

**Application for a Permit to Use Surface Water
In The Name of: ATI Wah Chang
Township 10 South, Range 3 West (W.M.)**

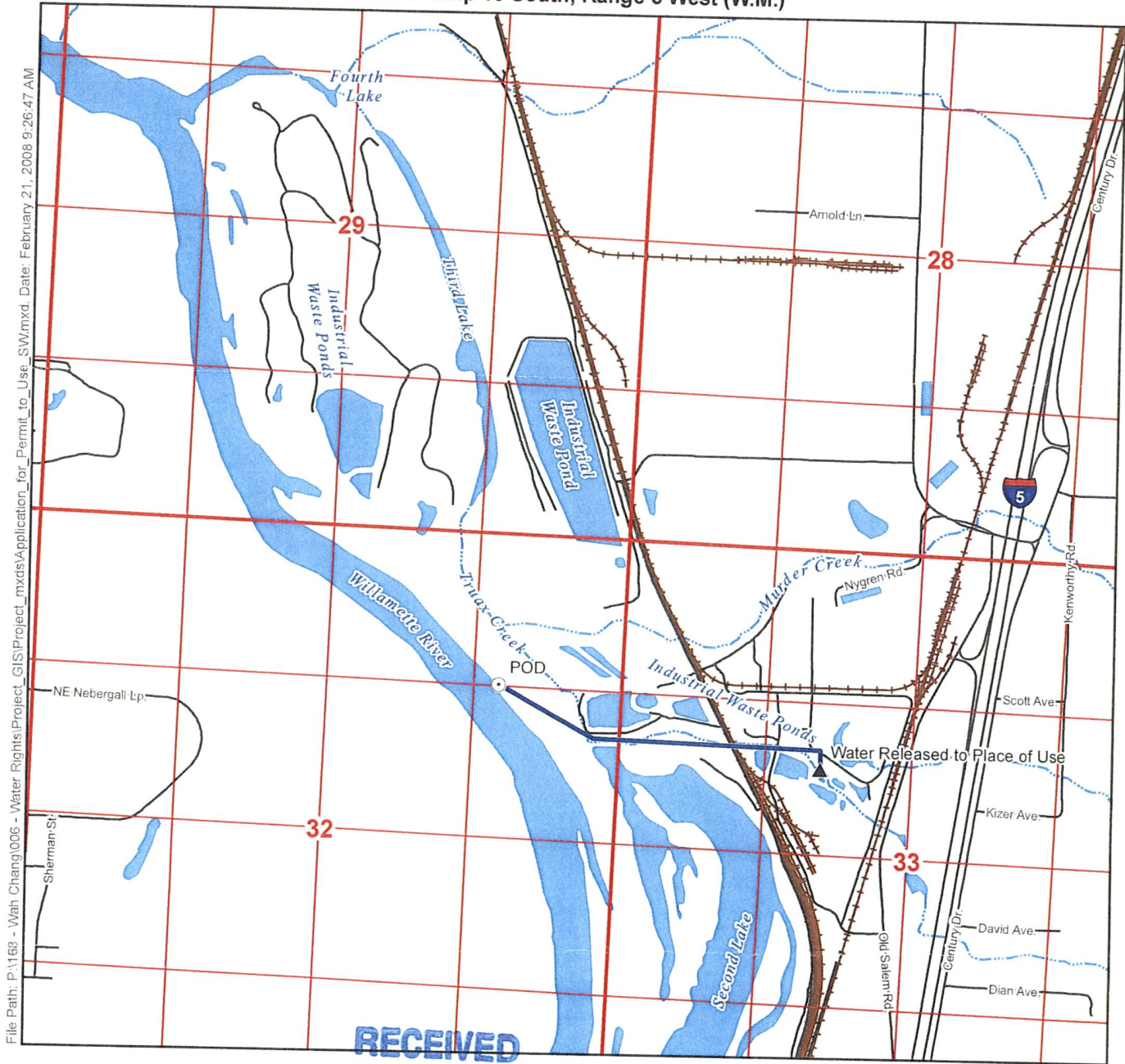

File Path: P:\168 - Wah Chang\006 - Water Rights\Project_GIS\Project_mxd\Application_for_Permit_to_Use_SW.mxd, Date: February 21, 2008 9:26:47 AM

Legend

- Point of Diversion (POD)
- ▲ Water Released to Place of Use
- Surface Water Diversion Pipe
- ~ Watercourses
- Waterbodies
- Roads
- Railroads

POD Legal Description

Proposed Point of Diversion
Located 1320 feet South and 1080 feet West from the NE corner of Section 32, Township 10 South, Range 3 West (W.M.)

FEB 25 2008

WATER RESOURCES DEPT
SALEM, OREGON



Scale

1 inch equals 1,320 feet
0 330 660 1,320
Feet

Map Information

Projection: Oregon State Plane North Zone
Datum: North American Datum of 1983
Date: February 21, 2008
Prepared By: GSI Water Solutions, Inc.

Data Sources

City of Albany GIS, Oregon Geospatial Data Clearinghouse

Disclaimer

This map was prepared for the purpose of identifying the location of a water right only and it is not intended to provide legal dimensions or location of property ownership lines.



App No S-87046 Permit No S-54459

