

T. 28 S., R. 8 W., W.M., Section 9

Diversion is:
1033 ft. North and
1132 ft. East of the
W 1/4 cor. Sec 9

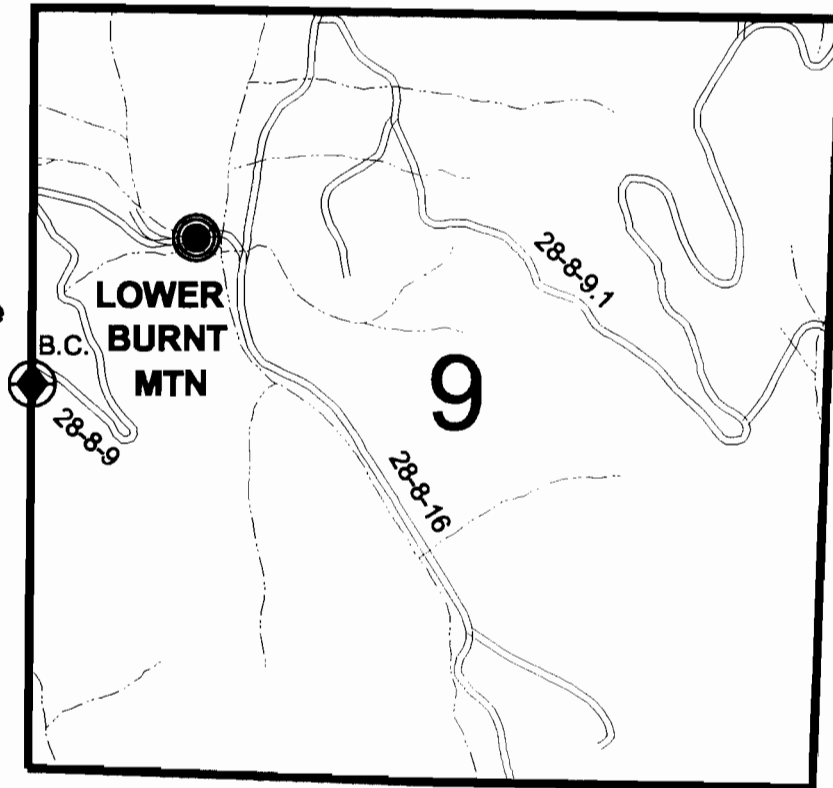

SCALE:
1" = 1320'

CLAIM OF BENEFICIAL USE MAP

in name of

UNITED STATES BUREAU OF LAND MANAGEMENT

Application No.: R - 70711

S - 70518

Permit No.: R - 11761

52000

RECEIVED

SEP 25 2000

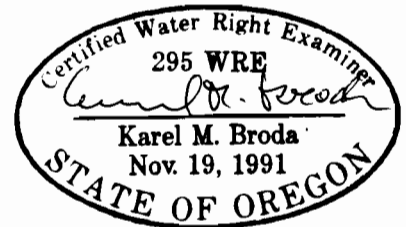

Expires: 12/31/01

SURVEYED: June 21, 2000

THIS MAP WAS PREPARED FOR THE PUPOSE OF IDENTIFYING THE LOCATION OF A WATER RIGHT ONLY
AND IS NOT INTENDED TO PROVIDE LEGAL DIMENSIONS OR LOCATION OF PROPERTY OWNERSHIP LINES.

U.S. Bureau of Land Management
Roseburg District Office
Division of Operations

Executed by:
Karel M. Broda, PE, CWRE
777 N.W. Garden Valley Blvd.
Roseburg, Oregon 97470

FINAL PROOF MAP

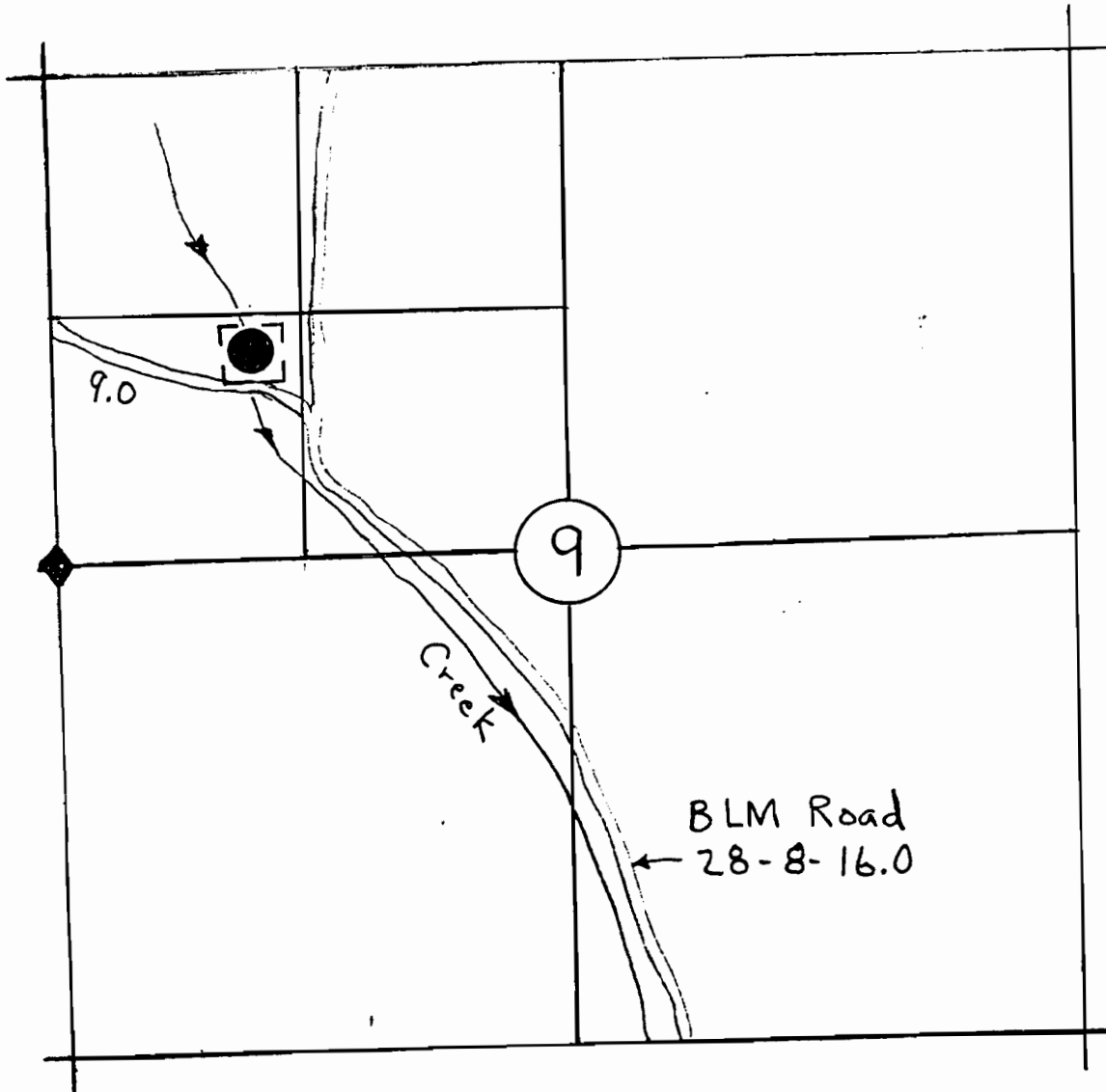

Scale 1" = 1000'

LOWER BURNT MTN. PUMP CHANCE
T28S R8W Sec 9
SW $\frac{1}{4}$ NW $\frac{1}{4}$

The point of diversion is located 1000 ft North and 1200 ft East from the West Quarter Corner of Section 9.

Coordinate Ties are based on aerial photo 3-7-40-89.

The map is shown for the purpose of water application and not property boundary.

APPLICATION: 70518, R. 70711
PERMIT: ...

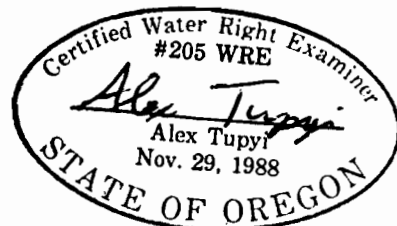

3-5-90