

GILLWORTH IRRIGATION RESERVOIR

LOCATED IN SECTION 31, TOWNSHIP 13 SOUTH, RANGE 12 EAST, W.M. — JEFFERSON COUNTY, OREGON

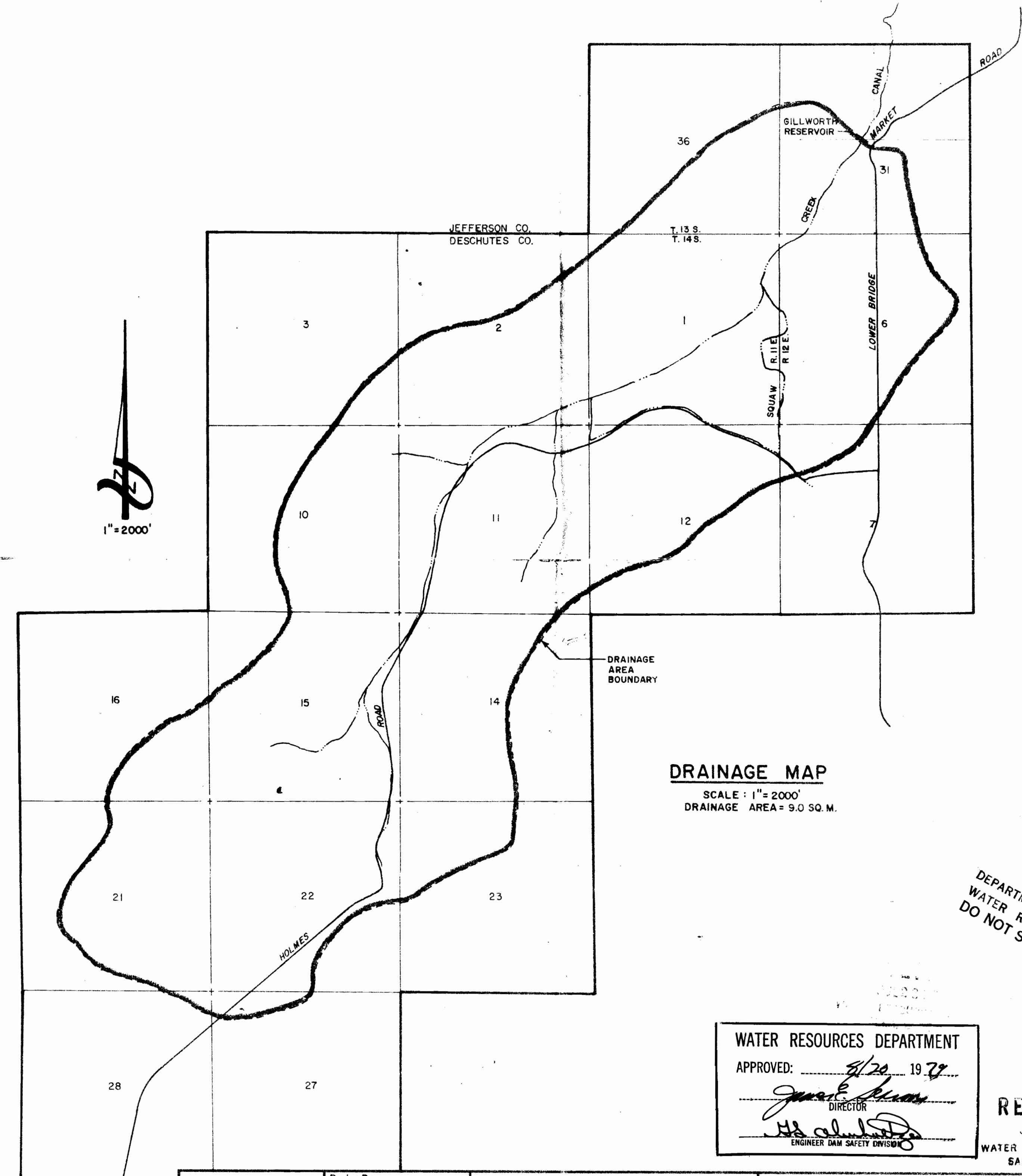
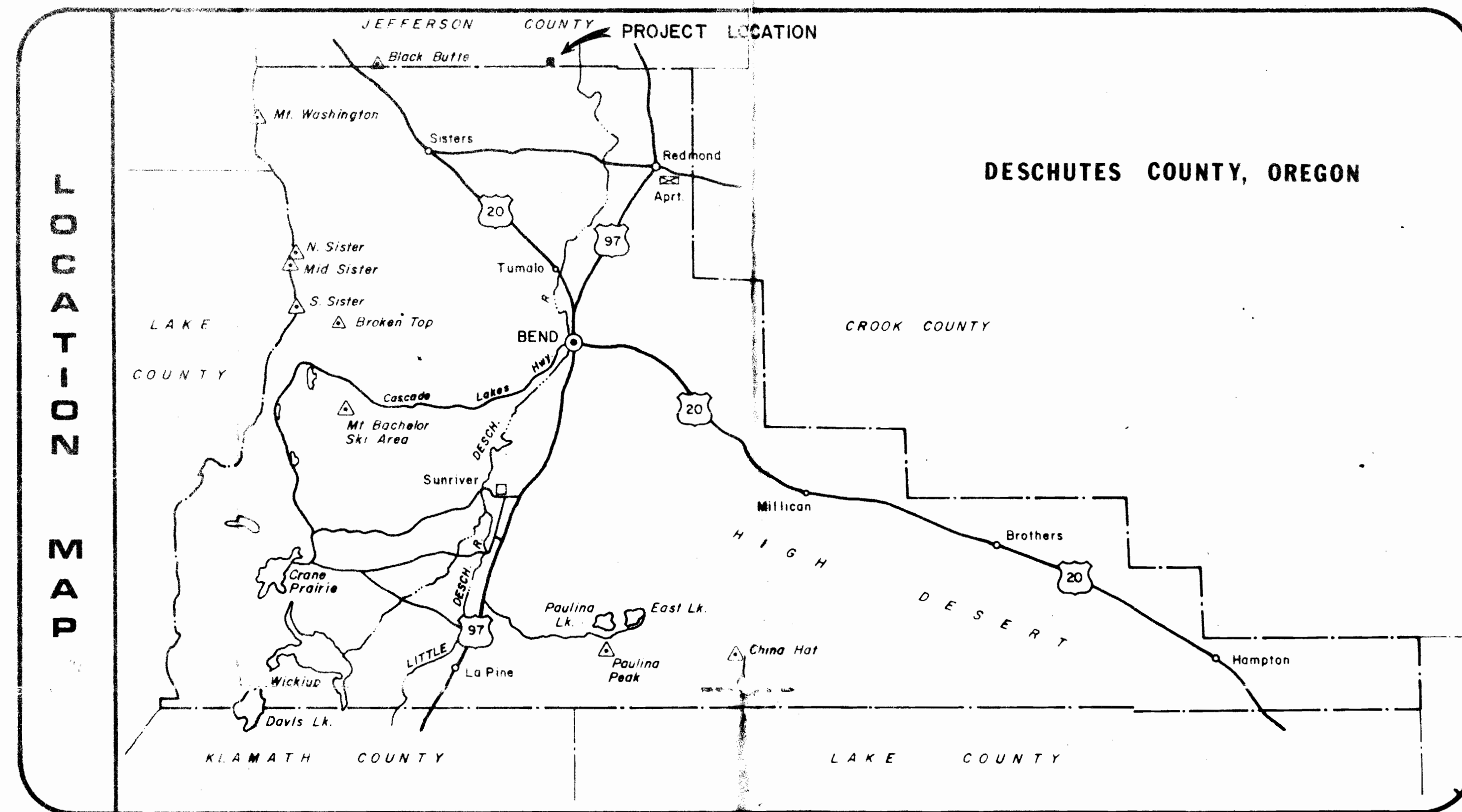

DRAINAGE MAP
SCALE: 1" = 2000'
DRAINAGE AREA = 9.0 SQ. M.

PAGE	SHEET TITLE
1.	LOCATION AND DRAINAGE MAP
2.	TOPOGRAPHICAL MAP
3.	AXIS AND SPILLWAY PROFILES
4.	AREA/CAPACITY CURVES AND DETAILS

DEPARTMENT OF
WATER RESOURCES
DO NOT SEND OUT

WATER RESOURCES DEPARTMENT
APPROVED: 8/20 1978
James H. ...
DIRECTOR
ENGINEER DAM SAFETY DIVISION

RECEIVED
JUN 21 1979
WATER RESOURCES DEPT
SALEM, OREGON

DESIGN BY	REVISIONS		
Drawn By N. O.	No.	By	Date
Checked By <i>RL</i>			
Approved By <i>RL</i>			
Date 7-14-78			
Scale AS SHOWN			
Drawing No. 0413-001 A9			

LOCATION AND DRAINAGE MAP
GILLWORTH IRRIGATION RESERVOIR

IN SECTION 31, TOWNSHIP 13 SOUTH, RANGE 12 EAST,
W.M., JEFFERSON COUNTY, OREGON

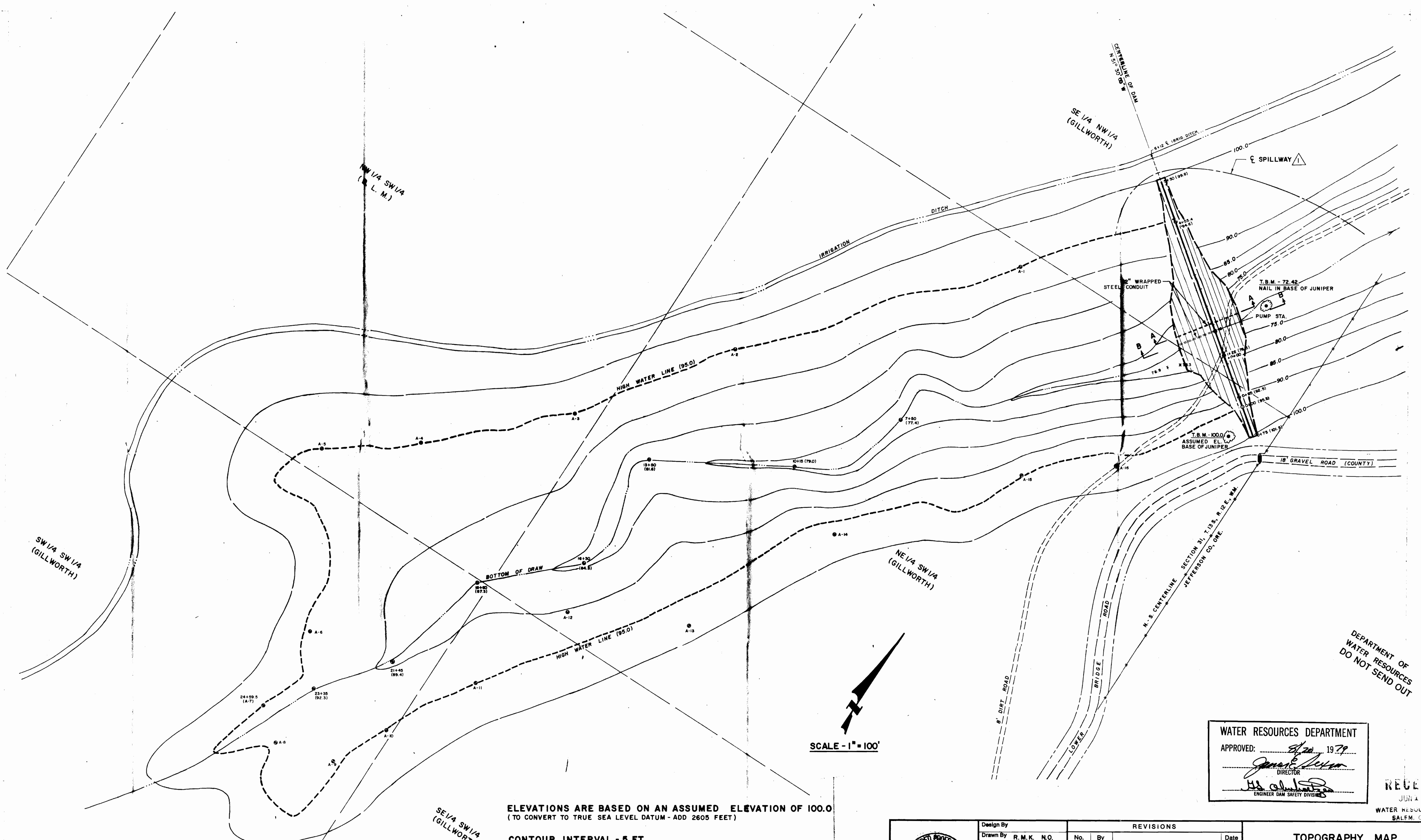

SCALE - 1" = 100'

ELEVATIONS ARE BASED ON AN ASSUMED ELEVATION OF 100.0
 (TO CONVERT TO TRUE SEA LEVEL DATUM - ADD 2605 FEET)
 CONTOUR INTERVAL - 5 FT.

DEPARTMENT OF
 WATER RESOURCES
 DO NOT SEND OUT

WATER RESOURCES DEPARTMENT
 APPROVED: *[Signature]* 1979
 DIRECTOR
 ENGINEER DAM SAFETY DIVISION

RECEIVED
 JUN 4 1979
 WATER RESOURCES DEPT
 SALEM, OREGON

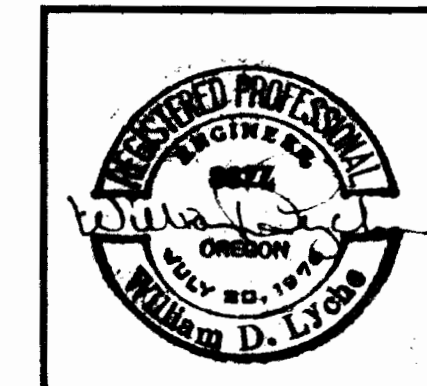

Design By		REVISIONS			
Drawn By	R.M.K. N.O.	No.	By	Date	
Checked By	SL	1	J.C.	RELOCATED SPILLWAY	6-8-79
Approved By	SL				
Date	7-12-78				
Scale	1" = 100'				
Drawing No.	0413-001 A9				

TOPOGRAPHY MAP
 GILLWORTH IRRIGATION RESERVOIR

IN SECTION 31, TOWNSHIP 13 SOUTH, RANGE 12 EAST,
 W.M., JEFFERSON COUNTY, OREGON

Century West Engineering Corporation

Bend,
 Oregon

2/4