

FINAL PROOF SURVEY MAP IN THE NAME OF E. DEAN SMITH

APPLICATION R - 70738

PERMIT R - 11786

SECTION 1, TOWNSHIP 29 SOUTH, RANGE 15 WEST, W.M.

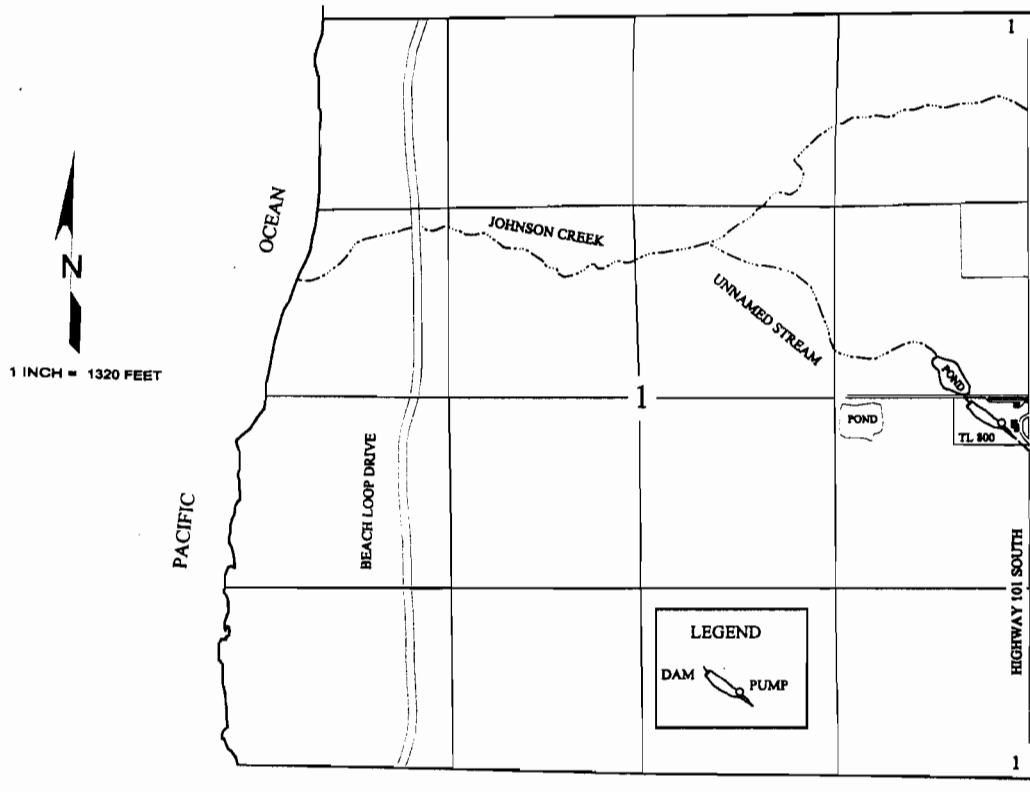

THE RESERVOIR POINT OF DIVERSION IS LOCATED 450 FEET WEST AND 40 FEET SOUTH FROM THE EAST QUARTER CORNER OF SECTION 1, BEING WITHIN THE NE 1/4 SE 1/4 OF SECTION 1, TOWNSHIP 29 SOUTH, RANGE 15 WEST, W.M.; COOS COUNTY.

RECEIVED
OCT 11 2002
WATER RESOURCES DEPT.
SALEM, OREGON

Certified Water Right Examiner
#054 WRE
James F. Gosson
James F. Gosson
Nov. 19, 1987
STATE OF OREGON

THE PURPOSE OF THIS MAP IS TO IDENTIFY THE LOCATION OF THE WATER RIGHT.
IT IS NOT INTENDED TO PROVIDE INFORMATION RELATIVE TO PROPERTY OWNERSHIP
BOUNDARY LINES.