

CLAIM OF BENEFICIAL USE FINAL PROOF MAP

LOCATED IN THE SW $\frac{1}{4}$ NW $\frac{1}{4}$, SE $\frac{1}{4}$ NW $\frac{1}{4}$ & NE $\frac{1}{4}$ SW $\frac{1}{4}$
of SECTION 13, TOWNSHIP 29 SOUTH, RANGE 15 WEST, W.M.
COOS COUNTY, OREGON
APPLICATION # S-74429 PERMIT #52404
APPLICATION # R-74428 PERMIT # R-11757

PREPARED FOR: BOAK BOGS INC.
(MELVIN E. & RUPERT G. BOAK)
PREPARED BY: DENNIS GOUDE
SURVEYED: JULY 14, 2000

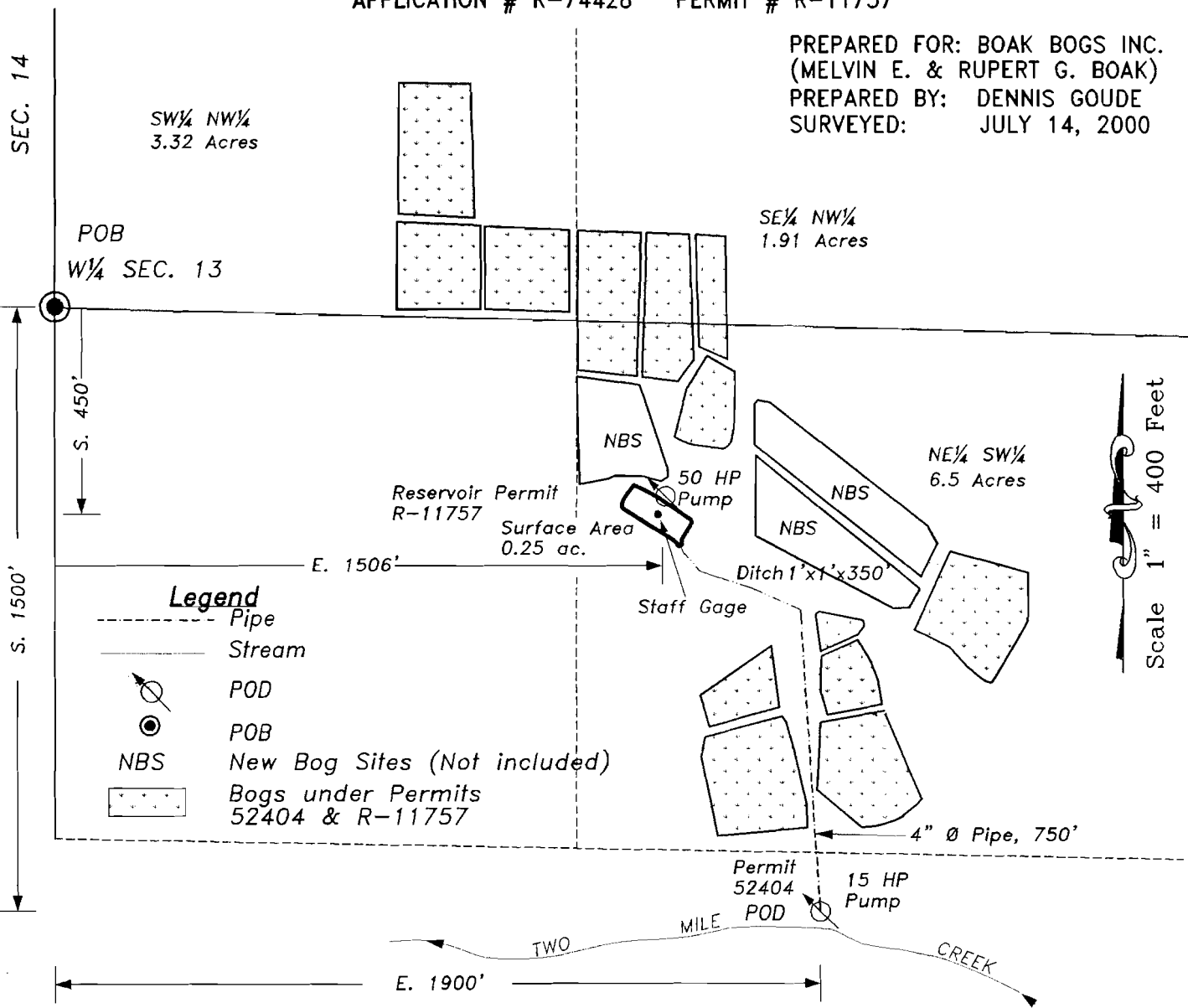

NOTE:
THE RESERVOIR PUMP IS A 50 HORSEPOWER GE AND IS LOCATED 450 FEET SOUTH AND 1506 FEET EAST FROM THE WEST CORNER $\frac{1}{4}$ OF SECTION 13. THE INSTREAM PUMP IS A 15 HORSEPOWER CENTURY AND IS LOCATED 1500 FEET SOUTH AND 1900 FEET EAST FROM THE WEST $\frac{1}{4}$ CORNER OF SECTION 13.



Stuntzner Engineering & Forestry

705 So. 4th Street
P.O. Box 118
Coos Bay, Oregon 97420
Phone (541) 267-2872
Fax (541) 267-0588

EXAMINERS DISCLAIMER STATEMENT

The preparation of this map was for the purpose of identifying the location of the Water Right only and has no intent to provide dimensions or location of property ownership lines.

AUG 23 2000
WATER RESOURCES DEP
SALEM, OREGON

EXPIRES 06/30/2001 **RECEIVED**