

APPLICATION MAP

IN THE NAME OF SEAWIND FARMS, INC.

RECEIVED

AUG 28 1994

SECTION 21, T 31 S, R 15 W, W.M.

WATER RESOURCES DEPT.
SALEM, OREGON

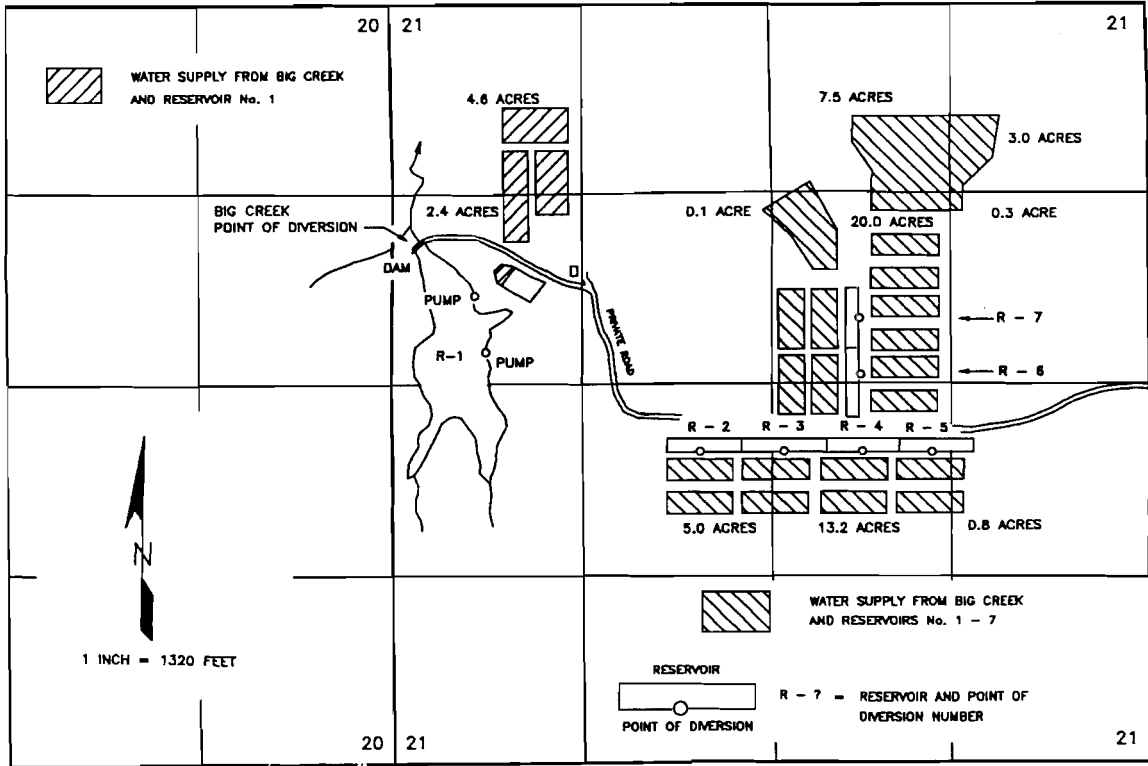

6 Reservoirs
= 54 acre-feet total

THE POINTS OF DIVERSION ARE TO BE LOCATED AS FOLLOWS:

SOURCE/POINT OF DIVERSION	FEET SOUTH	FEET EAST	¼ ¼ SECTION
BIG CREEK/RESERVOIR No. 1	1660 FEET	180 FEET	SW¼ NW¼
RESERVOIR No. 1 PUMP SITE	2210 FEET	570 FEET	SW¼ NW¼
RESERVOIR No. 1 PUMP SITE	2360 FEET	650 FEET	SW¼ NW¼
RESERVOIR No. 2	3070 FEET	2110 FEET	NE¼ SW¼
RESERVOIR No. 3	3070 FEET	2680 FEET	NW¼ SE¼
RESERVOIR No. 4	3070 FEET	3215 FEET	NW¼ SE¼
RESERVOIR No. 5	3070 FEET	3690 FEET	NW¼ SE¼
RESERVOIR No. 6	2550 FEET	3200 FEET	SW¼ NE¼
RESERVOIR No. 7	2170 FEET	3200 FEET	SW¼ NE¼

R-74440
> 74439

R-7444

ALL FROM THE NORTHWEST CORNER OF SECTION 21 AND WITHIN SECTION 21, TOWNSHIP 31 SOUTH, RANGE 15 WEST, W.M., CURRY COUNTY.

Application No. R74441
Permit No. R12960

THE PURPOSE OF THIS MAP IS TO IDENTIFY THE LOCATION OF THE WATER RIGHT. IT IS NOT INTENDED TO PROVIDE INFORMATION RELATIVE TO THE LOCATION OF PROPERTY OWNERSHIP BOUNDARY LINES.

Certified Water Right Examiner
#054 WRE
James F. Gosson
Nov. 19, 1987
STATE OF OREGON