

Application No. G. 1023

Permit No. G. 903

Certificate No. 28689

Stream Index, Page No. 2 - 924

Name Delmar J. Storment

By

Address Route 2, Box 391 B

Eugene, Oregon

Date filed June 26, 1958

Priority June 26, 1958

Action suspended until

OK Cert.

Returned to applicant

Date of approval July 25, 1958

CONSTRUCTION

Date for beginning July 25, 1959

Date for completion October 1, 1959

Extended to

Date for application of water October 1, 1960

Extended to

PROSECUTION OF WORK

Form "A" filed November 3, 1958

Form "B" filed November 3, 1958

Form "C" filed June 22, 1959

FINAL PROOF

Blank mailed MAY 19 1961

Proof received

Date certificate issued JUNE 9 1961

FEEES PAID

Date	Amount	
<u>6/26/58</u>	<u>15-</u>	
<u>5-23-61</u>	\$1 Cert. Fee	<u>5</u>

FEEES REFUNDED

Date	Amount

ASSIGNMENTS

Date	To Whom	Address	Volume

REMARKS

0.03 c.f.s. from a well for irrigation of 2.1 acres.

NOTICE OF BEGINNING OF CONSTRUCTION

I, Delmar J. Storment, the holder of Permit No. G-903
to appropriate the public waters of the state of Oregon, began the actual construction of the works described
therein on the 15 day of Oct., 1958.

Remarks: _____
The appropriator should state the manner of beginning construction work, number of men employed, the amount of work completed
up to the date of this statement, and any additional information which may tend to show the beginning of work in good faith.

IN WITNESS WHEREOF, I have hereunto set my hand this 28 day of Oct., 1958
Delmar J. Storment Rt. 2 Box 391 B Eugene, Oregon
(Signature of Applicant) (Address)

Fill out, detach, and mail to the State Engineer, Salem, Oregon, when construction work is begun.

STATE ENGINEER SALEM OREGON

NOTICE OF COMPLETION OF CONSTRUCTION

I, Delmar J. Storment, the holder of Permit No. G-903
to appropriate the public waters of the state of Oregon, completed the construction of the works described
therein on the 22 day of October, 1958.

Remarks: No water at proposed location authorized by
If the works have less capacity than described in the permit, or you have definitely abandoned part of the proposed development, you
permit new well located 109 feet north and 15 feet east
should so state in order that our records may not be unnecessarily encumbered.
of proposed well.

IN WITNESS WHEREOF, I have hereunto set my hand this 30 day of Oct, 1958
Delmar J. Storment Rt. 2, Box 391-B Eugene
(Signature of Applicant) (Address)

Fill out, detach, and mail to the State Engineer, Salem, Oregon, when construction work is completed.

The address is Rt. 2

IMPORTANT—This form is a notice to the State Engineer that permittee is ready to make final proof to the extent to which the water has actually been applied to the intended use under the terms of the permit. Permittee is cautioned that Certificate of Water Right will be issued based on the extent of the quantity and use as determined by the final proof inspection and survey which will be made in response to the filing of this Form C.

NOTE: In the case of an irrigation permit, this Form C should not be mailed to the State Engineer until all of the land described in the permit, which it is intended to irrigate under this permit at any time, has actually been irrigated.
Fill out, detach and mail to the State Engineer, Salem, Oregon, when all of the water has been applied.

NOTICE OF COMPLETE APPLICATION OF WATER TO A BENEFICIAL USE

I, Delmar J. Storment, the holder of Permit No. G-903
to appropriate the public waters of the state of Oregon, completely applied the waters to a beneficial use in
accordance with the terms of said permit, on the 12 day of June, 1959.

Remarks: _____

IN WITNESS WHEREOF, I have hereunto set my hand this 19 day of June, 1959
Delmar J. Storment Rt. 2 Box 391 B Eugene, Oregon
(Signature of Applicant) (Address)

STATE ENGINEER SALEM OREGON JUN 22 1959

T.16S.R.3W.W.M.

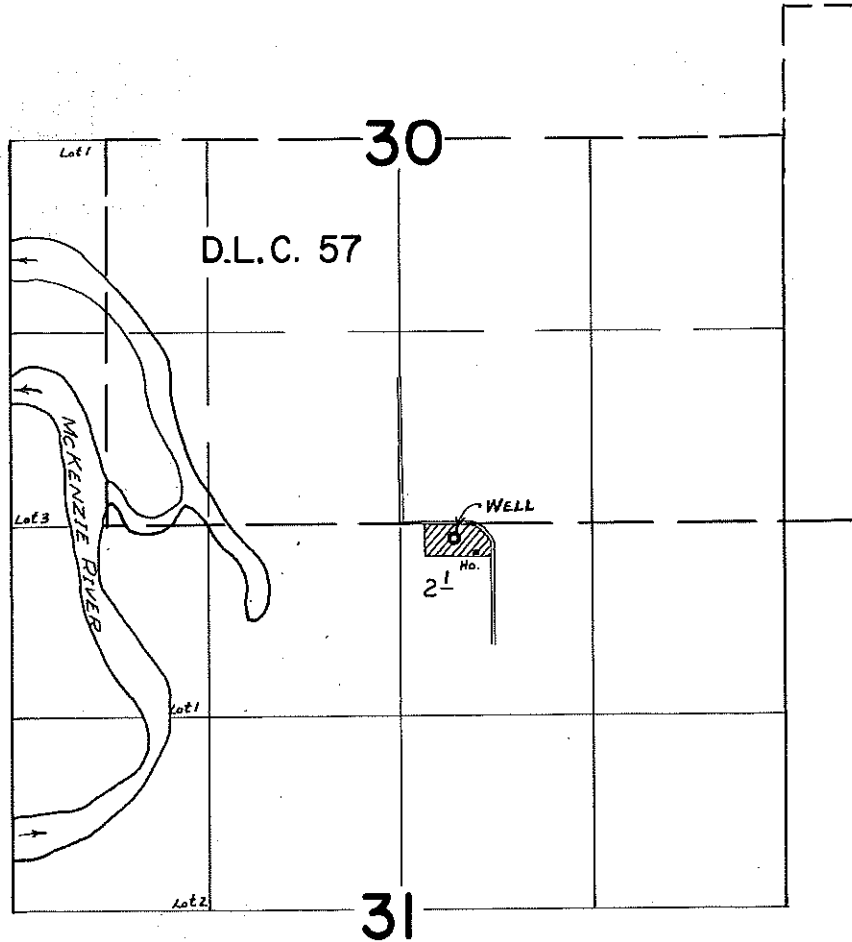

FINAL PROOF SURVEY
UNDER

Application No. G-1023. Permit No. G-903.
IN NAME OF

DELMAR J. STORMENT

Surveyed 28 April 1960, by M. Bish

1/4 Corner of north line of sec. 31, Twp. 16, R. 3

Rehney & Co. Inc.

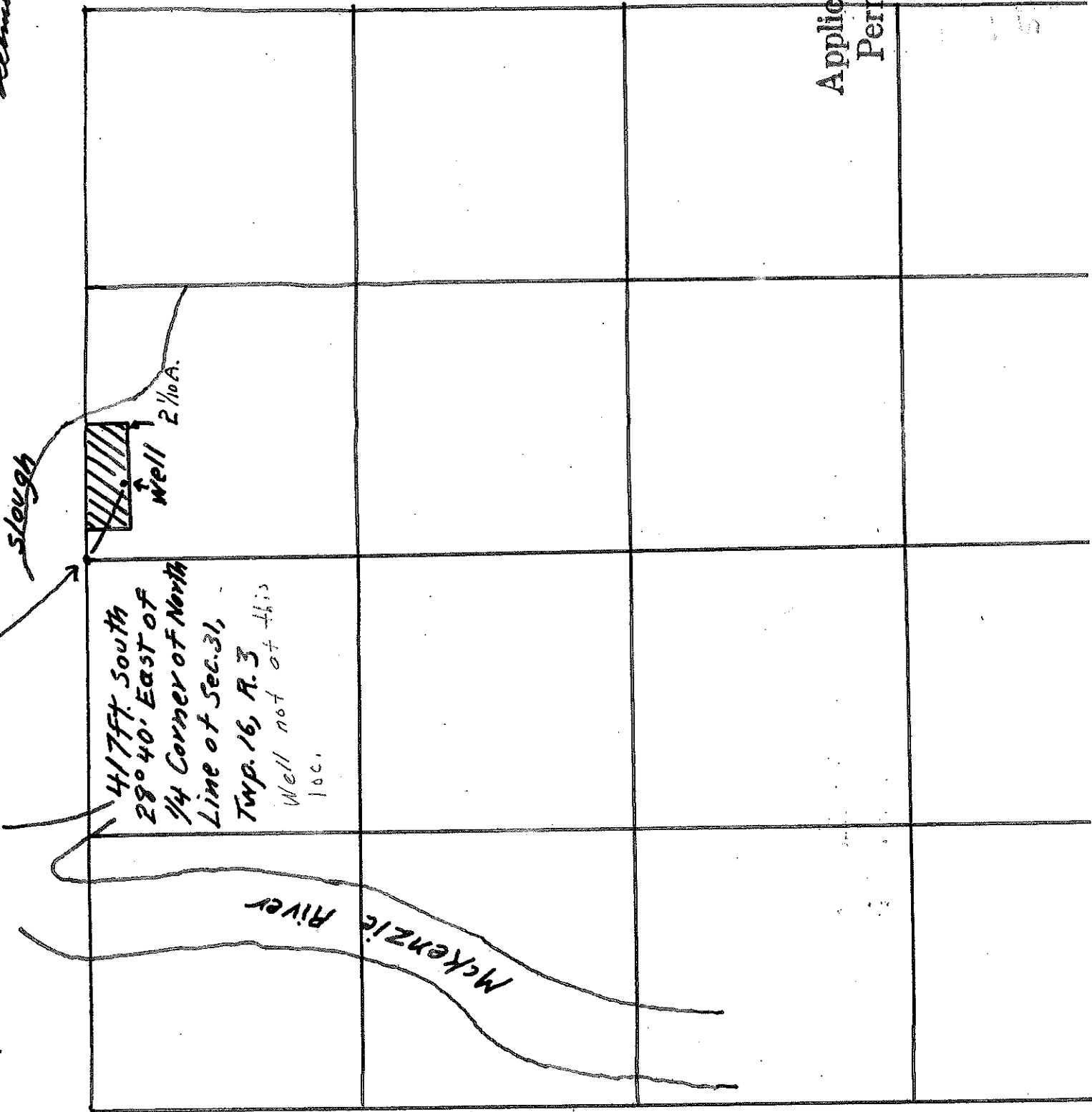

417 ft. south
 29° 40' east of
 1/4 corner of north
 line of sec. 31,
 Twp. 16, R. 3

Well not at this
 loc.

Application No. G-1023
 Permit No. G-903

24 June 1958

This is the legal description of the property upon which water is to be used for irrigation.

Beginning at a point on the North line of Section 31, Township 16 South, Range 3 West of the Willamette Meridian, South $89^{\circ}45'$ East 176.2 feet from the $\frac{1}{4}$ corner on the North side of said section; and running thence along said section line South $89^{\circ}45'$ East 446.2 feet to a point on the bank of a slough; thence South 210.0 feet; thence North $89^{\circ}45'$ West 446.2 feet; thence North 210.0 feet to the point of beginning, in Lane County, Oregon.

Alma J. Starnment
Box 391 B, Rte. 2
Eugene, Oregon

Permit No. G-903

Application No. G-1023

County LANE

Proof of Appropriation of Water

Apr 1 28 1960
M.B.

- 1. Name Delmar J. Storment
- 2. Address Rt. 2, Box 391B, Eugene, Oregon
- 3. Source of supply well
- Tributary of McKenzie River
- 4. Amount of water 0.03 c.f.s.
- 5. Priority date June 26, 1958
- 6. Use irrigation (~~supplemental clause~~) 1/80th & 2 1/2 a.f.
- 7. Location of point of diversion NW 1/4 NE 1/4 Sec. 31, Twp. 16 S, Range 3 W, W. M.
- 8. The description of land given below corresponds to that found in your permit covering land to be irrigated, or, if for other purposes, the place of use.
Well is located 1/2 ch. S, and 5 1/2 ch. E. from the NW 1/4 cor. Sec. 31

Township	Range	Section	Legal Subdivision	No. Acres Actually Irrigated
Willamette Meridian				
<u>16 S</u>	<u>3 W</u>	<u>31</u>	<u>NW 1/4 SE 1/4</u>	<u>2.1</u>
NOTE: WELL NOT PROPERLY LOCATED ON APPLICATION MAP				

use LP
attached

21
22

I have read the above and foregoing proof of appropriation of water; I know the contents thereof, and that the facts therein stated are true.

IN WITNESS WHEREOF, I have hereunto set my hand this day of

19.....

REPORT OF PERSON MAKING INSPECTION

Description of works: Infa - Mrs. Starnment

Well - 4" casing

Pump - GE 2hp 2855 RPM 1ph.

Pacific model 11-443 Dic. Const. 1x1 1/2

Pipe 280' 2" st.

Heads - 5 - RB40 3/16 x 3/32

Lift - 5 ft.

Crop - Pasture - lawn - garden

Tied to N 1/4 cor. Sec. 31 (RP found)
Drafted according to Photo layout

I, _____, do hereby certify that I have made
an inspection of the works described herein and in Permit No. G-903, on the 28 day
of April, 1960, and found the foregoing statements and descriptions of works to
be accurate. In my opinion the appropriation has been completed to the extent of _____
and I recommend the issuance of water right certificate for this amount.

(Quantity of water in
second-feet or acre-feet)

NOTICE TO INSPECTORS

If conditions do not justify the above re-
port by you, please return this form without
your signature, with a full report by letter.

Myron Bil
(Name)

(Title)

RECEIVED
MAY 23 1961
STATE ENGINEER
SALEM, OREGON

STATE OF OREGON

COUNTY OF LANE

CERTIFICATE OF WATER RIGHT

This Is to Certify, That **DELMAR J. STORMENT**

of **Rt. 2, Box 391-B, Eugene**, State of **Oregon**, has made proof to the satisfaction of the STATE ENGINEER of Oregon, of a right to the use of the waters of a well

a tributary of **McKenzie River** for the purpose of irrigation

under Permit No. **0-903** of the State Engineer, and that said right to the use of said waters has been perfected in accordance with the laws of Oregon; that the priority of the right hereby confirmed dates from **June 26, 1958**

that the amount of water to which such right is entitled and hereby confirmed, for the purposes aforesaid, is limited to an amount actually beneficially used for said purposes, and shall not exceed **0.03 cubic foot per second**

or its equivalent in case of rotation, measured at the point of diversion from the stream. The point of diversion is located in the **NW $\frac{1}{4}$ NE $\frac{1}{4}$, Section 31, T. 16 S., R. 3 W., W.M.** Well is **1 $\frac{1}{2}$ chain S. and 5 $\frac{1}{2}$ chains E.** from the **N $\frac{1}{4}$ corner, Section 31.**

The amount of water used for irrigation, together with the amount secured under any other right existing for the same lands, shall be limited to **one-eightieth** of one cubic foot per second per acre, or its equivalent for each acre irrigated and shall be further limited to a diversion of not to exceed **2 $\frac{1}{2}$ acre feet per acre** for each acre irrigated during the irrigation season of each year,

and shall conform to such reasonable rotation system as may be ordered by the proper state officer.

A description of the place of use under the right hereby confirmed, and to which such right is appurtenant, is as follows:

**2.1 acres NW $\frac{1}{4}$ SE $\frac{1}{4}$
Section 31
T. 16 S., R. 3 W., W.M.**

Land on which water is to be used is part of that described as follows:

Beginning at a point on the North line of Section 31, Township 16 South, Range 3 West, of the Willamette Meridian, South **89° 45'** East **176.2 ft.** from the **$\frac{1}{4}$ corner** on the North side of said Section; and running thence along said Section line South **89° 45'** East **446.2 ft.** to a point on the bank of a slough; thence South **210.0 ft.**; thence North **89° 45'** West **446.2 ft.**; thence North **210.0 ft.** to the point of beginning; in Lane County Oregon.

The right to the use of the water for the purposes aforesaid is restricted to the lands or place of use herein described.

THIS IS A DRAFT OF WATER RIGHT CERTIFICATE

See other side for instructions and final proof to be executed by permittee.

STATE OF OREGON

STATE ENGINEER

WATER RESOURCES DEPARTMENT

SALEM

251 FINANCE BUILDING
170 12TH STREET S. E.

REFER TO FILE NO. G-1023

May 19, 1961

Delmar J. Storment
Rt. 2, Box 391 B
Eugene, Oregon

Dear Mr. Storment:

On the reverse side of this paper is a copy of a draft of water right certificate to confirm the right under Permit No. G-903. You are requested to examine this draft and if you find it correctly describes the appropriation of water made, execute the following final proof. A fee of \$1.00 is required for recording your certificate of water right in the office of the County Clerk. The fee of \$1.00, together with this signed draft, must be returned to the State Engineer.

Very truly yours,

LEWIS A. STANLEY
State Engineer

FINAL PROOF

I have read the draft of water right certificate shown on the reverse side of this paper and as final proof of appropriation of water I hereby certify that the water has been used as described in said draft.

22 May 1961
(Date)

Delmar J. Storment
(Signature)

251 FINANCE BUILDING
170 12TH STREET, S.E.

STATE OF OREGON
STATE ENGINEER
WATER RESOURCES DEPARTMENT
SALEM
June 22, 1959

REF TO
FILE N. G-1023

Delmar J. Storment
Route 2 Box 391 B
Eugene, Oregon

Dear Sir:

This will acknowledge receipt of your notice to the effect that complete application of water has been made under Permit No. G-903.

Pursuant to your report and in line with the general practice of this office a survey will be made at a later date. After this survey, proof may be made and certificate issued covering the actual use of water as found by the engineer. In case of irrigation, any lands described in the permit that have not been irrigated will be automatically eliminated from the water right.

In the meantime, the permit which you hold will be valid evidence of the water right in question so long as you continue to use the water.

Very truly yours,

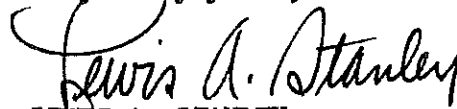

LEWIS A. STANLEY
State Engineer

Form ^{D1} 128

G-1023

August 22, 1958

Mr. Delmar J. Storment
Route 3, Box 391 B
Eugene, Oregon

Dear Mr. Storment:

Enclosed find Application No. G-1023, Permit No. G-903 with
blueprint.

November 14, 1958

Dedmar J. Storment
Route 2 Box 391 B
Eugene, Oregon

Dear Sir:

This acknowledges receipt of Forms A and B, being notices of the beginning of construction and completion of construction under Permit No. G-903.

These reports have been filed with other matter pertaining to the permit which is in good standing until October 1, 1960, when, under its terms, all the water which it is intended to use at any time should be used to the full extent intended.

Very truly yours,

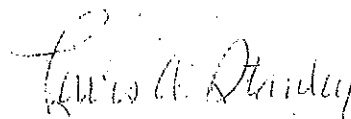

LEWIS A. STANLEY
State Engineer

Form 127
Dlf.

July 15, 1958

Delmar J. Stornant
Route 2, Box 391 B
Eugene, Oregon

Dear Sir:

This will acknowledge receipt of your returned Application No. G-1023 and the accompanying map.

Your application now appears to be in satisfactory form and is being placed in line for approval by issuance of a permit with the next group.

Very truly yours,

LEWIS A. STANLEY
State Engineer

By

James W. Carver, Jr.
Assistant

b129

June 30, 1958

Delmar J. Storment
Route 2, Box 391 B
Eugene, Oregon

Dear Mr. Storment:

This will acknowledge receipt of your application for a permit to construct a well and appropriate therefrom 40 gallons of water per minute for the irrigation of 2.1 acres, the accompanying map, legal description, and payment of fees in the amount of \$15, for which our Receipt No. 17172 is enclosed.

Upon examination of your application (File No. G-1023), the following defects are noted:

Application Item No. 4 and Map: The location of the well, as shown on the map, does not agree with the location as listed under Item 4. The equivalent bearing and distance for a point that is 200 feet South and 365 feet East from the N¹ corner would be South 28°40' East a distance of 417 feet.

The diversion point should be further located as being within a specific 1/16th of a section, which would appear to be the NW¹ NE¹ of Section 31.

Item No. 12: The area you propose to irrigate should be listed as being within specific 1/16ths of a section.

For your convenience in the correction of the above noted defects, we are returning herewith your application and map. The application has been endorsed so that in order to retain its date of priority it must be returned to this office on or before August 29, 1958.

Very truly yours,

LEWIS A. STANLEY
State Engineer

By James W. Carver, Jr.
Assistant

JWC:bks
Enc: application and map