

T. 9 S., R. 1 W., W. M.

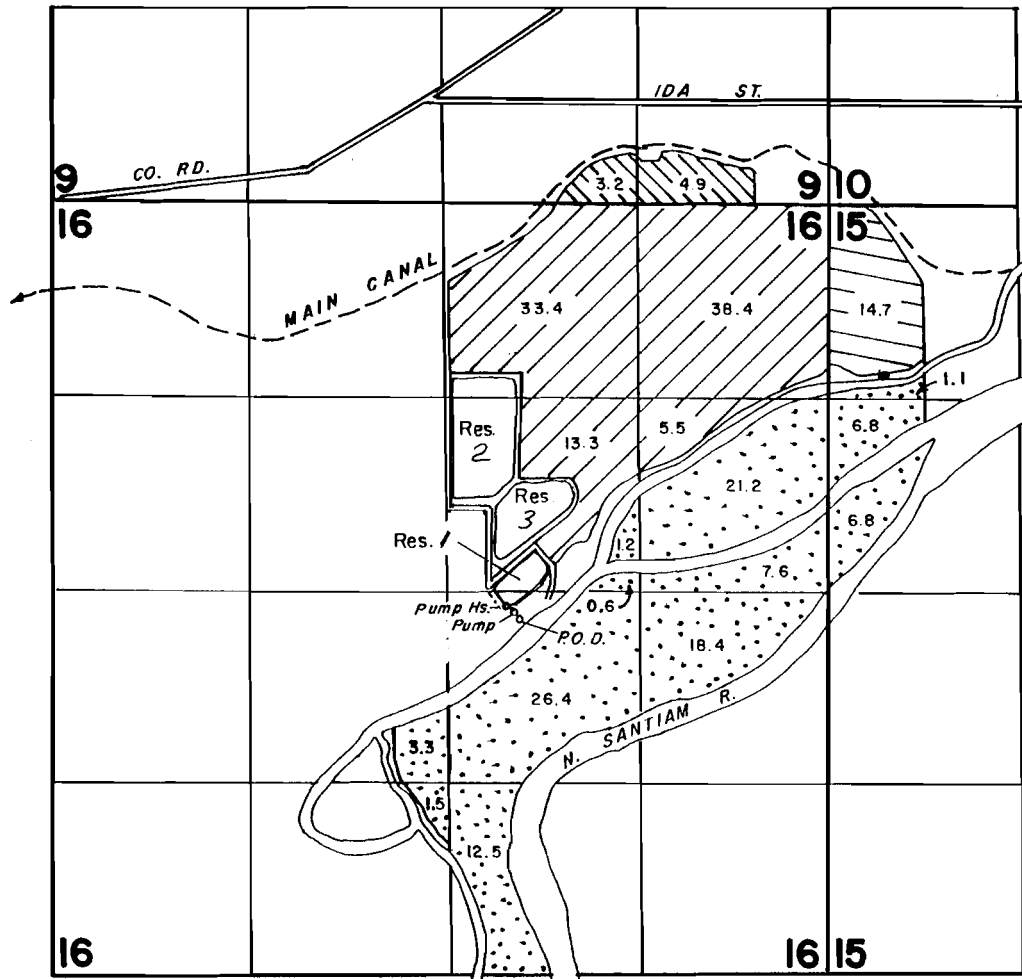

P.O.D.: RESERVOIR - 120' S. & 420' E.; STREAM - 190' S. & 500' E. FROM

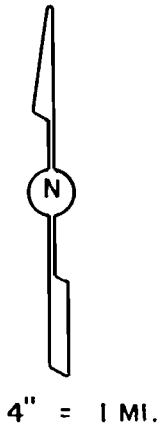

THIS MAP WAS PREPARED FOR THE PURPOSE OF IDENTIFYING THE LOCATION OF A WATER RIGHT ONLY AND IS NOT INTENDED TO PROVIDE LEGAL DIMENSIONS OR LOCATION OF PROPERTY OWNERSHIP LINES.

WATER RIGHT MAP

FOR

NORPAC FOODS, INC.

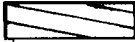
SURVEYED ON MAY 24, 1994

-  PRIMARY FROM N. SANTIAM R., RES. NO. 1, 2 & 3, & SUPPLEMENTAL FROM EFFLUENT
-  SUPPLEMENTAL FROM RES. NO. 1, 2, 3 & EFFLUENT
-  SUPPLEMENTAL FROM EFFLUENT & RES. NO. 2 & 3
-  PRIMARY FROM N. SANTIAM R., SUPPL. FROM EFFLUENT

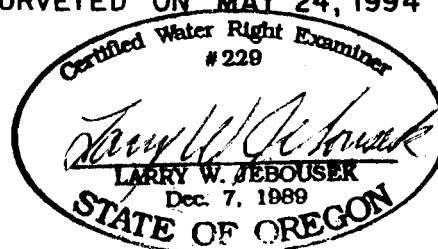

Applied for R-74827
R12083