

SW 1/4 OF NE 1/4 & NW 1/4 OF SE 1/4 (THOMAS DLC NO. 72)

SE 1/4 OF SE 1/4 (STOREY DLC NO. 63)

SECTION 17, T1S, R3E, W.M.

MULTNOMAH COUNTY, OREGON

RECEIVED

SEP 10 1996

WATER RESOURCES DEPT  
SALEM, OREGON

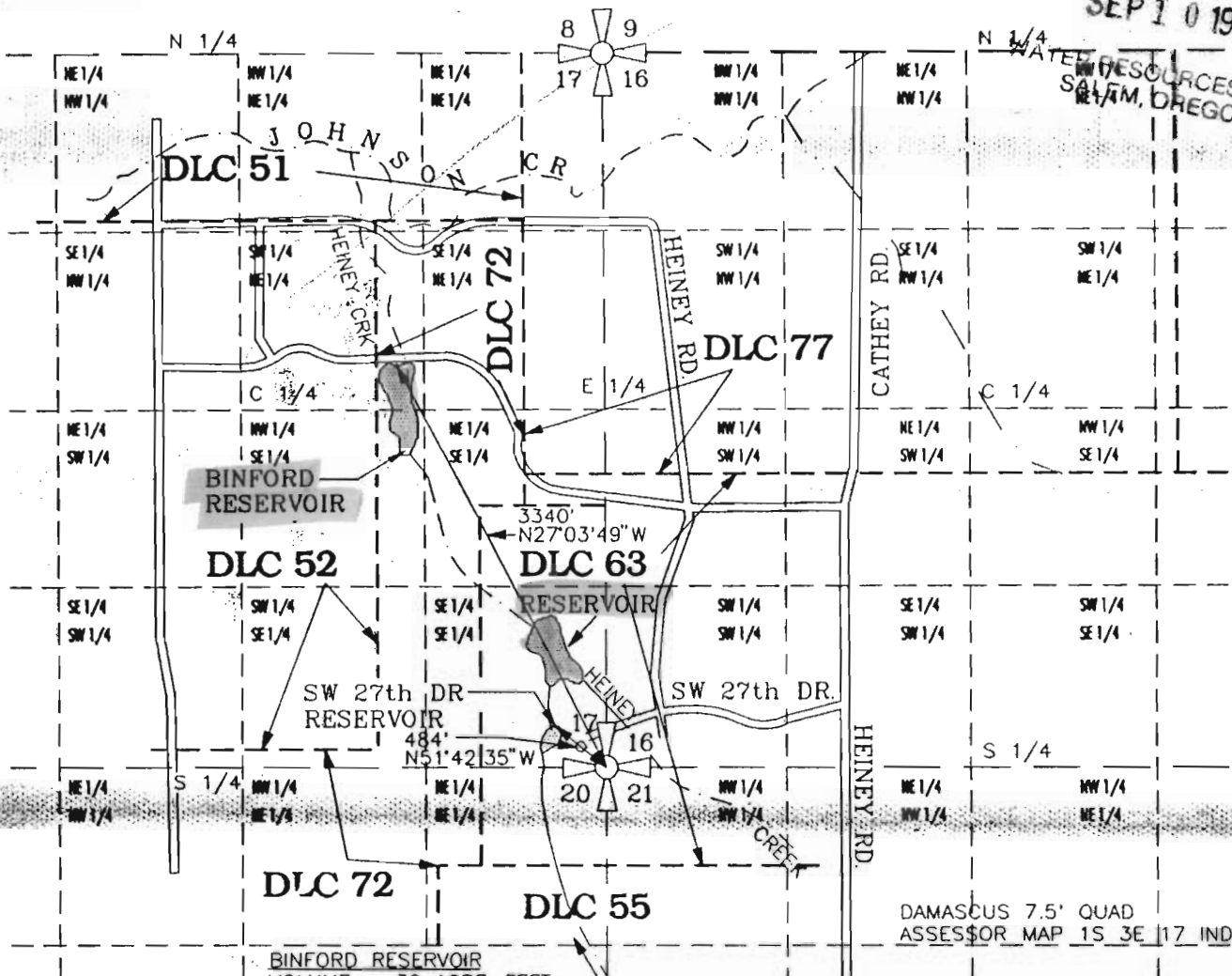

**BINFORD RESERVOIR**  
 VOLUME = 30 ACRE-FEET  
 DEPTH = 20 FEET  
 SURFACE = 3.0 ACRES

**SW 27th DRIVE RESERVOIR**  
 VOLUME = 1.02 ACRE-FEET  
 DEPTH = 4.0 FEET  
 SURFACE = 0.318 ACRE

**BINFORD RESERVOIR LOCATION:**

SW 1/4, NE 1/4, NW 1/4, SE 1/4 WITHIN B. THOMAS DLC NO. 72, SEC. 17, T1S, R3E, W.M., MULTNOMAH CO.

**SW 27th DRIVE RESERVOIR LOCATION:**

SE 1/4 OF SE 1/4, WITHIN J. STOREY DLC NO. 63 SECTION 17, T1S, R3E, W.M., MULTNOMAH COUNTY, OR

PREPARATION OF THIS MAP WAS FOR THE PURPOSE OF IDENTIFYING THE LOCATION OF THE WATER RIGHTS ONLY AND HAS NO INTENT TO PROVIDE DIMENSIONS OR LOCATION OF PROPERTY OWNERSHIP LINES.

**FINAL PROOF SURVEY  
RESERVOIR PERMIT R-11452**

PREPARED BY EDWARD A. CRANE, CWRE

Renewal 12/31/97  
Signed 8-12-96

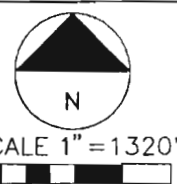
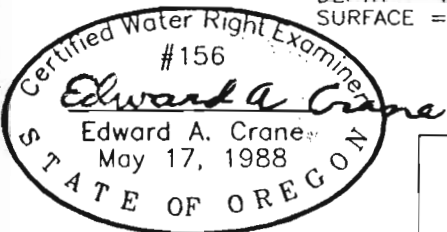

SURVEYED AUGUST 9, 1996  
BY EDWARD A. CRANE, CWRE

\\CADD\181-001\18100101.DWG 8/9/97 EAC

DATE  
AUG. 1996

PROJECT NO.  
181-001



**CRANE & MERSETH**  
 Engineering/Surveying

SUITE "D"  
 6566 SE LAKE ROAD  
 MILWAUKIE, OREGON 97222

BUS: (503) 654-2005  
 FAX: (503) 654-2575

APPLICATION FOR PERMIT NUMBER R-71519  
 PERMIT NUMBER G-11452 IN THE NAME OF:

CITY OF GRESHAM  
 PARKS AND RECREATION DIVISION, D.E.S.  
 1333 NW EASTMAN PKWY, GRESHAM OR 97030

FIGURE  
1/1