

Revised

RECEIVED

APPLICATION MAP

In the Name of: Momtazi Family, LLC
Moe Momtazi, Owner - Manager
Sections 4, 8, 9, 10, and 16 T. 5 S., R 5 W.
Scale 1" = 1320'

OCT 25 1999

WATER RESOURCES DEPT.
SALEM, OREGON

October 22, 1999

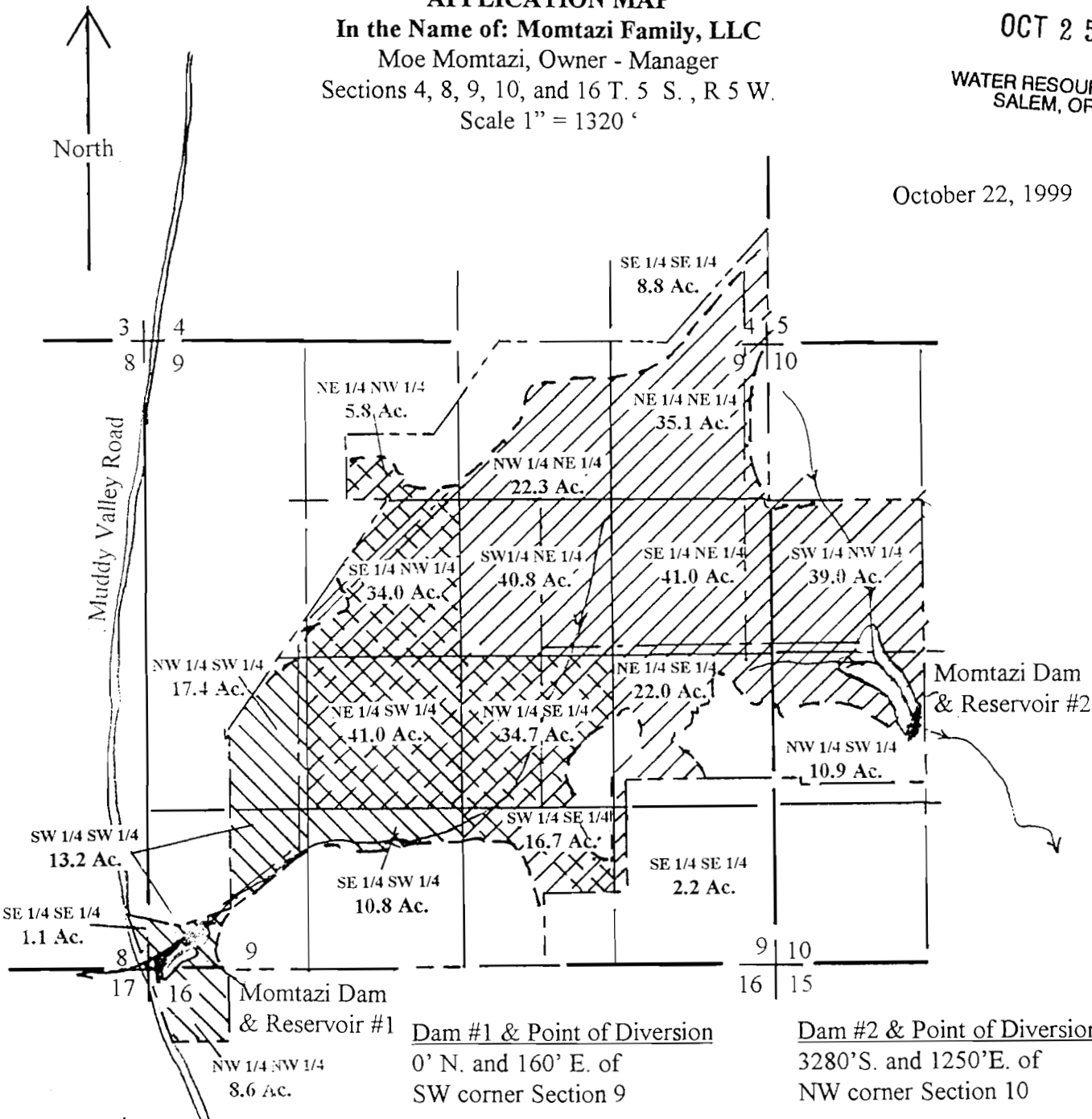

Legend

- //// Primary from Reservoir #1
- ~~~~ Supplemental from Reservoir #1
- //// Primary from Reservoir #2
- ~~~~ Supplemental from Reservoir #2
- ← Intermittent stream
- - - Property line
- 40 line
- - - Proposed pipelines

This map is for the purpose of locating water rights. It is not intended to provide information relative to location of property ownership boundary lines.

State Hwy 13

Certified Water Rights Examiner
#449WRE

Leland A. Hardy
Leland A. Hardy
June 11, 1998
STATE OF OREGON

Application No. 5-84126, R-84127
Permit No. 53672, R-1282

RENEWAL DATE: June 11, 2000
18 R-12824