

Application B-84165
 Permit No. R-1279 T.6S. R.5W., W.M.
 POLK COUNTY

WATER DIVISION
 JUN 19 1999
 WATER DIVISION OF POLK COUNTY
 SALES TAX 0.005000

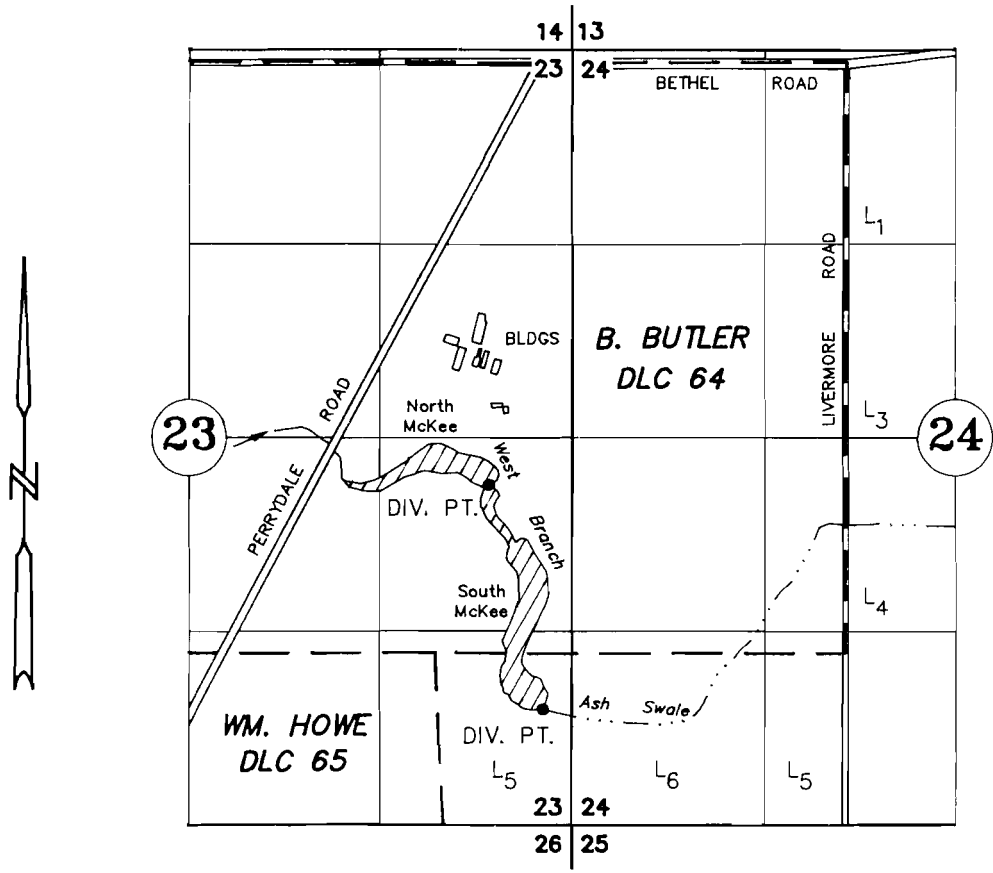

TAX LOTS:
 6 5W 23 01000
 6 5W 24 00500

DIVERSION POINT NORTH DAM: 1120' N AND 350' E OF NW COR OF W. HOWE DLC 65
 DIVERSION POINT SOUTH DAM: 440' S AND 755' E OF NW COR OF W. HOWE DLC 65

APPLICATION TO CONSTRUCT A RESERVOIR

APPLICATION No. R 84165 PERMIT NO. R-12790

SCHARF BROS. FARMS

APRIL 30, 1999
 SCALE 1" = 1320'

NOTE: This map is for the purpose of identifying the location of water rights and has no intent to dimension or locate property ownership lines.

