

T 6 S, R 1 W, W.M.

MARION COUNTY

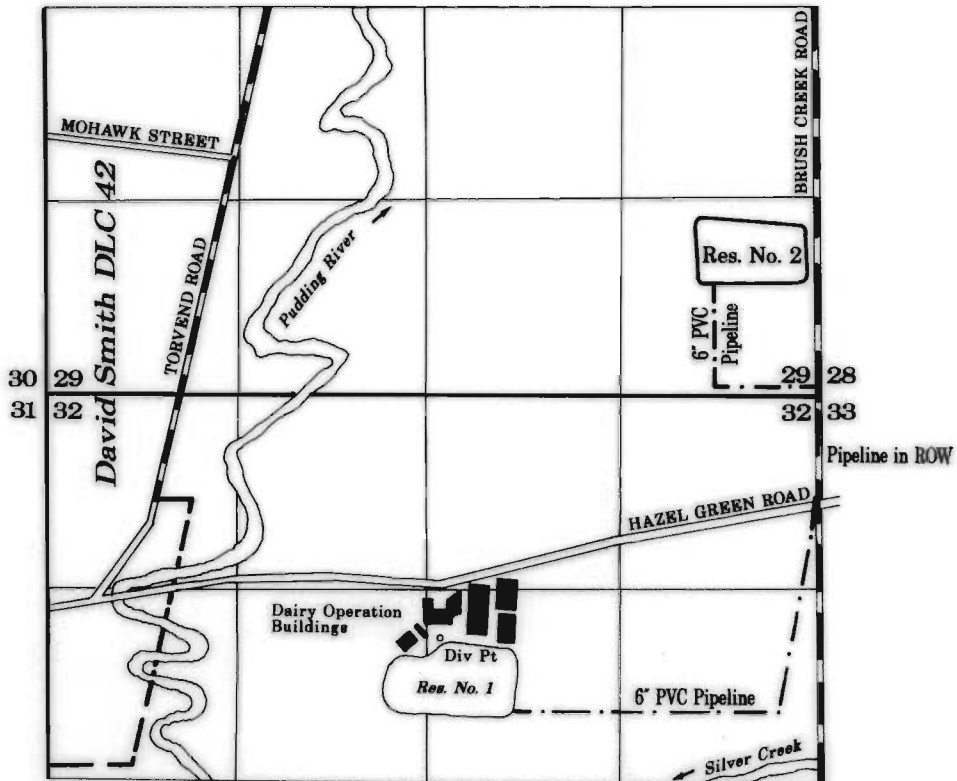

Div. Pt. 2580' West and 1660' South of the NE corner of Section 32.

**FINAL PROOF SURVEY
UNDER**

Application R-71810, Permit R-11533

IN THE NAME OF
MALLORIE'S DAIRY, INC.

RECEIVED

NOV 18 1996

WATER RESOURCES DEPT.
SALEM, OREGON

January 16, 1996
Scale: 1" = 1320'

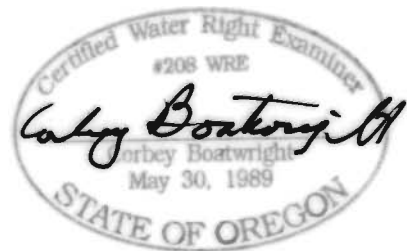

NOTE: This map is for the purpose of identifying the location of water rights and has no intent to locate or dimension property ownership lines.