

T. 15 S. R. 11 E.

N

Map to Accompany Application of
Arland T. Keeton and Keith Cyrus
Star R.T. Redmond, Oregon 97756
Scale 4" = 1 mile

Application No. G-8344
Permit No. G 7739

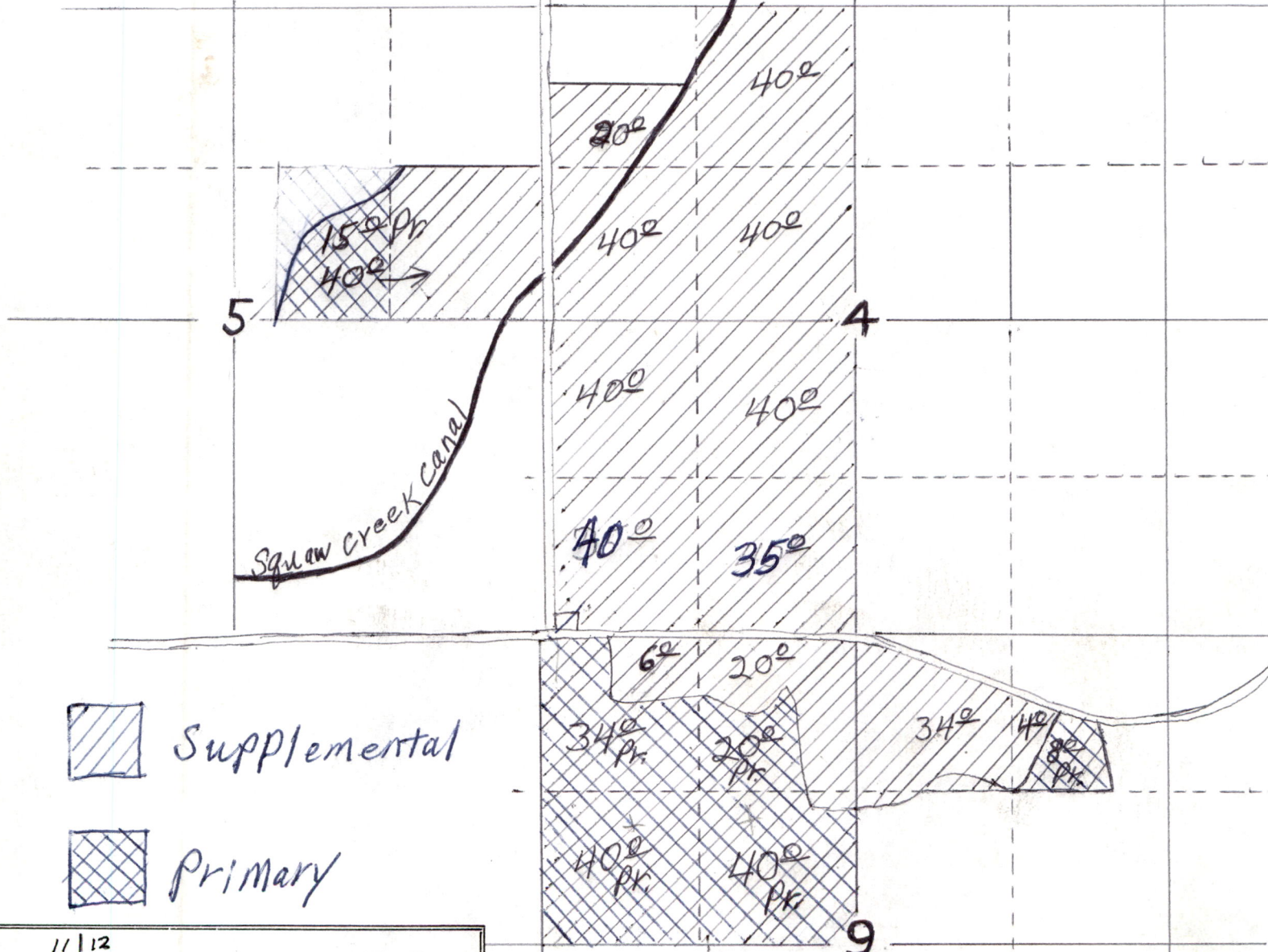

 Supplemental

 Primary

11	12
14	13

Well Located 219 ft. S. &
39 ft. E. from
the NW Corner of
Section 13, T. 15 S
R. 10 E

RECEIVED
AUG 5 1977
WATER RESOURCES DEPT.
SALEM, OREGON