

# FINAL PROOF SURVEY MAP IN THE NAME OF ALLAN B. & BEVERLY T. HASH

8

APPLICATION R-841~~18~~  
APPLICATION S-84189

PERMIT R-12871  
PERMIT 53685

SECTION 25, TOWNSHIP 24 SOUTH, RANGE 5 WEST, W.M.

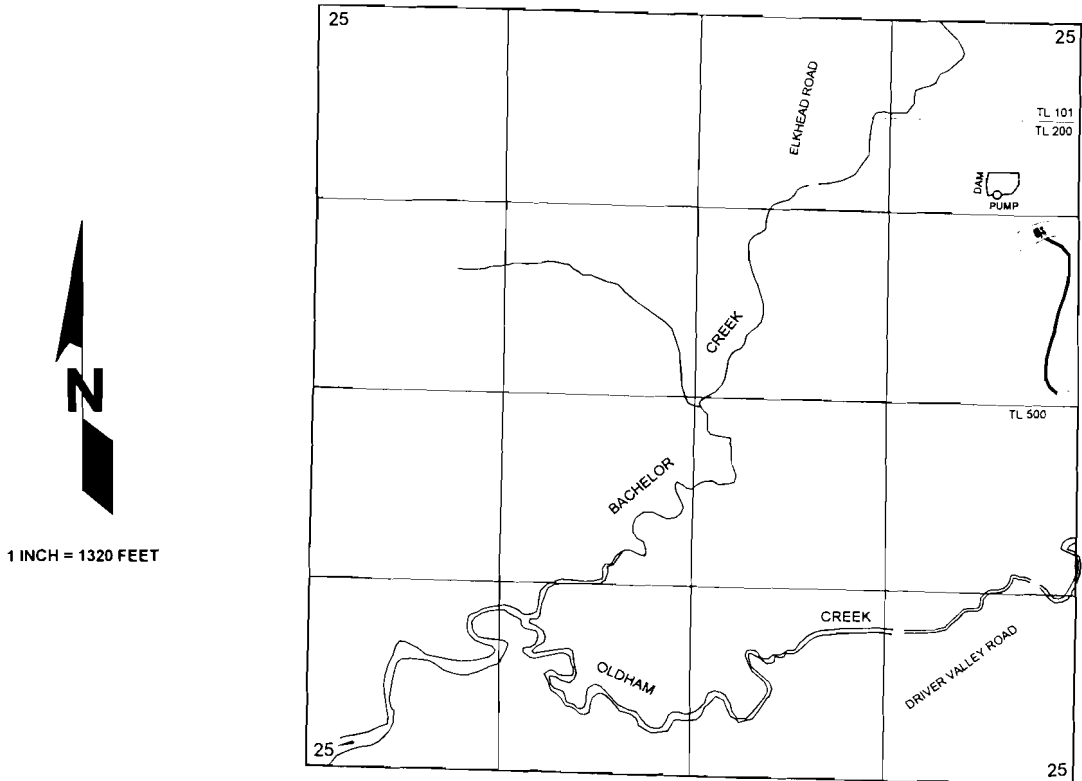

THE POINT OF DIVERSION FOR THE CENTER OF THE DAM IS LOCATED  
1095 FEET SOUTH AND 655 FEET WEST; AND

THE PUMP IN THE RESERVOIR IS LOCATED 1175 FEET SOUTH AND  
585 FEET WEST;

BOTH FROM THE NORTHEAST CORNER OF SECTION 25; BEING WITHIN  
THE NE $\frac{1}{4}$  NE $\frac{1}{4}$  OF SECTION 25, TOWNSHIP 24 SOUTH, RANGE 5 WEST, W.M.;  
DOUGLAS COUNTY.

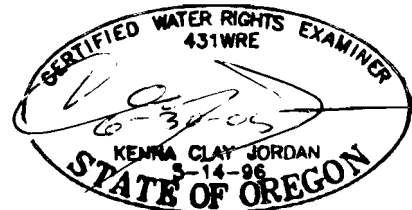

THE PURPOSE OF THIS MAP IS TO IDENTIFY THE LOCATION OF THE WATER RIGHT.  
IT IS NOT INTENDED TO PROVIDE INFORMATION RELATIVE TO THE LOCATION OF  
OWNERSHIP BOUNDARY LINES