

T7S, R4W, WM  
POLK COUNTY

FILED

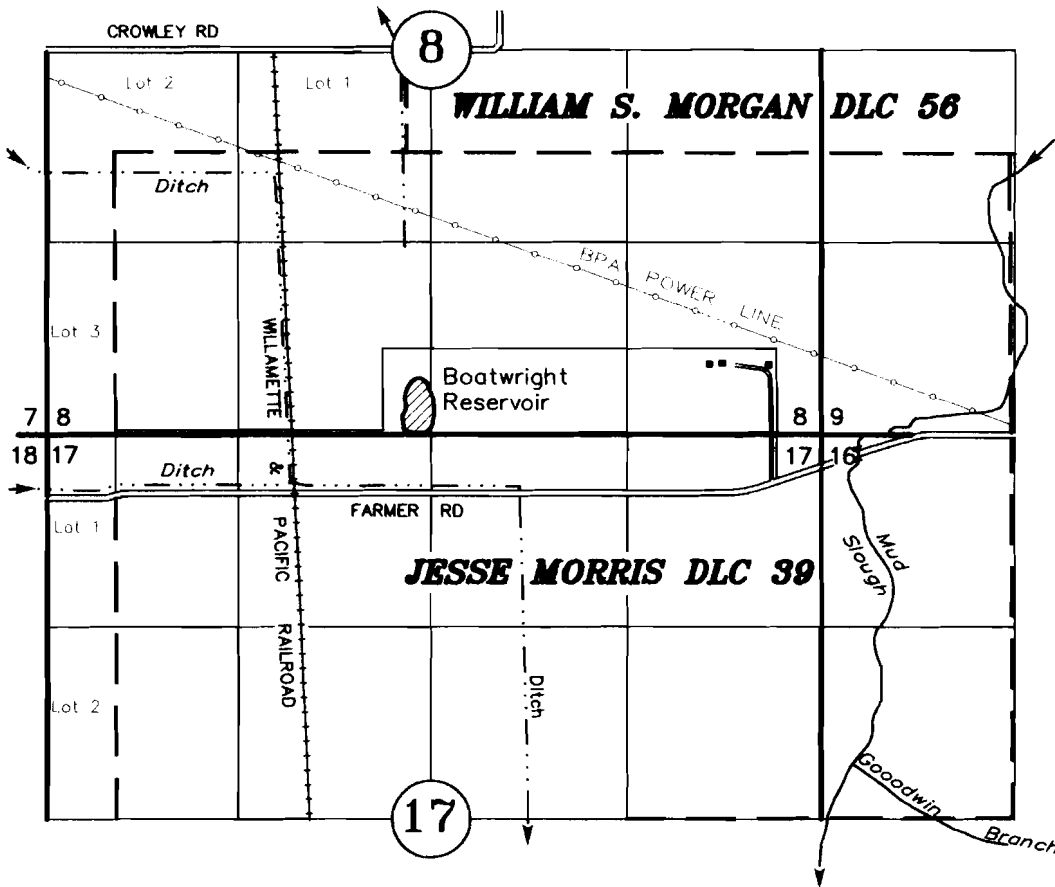

POND LOCATION: 1715' South and 4020' East of NE Corner of Jesse Morris  
DLC 39 as projected in Section 8.

# FINAL PROOF SURVEY

UNDER

Application No. R-84236 Permit No. R-12843

## Martin G. & Margaret D. Boatwright

AUGUST 05, 2003  
SCALE 1" = 1320'

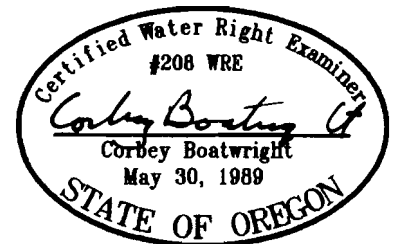

NOTE: This map is not intended to provide legal dimensions or location of property ownership lines.

EXPIRES 12-31-2005