





Section 19, T1S, R3E, W.M.
Multnomah County, Oregon

FEB 16 2024

OWRD

CLAIM OF BENEFICIAL USE MAP
Transfer T-13272

LEGEND

-  Tax Lot Line
-  Section Line
-  Quarter Section Line
-  Stream
-  Section Quarter

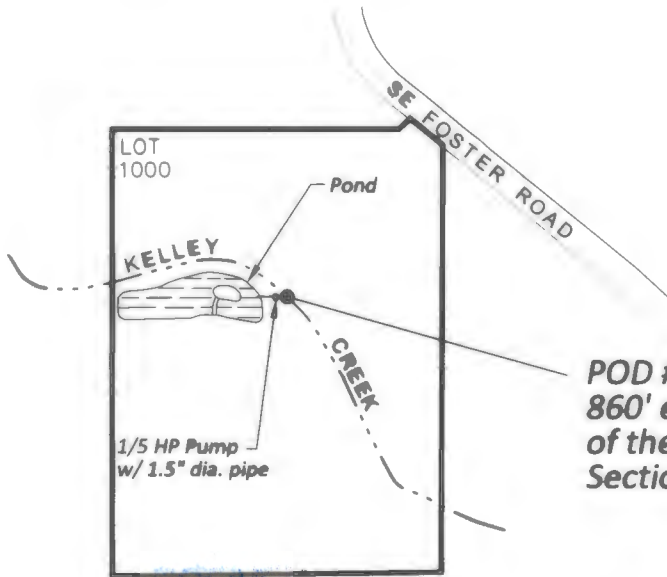
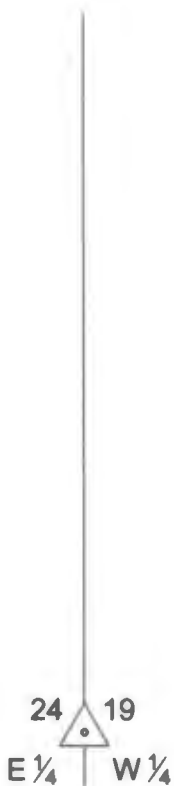

POD #2 - w/ Fish Screen
860' east and 660' north
of the west quarter of
Section 19

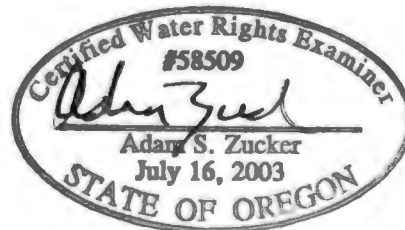

Expiration Date: 6-30-2024

This map is not intended to provide legal
dimensions of locations of property
ownership lines.



4014 SE Ankeny Street • Portland, Oregon 97214
ph: 503-956-3473 • adam@zuckerengineering.com

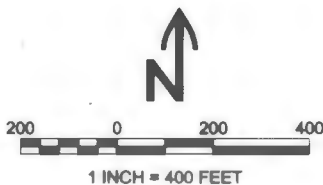

December 2023