

SECTION 2, T2S, R1E, W1M
CLACKAMAS COUNTY, OREGON
BLOW UP of PORTION of PROPERTY TO BE IRRIGATED

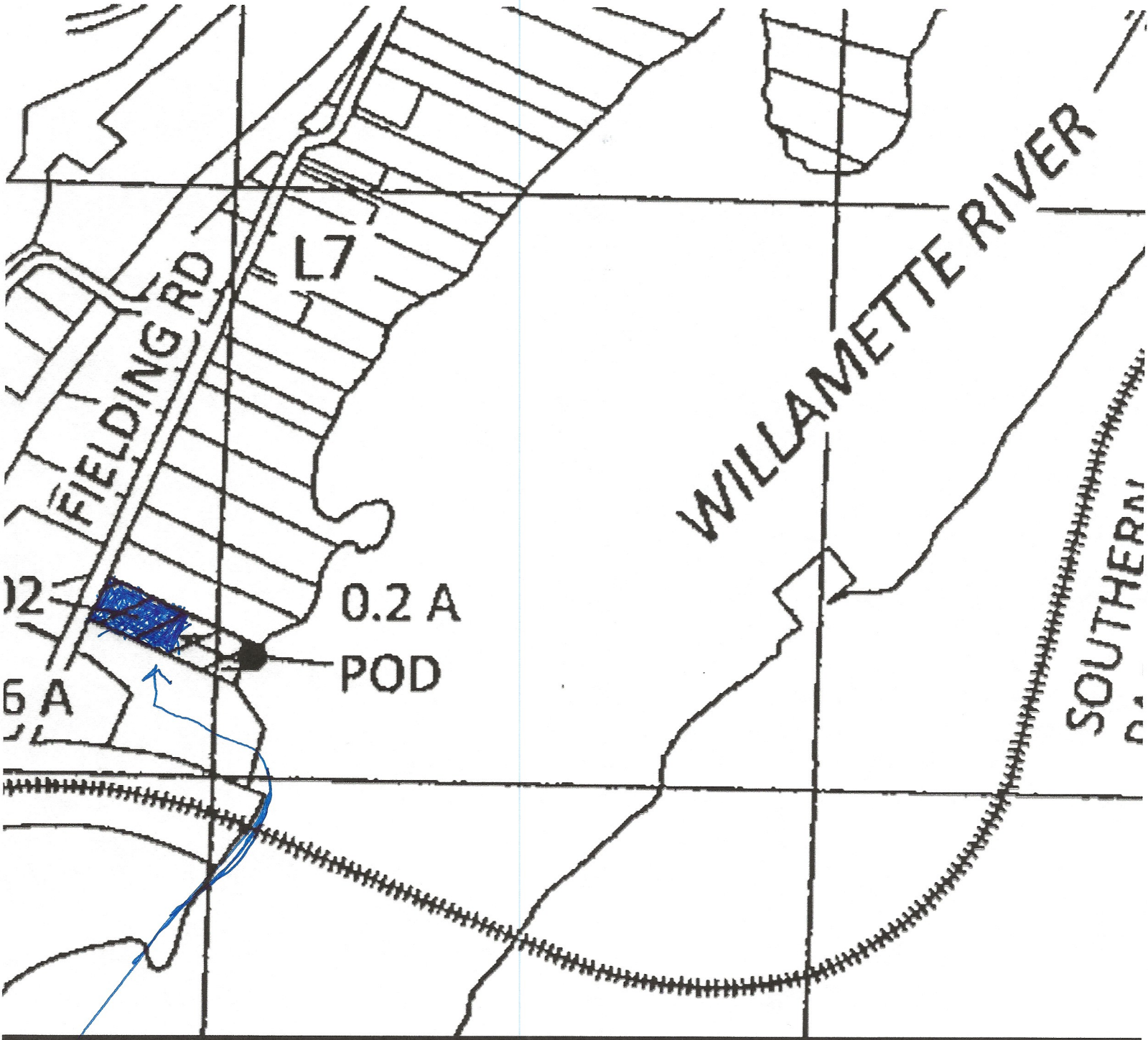

1 of 1

Subject: RE: Surface Water Rights Permit Application S-89357

PORTION of LOT 802 TO BE IRRIGATED
APPROXIMATE AREA .3 ACRES

E-RECEIVED
FEB 22, 2024
OWRD

Section 2, T2S, R1E, W.M.,
Clackamas County, Oregon

SURFACE WATER APPLICATION MAP
John Ward

E-RECEIVED
FEB 22, 2024
OWRD

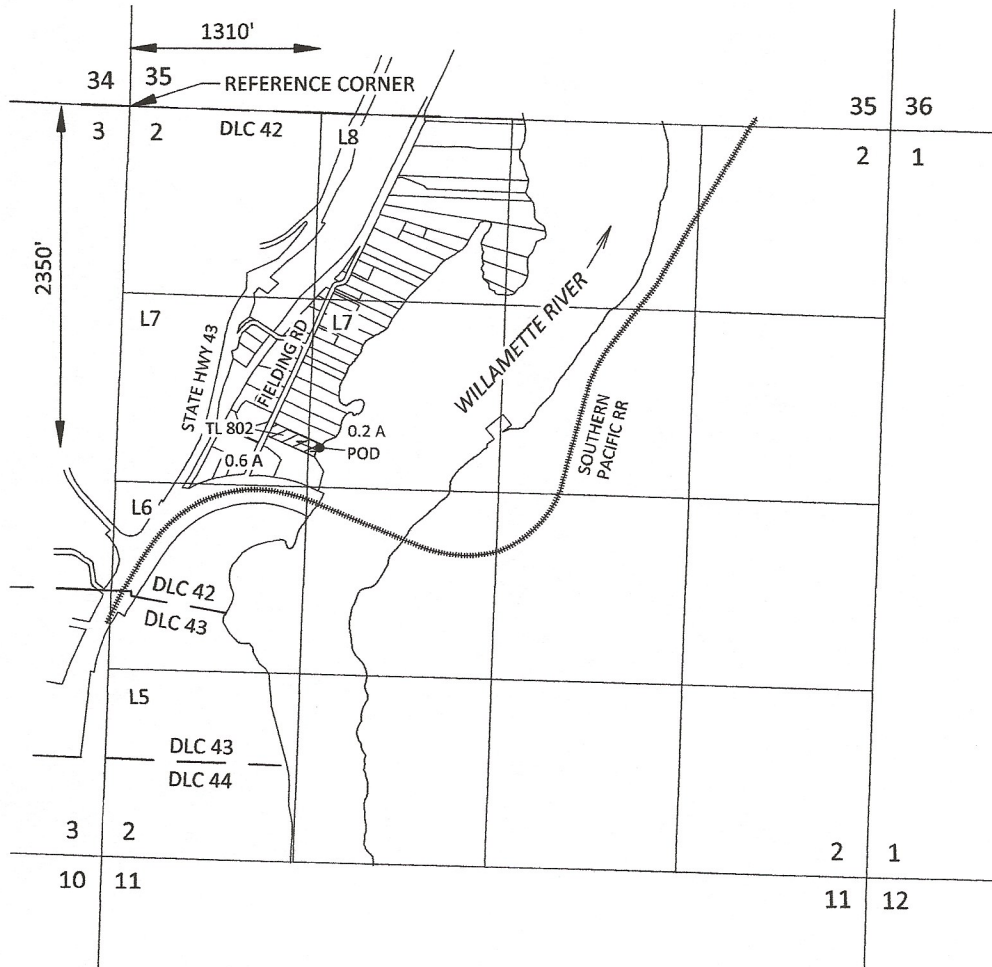

POD is located 2350 feet south & 1310 feet east of the NW corner of Section 2, T2S, R1E, W.M.*

* Distances based on cardinal directions from reference corner as required by the Certificate Section.

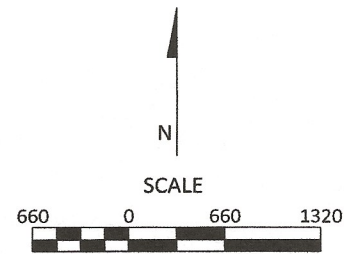



April 6, 2023



111 SW Fifth Ave., Suite 2400
Portland, OR 97204
O: 503.227.3251
F: 503.274.4681
www.kpff.com

EXPLANATION

-  PROPOSED PLACE OF USE IRRIGATION - ~~0.5 ACRES~~ **0.3 ACRES**
-  POD
-  PIPE **SEE ATTACHED**

This map is not intended to provide legal dimensions or locations of property ownership lines

Figure 1