

FINAL PROOF SURVEY

SITUATED IN THE SE1/4 NE1/4 OF SECTION 17,
T31S, R7EWM, KLAMATH COUNTY, OREGON
SURVEYED: SEPTEMBER 22, 1999

APPLICATION # R-7199B

PERMIT #12093

MAP PREPARED FOR
--CHARLES AND EUNICE SHORT--

MAP PREPARED FROM
--APPLICATION MAP--
--ASSESSORS MAP--
--FIELD SURVEY--

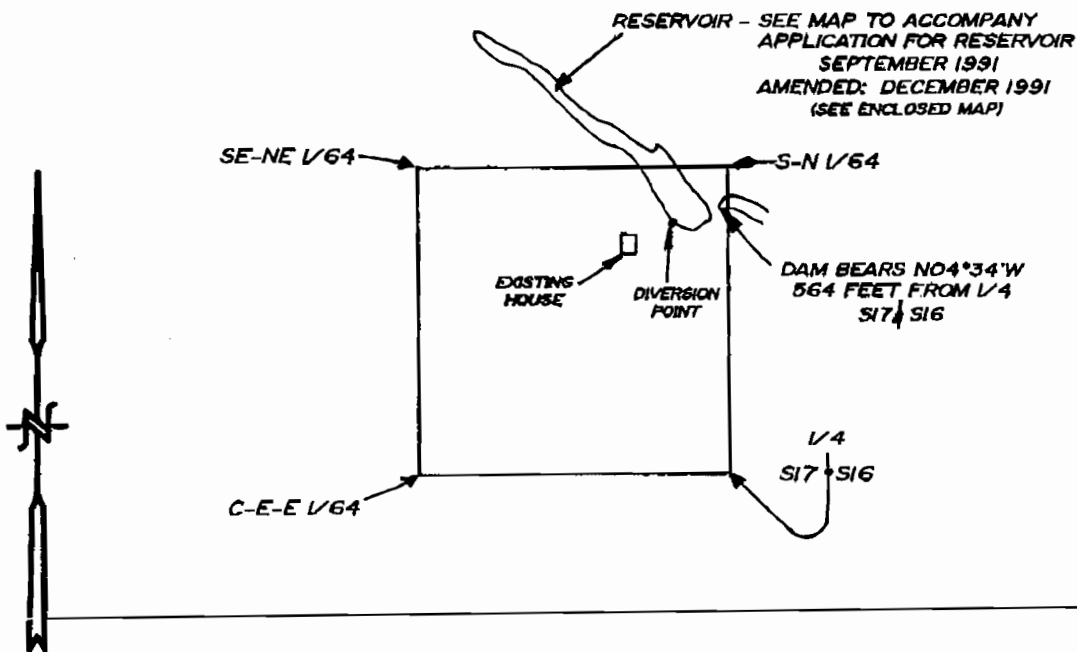

SCALE
1" = 400'

LOCATION OF POINT OF DIVERSION FOR
APPLICATION #S-72070, PERMIT #022912
530 FEET NORTH AND 110 FEET WEST
OF THE 1/4 S17 AND S16

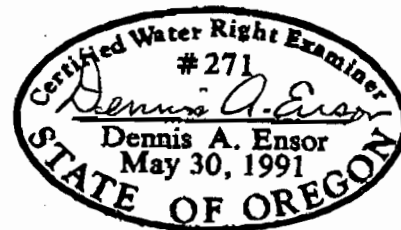

THE PURPOSE OF THIS MAP IS TO IDENTIFY THE LOCATION OF THE WATER RIGHT. IT IS NOT INTENDED TO PROVIDE INFORMATION RELATIVE TO THE LOCATION OF PROPERTY OWNERSHIP BOUNDARY LINES.

TRU-LINE SURVEYING, INC.
2333 SUMMERS LANE
KLAMATH FALLS, OREGON 97603