

# Townships 5 & 6 South, Range 1 West, W.M.

Portions of Sections 33, 34 & 35 in Township 5 South  
& Sections 2 & 3 & the East 1/2 of Section 4 in Township 6 South

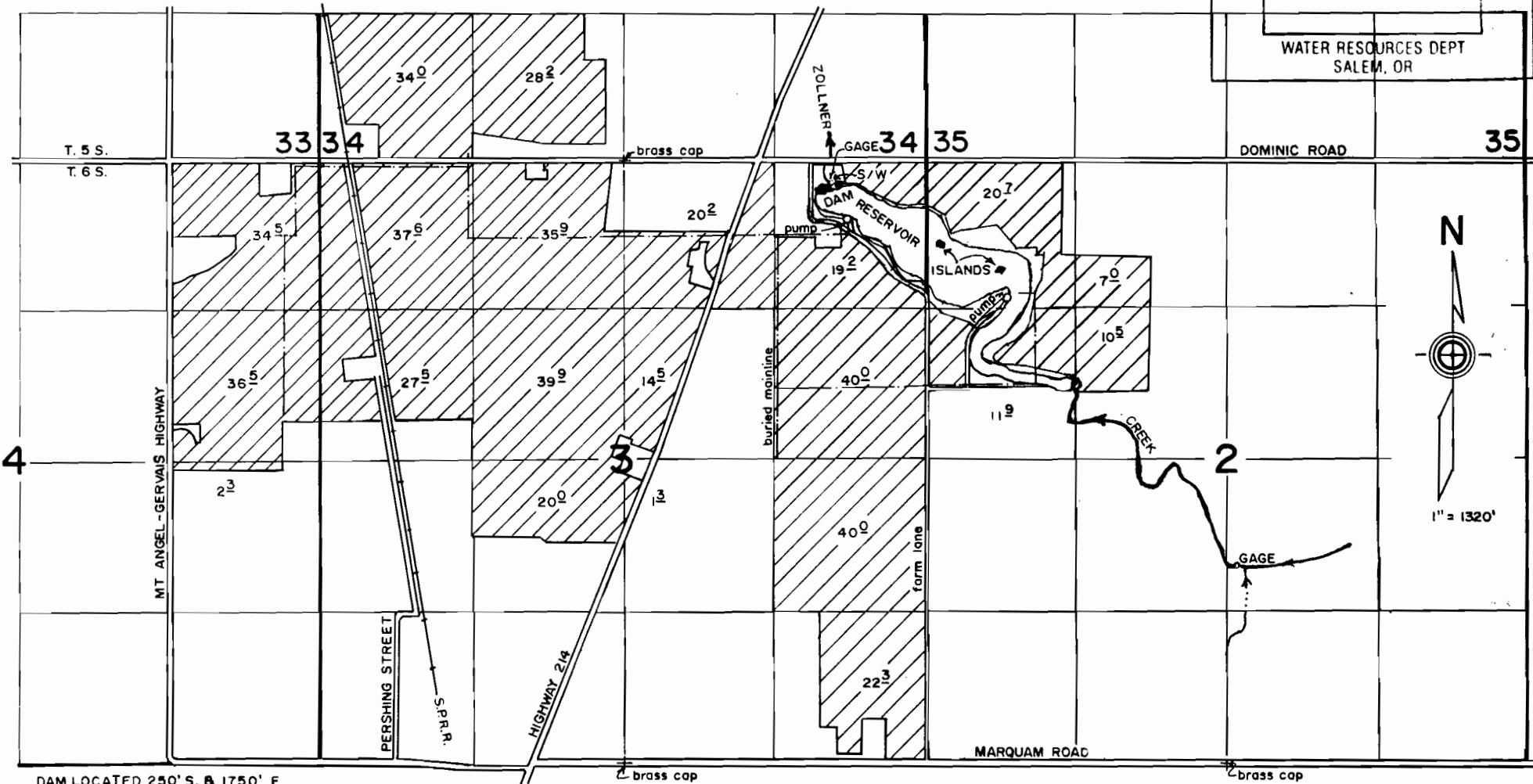
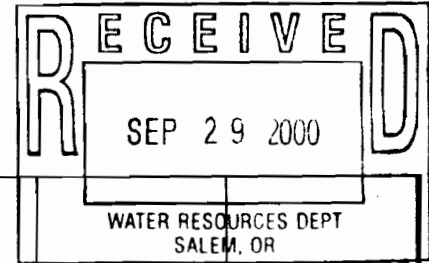

DAM LOCATED 250' S. & 1750' E.  
PUMPS LOCATED: 520' S. & 1950' E. and 1210' S. & 3370' E.  
ALL FROM N. 1/4 COR. SEC. 3.

## FINAL PROOF SURVEY under

Appl. No. 72037, Per. No. 52836  
R-72038 R-12051

in name of  
**KRAEMER FARMS**

Sep. 25, 2000

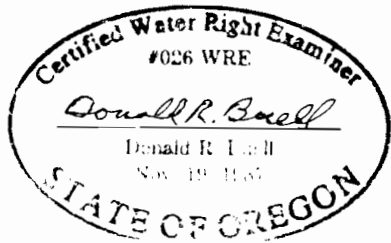

THIS MAP WAS PREPARED FOR THE PURPOSE OF IDENTIFYING THE LOCATION OF A WATER RIGHT ONLY AND IS NOT INTENDED TO PROVIDE LEGAL DIMENSIONS OR LOCATION OF PROPERTY OWNERSHIP LINES.