

**Pan-American Berry Growers
Transfers T-11434
T6S, R2W, Sections 32-33**

Certified Water Rights Examiner
#71101
RLJ
Robert E. Long Jr.
May 15, 2002
STATE OF OREGON
EXPIRATION DATE: 12-31-2021

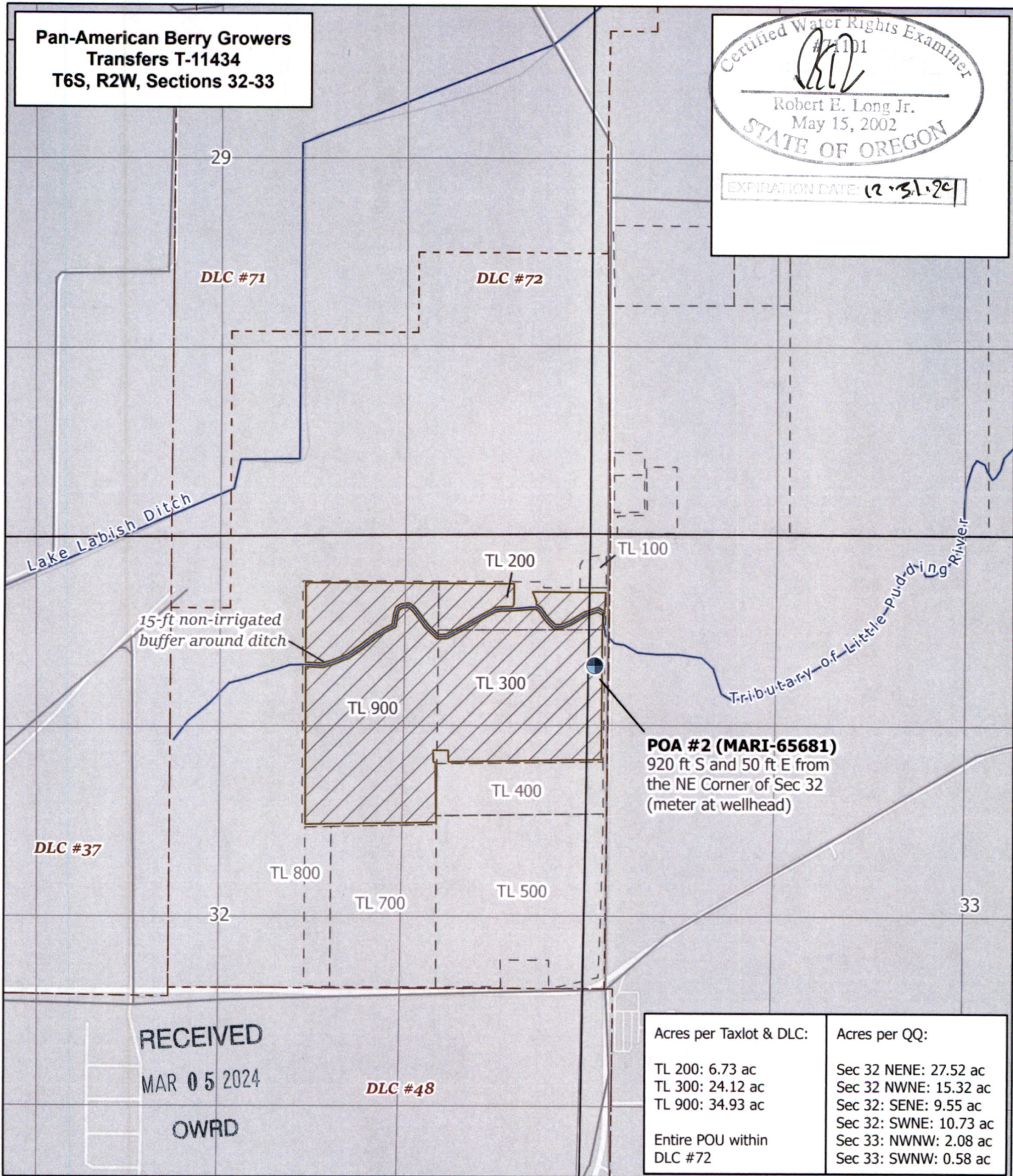

RECEIVED
MAR 05 2024
OWRD

Acres per Taxlot & DLC:	Acres per QQ:
TL 200: 6.73 ac	Sec 32 NENE: 27.52 ac
TL 300: 24.12 ac	Sec 32 NWNE: 15.32 ac
TL 900: 34.93 ac	Sec 32: SENE: 9.55 ac
Entire POU within DLC #72	Sec 32: SWNE: 10.73 ac
	Sec 33: NWNW: 2.08 ac
	Sec 33: SWNW: 0.58 ac



311 B Avenue, Suite P
Lake Oswego, Oregon 97034
(503) 954-1326

This map is not intended to provide legal dimensions or locations of property ownership lines.

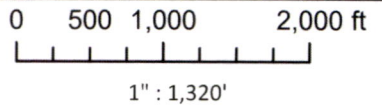

No.	Date	By	Revisions
1			DRAFT

Proj#: 2311001
Pan-America
Pan-American Berry Growers
6826 55th Avenue NE
Salem, OR 97035

