

T.29&30S., R.5W., W.M.

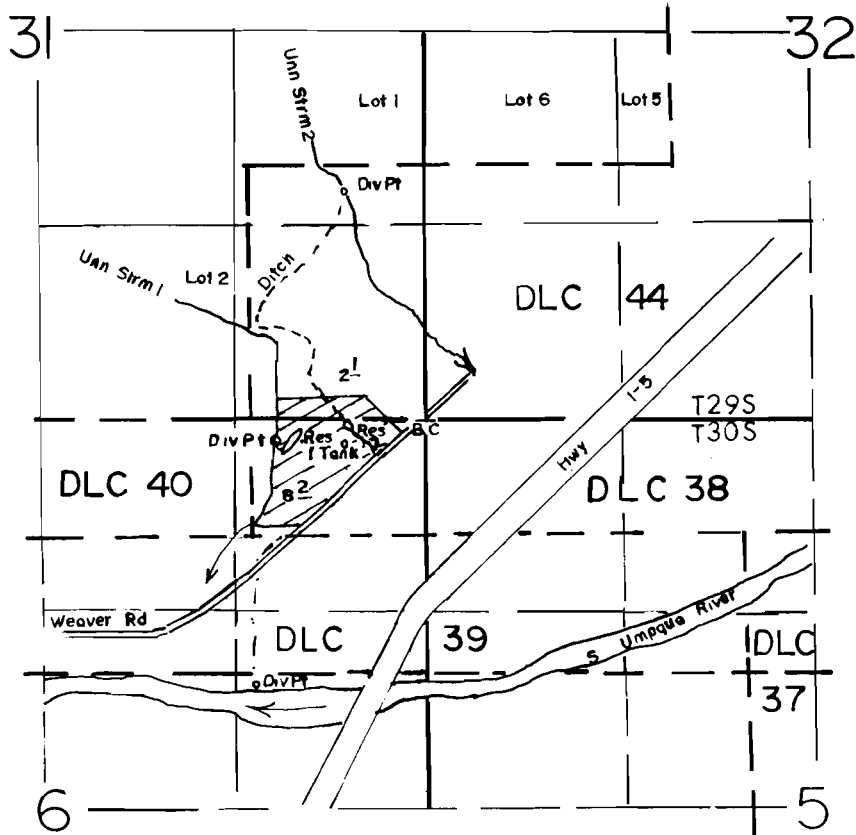

Div Pts Loc-Stream 1, 150'S 81050'W, Stream 2, 1550'N 8 550W, River-1900'S 81150'W All From The NE Corner Of Section 6

SCALE: 1"=1320'

FINAL PROOF SURVEY
UNDER

R-62121 R-8401
Application No. 62122.. Permit No. 46680.....
IN NAME OF

Darrell Henry Green

Surveyed APRIL 24, 1990., by B.S. JAMES.....