





AFFIDAVIT OF WITNESSES

We, \_\_\_\_\_, and \_\_\_\_\_,  
of \_\_\_\_\_, being first duly sworn, depose and say that  
we are well acquainted with the facts and conditions set forth in the foregoing statement relative  
to proof of appropriation of water under Permit No. ....; that we and each of us have  
been over and upon each tract described in said proof, and from such personal inspection have  
knowledge that all necessary ditches, dams and other diversion and distributing works have been  
constructed, and water used as stated therein; that we have carefully read such proof of appropria-  
tion, and that each and every statement contained therein is true to the best of our knowledge  
and belief.

\_\_\_\_\_  
\_\_\_\_\_

Subscribed and sworn to before me this \_\_\_\_\_ day of \_\_\_\_\_, 192\_\_\_\_\_.

(Notarial Seal)

\_\_\_\_\_  
Notary Public for Oregon

My commission expires \_\_\_\_\_

.....I inspected the above right on November 23rd and.....  
found that the applicant had complied with the terms of his permit;  
had constructed his dam and ditches, and would recommend that he  
be granted a certificate.....

\_\_\_\_\_  
\_\_\_\_\_  
\_\_\_\_\_  
\_\_\_\_\_

*M. L. Opedyke*

8. During what months is water beneficially used? May to October inclusive
9. State the character of the soil and kind of crops raised Pasture, grain, garden.  
Red loam;
10. Does the accompanying blue print of the map filed with your permit show correctly the location of diverting works and area of land where water is used? Yes
11. If not, wherein such map is in error
12. If the dimensions of your ditch or dam do not correspond to those described in your permit, state what changes have been made, giving dimensions of ditch (or other distributing works)
13. If water is used for power, mining, domestic, municipal, storage, manufacturing, or any other purpose than irrigation, give the extent and method of such use

STATE OF OREGON,

County of Josephine } ss.

I, C. W. White, being first duly sworn, depose and say that I have read the above and foregoing proof of appropriation of water; that I know the contents thereof; and that the facts therein stated are true.

IN WITNESS WHEREOF, I have hereunto set my hand this 23<sup>d</sup> day of November, 1924.

C. W. White

Subscribed and sworn to before me this 23 day of November, 1924.

E. A. Messenger  
Notary Public for Oregon

(Notarial Seal)

My commission expires Nov 17, 1924.

PROOF OF APPROPRIATION

Permit No. 4042

Recording fee paid

Receipt No. 3507

Priority date: April 9, 1919.

OFFICE OF STATE WATER COMMISSION  
RECEIVED  
DEC 5 1921  
SALEM, OREGON.

Handwritten scribbles at the top left corner.



MLO of <sup>2010</sup> 25111  
 CHEMICALS CORPORATION  
 DORRIS

December 3, 1921.

Mr. M. L. Opdycke,  
Water Master District No. 16,  
Grants Pass, Oregon.

Dear Sir:

Proofs of appropriation of water under permits No. 4042, in the name of C. H. White and No. 4454, in the name of Louis Huff, together with the required recording fees, have been received and filed in this office.

These proofs appear to be in proper form and will be presented to the Board at its next meeting for approval and issuance of final water right certificates.

Yours very truly,

R. W. Potter,  
Secretary.

Encls.

APR 9

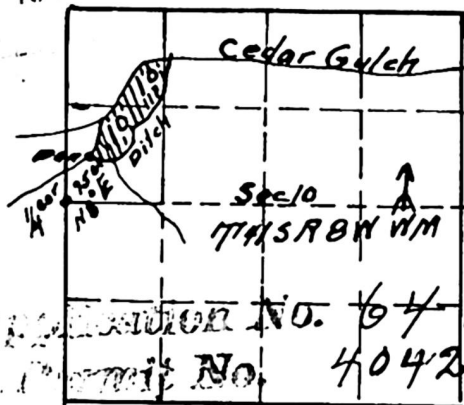

SECTION NO. 6481

TRAIL NO. 4042

Map of <sup>scale</sup> 2"=1mi  
CH White Irrigation  
Ditch



July 13, 1921.

Mr. C. H. White,

Waldo, Oregon.

Dear Sir:

Blank for proof of appropriation of water under permit No. 4042 has been mailed to Mr. M. L. Opdycke, Water Master for your district, who will make an inspection and assist you in filling out the proof at an early date.

When this proof has been properly filled out, it should be transmitted to this office, together with \$1.00 to cover recording fee for certificate of water right.

Yours very truly,

R. W. Potter,  
Secretary.

**June 6th, 1921.**

**Mr. C. H. White,  
Waldo,  
Oregon.**

**Dear Sir:**

**Permit No. 4042.**

**This will acknowledge receipt of the Notices of Completion of Construction and Complete Application of Water under your permit No. 4042, which notices have been placed on file.**

**Final proof blanks will accordingly be prepared and forwarded for execution through the Water Master of your county within a short time.**

**Very respectfully,**

**Percy A. Cupper,  
State Engineer.**

NOTICE OF BEGINNING OF CONSTRUCTION

I, C. N. White, the holder of Application No. 6481, being

White Permit No. 4047, issued by the State Engineer of the State of Oregon

(Reservoir or enlargement)

for the appropriation of 0.25 second-feet of the waters of Cedar Gulch in accordance with the tenor of such permit and the limitations indorsed thereon by the State Engineer,

began the actual construction of the works described therein on the 1st day of Oct., 1919, being within the time limitation as fixed in said permit for the beginning of construction work.

The appropriator should state the manner of beginning construction work, number of men and teams employed, the amount of work completed up to the date of this statement, and any additional information which may tend to show the beginning of work in good faith.

I am doing the work myself and as fast as I can get the time. I am on a home stead, and will get my title in a few months

IN WITNESS WHEREOF, I have hereunto set my hand this 4th day of Nov., 1919

Takilma, Or.  
(Present address)

C. N. White  
(Signature of applicant)

Fill out, detach, and mail to the Secretary, State Water Board, Salem, Oregon.

NOTICE OF COMPLETION OF CONSTRUCTION

Form B

I, C. N. White, the holder of Application No. 6481, being

New ditch Permit No. 4042, issued by the State Engineer of the State of Oregon

(Reservoir or enlargement)

for the appropriation of 1/4 second-feet of the waters of Cedar Gulch in accordance with the tenor of such permit and the limitations indorsed thereon by the State Engineer,

have completed the construction of the works described therein the 30th day of May, 1921, being within the time limitation as fixed in said permit or extended by the State Water Board for the completion of construction work.

Remarks: If the works have a less capacity than as described in the permit, or you have definitely abandoned your plan of irrigating any of the lands described

in your permit, you should so state in order that our records may not be unnecessarily encumbered.

IN WITNESS WHEREOF, I have hereunto set my hand this 2nd day of June, 1921

Mrs C. N. White  
(Present address)

C. N. White  
(Signature of applicant)

Fill out, detach, and mail to the Secretary, State Water Board, Salem, Oregon. Form D should be used in reporting progress of work if more than one year has been allowed for completion.

NOTICE OF COMPLETE APPLICATION OF WATER TO A BENEFICIAL USE

Form C

I, C. N. White, the holder of Application No. 6481, being

New ditch Permit No. 4042, issued by the State Engineer of the State of Oregon

(Reservoir or enlargement)

for the appropriation of 1/4 second-feet of the waters of Cedar Gulch in accordance with the tenor of such permit and the limitations indorsed thereon by the State Engineer,

completely applied the water to a beneficial use, on the 31st day of May, 1921, being the time limitation as fixed in said permit or extended by the State Water Board for the complete application of water to a beneficial use.

Remarks: If all the water granted in the permit had not been fully applied to beneficial use, you should so state, so that delinquent appropriators may have

notice.

IN WITNESS WHEREOF, I have hereunto set my hand this 2nd day of June, 1921

Mrs C. N. White  
(Present address)

C. N. White  
(Signature of applicant)

6481

April 25, 1919

Mr. C H White,  
Waldo, Josephine Co.,  
Oregon.

Dear Sir:- Herewith you will find Application No. 6481, being Permit No. 4042, together with map. This application has been approved and recorded in this office.

App. No. 6481.

April 10, 1919.

Mr. C. H. White,

Waldo, Oregon.

Dear Sir:

Inclosed please find my official receipt No. 6569 for \$6.00 which amount was transmitted with your application for a permit to appropriate water. I am also in receipt of map and tracing.

This application has been numbered 6481 and placed on file in this office and will be taken up for approval as soon as the same can be reached, and you will be further advised.

Very respectfully,

Enc.  
RJC/HC.

Percy A. Cupper,  
State Engineer.