

FINAL PROOF SURVEY MAP

IN THE NAME OF DELMER C. AND SUSAN M. ROBISON

APPLICATION R-72157
S-72158

PERMIT R-12003
52842

SECTION 12, TOWNSHIP 30 SOUTH, RANGE 15 WEST, W.M.

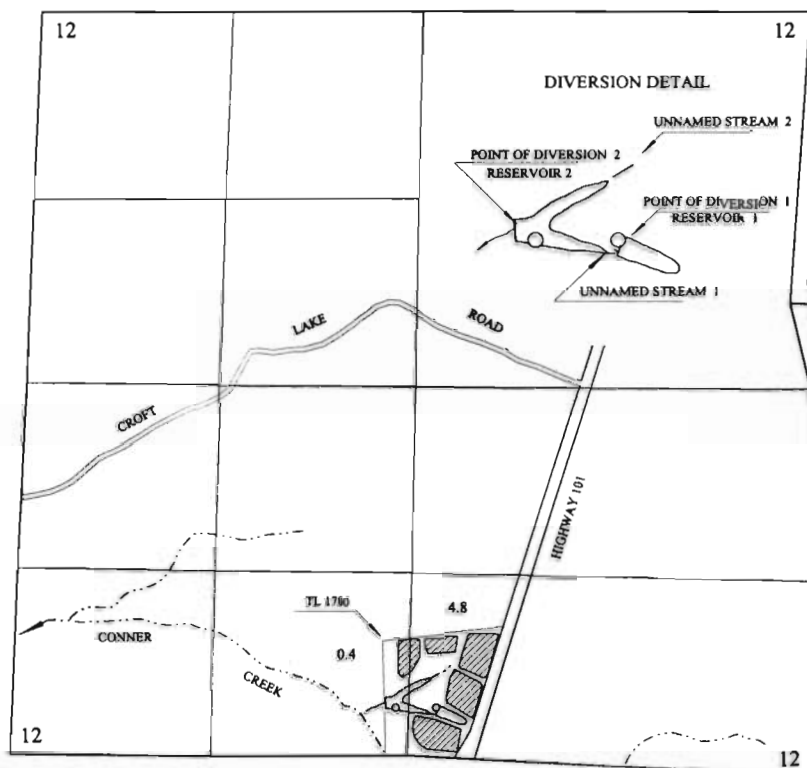

POINT OF DIVERSION No. 1 IS 310 FEET NORTH AND 200 FEET EAST WITHIN THE SW ¼ SE¼ AND POINT OF DIVERSION No. 2 IS LOCATED 330 FEET NORTH AND 80 FEET WEST WITHIN THE SE¼SW¼; BOTH FROM THE SOUTH QUARTER CORNER OF SECTION 12; WITHIN SECTION 12, TOWNSHIP 30 SOUTH, RANGE 15 WEST, W.M.; COOS COUNTY.

RECEIVED

SEP 14 2000

WATER RESOURCES DEPT.
SALEM, OREGON

