

T.10S. R.27E. Sec. 24 & 25, W.M.

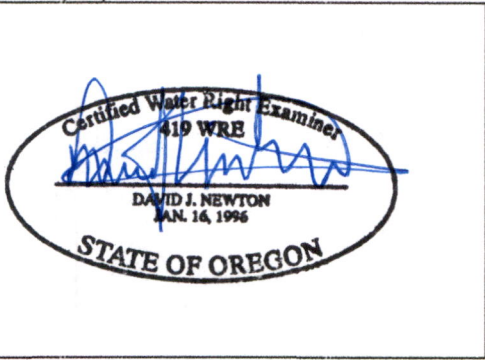
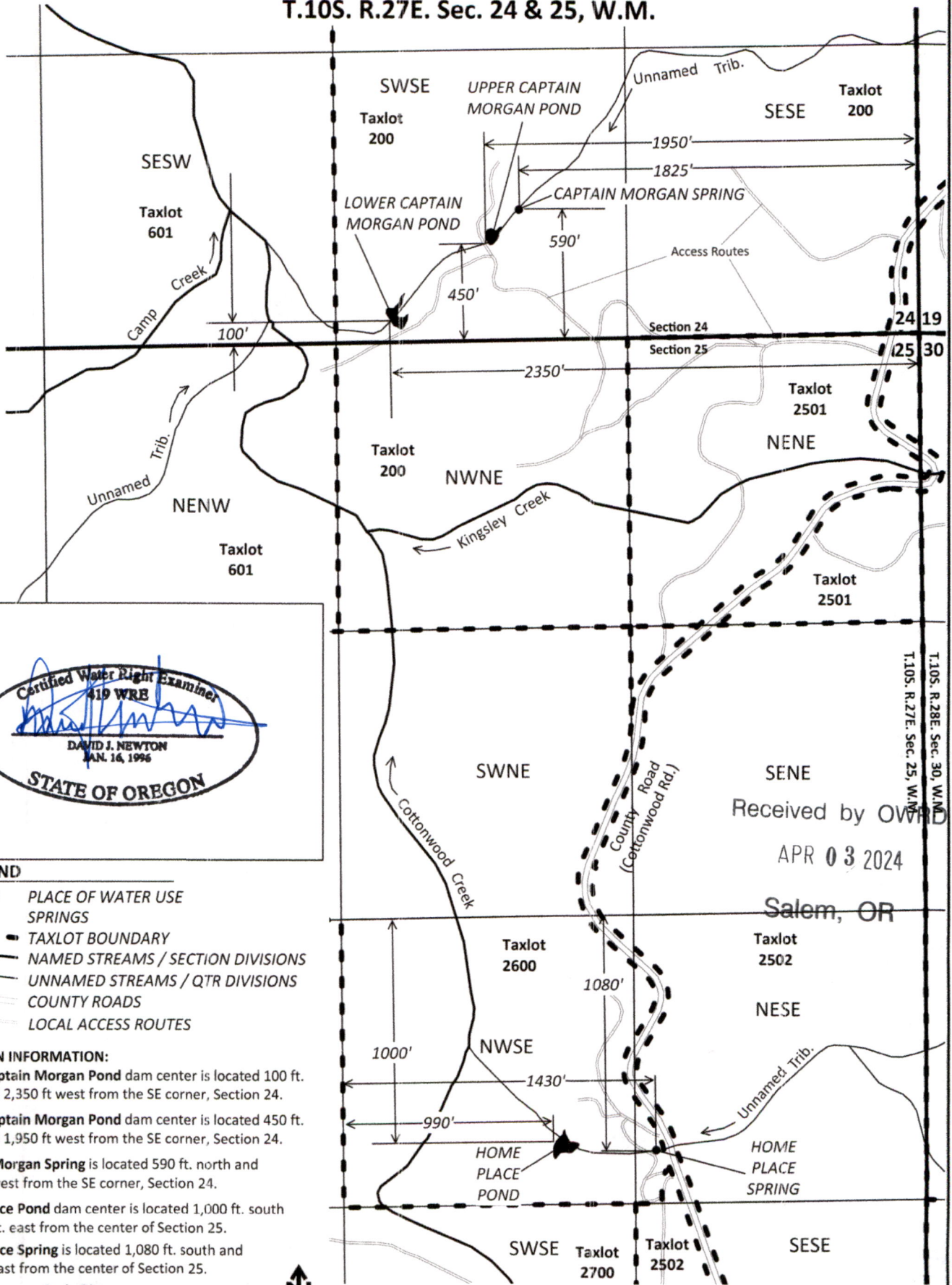

- LEGEND**
- PLACE OF WATER USE
 - SPRINGS
 - TAXLOT BOUNDARY
 - NAMED STREAMS / SECTION DIVISIONS
 - UNNAMED STREAMS / QTR DIVISIONS
 - COUNTY ROADS
 - LOCAL ACCESS ROUTES

LOCATION INFORMATION:

Lower Captain Morgan Pond dam center is located 100 ft. north and 2,350 ft. west from the SE corner, Section 24.

Upper Captain Morgan Pond dam center is located 450 ft. north and 1,950 ft. west from the SE corner, Section 24.

Captain Morgan Spring is located 590 ft. north and 1,825 ft. west from the SE corner, Section 24.

Home Place Pond dam center is located 1,000 ft. south and 990 ft. east from the center of Section 25.

Home Place Spring is located 1,080 ft. south and 1,430 ft. east from the center of Section 25.

All distances are Scale Distances.

SCALE 1" = 600'

0 ft 300 ft 600 ft

This map was prepared for the purpose of identifying the location of a water right only and is not intended to provide legal dimensions or location of property ownership lines.

Received by OWRD
 APR 03 2024
 Salem, OR