

Location: SE1/4 SE1/4, Section 21,  
T. 4 S., R. 4 W., WM, Yamhill Co., OR

Tax Lot: 4421DD 1400,1900

Scale : 1" = 400'

Deed recorded in Film Volume 251 Page 2050

JAN 29

SALEM OREGON

North

LEGEND:

- - - - - = section subdivision line
- . . . — = property line

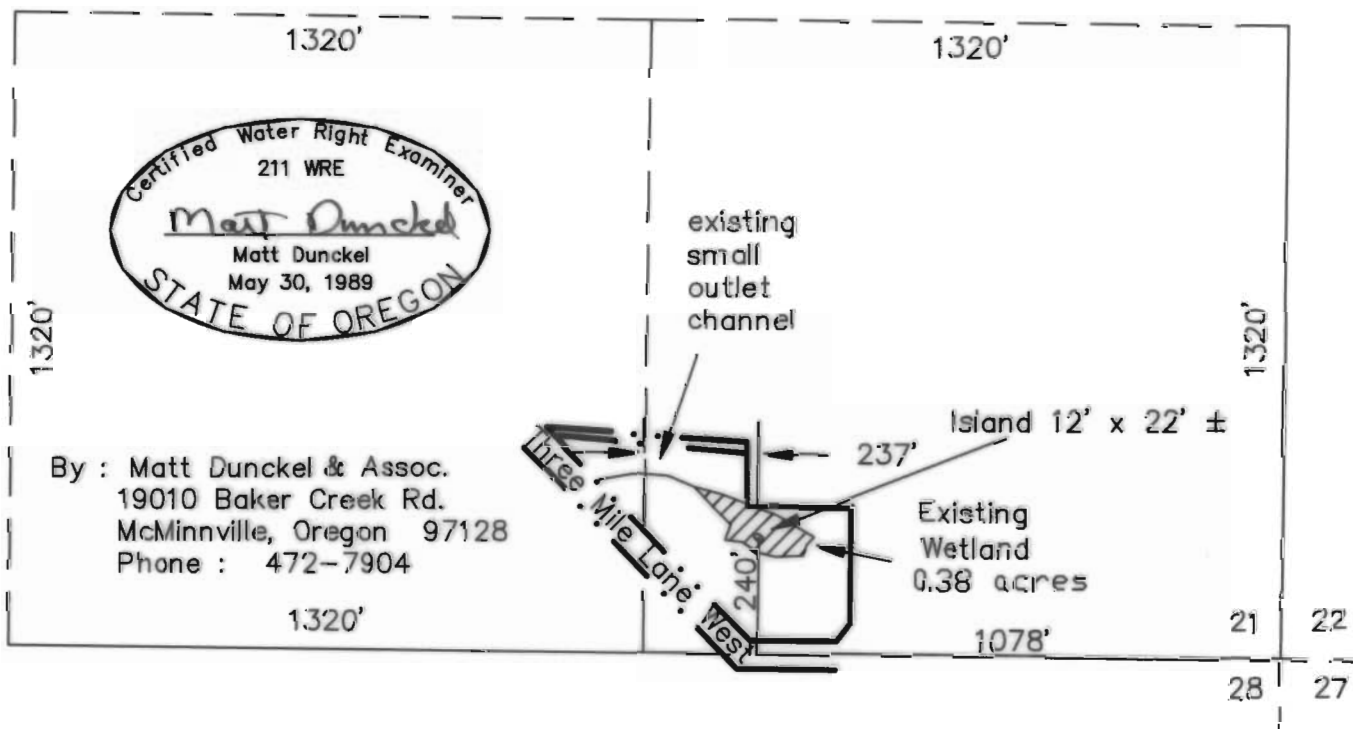

# FINAL PROOF SURVEY

UNDER

Application No. R-72246 Permit No. R-11467

IN NAME OF

## John Hitchcock

Surveyed Dec. 12, 1992