

SUNRISE PARKWAY LLC  
POB 1269  
SHADY COVE, OR 97539

SUNRISE POND  
CLAIM OF BENEFICIAL USE

APPLICATION NO. R-88479  
PERMIT R-15393

SECTION 28  
T35S R1W, W.M.  
JACKSON COUNTY

● R-15393 POD and METER  
935' NORTH and 700' WEST  
FROM SE CORNER  
SECTION 28, T35S R1W

■ SUNRISE POND PERMIT AREA  
SOURCE - RUNOFF TRIBUTARY  
TO LITTLE BUTTE CREEK

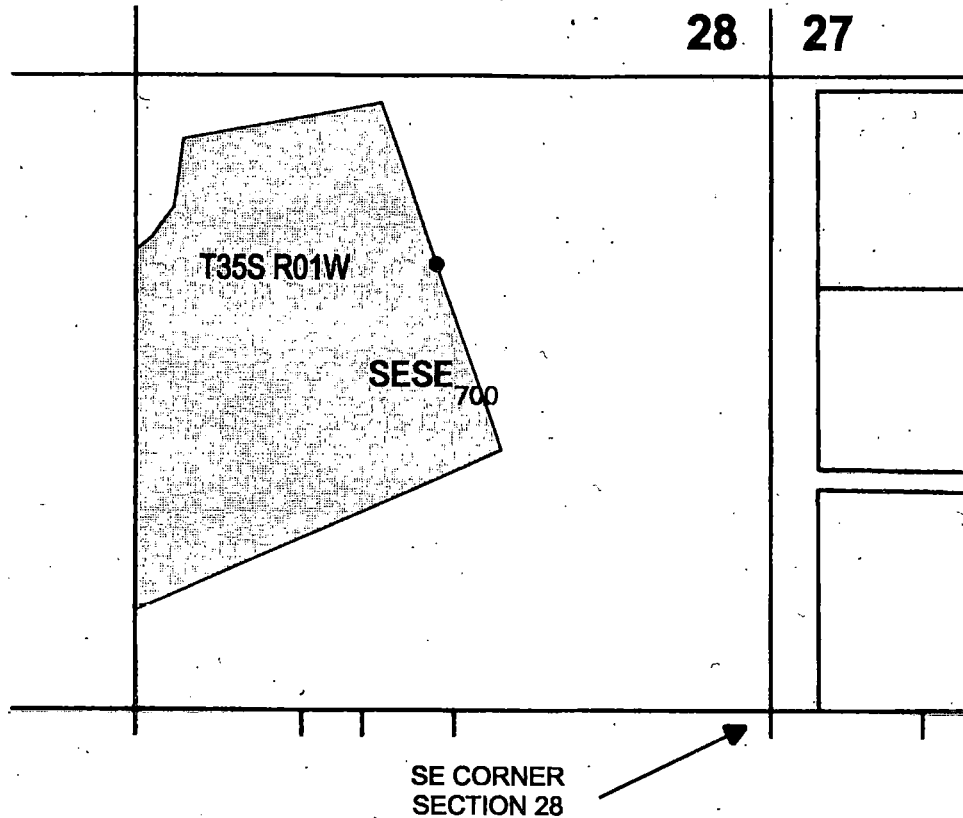

Received  
APR 08 2024  
OWRD

CERTIFIED WATER RIGHT EXAMINER  
91298CWRE  
*Richard F. Parsons*  
RICHARD F. PARSONS  
JULY 10, 2018  
STATE OF OREGON

0 400 ft



This map is not intended to provide  
legal dimensions or locations of  
property ownership lines

ParsonsWater Consulting LLC  
rick.parsons@parsonwater.com  
541.499.0257 303.667.5067

