

STATE OF OREGON
Water Resources Department
725 Summer St. N.E.
Salem, OR 97301

MEMORANDUM

DATE: 11/29/2022

TO: Mary Bjork, Water Rights Program Analyst; Justin Iverson, GW Section Manager
FROM: Gabriela Ferreira and Dennis Orłowski, Hydrogeologists
SUBJECT: Application G- 16209 Permit G- 17080
Information to Assess Permit Renewal Request

Location: T 2 S/ R 2 W- S 36
GW Limited Area Chehalem Mountain Groundwater Limited Area (GWLA)
Permittee: Countryside Community Church
Use: Irrigation use on 0.941 acres, April 1 through October 15
Priority Date: March 12, 2004
Permit History:

Document/Permit	Date Issued	Date Expired
G-15789 EX	12/9/2004	12/9/2009
G-17080 EX	8/8/2013	10/31/2014

Q: 0.01 cfs
Well Logs: WASH 59308
Decline Triggers: “Use of water from the well, as allowed herein, shall be controlled or shut off if the well displays: (a) An average water level decline of three or more feet per year for five consecutive years; or (b) A total water level decline of fifteen or more feet; or (c) A hydraulic interference decline of fifteen or more feet in any neighboring well providing water for senior exempt uses or wells covered by prior rights.”
Renewal Criteria: “The Director finds the groundwater resource can probably support the extended use.”
Pump Test: Not required per permit G-16209
Long-term supply plan: Not required per permit G-16209
Water Use Rptg: Submitted from water years 2013 through 2016.
COBU: Received by the department December 4, 2013.
Water Level Rptg: Yes. Permittee is required to submit a March water level each year; current through 2022 (see attached hydrograph for WASH 59308).
Ref. Water Level: 38.40 ft bls (first March measurement in 2005 as stated in permit G-16209).
SWL Data: See attached hydrograph for WASH 59308.

Comments

TRIGGERS. No triggers have been exceeded since the last permit renewal in 2013.

The data show very stable groundwater levels over the past ~15 years with less than 5 feet of fluctuation year-to-year.

RECOVERY FROM TRIGGER LEVELS. This is not a current issue.

AREA WATER LEVEL BEHAVIOR. Nearby wells show generally stable water levels (see attached hydrograph for nearby observation wells). WASH 1823 shows a decline of 50 feet from the 1960's through the early 2000's. Water level data from nearby wells in more recent years, however, show generally stable water levels. Groundwater data from the permitted well (WASH 59308) show very stable levels over 15 years.

PERMIT RENEWAL. The groundwater resource can probably support the extended use.

The Groundwater Section finds that renewal criteria for permit G-17080 have been satisfied.

If renewed by the Water Rights Section, it is requested that the renewal for application G-16209/permit G-17080 include an **expiration date of October 31, 2028**. The Groundwater Section proposes that, to the extent possible, all time-limited permits within a particular GWLA possess the same expiration date. The goal for synchronizing expiration dates will be to streamline future groundwater technical reviews by allowing them to be done concurrently for a particular GWLA.

Area Map

Permit G-17080 EX, Renewal Review
 Countryside Community Church
 T2S/R2W, Section 36

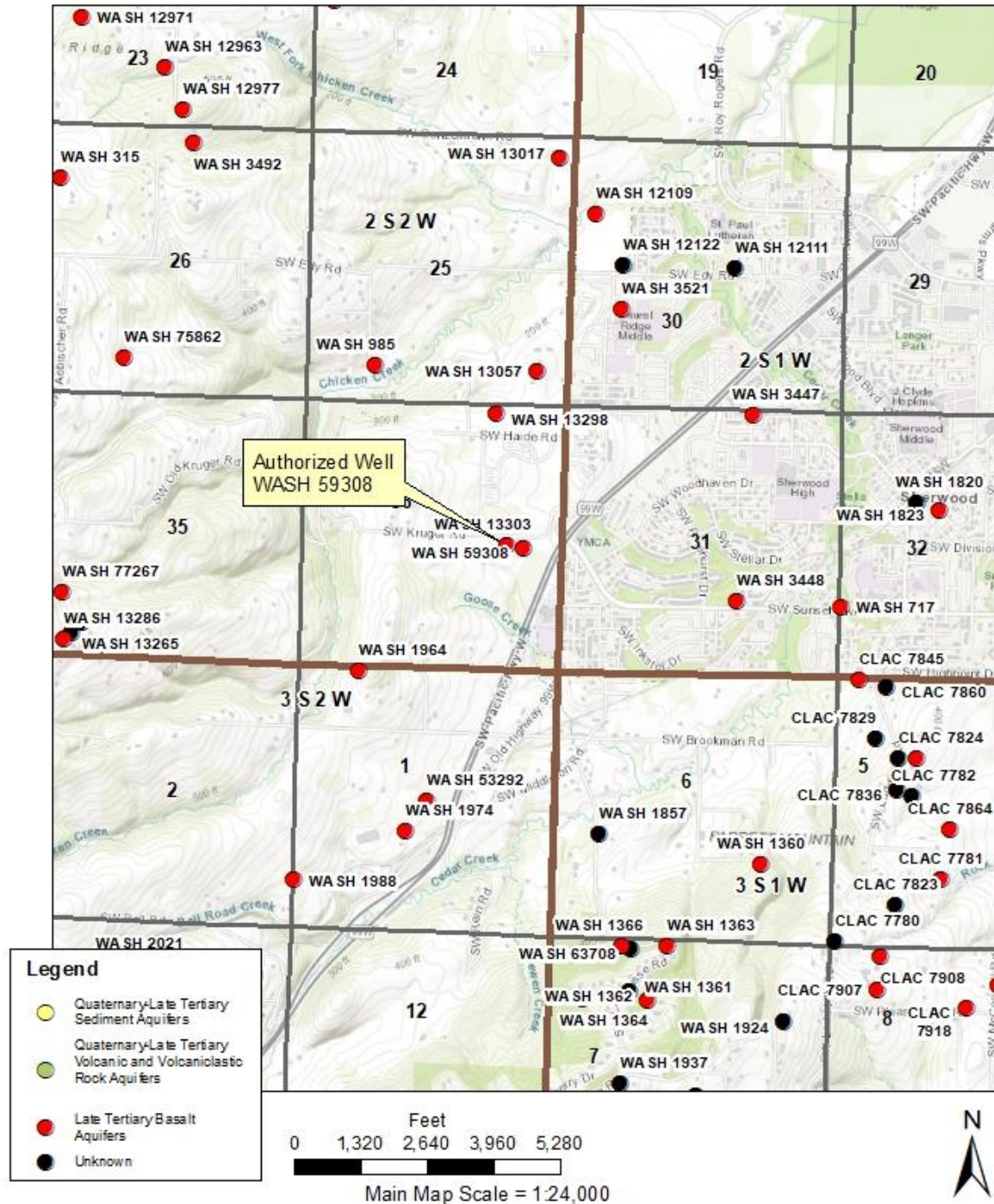

Service Layer Credits: Sources: Esri, HERE, Garmin, Intermap, increment P Corp., GEBCO, USGS, FAO, NPS, NRCAN, GeoBase, IGN, Kadaster NL, Ordnance Survey, Esri Japan, METI, Esri China (Hong Kong), (c) OpenStreetMap contributors, and the GIS User Community

Water Use Report

Water Use Report Based on Water Right

Permit: G 17080 EX
 COUNTRYSIDE COMMUNITY CHURCH 18810 SW KRUGER RD SHERWOOD, OR
 97140

Records per page: [View All](#)

Water Year*	Report ID	Facility	Acre-feet (AF) of Water Used												Total Water Used	Irrigated Acres
			Oct	Nov	Dec	Jan	Feb	Mar	Apr	May	Jun	Jul	Aug	Sep		
2016	62939	A WELL (WASH 59308/L-64131)	0.00	0.00	0.00	0.00	0.00	0.00	0.00	0.00	0.00	0.00	0.01	0.00	0.01	0.92
2015	62939	A WELL (WASH 59308/L-64131)	0.00	0.00	0.00	0.00	0.00	0.00	0.00	0.00	0.00	0.00	0.00	0.00	0.03	0.92
2014	62939	A WELL (WASH 59308/L-64131)	0.00	0.00	0.00	0.00	0.00	0.00	0.00	0.00	0.00	0.00	0.00	0.00	0.02	0.92
2013	62939	A WELL (WASH 59308/L-64131)				0.00	0.00	0.00	0.00	0.00	0.00	0.00	0.00	0.02	0.92	

*The water year is named for the calendar year in which it ends. Example: the 2018 water year begins Oct. 1, 2017 and ends Sep. 30, 2018.

Hydrograph – Area observation wells

Observation Well Data

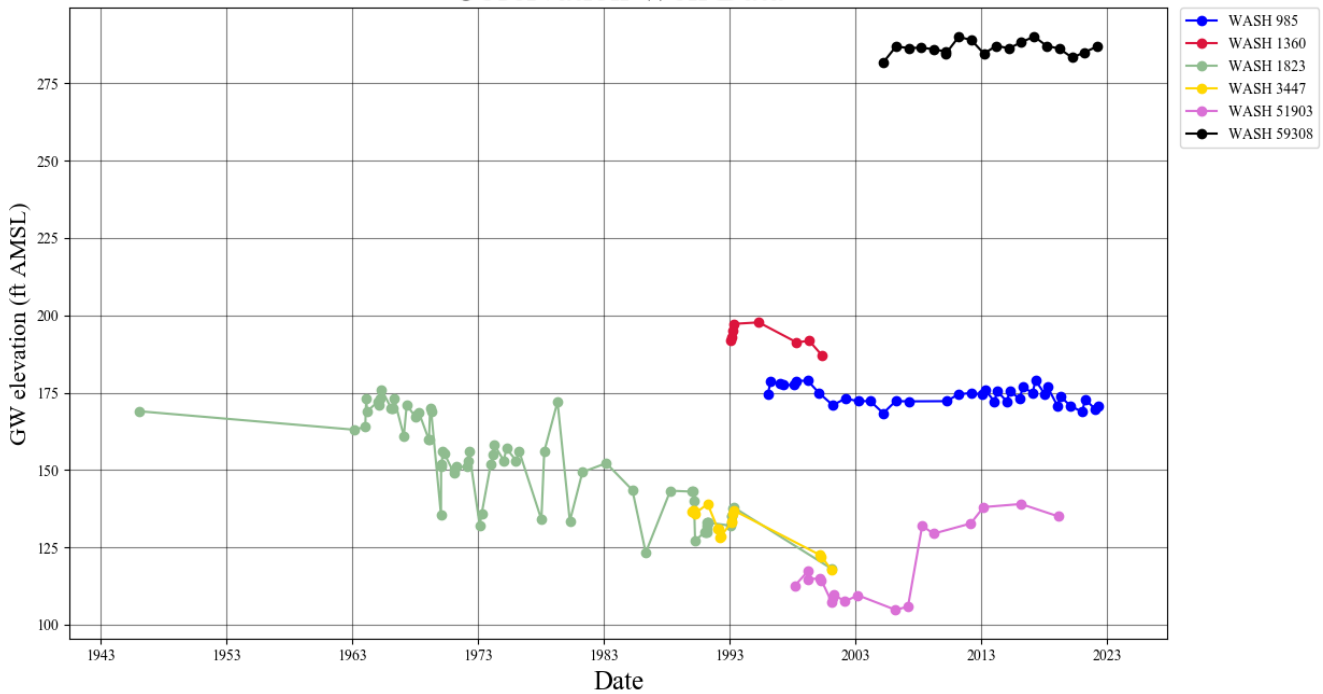

Hydrographs – Authorized POAs (WASH 59308)

