

Received
MAY 13 2024

OWRD

Application for a Permit to Use
Surface Water



Oregon Water Resources Department
725 Summer Street NE, Suite A
Salem, Oregon 97301-1266
503-986-0900
www.oregon.gov/OWRD

SECTION 1: APPLICANT INFORMATION AND SIGNATURE

Applicant

NAME Ulrich Wingens,		PHONE (HM)	
PHONE (HOME) 408-307-7900	CELL	FAX	
ADDRESS P.O.Box 5038			
CITY San Jose	STATE CA	ZIP 95150	E-MAIL * irobrahn@hotmail.com

Organization

NAME N/A		PHONE	FAX
ADDRESS			CELL
CITY	STATE	ZIP	E-MAIL *

Agent – The agent is authorized to represent the applicant in all matters relating to this application.

AGENT / BUSINESS NAME Inken Robrahn		PHONE 408-307-7900	FAX
ADDRESS P.O.Box 5038			CELL
CITY San Jose	STATE CA	ZIP 95150	E-MAIL * irobrahn@hotmail.com

Note: Attach multiple copies as needed

* By providing an e-mail address, consent is given to receive all correspondence from the Department electronically. (Paper copies of the proposed and final order documents will also be mailed.)

By my signature below I confirm that I understand:

- I am asking to use water specifically as described in this application.
- Evaluation of this application will be based on information provided in the application.
- I cannot legally use water until the Water Resources Department issues a permit.
- The Department encourages all applicants to wait for a permit to be issued before beginning construction of any proposed diversion. Acceptance of this application does not guarantee a permit will be issued.
- If I begin construction prior to the issuance of a permit, I assume all risks associated with my actions.
- If I receive a permit, I must not waste water.
- If development of the water use is not according to the terms of the permit, the permit can be cancelled.
- The water use must be compatible with local comprehensive land use plans.
- Even if the Department issues a permit, I may have to stop using water to allow senior water right holders to receive water to which they are entitled.

I (we) affirm that the information contained in this application is true and accurate

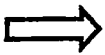

<u>Ulrich Wingens</u> Applicant Signature	Ulrich Wingens, Trustee Print Name and Title if applicable	9-8-2023 Date
_____ Applicant Signature	_____ Print Name and Title if applicable	_____ Date

SECTION 2: PROPERTY OWNERSHIP

Please indicate if you own all the lands associated with the project from which the water is to be diverted, conveyed, and used.

- YES, there are no encumbrances.
- YES, the land is encumbered by easements, rights of way, roads or other encumbrances.
- NO, I have a recorded easement or written authorization permitting access.
- NO, I do not currently have written authorization or easement permitting access.
- NO, written authorization or an easement is not necessary, because the only affected lands I do not own are state-owned submersible lands, and this application is for irrigation and/or domestic use only (ORS 274.040).
- NO, because water is to be diverted, conveyed, and/or used only on federal lands.

Affected Landowners: List the names and mailing addresses of all owners of any lands that are not owned by the applicant and that are crossed by the proposed ditch, canal or other work, even if the applicant has obtained written authorization or an easement from the owner. *(Attach additional sheets if necessary).*

Legal Description: You must provide the legal description of: 1. The property from which the water is to be diverted, 2. Any property crossed by the proposed ditch, canal or other work, and 3. Any property on which the water is to be used as depicted on the map.

SECTION 3: SOURCE OF WATER

A. Proposed Source of Water

Provide the commonly used name of the water body from which water will be diverted, and the name of the stream or lake it flows into (if unnamed, say so), and the locations of the point of diversion (POD):

Source 1: <i>mt. ulka Reservoir</i>	Tributary to: <i>gooseberry Spring Creek unnamed Spring</i>
TRSQQ of POD: <i>2N.13E 20 SW NW</i>	
Source 2:	Tributary to:
TRSQQ of POD:	

If any source listed above is stored water that is authorized under a water right permit, certificate, or decree, attach a copy of the document or list the document number (for decrees, list the volume, page and/or decree name).

Received
MAY 13 2024
OWRD

Minimum Requirements Checklist

Minimum Requirements (OAR 690-310-0040, OAR 690-310-0050 & ORS 537.140)

Include this checklist with the application

Check that each of the following items is included. The application will be returned if all required items are not included. If you have questions, please call the Water Rights Customer Service Group at (503) 986-0900.

Please submit the original application and signatures to the Water Resources Department. Applicants are encouraged to keep a copy of the completed application.

- SECTION 1: Applicant Information and Signature
- SECTION 2: Property Ownership
- SECTION 3: Source of Water
- SECTION 4: Sensitive, Threatened or Endangered Fish Species Public Interest Information
- SECTION 5: Water Use
- SECTION 6: Water Management
- SECTION 7: Resource Protection
- SECTION 8: Project Schedule
- SECTION 9: Within a District
- SECTION 10: Remarks

Received
MAY 13 2024
OWRD

Include the following additional items:

- Land Use Information Form with approval and signature of local planning department (*must be an original*) or signed receipt.
- Provide the legal description of: (1) the property from which the water is to be diverted, (2) any property crossed by the proposed ditch, canal or other work, and (3) any property on which the water is to be used as depicted on the map.
- Fees - Amount enclosed: \$ 1,548
See the Department's Fee Schedule at www.oregon.gov/owrd or call (503) 986-0900.
- Map that includes the following items:
 - Permanent quality and drawn in ink
 - Even map scale not less than 4" = 1 mile (example: 1" = 400 ft, 1" = 1320 ft, etc.)
 - North Directional Symbol
 - Township, Range, Section, Quarter/Quarter, Tax Lots
 - Reference corner on map
 - Location of each diversion, by reference to a recognized public land survey corner (distances north/south and east/west)
 - Indicate the area of use by Quarter/Quarter and tax lot identified clearly.
 - Number of acres per Quarter/Quarter and hatching to indicate area of use if for primary irrigation, supplemental irrigation, or nursery
 - Location of main canals, ditches, pipelines or flumes (if well is outside of the area of use)

Water-Use Permit Application Processing

1. Completeness Determination

The Department evaluates whether the application and accompanying map contain all of the information required under OAR 690-310-0040 and OAR 690-310-0050. The Department also determines whether the proposed use is prohibited by statute. If the Department determines that the application is incomplete, all fees have not been paid, or the use is prohibited by statute, the application and all fees submitted are returned to the applicant.

2. Initial Review

The Department reviews the application to determine whether water is available during the period requested, whether the proposed use is restricted or limited by rule or statute, and whether other issues may preclude approval of or restrict the proposed use. An Initial Review (IR) containing preliminary determinations is mailed to the applicant. The applicant has 14 days from the mailing date to withdraw the application from further processing and receive a refund of all fees paid minus \$310. The applicant may put the application on hold for up to 180 days and may request additional time if necessary.

3. Public Notice

Within 7 days of the mailing of the initial review, the Department gives [public notice](#) of the application in the weekly notice published by the Department at www.oregon.gov/owrd. The public comment period is 30 days from publication in the weekly notice.

4. Proposed Final Order Issued

The Department reviews any comments received, including comments from other state agencies related to the protection of sensitive, threatened or endangered fish species. Within 60 days of completion of the IR, the Department issues a Proposed Final Order (PFO) explaining the proposed decision to deny or approve the application. A PFO proposing approval of an application will include a draft permit, and may request additional information or outstanding fees required prior to permit issuance.

5. Public Notice

Within 7 days of issuing the PFO, the Department gives public notice in the weekly notice. Notice includes information about the application and the PFO. Protest must be received by the Department within 45 days after publication of the PFO in the weekly notice. Anyone may file a protest. The protest filing fee is \$480.00 for the applicant and \$950.00 for non-applicants. Protests are filed on approximately 10 percent of Proposed Final Orders. If a protest is filed the Department will attempt to settle the protest but will schedule a contested case hearing if necessary.

6. Final Order Issued

If no protests are filed, the Department can issue a Final Order within 60 days of the close of the period for receiving protest. If the application is approved, a permit is issued. The permit specifies the details of the authorized use and any terms, limitations or conditions that the Department deems appropriate

Received

MAY 13 2024

OWRD

B. Applications to Use Stored Water

Do you, or will you, own the reservoir(s) described in Section 3A above?

Yes. No. (Enclose a copy of your written notification to the operator of the reservoir of your intent to file this application, which should have been mailed or delivered to the operator.)

If all sources listed in Section 3A are stored water, the Department will review your application using the expedited process provided in ORS 537.147, unless you check the box below. Please see the instruction booklet for more information.

By checking this box, you are requesting that the Department process your application under the standard process outlined in ORS 537.150 and 537.153, rather than the expedited process provided by ORS 537.147. To file an application under the standard process, you must enclose the following:

- A copy of a signed non-expired contract or other agreement with the owner of the reservoir (if not you) to impound the volume of water you propose to use in this application.
- A copy of your written agreement with the party (if any) delivering the water from the reservoir to you.

SECTION 4: SENSITIVE, THREATENED OR ENDANGERED FISH SPECIES PUBLIC INTEREST INFORMATION

This information must be provided for your application to be accepted as complete. The Water Resources Department will determine whether the proposed use will impair or be detrimental to the public interest with regard to sensitive, threatened or endangered fish species.

To answer the following questions, use the map provided in [Attachment 3](#) or the link below to determine whether the proposed point of diversion (POD) is located in an area where the Upper Columbia, the Lower Columbia, and/or the Statewide public interest rules apply.

For more detailed information, click on the following link and enter the T,R,S,QQ or the Lat/Long of a POD and click on "Submit" to retrieve a report that will show which section, if any, of the rules apply:
https://apps.wrd.state.or.us/apps/misc/lkp_trsqg_features/

If you need help to determine in which area the proposed POD is located, please call the customer service desk at (503) 986-0900.

Received
MAY 13 2024

Upper Columbia - OAR 690-033-0115 thru -0130

Is the POD located in an area where the Upper Columbia Rules apply?

Yes No

OWRD

If yes, you are notified that the Water Resources Department will consult with numerous federal, state, local and tribal governmental entities so it may determine whether the proposed use is consistent with the "Columbia River Basin Fish and Wildlife Program" adopted by the Northwest Power Planning Council in 1994 for the protection and recovery of listed fish species. The application may be denied, heavily conditioned, or if appropriate, mitigation for impacts may be needed to obtain approval for the proposed use.

If yes,

- I understand that the proposed use does not involve appropriation of direct streamflow during the time period April 15 to September 30, except as provided in OAR 690-033-0140.
- I understand that I will install, operate and maintain a fish screen and fish passage as listed in ORS 498.301 through 498.346, and 509.580 through 509.910, to the specifications and extent required by Oregon Department of Fish and Wildlife, prior to diversion of water under any permit issued pursuant to this application.
- I understand that the Oregon Department of Environmental Quality will review my application to determine if the proposed use complies with existing state and federal water quality standards.
- I understand that I will install and maintain water use measurement and recording devices as required by the Water Resources Department, and comply with recording and reporting permit condition requirements.

Lower Columbia - OAR 690-033-0220 thru -0230

Is the POD located in an area where the Lower Columbia rules apply?

Yes No

If yes, you are notified that that the Water Resources Department will determine, by reviewing recovery plans, the Columbia River Basin Fish and Wildlife Program, and regional restoration programs applicable to threatened or endangered fish species, in coordination with state and federal agencies, as appropriate, whether the proposed use is detrimental to the protection or recovery of a threatened or endangered fish species and whether the use can be conditioned or mitigated to avoid the detriment.

If a permit is issued, it will likely contain conditions to ensure the water use complies with existing state and federal water quality standards; and water use measurement, recording and reporting required by the Water Resources Department. The application may be denied, or if appropriate, mitigation for impacts may be needed to obtain approval of the proposed use.

If yes, provide the following information (the information must be provided with the application to be considered complete).

Yes No The proposed use is for more than **one** cubic foot per second (448.8 gpm) and is not subject to the requirements of OAR 690, Division 86 (Water Management and Conservation Plans).

If yes, provide a description of the measures to be taken to assure reasonably efficient water use:

Received
MAY 13 2024
OWRD

Statewide - OAR 690-033-0330 thru -0340

Is the POD located in an area where the Statewide rules apply?

Yes No

If yes, the Water Resources Department will determine whether the proposed use will occur in an area where endangered, threatened or sensitive fish species are located. If so, the Water Resources Department, Department of Fish and Wildlife, Department of Environmental Quality, and the Department of Agriculture will recommend conditions required to achieve "no loss of essential habitat of threatened and endangered (T&E) fish species," or "no net loss of essential habitat of sensitive (S) fish species." If conditions cannot be identified that meet the standards of no loss of essential T & E fish habitat or no net loss of essential S fish habitat, the agencies will recommend denial of the application unless they conclude that the proposed use would not harm the species.

SECTION 5: WATER USE

Provide the amount of water you propose to use from each source, for each use, in cubic feet-per-second (cfs) or gallons-per-minute (gpm). If the proposed use is from storage, provide the amount in acre-feet (af):
 (1 cfs equals 448.8 gpm. 1 acre-foot equals 325,851 gallons or 43,560 cubic feet)

SOURCE	USE	PERIOD OF USE	AMOUNT
Mt. Ulka Reservoir	<i>irrigation</i>	March 1st to October 1st	<input checked="" type="checkbox"/> cfs <input type="checkbox"/> gpm <input type="checkbox"/> af
			<input type="checkbox"/> cfs <input type="checkbox"/> gpm <input type="checkbox"/> af
			<input type="checkbox"/> cfs <input type="checkbox"/> gpm <input type="checkbox"/> af
			<input type="checkbox"/> cfs <input type="checkbox"/> gpm <input type="checkbox"/> af

Please indicate the number of primary, supplemental and/or nursery acres to be irrigated.

Primary: 67.9 Acres Supplemental: _____ Acres Nursery Use: _____ Acres

If supplemental acres are listed, provide the Permit or Certificate number of the underlying primary water right(s):

Indicate the maximum total number of acre-feet you expect to use in an irrigation season: 8 ac-ft.

- If the use is **municipal or quasi-municipal**, attach **Form M**
- If the use is **domestic**, indicate the number of households:
- If the use is **mining**, describe what is being mined and the method(s) of extraction:

Received
 Received
 3 2024
 MAY 13 2024
 OWRD
 OWRD

SECTION 6: WATER MANAGEMENT

A. Diversion and Conveyance

What equipment will you use to pump water from your source?

- Pump (give horsepower and type): *PTO driven water pump. Bauer Famos III 60, 350 GPM.*
- Other means (describe):

Provide a description of the proposed means of diversion, construction, and operation of the diversion works and conveyance of water. *A Suction pipe will draw water from the pond and the pump will fill the mainline.*

B. Application Method

What equipment and method of application will be used? (e.g., drip, wheel line, high-pressure sprinkler)

Drip irrigation under plastic mulch to improve efficiency

C. Conservation

Please describe why the amount of water requested is needed and measures you propose to: prevent waste; measure the amount of water diverted; prevent damage to public uses of affected surface waters.

This water will allow the farmer to efficiently irrigate 203 acres. The drip irrigation underneath the plastic mulch is the most efficiency type of irrigation for fresh market vegetables.

will only irrigate when necessary to prevent waste and prevent damage to public water.

SECTION 7: RESOURCE PROTECTION

In granting permission to use water from a stream or lake, the state encourages, and in some instances requires, careful control of activities that may affect the waterway or streamside area. See instruction guide for a list of possible permit requirements from other agencies. Please indicate any of the practices you plan to undertake to protect water resources:

Diversion will be screened per ODFW specifications in ORS 498.301 through 498.346 to prevent uptake of fish and other aquatic life.
Describe planned actions: *No need for any. No native fish. Not in channel. Does not flow anywhere.*

Excavation or clearing of banks will be kept to a minimum to protect riparian or streamside areas.
Note: If disturbed area is more than one acre, applicant should contact the Department of Environmental Quality to determine if a 1200C permit is required.
Describe planned actions and additional permits required for project implementation:

Operating equipment in a water body will be managed and timed to prevent damage to aquatic life.
Describe planned actions and additional permits required for project implementation:

Water quality will be protected by preventing erosion and run-off of waste or chemical products.
Describe planned actions:

List other federal and state permits or contracts to be obtained, if a water right permit is granted.

SECTION 8: PROJECT SCHEDULE

- a) Date construction will begin: *"already complete"*
- b) Date construction will be completed: *"already complete"*
- c) Date beneficial water use will begin: *as soon as permitted*

SECTION 9: WITHIN A DISTRICT

Check here if the point of diversion or place of use are located within or are served by an irrigation or other water district.

Irrigation District Name	Address	
City	State	Zip

SECTION 10: REMARKS

Use this space to clarify any information you have provided in the application. (*Attach additional sheets if necessary*).

Received
MAY 13 2024

OWRD

Land Use Information Form



Oregon Water Resources Department
725 Summer Street NE, Suite A
Salem, Oregon 97301-1266
503-986-0900
www.oregon.gov/OWRD

NOTE TO APPLICANTS

In order for your application to be processed by the Water Resources Department (WRD), this Land Use Information Form must be completed by a local government planning official in the jurisdiction(s) where your water right will be used and developed. The planning official may choose to complete the form while you wait, or return the receipt stub to you. Applications received by WRD without the Land Use Form or the receipt stub will be returned to you. Please be aware that your application will not be approved without land use approval.

This form is NOT required if:

- 1) Water is to be diverted, conveyed, and/or used only on federal lands; **OR**
- 2) The application is for a water right transfer, allocation of conserved water, exchange, permit amendment, or groundwater registration modification, and all of the following apply:
 - a) The existing and proposed water use is located entirely within lands zoned for exclusive farm-use or within an irrigation district;
 - b) The application involves a change in place of use only;
 - c) The change does not involve the placement or modification of structures, including but not limited to water diversion, impoundment, distribution facilities, water wells and well houses; and
 - d) The application involves irrigation water uses only.

NOTE TO LOCAL GOVERNMENTS

The person presenting the attached Land Use Information Form is applying for or modifying a water right. The Water Resources Department (WRD) requires its applicants to obtain land use information to be sure the water rights do not result in land uses that are incompatible with your comprehensive plan. Please complete the form or detach the receipt stub and return it to the applicant for inclusion in their water right application. You will receive notice once the applicant formally submits his or her request to the WRD. The notice will give more information about WRD's water rights process and provide additional comment opportunities. You will have 30 days from the date of the notice to complete the land use form and return it to the WRD. If no land use information is received from you within that 30-day period, the WRD may presume the land use associated with the proposed water right is compatible with your comprehensive plan. Your attention to this request for information is greatly appreciated by the Water Resources Department. If you have any questions concerning this form, please contact the WRD's Customer Service Group at 503-986-0900.

Received

MAY 13 2024

OWRD

Received
MAY 13 2024

Land Use Information Form

OWRD



Oregon Water Resources Department
725 Summer Street NE, Suite A
Salem, Oregon 97301-1266503-986-0900
www.oregon.gov/OWRD

NAME <i>Ulrich Wmgers c/o Inken Robrahn</i>		PHONE (HM)
PHONE (WK) <i>408-307-7900</i>	CELL	FAX
MAILING ADDRESS <i>P.O. Box 5038</i>		
CITY <i>San Jose</i>	STATE <i>CA</i>	ZIP <i>95150</i>
E-MAIL* <i>irobrahn@hotmail.com</i>		

A. Land and Location

Please include the following information for all tax lots where water will be diverted (taken from its source), conveyed (transported), and/or used or developed. Applicants for municipal use, or irrigation uses within irrigation districts may substitute existing and proposed service-area boundaries for the tax-lot information requested below.

Township	Range	Section	¼ ¼	Tax Lot #	Plan Designation (e.g., Rural Residential/RR-5)	Water to be:			Proposed Land Use:
<i>2N</i>	<i>13</i>	<i>E</i>	<i>20</i>	<i>400</i>	<i>(BMA)A-1</i>	<input checked="" type="checkbox"/> Diverted	<input checked="" type="checkbox"/> Conveyed	<input checked="" type="checkbox"/> Used	<i>irrigation</i>
				<i>500</i>	<i>(T60) large scale agriculture</i>	<input type="checkbox"/> Diverted	<input type="checkbox"/> Conveyed	<input type="checkbox"/> Used	<i>fire protection in emergency</i>
						<input type="checkbox"/> Diverted	<input type="checkbox"/> Conveyed	<input type="checkbox"/> Used	<i>aesthetic value</i>
						<input type="checkbox"/> Diverted	<input type="checkbox"/> Conveyed	<input type="checkbox"/> Used	

List all counties and cities where water is proposed to be diverted, conveyed, and/or used or developed:

Wasco County

B. Description of Proposed Use

Type of application to be filed with the Water Resources Department:

- Permit to Use or Store Water
 Water Right Transfer
 Permit Amendment or Ground Water Registration Modification
 Limited Water Use License
 Allocation of Conserved Water
 Exchange of Water

Source of water: Reservoir/Pond
 Ground Water
 Surface Water (name) *Mt. Ulka Reservoir*

Estimated quantity of water needed: *8* cubic feet per second
 gallons per minute
 acre-feet

Intended use of water: Irrigation
 Commercial
 Industrial
 Domestic for _____ household(s)
 Municipal
 Quasi-Municipal
 Instream
 Other *multi purpose*

Briefly describe:

irrigated agricultural, no new structures are proposed. planting and growing organic vegetables, the pond will be used for fire protection in an emergency and also the pond is used for aesthetic values

Note to applicant: If the Land Use Information Form cannot be completed while you wait, please have a local government representative sign the receipt at the bottom of the next page and include it with the application filed with the Water Resources Department.

Received
MAY 13 2024

For Local Government Use Only

OWRD

The following section must be completed by a planning official from each county and city listed unless the project will be located entirely within the city limits. In that case, only the city planning agency must complete this form. This deals only with the local land-use plan. Do not include approval for activities such as building or grading permits.

Please check the appropriate box below and provide the requested information

- Land uses to be served by the proposed water uses (including proposed construction) are allowed outright or are not regulated by your comprehensive plan. Cite applicable ordinance section(s):
- Land uses to be served by the proposed water uses (including proposed construction) involve discretionary land-use approvals as listed in the table below. (Please attach documentation of applicable land-use approvals which have already been obtained. Record of Action/land-use decision and accompanying findings are sufficient.) **If approvals have been obtained but all appeal periods have not ended, check "Being pursued."**

Type of Land-Use Approval Needed (e.g., plan amendments, rezones, conditional-use permits, etc.)	Cite Most Significant, Applicable Plan Policies & Ordinance Section References	Land-Use Approval	
		<input type="checkbox"/> Obtained <input type="checkbox"/> Denied	<input type="checkbox"/> Being Pursued <input type="checkbox"/> Not Being Pursued
		<input type="checkbox"/> Obtained <input type="checkbox"/> Denied	<input type="checkbox"/> Being Pursued <input type="checkbox"/> Not Being Pursued
		<input type="checkbox"/> Obtained <input type="checkbox"/> Denied	<input type="checkbox"/> Being Pursued <input type="checkbox"/> Not Being Pursued
		<input type="checkbox"/> Obtained <input type="checkbox"/> Denied	<input type="checkbox"/> Being Pursued <input type="checkbox"/> Not Being Pursued
		<input type="checkbox"/> Obtained <input type="checkbox"/> Denied	<input type="checkbox"/> Being Pursued <input type="checkbox"/> Not Being Pursued
		<input type="checkbox"/> Obtained <input type="checkbox"/> Denied	<input type="checkbox"/> Being Pursued <input type="checkbox"/> Not Being Pursued

Local governments are invited to express special land-use concerns or make recommendations to the Water Resources Department regarding this proposed use of water below, or on a separate sheet.

Name: Chris McNEEL Title: ASSISTANT PLANNER
 Signature: [Signature] Phone: (541) 406-2510 Date: 9/12/2023
 Government Entity: WASCO COUNTY PLANNING

Note to local government representative: Please complete this form or sign the receipt below and return it to the applicant. If you sign the receipt, you will have 30 days from the Water Resources Department's notice date to return the completed Land Use Information Form or WRD may presume the land use associated with the proposed use of water is compatible with local comprehensive plans.

Receipt for Request for Land Use Information

Applicant name: _____
 City or County: _____ Staff contact: _____
 Signature: _____ Phone: _____ Date: _____

RECORDING REQUESTED BY:
JAMES M. DRAEGER, ESQ.

WHEN RECORDED, MAIL TO:
James M. Draeger
Attorney at Law
770 Menlo Avenue, Suite 101
Menlo Park, CA 94025

MAIL TAX STATEMENTS TO:
Eva Merg
1525 Norland Avenue
Sunnyvale, CA 94087

(2)
Microfilm No. **985906**
FILED WASCO CTY
THE DALLES OR.

Nov 16 1 57 PM '98

KAREN R. LEBRETON
COUNTY CLERK

STATE OF OREGON, }
County of Wasco, } SS
I certify that this document was received
and recorded in the
DEED
records.
Karen LeBreton, County Clerk
A+T 20 LC 10 Recording 25

TRUST TRANSFER DEED

FOR NO CONSIDERATION, receipt of which is acknowledged, ULRICH WINGENS,

hereby GRANT(S), EARGAINS, SELLS AND CONVEYS to ULRICH WINGENS, Trustee of "The Ulrich Wingens 1989 Revocable Trust", dated April 6, 1989,

hereinafter called Grantee, and Grantee's heirs, successors and assigns, that certain real property with the tenements, hereditaments and appurtenances thereunto belonging or appertaining, situated in the County of Wasco, State of Oregon, described as follows to wit:

SEE EXHIBIT A WHICH IS MADE A PART HEREOF BY THIS REFERENCE.

TO HAVE AND TO HOLD the same unto said Grantee and Grantee's heirs, successors and assigns forever.

And Grantor hereby covenants to and with Grantees and the heirs and of the survivor and their assigns, that Grantor is lawfully seized in fee simple of the above granted premises, free from all encumbrances, EXCEPT AS PROVIDED IN EXHIBIT "A" ATTACHED HERETO AND MADE A PART HEREOF

The true and actual consideration for this conveyance is -0-.

Dated: October 1, 1998

THIS INSTRUMENT WILL NOT ALLOW USE OF THE PROPERTY DESCRIBED IN VIOLATION OF APPLICABLE LAND USE LAWS AND REGULATIONS. BEFORE SIGNING OR ACCEPTING THIS INSTRUMENT, THE PERSON ACQUIRING FEE TITLE TO THE PROPERTY SHOULD CHECK WITH THE APPROPRIATE CITY OR COUNTY PLANNING DEPARTMENT TO VERIFY APPROVED FEES

Ulrich Wingens
Ulrich Wingens

Received
MAY 13 2024
OWRD

985906 (5)

ACKNOWLEDGEMENT

STATE OF CALIFORNIA)
) SS
COUNTY OF SAN MATEO)

On October 1, 1998, before me, James M. Draeger, a Notary Public for the State of California, personally appeared ULRICH WINGENS personally known to me (or proved to me on the basis of satisfactory evidence) to be the person(s) whose name(s) is/are subscribed to the within instrument and acknowledged to me that he/she/they executed the same in his/her/their authorized capacity(ies), and that by his/her/their signature(s) on the instrument the person(s), or the entity upon behalf of which the person(s) acted, executed the instrument.

IN WITNESS WHEREOF, I have hereunto set my hand and affixed my official seal the date and year first above written.



Notary Public in and for the State of California

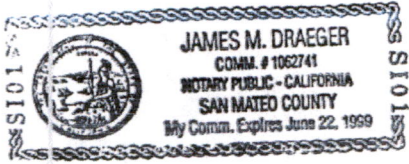

Received
MAY 13 2024
OWRD

985906 (2)

EXHIBIT A

PARCEL 1:

The Northwest quarter of the Southeast quarter and Government Lot 6⁷ Township 2 North, Range 13 East of the Willamette Meridian, in the County of Wasco and State of Oregon, EXCEPTING THEREFROM that portion conveyed to The Dalles Country Club by deed recorded in Book 71, page 81, Wasco County Deed Records.

PARCEL 2:

The North half of the Southwest quarter and Government Lots 4 and 5, Section 17, Township 2 North, Range 13 East of the Willamette Meridian, in the County of Wasco and State of Oregon.

PARCEL 3:

The East half and the East half of the Southwest quarter of Section 18, Township 2 North, Range 13 East of the Willamette Meridian, in the County of Wasco and State of Oregon.

PARCEL 4:

The Northeast quarter; the East half of the Northwest quarter; the Northeast quarter of the Southwest quarter; the Northwest quarter of the Southeast quarter; and Government Lot 1; all in Section 19, Township 2 North, Range 13 East of the Willamette Meridian, in the County of Wasco and State of Oregon;

EXCEPTING THEREFROM Beginning at the Southwest corner of the Northeast quarter of the Southwest quarter of said Section 19; thence North 528 feet; thence East 82.5 feet; thence South 528 feet; thence West 82.5 feet to the point of beginning.

*Section 17,

Received

MAY 13 2024

OWRD

985908

(5)

PARCEL 5:

Government Lots 5, 6 and 7, Section 20, Township 2 North, Range 13 East of the Willamette Meridian, in the County of Wasco and State of Oregon.

PARCEL 6:

That portion of the Edward Crate Donation Land Claim No. 38, Notification No. 8026, in Sections 17 and 20, Township 2 North, Range 13 East of the Willamette Meridian, in the County of Wasco and State of Oregon, which lies Westerly of the West Right of Way line of the Old Columbia River Highway, EXCEPTING THEREFROM that portion conveyed to The Dalles Country Club by deed recorded in Book 71, page 81, Wasco County Deed Records, ALSO EXCEPTING THEREFROM that portion described as: Commencing at the Northwest corner of the Justin Chenoweth Donation Land Claim No. 37, said corner being located in Section 19, Township 2 North, Range 13 East of the Willamette Meridian, Wasco County, Oregon; thence North 89 degrees 51' 18" East along the North line of said D.L.C. No. 37 a distance of 1895.27 feet to the Northeast corner of said D.L.C. No. 37; thence North 89 degrees 52' 23" East along the South line of the Edward Crate D.L.C. No. 38 a distance of 1419.08 feet to the true point of beginning of the herein described tract; thence North 17 degrees 37' 00" West 1235.10 feet; thence North 81 degrees 09' 16" East 117.08 feet; thence South 74 degrees 39' 00" East 115.86 feet; thence North 56 degrees 34' 50" East 116.22 feet; thence North 85 degrees 04' 24" East 122.32 feet; thence South 76 degrees 18' 21" East 197.70 feet; thence South 72 degrees 06' 04" East 177.57 feet; thence South 88 degrees 38' 05" East 189.69 feet; thence South 65 degrees 43' 52" East 262.18 feet; thence South 78 degrees 50' 42" East 135.15 feet; thence North 33 degrees 05' 44" East 286.24 feet; thence North 84 degrees 58' 59" East 1070.65 feet; thence South 61 degrees 48' 18" East 38.31 feet; thence North 87 degrees 07' 27" East 335 feet, more or less, to the Westerly right of way line of the Old Columbia River Highway; thence Southeasterly along said Westerly right of way line to its intersection with the South line of said Edward Crate D.L.C.; thence West along said South line to the true point of beginning.

Received

MAY 13 2024

985908 (5)

OWRD

PARCEL 7:

A tract of land in Section 19 and 20, Township 2 North, Range 13 East of the Willamette Meridian, in the County of Wasco and State of Oregon, described as follows:

Beginning at the Northwest corner of the Justin Chenowith Donation Land Claim No. 37; thence South 89 degrees 42' East along the North line thereof, 28.56 chains to the Northeast corner of said D.L.C.; thence South along the East line of said Claim a distance of 21 chains; thence West 28.56 chains to the West line of said Claim; thence North 21.13 chains along said West line to the point of beginning.

Received

MAY 13 2024

OWRD

985906

(2)

3572
5-7-24

Today's Date: Friday, September 8, 2023

Base Application Fee.		\$610.00
Acre feet of Stored Water to be diverted.	8	\$328.00
Subtotal:		\$938.00
Permit Recording Fee. ***		\$610.00
*** the Permit Recording Fee is not required when the application is submitted but, must be paid before a permit will be issued. It is fully refundable if a permit is not issued. If the recording fee is not paid prior to issuance of the Final Order, permit issuance will be delayed.	<input type="button" value="Recalculate"/>	
Estimated cost of Permit Application		\$1,548.00

Received
 MAY 13 2024
 OWRD

STATE OF OREGON

COUNTY OF WASCO

PERMIT TO STORE PUBLIC WATERS

THIS PERMIT IS HEREBY ISSUED TO

ULRICH WINGENS
PO BOX 5038
SAN JOSE CA 95150

The specific limits and conditions of the use are listed below.

APPLICATION FILE NUMBER: R-89409

SOURCE OF WATER: UNNAMED SPRING, TRIBUTARY TO GOOSEBERRY SPRING CREEK

STORAGE FACILITY: MT ULKA RESERVOIR

MAXIMUM DAM HEIGHT: 10.0 FEET

MAXIMUM VOLUME: 8.0 ACRE-FEET

PURPOSE OR USE OF THE STORED WATER: MULTIPURPOSE USE

WATER MAY BE APPROPRIATED FOR STORAGE DURING THE PERIOD: JANUARY 1 THROUGH DECEMBER 31

DATE OF PRIORITY: OCTOBER 27, 2023

DAM LOCATION:

Twp	Rng	Mer	Sec	Q-Q	Measured Distances
2 N	13 E	WM	20	SW NW	2464 FEET SOUTH AND 575 FEET EAST FROM NW CORNER, SECTION 20

THE AREA TO BE SUBMERGED BY THE RESERVOIR:

Twp	Rng	Mer	Sec	Q-Q
2 N	13 E	WM	20	SW NW
2 N	13 E	WM	20	NW SW

Received
MAY 13 2024

OWRD

PERMIT SPECIFIC CONDITIONS

1. Failure to comply with any of the provisions of this permit may result in action including, but not limited to, restrictions on the use, civil penalties, or cancellation of the permit.

2. Water Use Measurement, Recording, and Reporting:

- A. The Director may require the permittee to install a staff gage that measures the entire range and stage between full reservoir level and dead-pool level in the reservoir. If no dead-pool, the gage must measure the full depth of the reservoir. The watermaster may determine an alternate measuring device is suitable. If the Director notifies the permittee to install a measuring device, the permittee shall install such device within the period stated in the notice. Once installed, the permittee shall maintain the device in good working order and shall allow the watermaster access to the device.
- B. The Director may require the permittee to keep and maintain a record of the volume of water stored, and may require the permittee to report water-storage on a periodic schedule as established by the Director. In addition, the Director may require the permittee to report general water-use information, the periods of water use and the place and nature of use of water under the permit.
- C. The Director may provide an opportunity for the permittee to submit alternative measuring and reporting procedures for review and approval.

3. Fish Stocking:

Per ORS 498.222 and OAR 635-007-0600, all persons transporting live fish in Oregon shall have a Fish Transport Permit (FTP) issued by the Oregon Department of Fish and Wildlife (ODFW). The permittee shall not stock fish in the reservoir without an FTP approved by ODFW. As part of the FTP permitting process, the permittee may be required to screen the inlet and outlet of the reservoir to ensure that fish cannot escape into public waters and/or to keep wild fish from entering the reservoir.

4. Agricultural Water Quality Management Area Rules:

The permittee shall comply with basin-specific Agricultural Water Quality Management Area Rules described in Oregon Administrative Rule Chapter 603-095. The permittee shall protect riparian areas, allowing site capable vegetation to establish and grow along streams, while providing the following functions: shade (on perennial and some intermittent streams), bank stability, and infiltration or filtration of overland runoff.

5. Live Flow:

Once the allocated volume has been stored, permittee shall pass all live flow downstream at a rate equal to inflow, using methods that protect instream water quality.

Received
MAY 13 2024

OWRD

6. Off-Channel Stored Water Releases:

The permittee shall not release polluted water from this off-channel reservoir into waters of the state except when the release is directed by the State Engineer to prevent dam failure.

7. Riparian Area Restoration:

If the riparian area is disturbed in the process of developing a point of diversion, the permittee shall be responsible for restoration and enhancement of such riparian area in accordance with ODFW's Fish and Wildlife Habitat Mitigation Policy OAR 635-415. For purposes of mitigation, the ODFW Fish and Wildlife Habitat Mitigation Goals and Standards, OAR 635-415, shall be followed.

8. Water Quality:

All water use under this permit shall comply with state and federal water quality laws. The permittee shall not violate any state and federal water quality standards, shall not cause pollution of any waters of the state, and shall not place or cause to be placed any wastes in a location where such wastes are likely to escape or be carried into the waters of the state by any means. The use may be restricted if the quality of source stream or downstream waters decrease to the point that those waters no longer meet existing state or federal water quality standards. Permittee is responsible for obtaining any necessary state and federal permits.

9. The storage of water allowed herein is subject to the installation and maintenance of an outlet pipe (with a minimum diameter of 8" for any in-channel reservoir). This requirement may be waived if the Department determines other means have been provided to evacuate water when necessary.

10. The permittee shall pass all live flow outside the storage season described above.

11. The permittee shall not construct, operate or maintain any dam or artificial obstruction to fish passage in the channel of the subject stream without providing a fishway to ensure adequate upstream and downstream passage for fish, unless the permittee has requested and been granted a fish passage waiver by the Oregon Fish and Wildlife Commission. The permittee is hereby directed to contact an Oregon Department of Fish and Wildlife Fish Passage Coordinator, before beginning construction of any in-channel obstruction.

12. The permittee may be required in the future to install, maintain, and operate fish screening and by-pass devices to prevent fish from entering the proposed diversion and to provide adequate upstream and downstream passage for fish.

13. This permit allows an annual appropriation (not to exceed the specified volume). This permit does not provide for the appropriation of water for out-of-reservoir uses, the maintenance of the water level or maintaining a suitable freshwater condition. If any water is to be used for out-of-reservoir purposes, a secondary water right is required. If any additional live flow is to be appropriated to maintain either the water level or a suitable freshwater condition, an additional water right is required.

STANDARD CONDITIONS

1. This permit is for the beneficial use of water without waste. The water user is advised that new regulations may require the use of best practical technologies or conservation practices to achieve this end.
2. By law, the land use associated with this water use must be in compliance with statewide land-use goals and any local acknowledged land-use plan.
3. The use of water allowed herein may be made only at times when sufficient water is available to satisfy all prior rights, including prior rights for maintaining instream flows.

DEVELOPMENT AND COMPLETION TIMELINE REQUIREMENTS

1. Construction of the water system shall begin within five years of the date of permit issuance. The deadline to begin construction may not be extended. This permit is subject to cancellation proceedings if the begin construction deadline is missed.
2. The permitted volume of water shall be stored within five years of the date of permit issuance. If additional time is needed, the permittee may submit an application for extension of time, which may be approved based upon the merit of the application.
3. Within one year after storage of water, the permittee shall submit a claim of beneficial use to the Oregon Water Resources Department.
4. The claim of beneficial use shall be prepared by a Certified Water Right Examiner in conformance with the requirements of OAR 690-014 if an associated secondary permit exists for the use of stored water under this permit, or if the reservoir capacity is equal to or greater than 9.2 acre-feet.
5. If no secondary permit exists and the reservoir capacity is less than 9.2 acre-feet of water, the claim of beneficial use need not be prepared by a Certified Water Right Examiner. The information submitted to the Oregon Water Resources Department shall include:
 - a. the dimensions of the reservoir;
 - b. the maximum capacity of the reservoir in acre-feet; and
 - c. a map identifying the location of the reservoir prepared in compliance with Water Resources Department standards.

ISSUED APR 26 2024

Katherine Ratcliffe

Katherine Ratcliffe
Water Rights Section Manager, for
Douglas E. Woodcock, Acting Director
Oregon Water Resources Department

Application R-89409
Basin #4

Water Resources Department
Page 4 of 4

Permit R-15632
Water District #3

Received
MAY 13 2024
OWRD

Oregon Water Resources Department
Water Right Services Division

Received
MAY 13 2024

OWRD

Water Right Application R-89409 in the)
name of ULRICH WINGENS)
)

FINAL ORDER
APPROVING THE STORAGE OF
SURFACE WATER

Authority

The application is being processed in accordance with Oregon Revised Statute (ORS) 537.409, which establishes the process by which an application to store waters of the public may be submitted. This statute can be accessed here:

www.oregon.gov/OWRD/programs/policylawandrules

The Water Resources Department's website can be accessed here:

www.oregon.gov/OWRD

In accordance with ORS 537.409, the Department shall conduct a public interest review of an application submitted to store water in a reservoir that has a storage capacity of less than 9.2 acre-feet or a dam or impoundment structure less than 10 feet in height.

The review shall be limited to issues pertaining to:

- (a) Water availability;
- (b) Potential detrimental impact to existing fishery resources; and
- (c) Potential injury to existing water rights.

In addition, the Department will review ORS Chapter 538 to determine if the source of water has been withdrawn from further appropriation and will conduct a review consistent with ORS Chapter 390.835 – Oregon's Scenic Waterway laws – to determine whether the use is prohibited.

Following this review, the Department shall issue a final order granting or denying the permit or granting the permit with conditions.

NOTICE OF RIGHT TO PETITION FOR RECONSIDERATION OR JUDICIAL REVIEW

This is a Final Order in other than contested case. This order is subject to judicial review under ORS 536.075 and ORS 183.484. Any petition for judicial review must be filed within the 60-day time period specified by ORS 183.484(2). Pursuant to OAR 137-004-0080, you may petition the Director for reconsideration of this order. A petition for reconsideration may be granted or denied by the Director, and if no action is taken within 60 days following the date the petition was filed, the petition shall be deemed denied.

ORS 537.409 does not provide an opportunity to request a contested-case hearing. Appeal rights on this final order approving the application are limited to the above procedures.

FINDINGS OF FACT

1. On October 27, 2023, Ulrich Wingers submitted an application for a permit to store water pursuant to ORS 537.409.

Storage Volume: 8.0 ACRE-FEET

Dam Height: 10.0 FEET

Source: UNNAMED SPRING, TRIBUTARY TO GOOSEBERRY SPRING CREEK

County: WASCO COUNTY

Reservoir Location: SECTION 20, TOWNSHIP 2 NORTH, RANGE 13 EAST, W.M.

2. The required examination fees were paid, and the minimum application requirements were met.
3. On November 7, 2023, the Department provided public notice of the application in the Department's weekly public notice. A 60-day comment period followed.
4. The Department did not receive public comment related to the possible issuance of the attached permit.
5. An assessment of water availability at 50% exceedance for the proposed use was completed using the Department's Water Availability Reporting System. A copy of this assessment is in the application file. This review is done consistent with OAR 690-410-0070(2)(a). The assessment established that water is available December 1 through March 31 of each year for the proposed use. However, the local watermaster examined the reservoir and determined the spring-fed reservoir does not have connection to the surrounding surface water network; therefore, this site-specific assessment identified that water for proposed use is available from January 1 through December 31 of each year.
6. The Department relies on the Oregon Department of Fish and Wildlife's review and recommendations in determining whether a proposed use would pose a significant detrimental impact to existing fishery resources. The Department has determined that, as conditioned, the proposed use will not pose a significant detrimental impact to existing fishery resources.
7. The Department has determined that the proposed use, as conditioned, will not injure other water rights.
8. The Department has determined that the proposed source has not been withdrawn from further appropriation under ORS Chapter 538.
9. The proposed reservoir is not prohibited under ORS 390.835.

CONCLUSIONS OF LAW

1. Application R-89409 contains the information required by ORS 537.409(1)-(3).
2. The proposed use would not impair or be detrimental to the public interest as described in ORS 537.409.

ORDER

Application R-89409 is approved and Permit R-15632 is issued as limited by the conditions contained therein.

DATED APR 26 2024

Katherine Ratcliffe

Katherine Ratcliffe
Water Rights Section Manager, for
Douglas E. Woodcock, Acting Director
Oregon Water Resources Department

Received
MAY 13 2024
OWRD

If you have questions about statements contained in this document, please contact Adam Frederick at Adam.M.Frederick@water.oregon.gov or 971-707-8400.

If you have other questions about the Department or any of its programs, please contact our Water Resources Customer Service Group at 503-986-0900.

Received
MAY 13 2024

Township 2 North Range 13 East Section 20
Tax Lots 400 and 500

OWRD

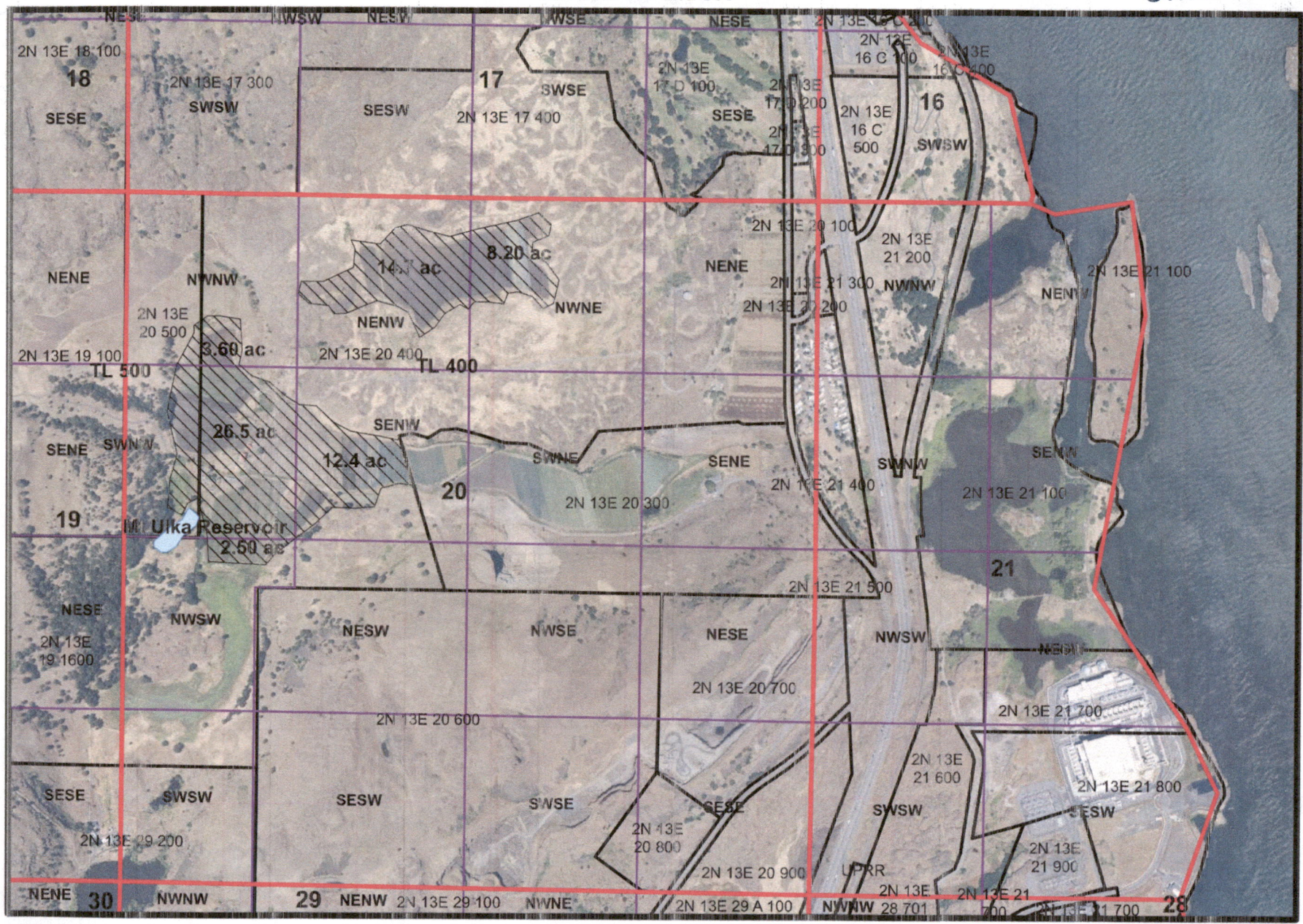

Dam is 2,464' South and 575' East from NW Corner, Section 20.

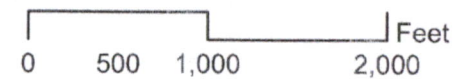

Superseded

received
MAY 13 2024

Township 2 North Range 13 East Section 20
Tax Lots 400 and 500

OWRD

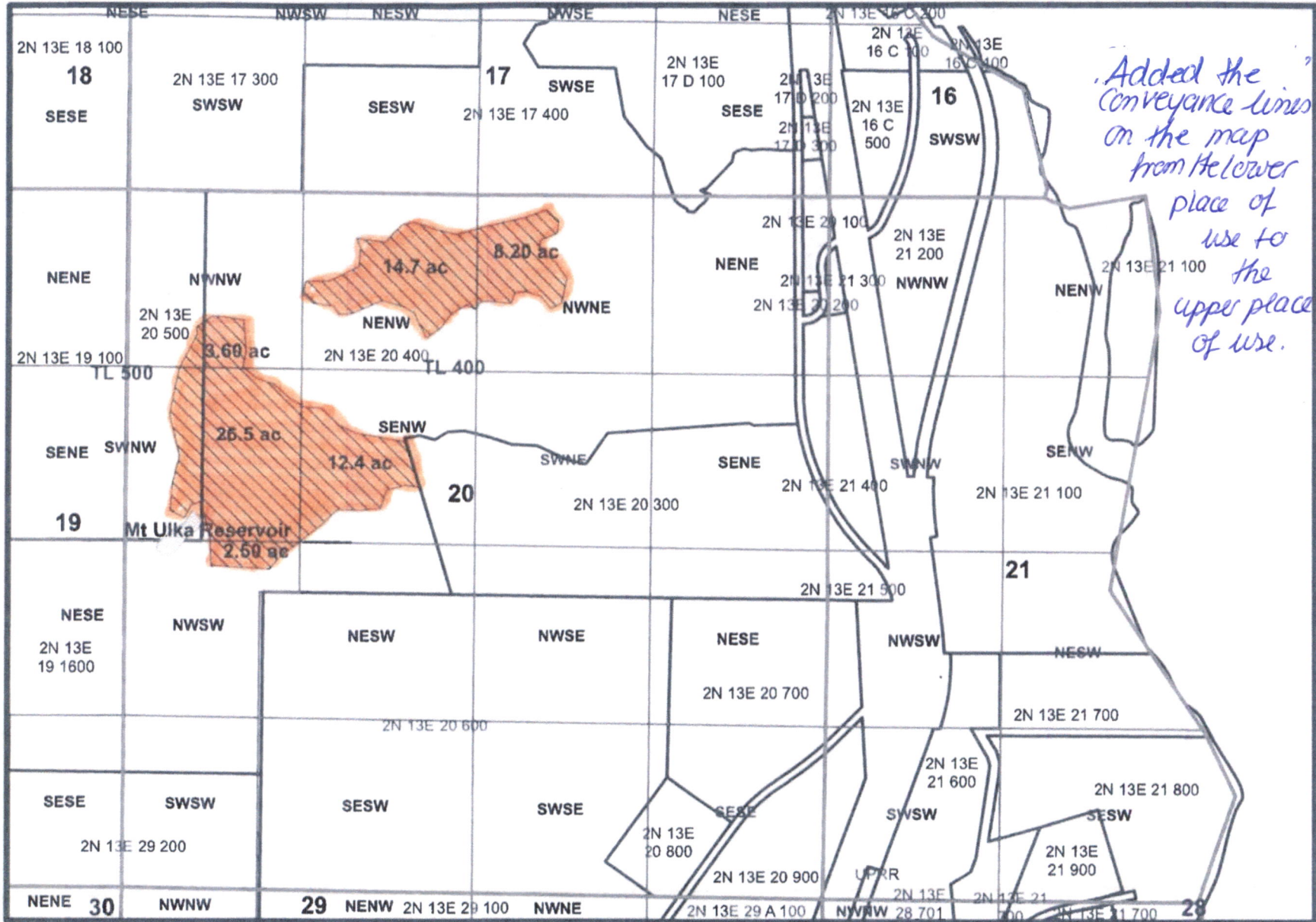

Dam is 2,464' South and 575' East from NW Corner, Section 20.

