

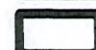

**T25S R15E &  
T25S R14E, WM  
LAKE COUNTY, OR**



0 2,640 Feet

1" = 2640'

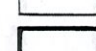
-  Place of Use
-  Township
-  Section
-  Quarter Quarter
-  Taxlot

Received  
JUN 13 2024  
OWRD

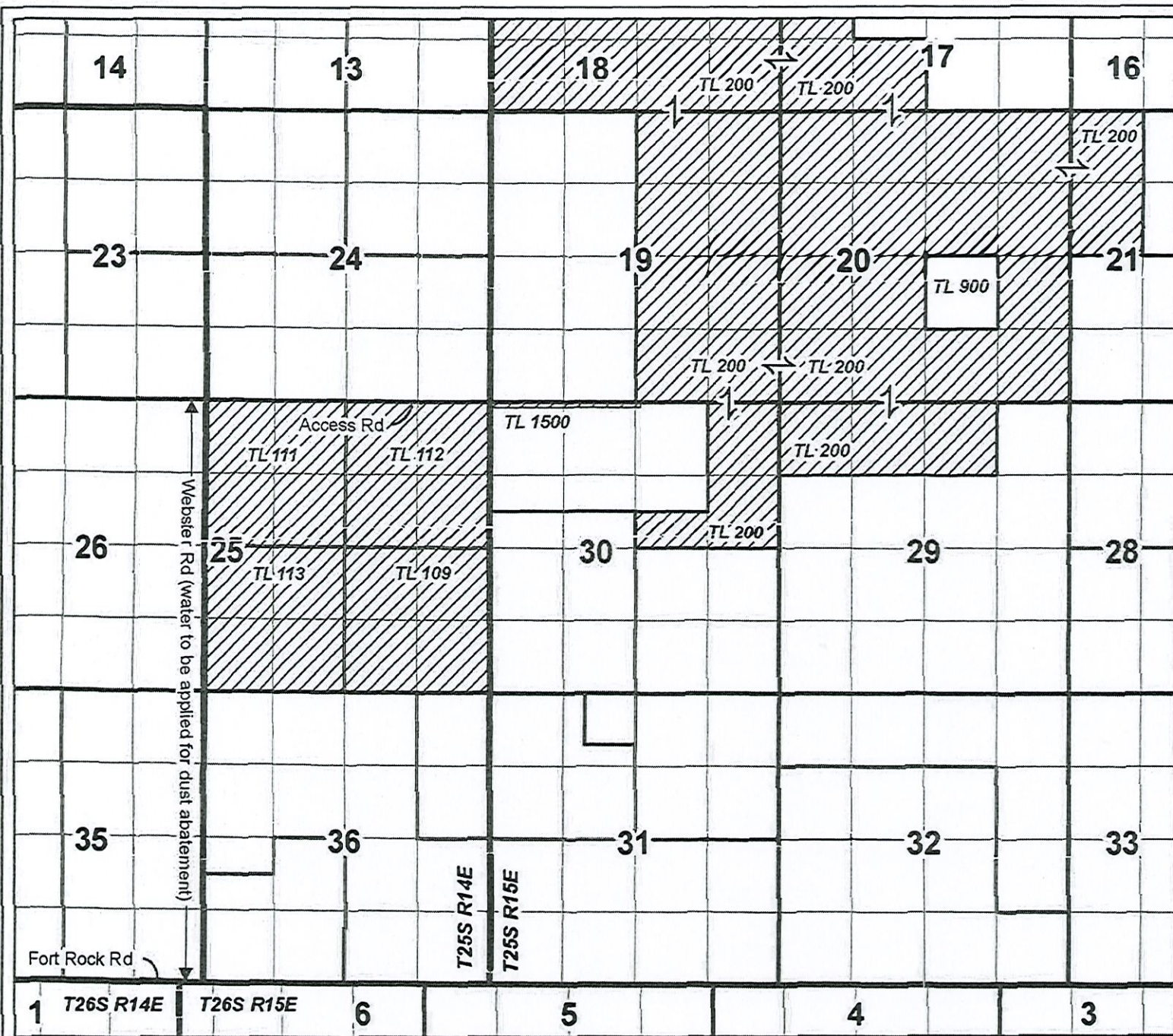

**LIMITED LICENSE MAP**  
NewSun Cascade Development  
Services LLC

This map is not intended  
to provide legal dimensions  
or locations of property  
ownership lines.

**WATER RIGHT SERVICES, LLC**  
PO BOX 1830, BEND, OR 97709  
WWW.OREGONWATER.US CCB # 197121  
johnshort@usa.com 541-389-2837

LL-1981







**T25S R15E &  
T25S R14E, WM  
LAKE COUNTY, OR**

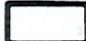

0 2,640 Feet

1" = 2640'

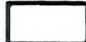
-  Place of Use
-  Township
-  Section
-  Quarter Quarter
-  Tax Lot

Received  
JUN 13 2024  
OWRD

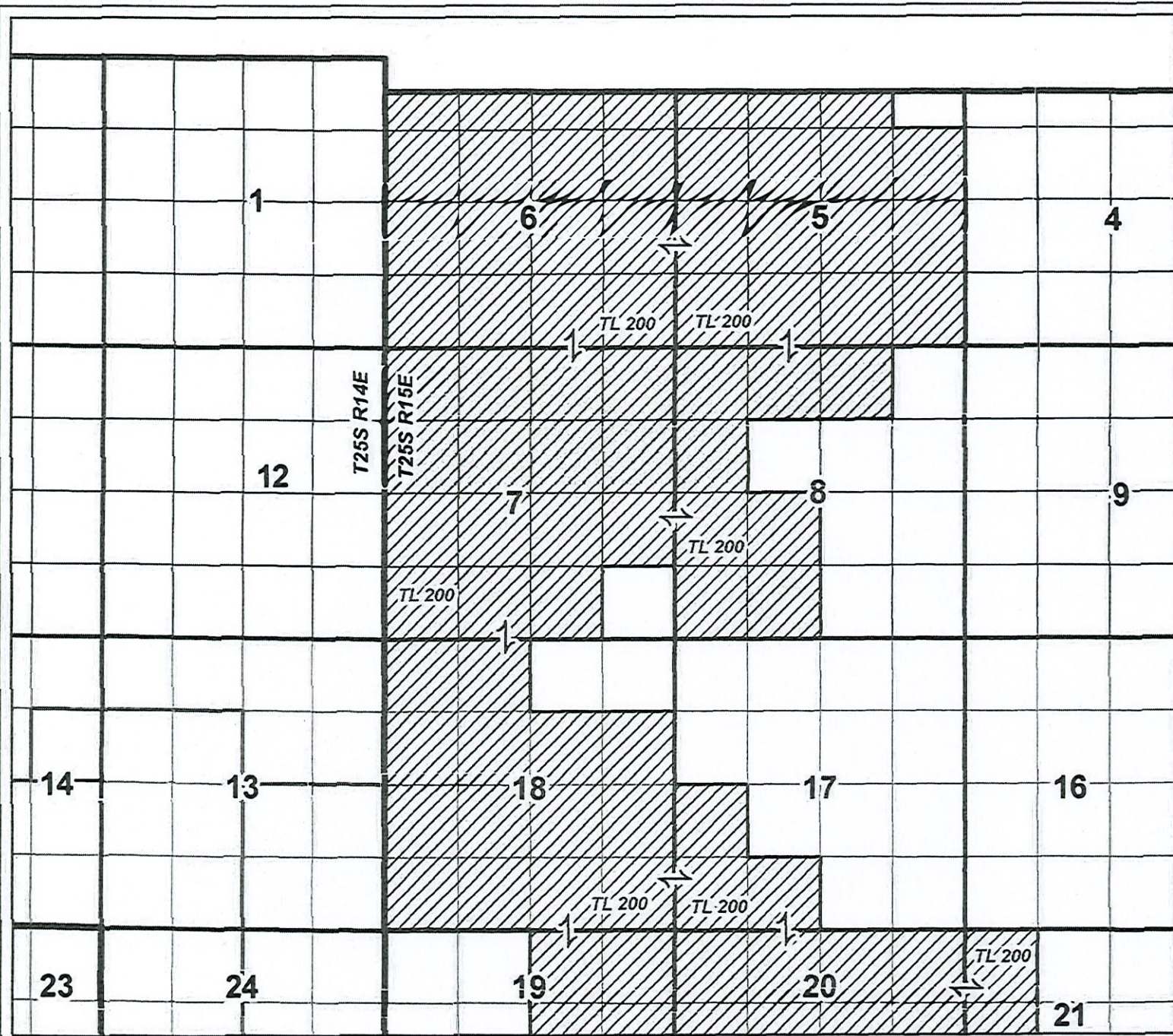

**LIMITED LICENSE MAP**  
NewSun Cascade Development  
Services LLC

This map is not intended  
to provide legal dimensions  
or locations of property  
ownership lines.

**WATER RIGHT SERVICES, LLC**  
PO BOX 1830, BEND, OR 97709  
[WWW.OREGONWATER.US](http://WWW.OREGONWATER.US) CCB # 197121  
johnshort@usa.com 541-389-2837

LL-1981



**T26S R14E &  
T26S R15E, WM,  
LAKE COUNTY, OR**

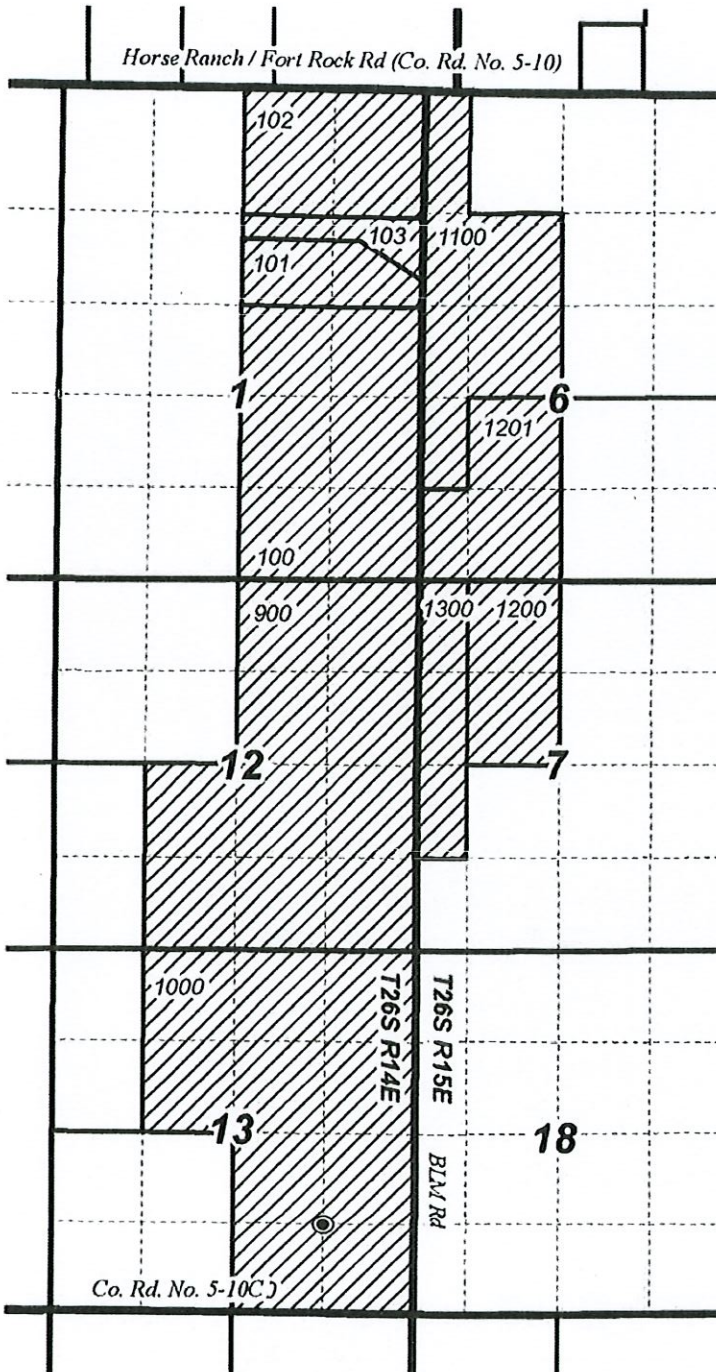
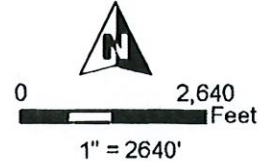

- Well
- Township
- Section
- - - - Quarter Quarter
- ▨ Place of Use

Well Location:  
Well (LAKE 341) Location:  
1330' N, 1310' W of SE Cor Sec 13

Received  
JUN 13 2024  
OWRD



**LIMITED LICENSE MAP**

NewSun Cascade Development Services LLC

This map is not intended to provide legal dimensions or locations of property ownership lines.

**WATER RIGHT SERVICES, LLC**

PO BOX 1830, BEND, OR 97709

[WWW.OREGONWATER.US](http://WWW.OREGONWATER.US) 541-389-2837

[johnshort@usa.com](mailto:johnshort@usa.com)

CCB # 197121