

# TOWNSHIP 18 SOUTH, RANGE 2 WEST, W.M.

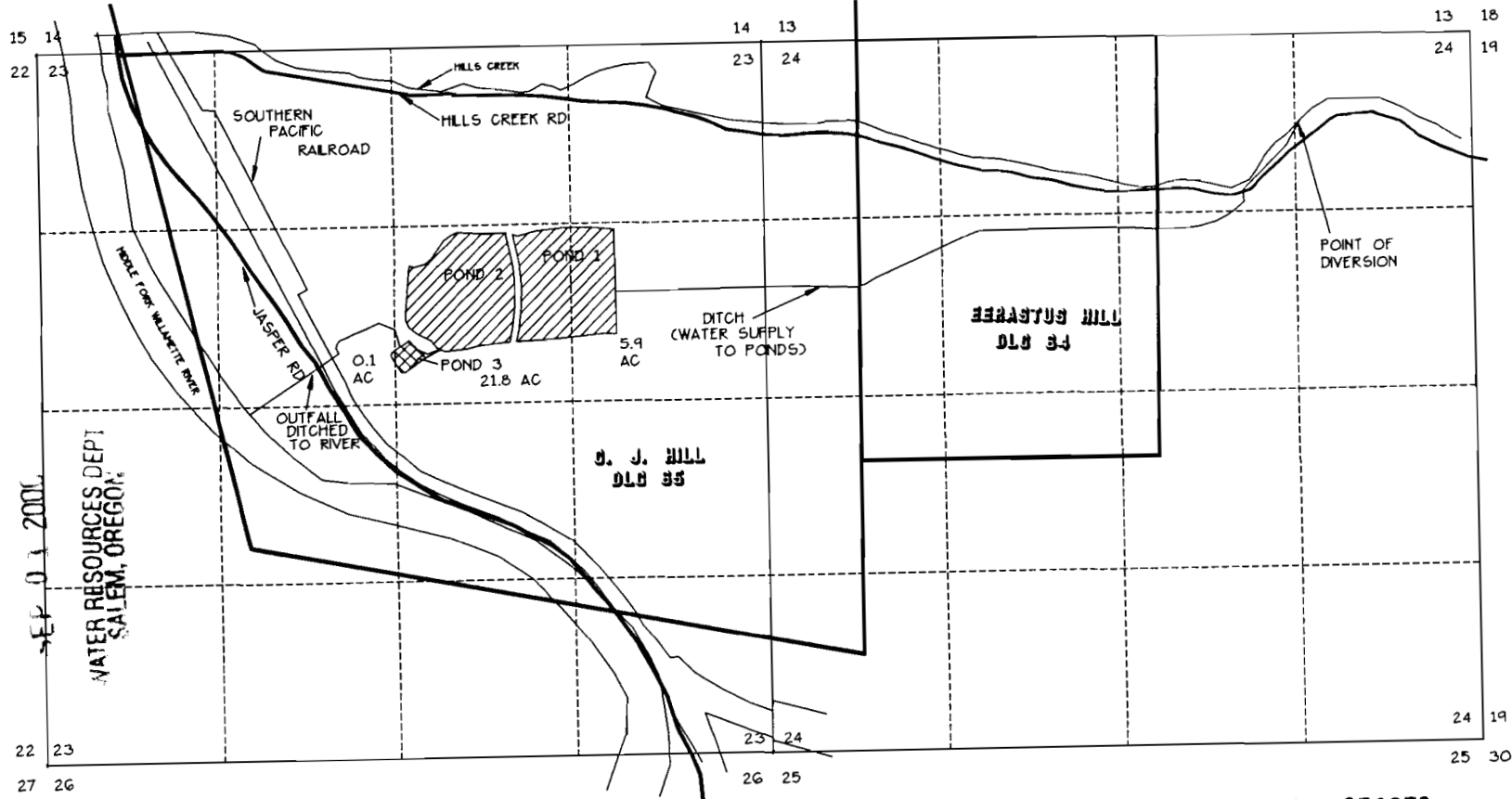

RECEIVED

SEP 01 2001

WATER RESOURCES DEPT  
SALEM, OREGON

## DIVERSION POINT LOCATION

652 FEET SOUTH AND 1290 FEET WEST OF  
THE NORTHEAST CORNER OF SECTION 24.

## POND LOCATION AREA



DENOTES AREA FOR WETLAND ENHANCEMENT



DENOTES AREA FOR FIRE PROTECTION

## NOTE

THIS MAP WAS PREPARED FOR THE PURPOSE OF IDENTIFYING  
THE LOCATION OF THE WATER RIGHT ONLY. IT IS NOT  
INTENDED TO PROVIDE DIMENSIONS OR LOCATION OF  
PROPERTY OWNERSHIP LINES.

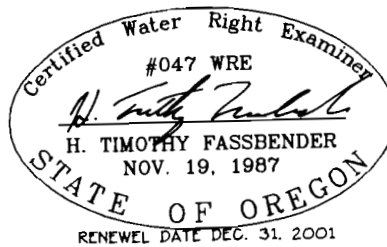

FINAL ORDER R80846 & S13972  
FINAL PROOF SURVEY

FOR  
J.E.N. HILL CO. & PACIFIC RIM MFG CO.  
C/O KEN BRONSON  
P.O. BOX 2236  
JASPER, OREGON 97438  
PH (541) 747-5025

BY  
FORD - NESS - FASSBENDER  
PO BOX  
P.O. BOX 22735  
EUGENE, OREGON, 97402  
PH (541) 344-1852  
AUGUST 30, 2000

SCALE  
1" = 1320'