

TOWNSHIP 18 SOUTH, RANGE 2 WEST, W.M.

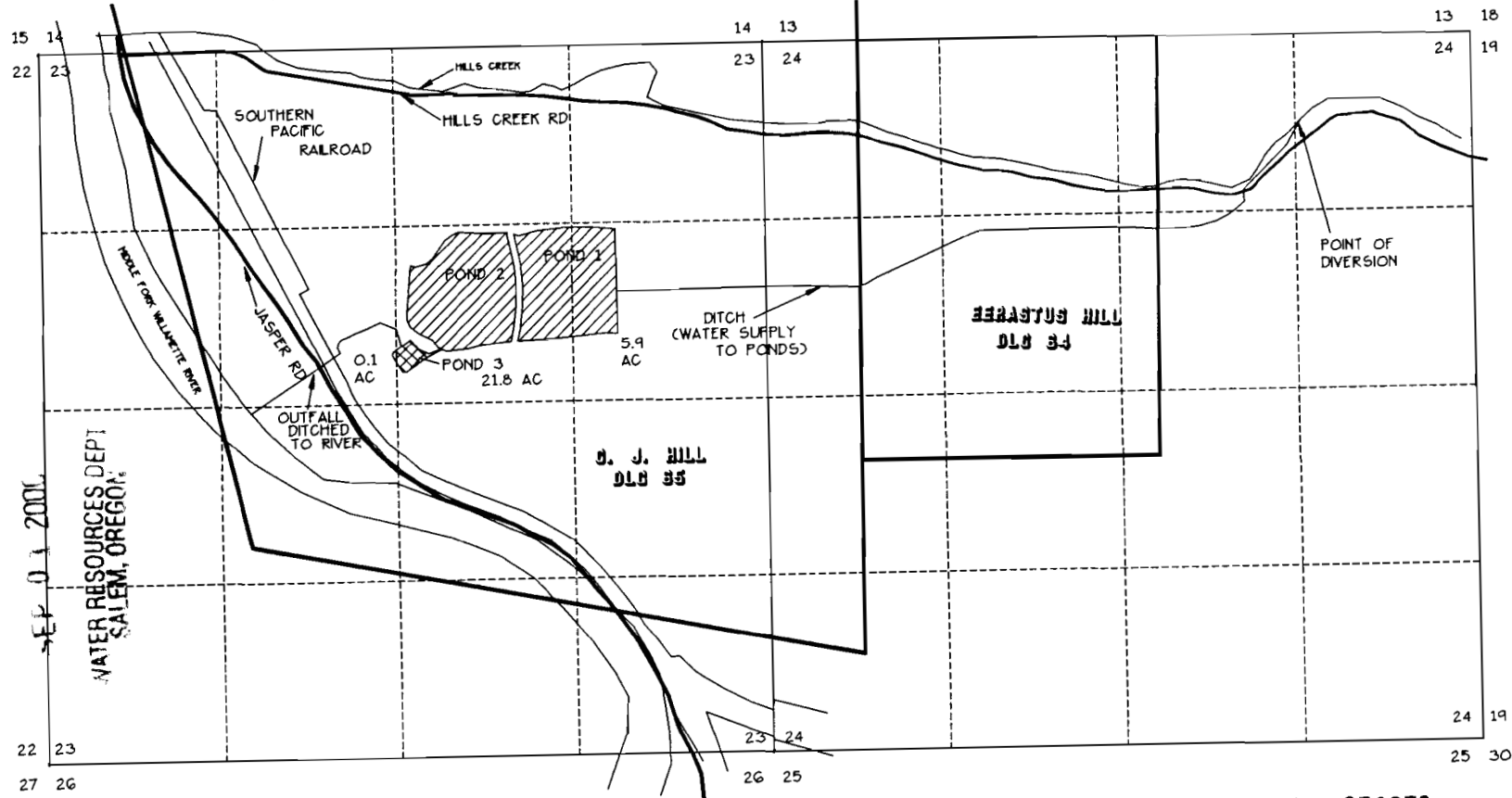

RECEIVED

WATER RESOURCES DEPT
SALEM, OREGON

DIVERSION POINT LOCATION

652 FEET SOUTH AND 1290 FEET WEST OF
THE NORTHEAST CORNER OF SECTION 24.

POND LOCATION AREA



DENOTES AREA FOR WETLAND ENHANCEMENT



DENOTES AREA FOR FIRE PROTECTION

NOTE

THIS MAP WAS PREPARED FOR THE PURPOSE OF IDENTIFYING
THE LOCATION OF THE WATER RIGHT ONLY. IT IS NOT
INTENDED TO PROVIDE DIMENSIONS OR LOCATION OF
PROPERTY OWNERSHIP LINES.

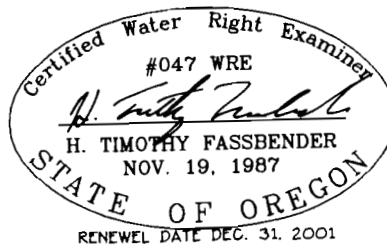

FINAL ORDER R80846 & S13972
FINAL PROOF SURVEY

FOR
J.E.N. HILL CO. & PACIFIC RIM MFG CO.
C/O KEN BRONSON
P.O. BOX 2236
JASPER, OREGON 97438
PH (541) 747-5025

BY
FORD - NESS - FASSBENDER
PO BOX
P.O. BOX 22735
EUGENE, OREGON, 97402
PH (541) 344-1852
AUGUST 30, 2000

SCALE
1" = 1320'