

RECEIVED  
 JUL 25 2003  
 WATER RESOURCES DEPT  
 SALEM, OREGON

Scale 1"=1320'

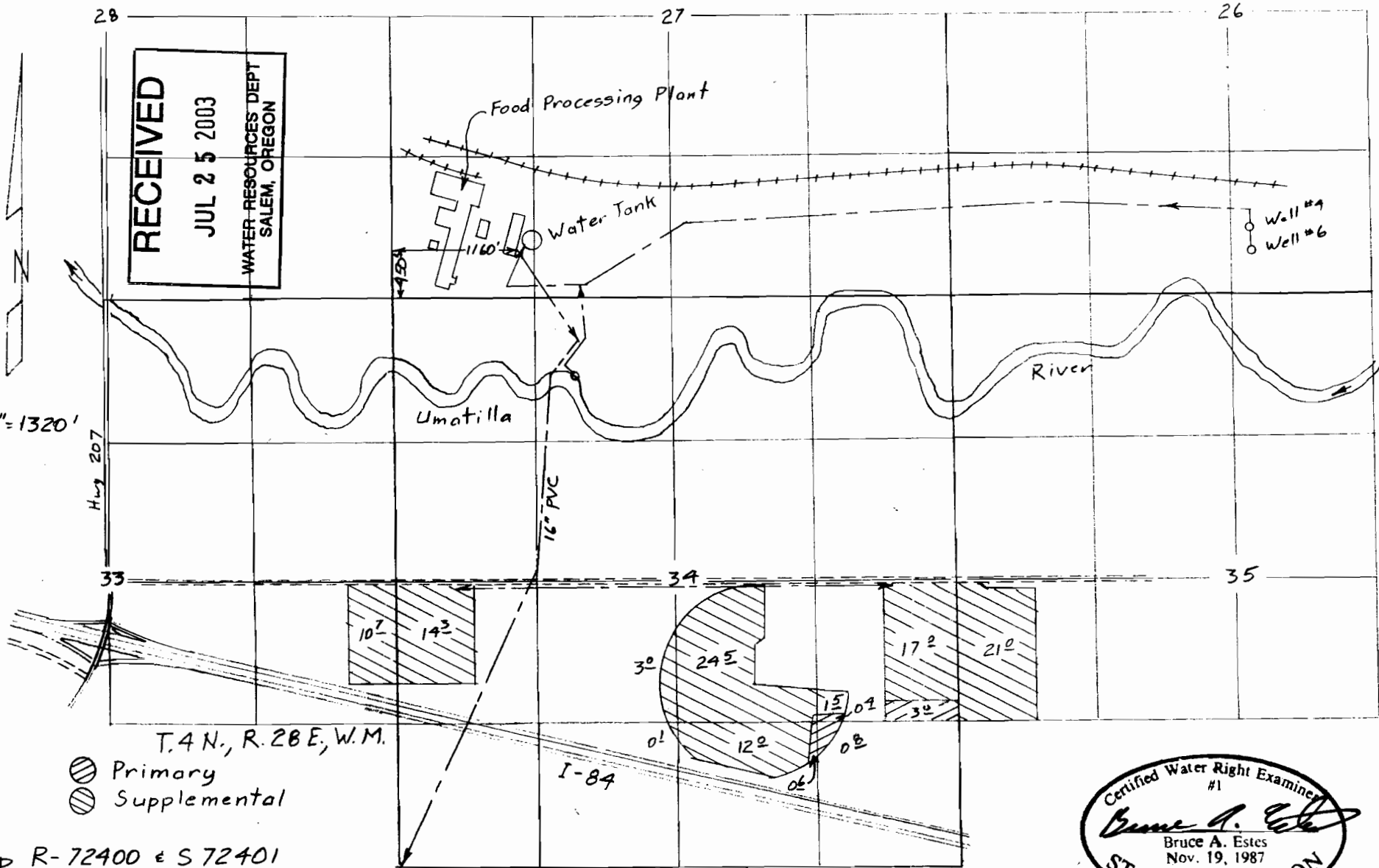

T.4N., R.28E., W.M.  
 (Primary)  
 (Supplemental)

App R-72400 & S 72401  
 Per R-12130 & 53063

Surveyed April 25 & 26 and August 9 & 10, 2002

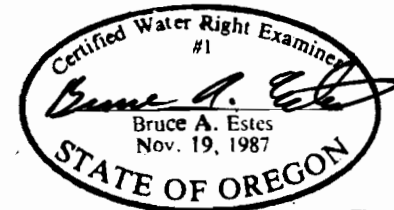

Renewal Dec 31, 2003

Sheet 1 of 4

Claim of Beneficial Use Map  
 for  
 J. R. SIMPLOT CO.

This map is for the purpose of  
 locating a water right only  
 and has no intent to provide  
 legal dimensions or the location  
 of property lines.

**ESTES SURVEYS, LLC**  
 PO Box 17519 60382 Arnold Rd  
 Salem, OR 97305-7519 Bend, OR 97702  
 (503) 585-7593 (541) 382-7391