

THIS MAP WAS PREPARED FOR THE PURPOSE OF IDENTIFYING THE LOCATION OF THE WATER RIGHT AND IS NOT INTENDED TO PROVIDE LEGAL DIMENSIONS OR LOCATIONS OF PROPERTY OWNERSHIP LINES.

RECEIVED

AUG 31 1999

WATER RESOURCES DEPT.
SALEM, OREGON

T 10 S ; R 4 W

7 8

PROPERTY LINE

LEVEE

SPILLWAY, EL. 206.0

DAM, EL. 208.5

NE $\frac{1}{4}$ 7 8 NW $\frac{1}{4}$

HWY. 99W

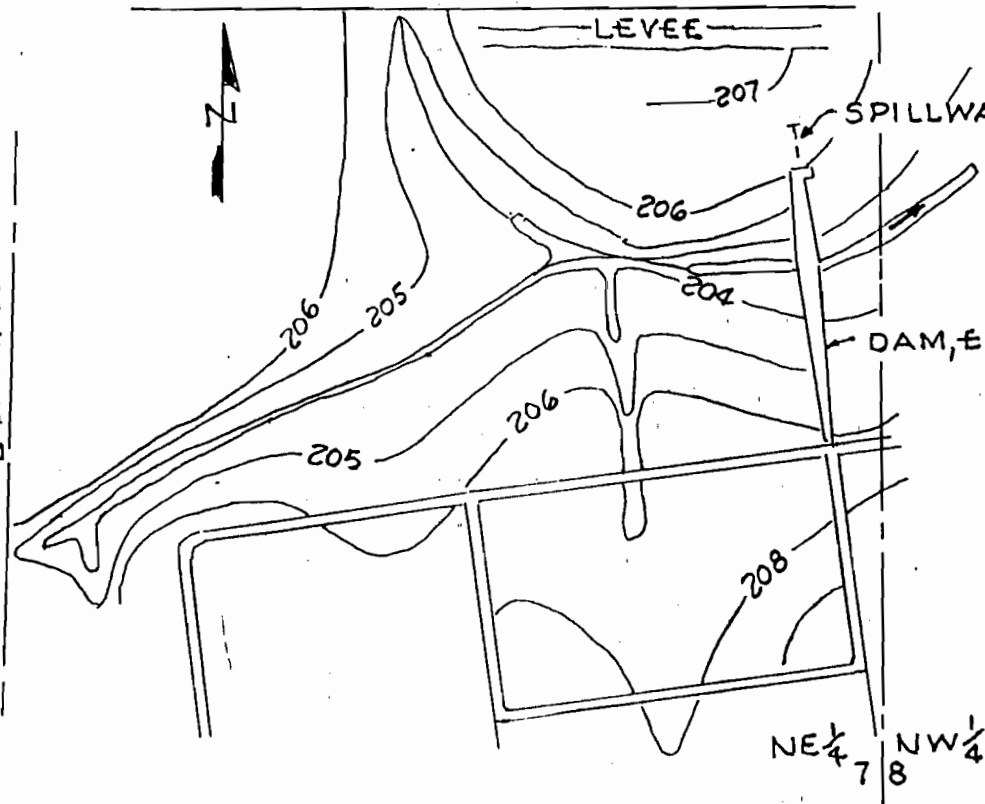

SITE PLAN
1" = 400'

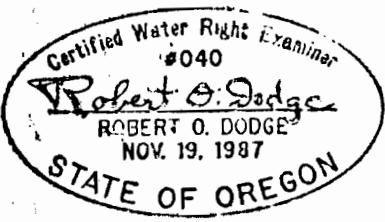

FINAL PROOF SURVEY
UNDER

APPLICATION NO. 72425 PERMIT NO. R-11540
IN NAME OF

OREGON DEPARTMENT OF FISH AND WILDLIFE

SURVEYED: 8/25/99 BY: DODGE