



Oregon Water Resources Department  
 725 Summer Street NE, Suite A  
 Salem, Oregon 97301  
 (503) 986-0900  
 www.wrd.state.or.us

# Ownership Update For Certificated Rights Only

## NO FEES ARE REQUIRED TO SUBMIT THIS FORM

**NOTICE:** A certificate of water right typically stays with the land. In order to track water right ownership, the Department requests that this form be submitted to the Department. **To update multiple rights, a separate form is required for each right.**

If you have any questions about this form, please contact your local watermaster, or call the Water Resources Department at (503) 986-0900.

This form is not for Applications, Permits, Transfers, Groundwater Registrations, or Limited Licenses. To notify the Department of changes in ownership to these types of authorizations, an Assignment is required.

### Current Landowner Information

Name: Oregon Parks & Recreation Dept  
 Mailing Address: 725 Summer St NE & Suite C  
 City: Salem State: OR Zip: 97301  
 Phone (Home): \_\_\_\_\_ Work: 800-551-6949 Other: \_\_\_\_\_

### Property Description

County: Clackamas Township: 3S Range: 3&4E Section: 13 & 18

Taxlot Number(s): \_\_\_\_\_

Street Address of water right property: Milo McIver State Park Estacada OR 97023

Water Right Information: Application: S - 44003 Permit: S - 32895 Certificate #: 44146

Are all the lands associated with this water right owned by the requester? Yes \_\_\_\_\_ No \_\_\_\_\_ If No, include a map showing the portion of the right involved.

Name of individual completing this form: <sup>ODOT</sup> Katie Kroenlein Huber Phone: 971 718 6681

Signature of requestor: Katie K. Huber Date: 6-25-2024

The Department does not change names on certificates. This form will be placed in the file for future reference only. The Department does not provide acknowledgement that this form has been received.

Received  
 JUN 26 2024  
 WR  
 OWRD

Milo McIver State Park

Contact Information (Click to Collapse...)

▼ Contact information

OWNER:  
▶ OREGON DEPARTMENT OF TRANSPORTATION  
301 STATE HWY BUILDING  
SALEM, OR 97302

Water Right Information (Click to Collapse...)

**Status:** Non-Cancelled  
**County:** Clackamas  
**Basin:** Willamette  
**File Folder Location:** Salem  
[Watermaster District:](#) 20

Scanned Documents (Click to Expand...)

Point(s) of Diversion (Click to Collapse...)

▶ [POD 1 - CLACKAMAS RIVER > WILLAMETTE RIVER](#)

Place(s) of Use (Click to Collapse...)

[Add TRS grouping](#)

▶ **Use - IRRIGATION**  
**(Primary) - 72.6 acres; Priority Date: 8/24/1967**

Water Right Genealogy (Click to Collapse...)

---No genealogy records available for this water right, try the family link below instead.

[View Water Rights in same Family](#)

[Report Errors with Water Right Data](#)

Processing History (Click to Collapse...)

- ▶ **Application: S 44003**
- ▶ **Permit: S 32895 [document](#)**
- ▼ **Certificate: 44146 [document](#) , [paper map](#)**
  - ▶ Staff Person Responsible: no caseworker currently assigned
  - ▶ Signature: 3/9/1977
  - ▶ Type: Original
  - ▶ [View right with Web Mapping](#)
  - ▶ [View Places of Use from Water Rights in the Same Area](#)
  - ▶ [View Reported Water Use](#)

Received  
JUN 26 2024  
OWRD

RECEIVED  
JUN 26 1967  
STATE ENGINEER  
Salem, Oregon

Permit No. 32895

\*APPLICATION FOR PERMIT

CERTIFICATE NO. 44146

# To appropriate the Public Waters of the State of Oregon

I, Oregon State Parks and Recreation Division of the Oregon State Highway Dept.  
(Name of applicant)  
of Room 301 Highway Building Salem,  
(Mailing address)  
State of Oregon, do hereby make application for a permit to appropriate the

following described public waters of the State of Oregon, **SUBJECT TO EXISTING RIGHTS:**

If the applicant is a corporation, give date and place of incorporation

1. The source of the proposed appropriation is Clackamas River  
(Name of stream)  
, a tributary of Willamette River

2. The amount of water which the applicant intends to apply to beneficial use is 1.5  
cubic feet per second.  
(If water is to be used from more than one source, give quantity from each)

\*\*3. The use to which the water is to be applied is irrigation 1.5 c.f.s.  
(Irrigation, power, mining, manufacturing, domestic supplies, etc.)

4. The point of diversion is located 2350 ft. N and 700 ft. E from the SW  
(N. or S.) (E. or W.)  
corner of Sec. 18  
(Section or subdivision)

(If preferable, give distance and bearing to section corner)

(If there is more than one point of diversion, each must be described. Use separate sheet if necessary)  
being within the NW<sup>4</sup> SW<sup>4</sup> of Sec. 18, Tp. 3 S  
(Give smallest legal subdivision) (N. or S.)

R. 4 E, W. M., in the county of Clackamas  
(E. or W.)

5. The pipe line to be 5000'  
(Main ditch, canal or pipe line) (Miles or feet)  
in length, terminating in the SE<sup>4</sup> SW<sup>4</sup> of Sec. 18, Tp. 3 S  
(Smallest legal subdivision) (N. or S.)

R. 4 E, W. M., the proposed location being shown throughout on the accompanying map.  
(E. or W.)

## DESCRIPTION OF WORKS

### Diversion Works—

6. (a) Height of dam ..... feet, length on top ..... feet, length at bottom  
..... feet; material to be used and character of construction .....  
(Loose rock, concrete, masonry,  
rock and brush, timber crib, etc., wasteway over or around dam)

(b) Description of headgate .....  
(Timber, concrete, etc., number and size of openings)

(c) If water is to be pumped give general description 4" centrifugal  
(Size and type of pump)  
40 hp elec. 160' head  
(Size and type of engine or motor to be used, total head water is to be lifted, etc.)

\*A different form of application is provided where storage works are contemplated.

\*\*Application for permits to appropriate water for the generation of electricity, with the exception of municipalities, must be made to the Hydroelectric Commission. Either of the above forms may be secured, without cost, together with instructions by addressing the State Engineer, Salem, Oregon.

Received  
JUN 26 2024  
OWRD

Canal System or Pipe Line—

7. (a) Give dimensions at each point of canal where materially changed in size, stating miles from headgate. At headgate: width on top (at water line) ..... feet; width on bottom ..... feet; depth of water ..... feet; grade ..... feet fall per one thousand feet.

(b) At ..... miles from headgate: width on top (at water line) ..... feet; width on bottom ..... feet; depth of water ..... feet; grade ..... feet fall per one thousand feet.

(c) Length of pipe, 5000 ft.; size at intake, 6 in.; size at 1000 ft. from intake 4 in.; size at place of use 4 in.; difference in elevation between intake and place of use, 20 ft. Is grade uniform? Yes. Estimated capacity, 1.65 sec. ft.

8. Location of area to be irrigated, or place of use Milo McIver State Park

Township North or South	Range E. or W. of Williams Meridian	Section	Forty-acre Tract	Number Acres To Be Irrigated
3 S	3 E	13	SE <sup>4</sup> NE <sup>4</sup>	3
3 S	3 E	13	NE <sup>4</sup> SE <sup>4</sup>	26
3 S	3 E	13	SE <sup>4</sup> SE <sup>4</sup>	1
3 S	4 E	18	NW <sup>4</sup> SW <sup>4</sup>	30
3 S	4 E	18	SW <sup>4</sup> SW <sup>4</sup>	22
3 S	4 E	18	NE <sup>4</sup> SW <sup>4</sup>	8
3 S	4 E	18	SE <sup>4</sup> SW <sup>4</sup>	6
				TOTAL 96

(If more space required, attach separate sheet)

(a) Character of soil fine silt & gravel

(b) Kind of crops raised lawn and shrubs

Power or Mining Purposes—

9. (a) Total amount of power to be developed ..... theoretical horsepower.

(b) Quantity of water to be used for power ..... sec. ft.

(c) Total fall to be utilized ..... feet.  
(Head)

(d) The nature of the works by means of which the power is to be developed .....

(e) Such works to be located in ..... of Sec. ....  
(Legal subdivision)

Tp. ...., R. ...., W. M. ....  
(No. N. or S.) (No. E. or W.)

(f) Is water to be returned to any stream? .....  
(Yes or No)

(g) If so, name stream and locate point of return .....

....., Sec. ...., Tp. ...., R. ...., W. M. ....  
(No. N. or S.) (No. E. or W.)

(h) The use to which power is to be applied is .....

(i) The nature of the mines to be served .....

Received  
JUN 26 2024

OWRD

10. (a) To supply the city of Milo McIver State Park

(Name of) County, having a present population of \_\_\_\_\_  
and an estimated population of \_\_\_\_\_ in 19\_\_\_\_\_

(b) If for domestic use state number of families to be supplied \_\_\_\_\_

(Answer questions 11, 12, 13, and 14 in all cases)

11. Estimated cost of proposed works, \$ 33,000

12. Construction work will begin on or before 9-1-67

13. Construction work will be completed on or before 4-1-68

14. The water will be completely applied to the proposed use on or before 6-1-68

Walter H. Gashill  
(Signature of applicant)

Remarks: \_\_\_\_\_  
\_\_\_\_\_  
\_\_\_\_\_  
\_\_\_\_\_  
\_\_\_\_\_  
\_\_\_\_\_  
\_\_\_\_\_  
\_\_\_\_\_  
\_\_\_\_\_  
\_\_\_\_\_  
\_\_\_\_\_  
\_\_\_\_\_  
\_\_\_\_\_  
\_\_\_\_\_  
\_\_\_\_\_  
\_\_\_\_\_  
\_\_\_\_\_  
\_\_\_\_\_  
\_\_\_\_\_  
\_\_\_\_\_  
\_\_\_\_\_  
\_\_\_\_\_

STATE OF OREGON, }  
County of Marion, } ss.

This is to certify that I have examined the foregoing application, together with the accompanying maps and data, and return the same for \_\_\_\_\_  
\_\_\_\_\_

In order to retain its priority, this application must be returned to the State Engineer, with corrections on or before \_\_\_\_\_, 19\_\_\_\_\_

WITNESS my hand this \_\_\_\_\_ day of \_\_\_\_\_, 19\_\_\_\_\_

Received  
JUN 26 2024  
OWRD

By \_\_\_\_\_ STATE ENGINEER  
ASSISTANT

PERMIT

STATE OF OREGON, }  
County of Marion, } ss.

This is to certify that I have examined the foregoing application and do hereby grant the same, SUBJECT TO EXISTING RIGHTS and the following limitations and conditions:

The right herein granted is limited to the amount of water which can be applied to beneficial use and shall not exceed 1.20 cubic feet per second measured at the point of diversion from the stream, or its equivalent in case of rotation with other water users, from Clackamas River

The use to which this water is to be applied is irrigation

If for irrigation, this appropriation shall be limited to 1/80th of one cubic foot per second or its equivalent for each acre irrigated and shall be further limited to a diversion of not to exceed 2 1/2 acre feet per acre for each acre irrigated during the irrigation season of each year,

and shall be subject to such reasonable rotation system as may be ordered by the proper state officer.

The priority date of this permit is August 24, 1967

Actual construction work shall begin on or before April 17, 1969 and shall thereafter be prosecuted with reasonable diligence and be completed on or before October 1, 1970

Complete application of the water to the proposed use shall be made on or before October 1, 1971

WITNESS my hand this 17th day of April, 1968

*Chris J. Whemler*

STATE ENGINEER

Received  
JUN 26 2024  
OWRD

Application No. 44463  
Permit No. 32895

PERMIT

TO APPROPRIATE THE PUBLIC WATERS OF THE STATE OF OREGON

This instrument was first received in the office of the State Engineer at Salem, Oregon, on the 24th day of August, 1967, at 8:00 o'clock A. M.

Returned to applicant:

Approved:

April 17, 1968

Recorded in book No. 32895 of

Permits on page 32895

CHRIS J. WHEMLER  
STATE ENGINEER

Drainage Basin No. 8 page 6a  
Fees 4.50

## STATE OF OREGON

COUNTY OF CLACKAMAS

## CERTIFICATE OF WATER RIGHT

This Is to Certify, That

OREGON STATE PARKS AND RECREATION DIVISION  
OREGON STATE HIGHWAY DEPARTMENT

of **Rm. 301 Highway Building, Salem**, State of **Oregon, 97310**, has made proof to the satisfaction of the Water Resources Director, of a right to the use of the waters of **Clackamas River**

a tributary of **Willamette River** for the purpose of irrigation of **72.6 acres**

under Permit No. **32895** and that said right to the use of said waters has been perfected in accordance with the laws of Oregon; that the priority of the right hereby confirmed dates from **August 24, 1967** that the amount of water to which such right is entitled and hereby confirmed, for the purposes aforesaid, is limited to an amount actually beneficially used for said purposes, and shall not exceed **0.9 cubic foot per second**

or its equivalent in case of rotation, measured at the point of diversion from the stream. The point of diversion is located in the **Lot 1 (NW $\frac{1}{4}$  SW $\frac{1}{4}$ ), Section 18, T. 3 S., R. 4 E., T. M., 2490 feet North and 40 feet East from the SW Corner of Section 18.**

The amount of water used for irrigation, together with the amount secured under any other right existing for the same lands, shall be limited to **one-eightieth** of one cubic foot per second per acre, or its equivalent for each acre irrigated and shall be further limited to a diversion of not to exceed **2 $\frac{1}{2}$  acre feet per acre** for each acre irrigated during the irrigation season of each year,

and shall conform to such reasonable rotation system as may be ordered by the proper state officer.

A description of the place of use under the right hereby confirmed, and to which such right is appurtenant, is as follows:

<b>1.2 acres Lot 7 (SE<math>\frac{1}{4}</math> NE<math>\frac{1}{4}</math>)</b>	<b>9.2 acres Lot 1 (NW<math>\frac{1}{4}</math> SW<math>\frac{1}{4}</math>)</b>
<b>21.5 acres Lot 7 (NE<math>\frac{1}{4}</math> SE<math>\frac{1}{4}</math>)</b>	<b>2.5 acres Lot 2 (SW<math>\frac{1}{4}</math> SW<math>\frac{1}{4}</math>)</b>
<b>Section 13</b>	<b>5.0 acres SW<math>\frac{1}{4}</math> SW<math>\frac{1}{4}</math></b>
<b>T. 3 S., R. 3 E., W. M.</b>	<b>6.4 acres SE<math>\frac{1}{4}</math> SW<math>\frac{1}{4}</math></b>
<b>11.8 acres NE<math>\frac{1}{4}</math> SW<math>\frac{1}{4}</math></b>	<b>Both projected within Young DLC 42</b>
<b>15.0 acres NW<math>\frac{1}{4}</math> SW<math>\frac{1}{4}</math></b>	<b>Section 18</b>
<b>Both projected within Young DLC 42</b>	<b>T. 3 S., R. 4 E., W. M.</b>

The right to the use of the water for the purposes aforesaid is restricted to the lands or place of use herein described, and is subject to the existing minimum flow policies established by the Water Policy Review Board.

WITNESS the signature of the Water Resources Director, affixed

this date. March 9, 1977

Received

JUN 26 2024

James E. Sexson  
Water Resources Director

OWRD

Recorded in State Record of Water Right Certificates, Volume 36, page 44146

T.3S. R.3 & 4E. W.M.

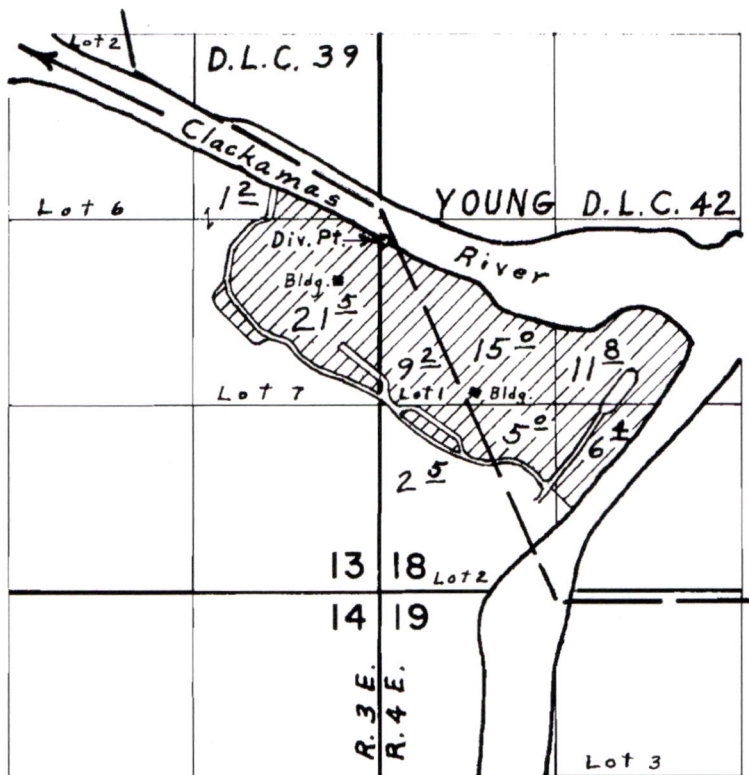

Div. Pt. located 2490' N. & 40' E. from S.W. Cor. Sec. 18

FINAL PROOF SURVEY

UNDER

Application No. 44003 Permit No. 32895

IN NAME OF

OREGON STATE PARKS

Surveyed May 30, 1975, by L. E. Gould

Received  
JUN 26 2024

OWRD



T.3S. R.3 & 4 E. W.M.

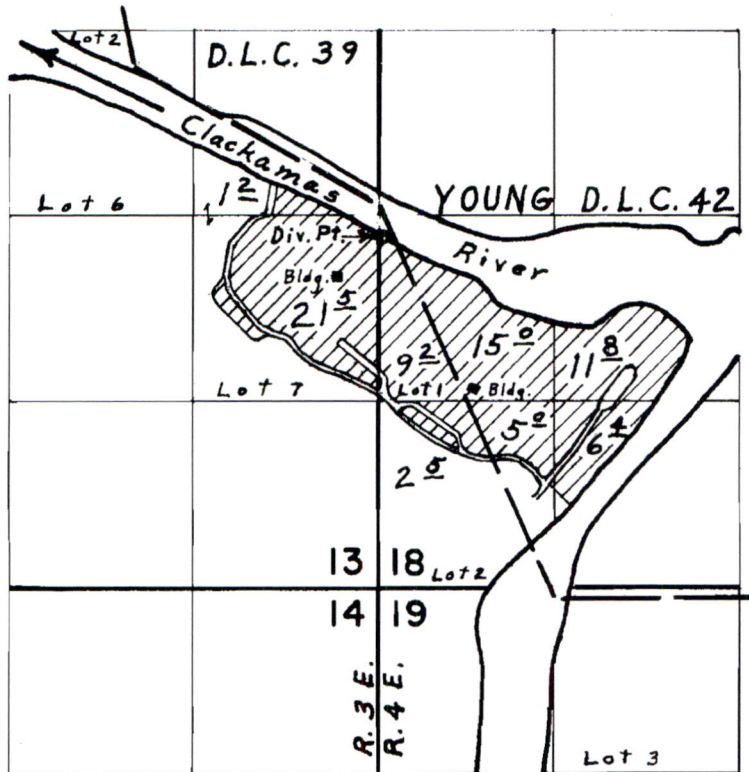

Div. Pt. located 2490' N. & 40' E. from S.W. Cor. Sec. 18

FINAL PROOF SURVEY

UNDER

Application No. 44003 Permit No. 32895

IN NAME OF

OREGON STATE PARKS

Surveyed May 30, 1975, by L. E. Gould

Received  
JUN 26 2024  
OWRD