

T1N, R3E, W.M. SECTION 19

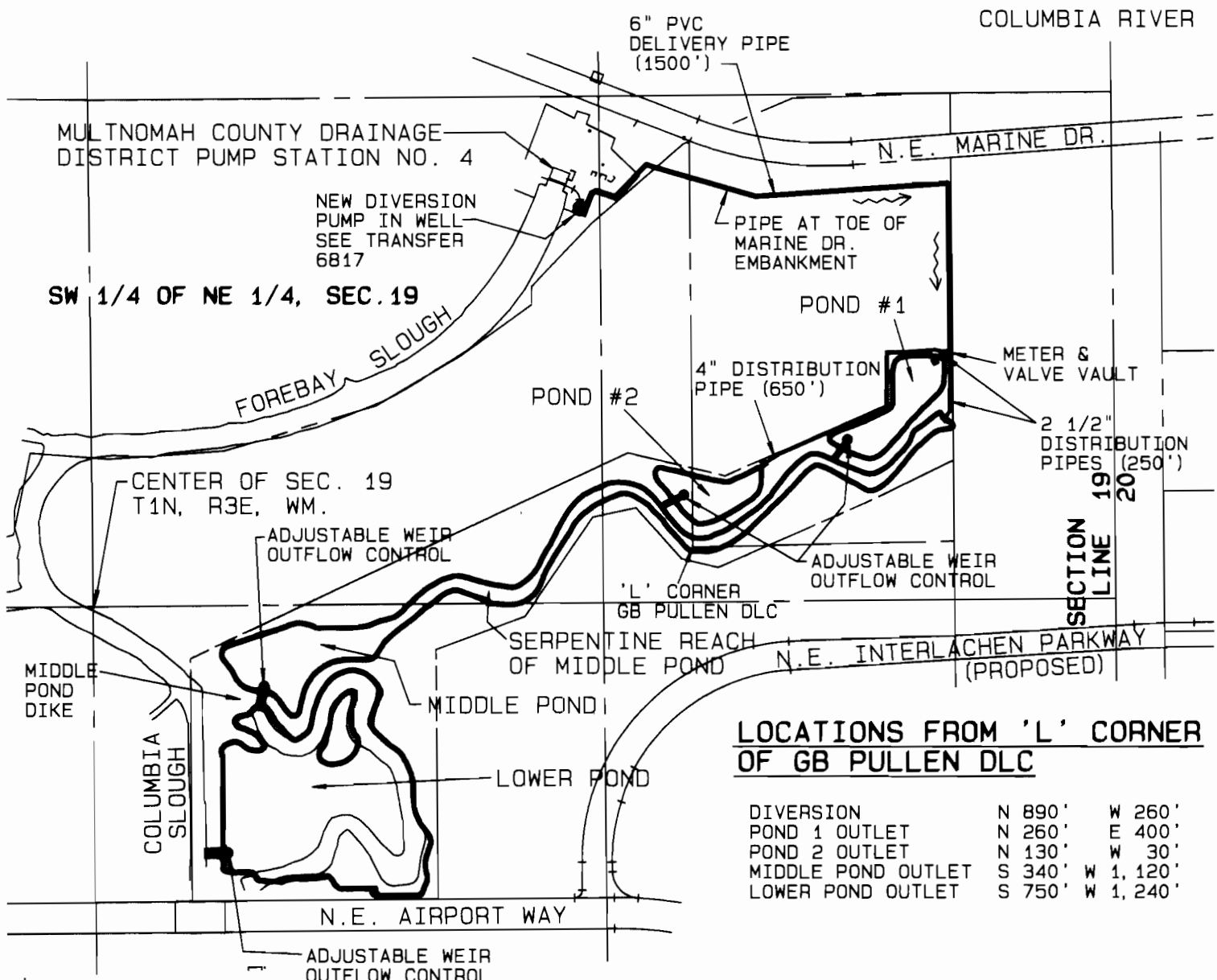

LOCATIONS FROM 'L' CORNER OF GB PULLEN DLC

DIVERSION	N 890'	W 260'
POND 1 OUTLET	N 260'	E 400'
POND 2 OUTLET	N 130'	W 30'
MIDDLE POND OUTLET	S 340'	W 1,120'
LOWER POND OUTLET	S 750'	W 1,240'

FINAL PROOF SURVEY

UNDER APPLICATION NO. R-72641 / PERMIT NO. R-11486
 IN THE NAME OF:
 DONALD COVILLE, CITY OF PORTLAND, AND
 TIM HAYFORD, MULTNOMAH CO. DRAINAGE DISTRICT NO. 1
 SURVEYED NOVEMBER 17, 1995

SCALE
 1"=400'



FILED
 MAR 28 1996
 WATER RESOURCES DEPT.
 SALEM, OREGON

PREPARATION OF THIS MAP WAS FOR THE PURPOSE OF IDENTIFYING THE LOCATION OF THE RESERVOIRS ONLY AND HAS NO INTENT TO PROVIDE DIMENSIONS OR LOCATION OF PROPERTY OWNERSHIP LINES.