

X:\clients\Island City OR\562-10 General Consultation\Graphics\WR-562-10-FIG01\_Transfer.incd, 05/30/24, 8:14 AM

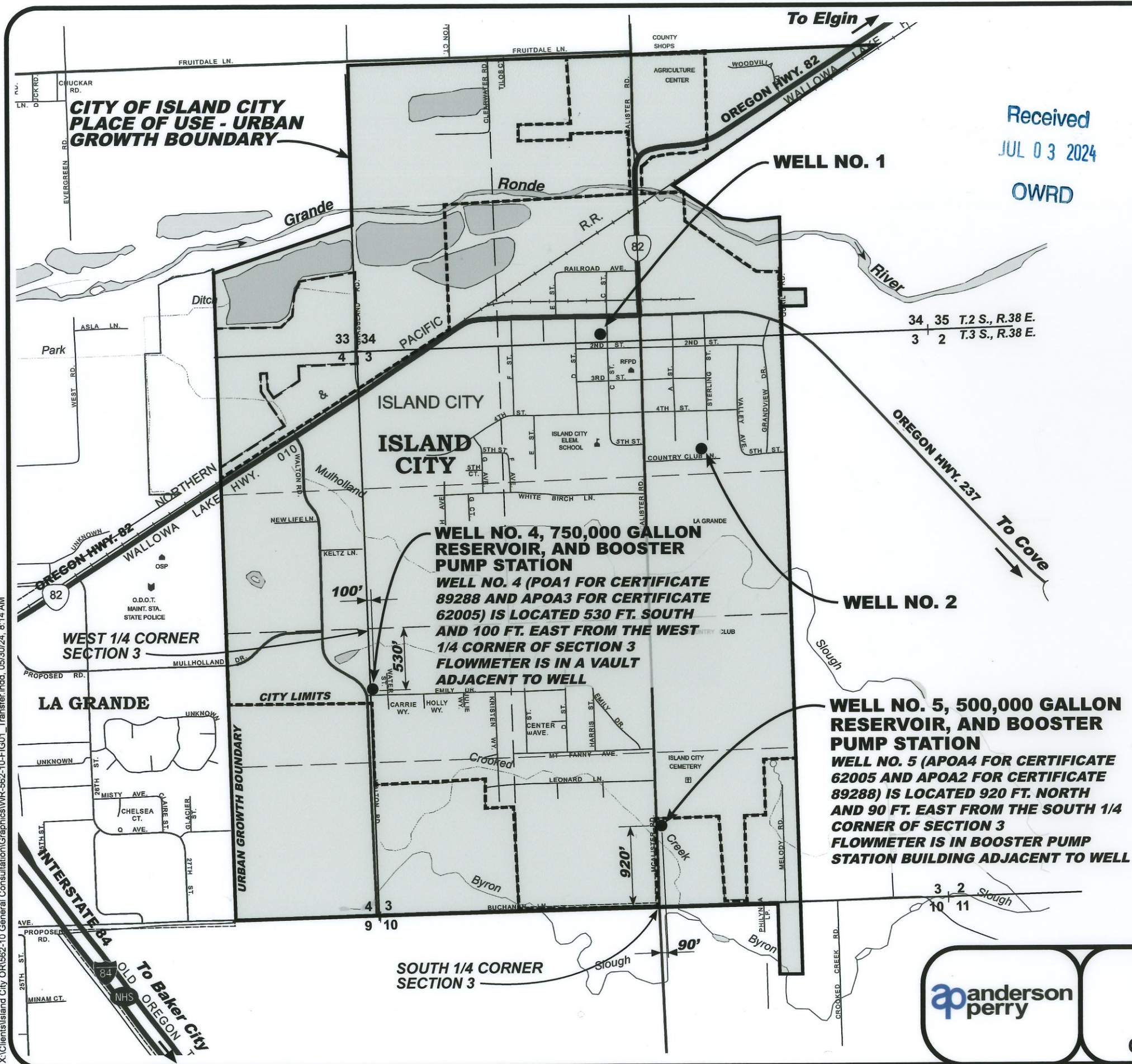

Received  
JUL 03 2024  
OWRD



**CITY OF ISLAND CITY PLACE OF USE**

IN T.2 S., R.38 E., W.M., UNION COUNTY, OREGON  
**SECTION 34**      **SECTION 33**  
 SE 1/4      SE 1/4 OF THE SE 1/4  
 SW 1/4

IN T.3 S., R.38 E., W.M., UNION COUNTY, OREGON  
**SECTION 3**      **SECTION 4**  
 W 1/2 OF THE NE 1/4      E 1/2 OF THE NE 1/4  
 NW 1/4      E 1/2 OF THE SE 1/4  
 SW 1/4      **SECTION 10**  
 W 1/2 OF THE SE 1/4      NW 1/4 OF THE NE 1/4

THIS MAP IS FOR THE PURPOSE OF LOCATING A WATER RIGHT ONLY AND IS NOT INTENDED TO PROVIDE LEGAL DIMENSIONS FOR LOCATIONS OF PROPERTY LINES.

DATE OF SURVEY: NOVEMBER 2023

**LEGEND**

- ISLAND CITY URBAN GROWTH BOUNDARY (UGB)
- ISLAND CITY CITY LIMITS
- SECTION LINE
- 1/4 SECTION LINE
- PLACE OF USE - ISLAND CITY UGB\*
- ISLAND CITY WELL

\*SPECIAL ORDER VOLUME 93, PAGES 734-739 NOTED THAT THE ORIGINAL SPECIAL ORDER APPROVING TRANSFER T-11760 CONTAINED AN ERROR IN THE DESCRIPTION OF THE PLACE OF USE, AND CORRECTED IT WITH THE REVISED SPECIAL ORDER. THE PURPOSE OF NOTING THE PROPOSED PLACE OF USE ON THIS CLAIM OF BENEFICIAL USE IS NOT TO DEFINE A CHANGE IN THE PLACE OF USE, BUT TO REFLECT THE ACCURATE DESCRIPTION OF THE PLACE OF USE DESCRIBED IN THE SPECIAL ORDER REFERENCED ABOVE.

**TRANSFER T-11760  
ADDITIONAL POINT OF APPROPRIATION**

	CERTIFICATE 62005		CERTIFICATE 89288	
WELL NO. 1	POA1	UNIO 639		
WELL NO. 2	POA2	UNIO 2477		
WELL NO. 4	APOA3	UNIO 2496	POA1	UNIO 2496
WELL NO. 5	APOA4	UNIO 52551	APOA2	UNIO 52551

CERTIFIED WATER RIGHT EXAMINER  
 87545  
  
 BRANDON A. MAHON  
 MAY 11, 2017  
 STATE OF OREGON 5/30/24

RENEWS: 12/31/24

**anderson perry**

CITY OF  
**ISLAND CITY, OREGON**  
 10605 ISLAND AVENUE, ISLAND CITY, OREGON 97850

**TRANSFER T-11760  
 CLAIM OF BENEFICIAL USE MAP**

SHEET  
**1 of 1**