

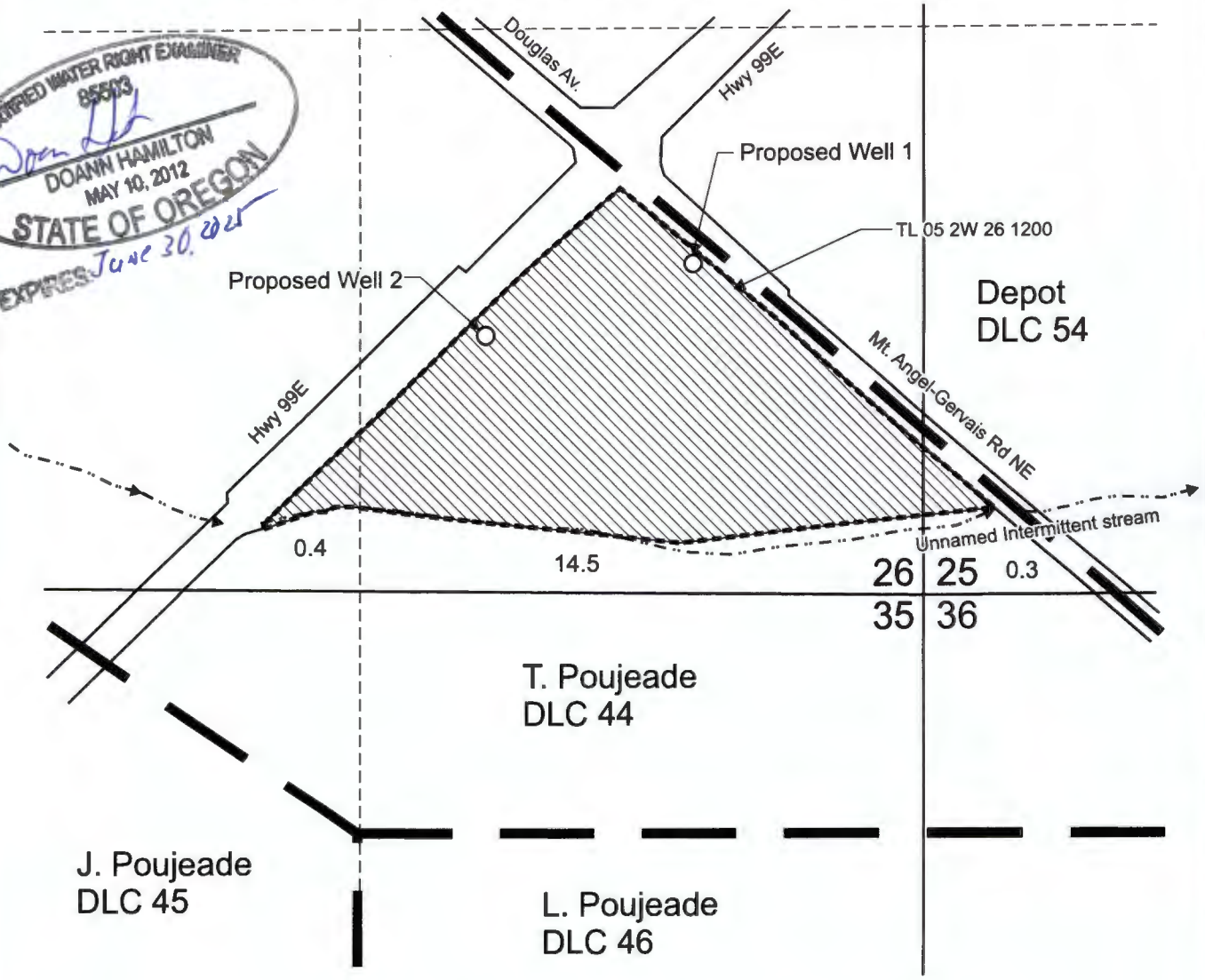



# T.5S. R.2W. Section 26, W.M.

**CERTIFIED WATER RIGHT EXAMINER**  
 85503  
*Doann Hamilton*  
**DOANN HAMILTON**  
 MAY 10, 2012  
**STATE OF OREGON**  
 EXPIRES *June 30, 2025*



Proposed Well 1 is located 770 feet north and 540 feet west from the SE corner, Section 26.  
 Proposed Well 2 is located 600 feet north and 1,025 feet west from the SE corner, Section 26.

-  Area (15.2 Acres) to be covered under nursery operations.
-  Tax lot boundary
-  Donation Land Claim boundary

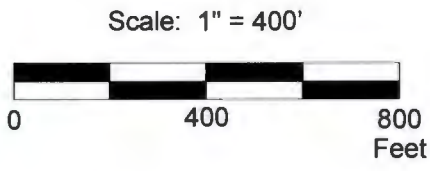

**Received**  
**JUL 11 2024**  
**OWRD**



This map was prepared for the purpose of identifying the location of a water right only and is not intended to provide legal dimensions or location of property ownership lines.

## Water Right Application Map

Pacific Hydro-Geology Inc.

Paul Kuschnick  
 T.5S. R.2W. Section 26, W.M.

07/2024

KuschnickGWAppMap.cdr