

T. 23 S., R. 26 E., R. 27 E., W.M.

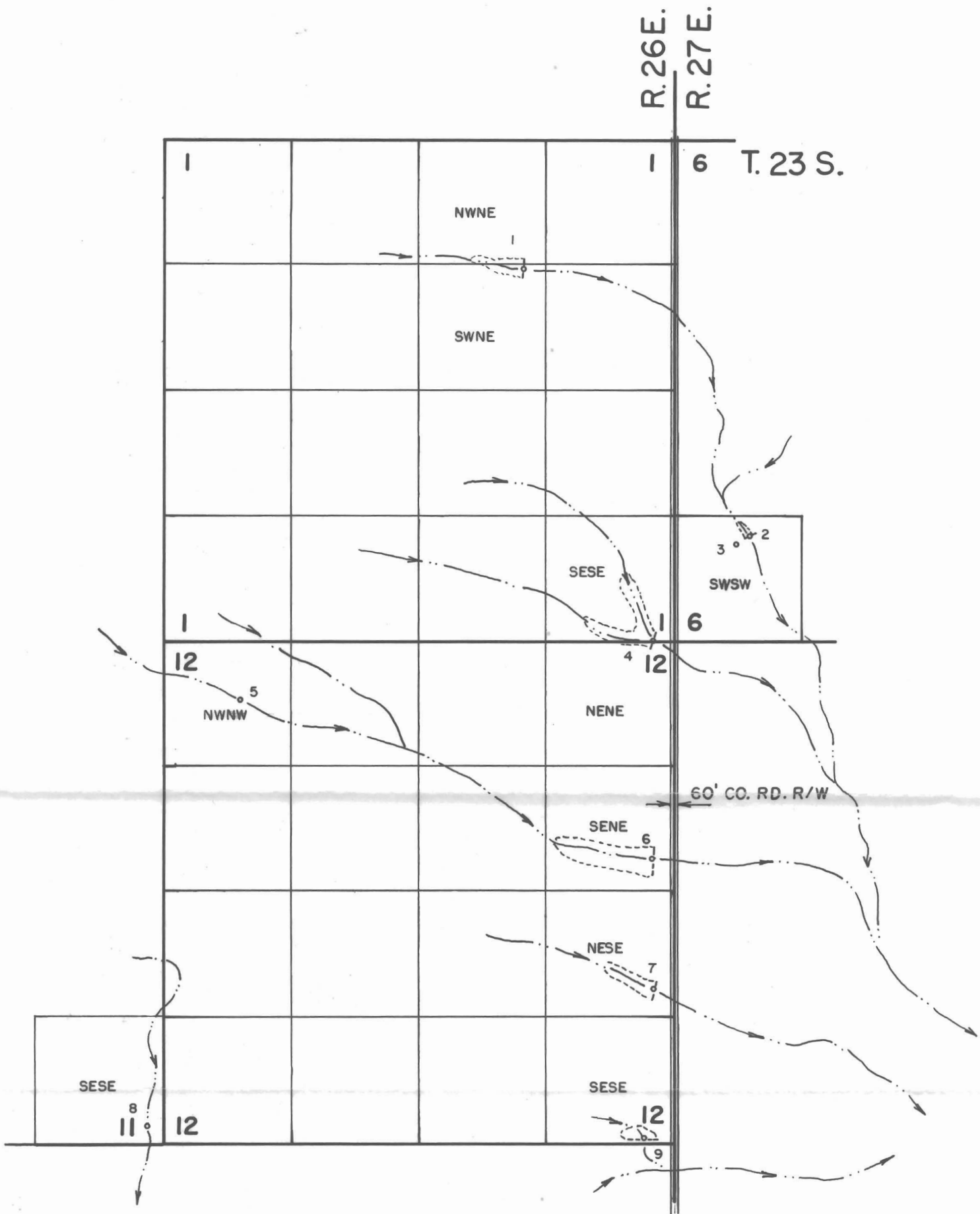

LOCATIONS

1	1350' S	1550' W	from NE COR.	SEC. 1
2	1110' N	800' E	" SW "	" 6
3	1035' N	675' E	" " "	" "
4	10' N	200' W	" SE "	" 1
5	600' S	820' E	" NW "	" 12
6	2150' S	200' W	" NE "	" "
7	1620' N	200' W	" SE "	" "
8	200' N	160' W	" " "	" 11
9	60' N	300' W	" " "	" 12

LEGEND

- INTERMITTENT STREAMS
- Q OF DAM OR CENTER OF WATER HOLE

THE PURPOSE OF THIS MAP IS TO IDENTIFY THE LOCATION OF THE WATER RIGHT. IT IS NOT INTENDED TO PROVIDE INFORMATION RELATIVE TO THE LOCATION OF PROPERTY OWNERSHIP.

RECEIVED

SEP 29 2000

WATER RESOURCES DEPT.
SALEM, OREGON

	FINAL PROOF SURVEY		IN THE NAME OF MARIE MACOMBER
	UNDER APPLICATION R-72048 PERMIT R-11821		
	Scale: 4" = 1 MILE	Date: SEPT. 2000	Job: 1383-00
	Dsn:		Sht. No.
Drm: CHRIS	of 1		
Ckd:	M.A. PALMER & SONS, INC. ENGINEERING & SURVEYING 711 Ponderosa Village • Box 61 Burns, Oregon 97720		