

JUL 24 2024

Salem, OR

Application for a Permit to
Store Water in a Reservoir
 Alternate Review (ORS 537.409)



Oregon Water Resources Department
 725 Summer Street NE, Suite A
 Salem, Oregon 97301-1266
 (503) 986-0900
 www.oregon.gov/OWRD

You may use this form for any reservoir storing less than 9.2 acre-feet or with a dam less than 10 feet high.

Use a separate form for each reservoir

SECTION 1: APPLICANT INFORMATION AND SIGNATURE

Applicant

NAME <u>Irving Villarreal</u>		PHONE (HM) <u>971 241 0280</u>	
PHONE (WK) <u>971 241 0280</u>	CELL	FAX	
MAILING ADDRESS <u>17059 SE Mallard LN</u>			
CITY <u>Dayton</u>	STATE <u>OR</u>	ZIP <u>97114</u>	E-MAIL* <u>irving@rexnursery.com</u>

Organization

NAME <u>Rex Nursery LLC</u>		PHONE <u>971 241 0280</u>		FAX
MAILING ADDRESS <u>17059 SE Mallard LN</u>			CELL	
CITY <u>Dayton</u>	STATE <u>OR</u>	ZIP <u>97114</u>	E-MAIL* <u>irving@rexnursery.com</u>	

Agent – The agent is authorized to represent the applicant in all matters relating to this application.

AGENT / BUSINESS NAME		PHONE		FAX
MAILING ADDRESS			CELL	
CITY	STATE	ZIP	E-MAIL*	

Note: Attach multiple copies as needed

* By providing an e-mail address, consent is given to receive all correspondence from the Department electronically.
 (Paper copies of the final order documents will also be mailed.)

By my signature below I confirm that I understand:

- I am asking to use water specifically as described in this application.
- Evaluation of this application will be based on information provided in the application.
- I cannot legally store water until the Water Resources Department issues a permit.
- Oregon law requires that a permit be issued before beginning construction. Acceptance of this application does not guarantee a permit will be issued.
- If I get a permit, I must not waste water.
- If development of the water use is not according to the terms of the permit, the permit can be cancelled.
- The water use must be compatible with local comprehensive land use plans.
- Even if the Department issues a permit, I may have to stop using water to allow senior water right holders to get water to which they are entitled.

I (we) affirm that the information contained in this application is true and accurate.

Irving Villarreal Irving Villarreal 7-3-2024
 Applicant Signature Print Name and Title if applicable Date

Applicant Signature Print Name and Title if applicable Date

SECTION 2: SOURCE OF WATER AND LOCATION OF RESERVOIR

Reservoir name:	Rex Pond				
Source*:	run off, Seepage	Tributary:	None		
County:	Yamhill				
Quantity:	Acre-Feet [length x width x depth / 43,560] 7.74 acre Feet				
Reservoir Location:	Township (N or S)	Range (E or W)	Section	Quarter-Quarter	Tax Lot #
	4 S	3 W	21	SE SE	4321-00700
Maximum Height of Dam:	10 Feet feet. If excavated write "zero feet."				

* Provide the name of the water body or other source from which water will be diverted, and the name of the stream or lake it flows into. Indicate if source is run-off, seepage, an unnamed stream, or spring.

SECTION 3: WATER USE

Indicate the proposed use(s) of the stored water: Multi purpose

NOTE: You may wish to consider filing for "Multipurpose use" for your reservoir. Multipurpose use does not limit the types of future uses for the stored water. Multipurpose covers all uses, which may include stock water, fish and wildlife, domestic, irrigation, agriculture, fire protection and pollution abatement.

SECTION 4: PROPERTY OWNERSHIP

Do you own all the land where you propose to divert, transport, and use water?

Yes (please check appropriate box below then skip to section 5)

There are no encumbrances.

This land is encumbered by easements, right of way, roads of way, roads or other encumbrances.

No (please check the appropriate box below)

I have a recorded easement or written authorization permitting access.

I do not currently have written authorization or easement permitting access.

Written authorization or an easement is not necessary, because the only affected lands I do not own are state-owned submersible lands, and this application is for irrigated and/or domestic use only (ORS 274.040). (Do not check this box if you described your use as "Multipurpose" in #3 above.)

List the names and mailing addresses of all affected landowners:

Received by OWRD

JUL 24 2024

Salem, OR

JUL 24 2024

Salem, OR

SECTION 5: ENVIRONMENTAL IMPACT

Channel: Is the Reservoir: in-stream or off channel?

Wetland: Is the project in a wetland? YES NO unknown

Existing: Is this an existing reservoir? YES NO

If YES, how long has it been in place? _____ years.

Fish Habitat: Is there a fish habitat upstream of the proposed structure? YES NO unknown

If YES, how much? _____ miles.

Existing: Have you been working with other agencies? YES NO

Indicate agency, staff and phone numbers of those involved. Also indicate any agencies that are cost sharing in this project.

SECTION 6: WITHIN A DISTRICT

Check here if the point of diversion or place of use are located within or served by an irrigation or other water district.

IRRIGATION DISTRICT NAME <i>Palmer Creek water district</i>		ADDRESS <i>14395 SE Wallace Rd</i>	
CITY <i>Dayton</i>	STATE <i>OR</i>	ZIP <i>97114</i>	

SECTION 7: DESCRIPTION

Provide a short description of the design and operation of the proposed diversion, including a description of how live flow will be passed outside the authorized storage season. Use this space for narrative. You may also provide narrative and sketches on separate pages.

The property is tile drained into gully. It naturally catches run off and seepage from rain and irrigation. Live flow of water will be controlled by overflow control gravity PVC pipe system at the dam.

If the diversion involves a dam, use this space below (or attached pages) for sketches of the diversion (e.g. cross-section of the dam with its dimensions, dimension and placement of outlet pipe, means of passing live flow outside of the authorized storage season, and means for providing fish passage).

The dam will be the curved path made through the gully. It will be 10 feet and control live flow with overflow control gravity PVC pipe system.



JUL 24 2024

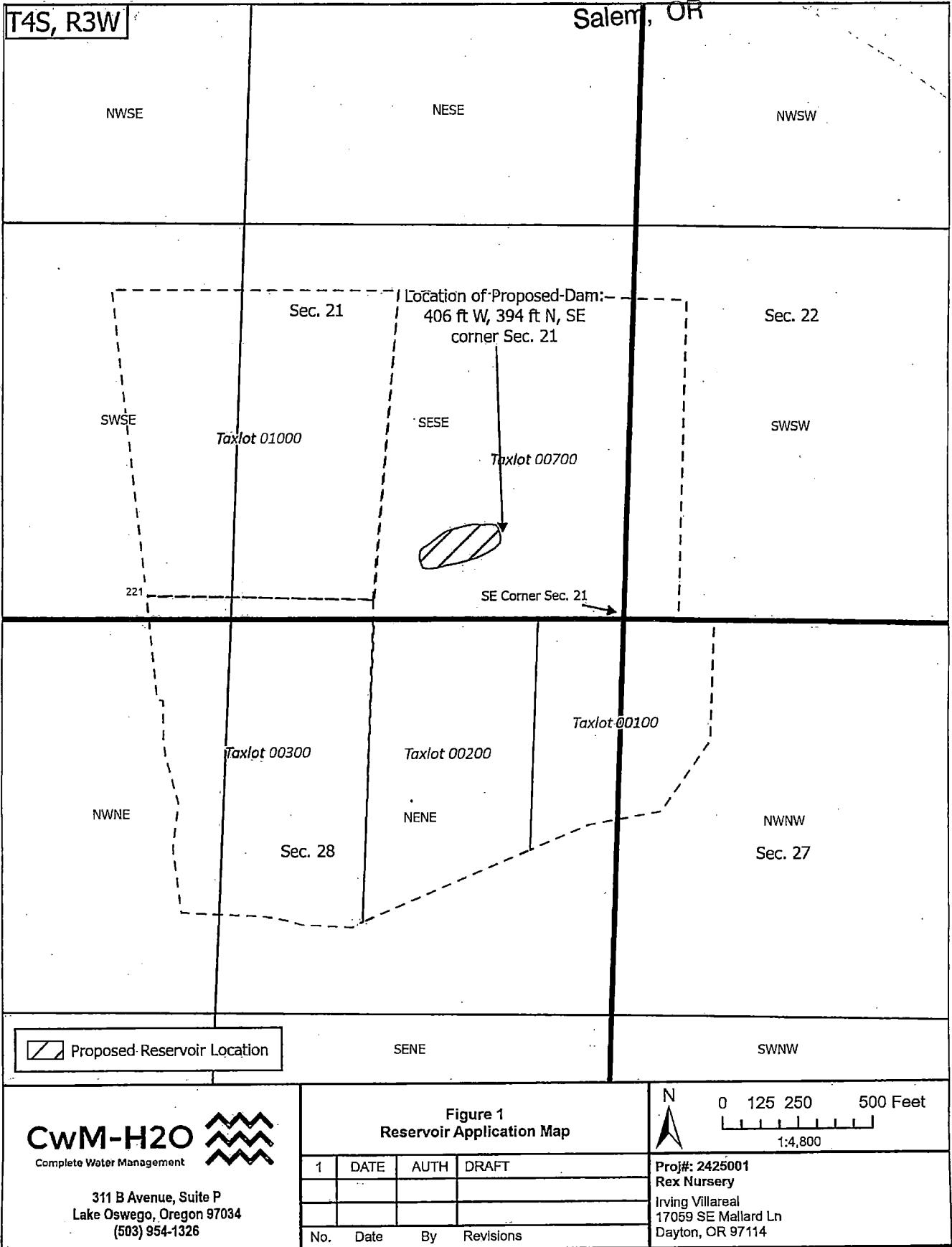

Legal Document

Page 1 of 4



After recording return to:
Uvaldo Villarreal and Marla I.
Villarreal
839 SW Westvale
McMinnville, OR 97128

Until a change is requested all tax statements
shall be sent to the following address:
Uvaldo Villarreal and Marla I. Villarreal
839 SW Westvale
McMinnville, OR 97128

File No.: 1031-1198957 (LVF)
Date: April 14, 2008

THIS SPACE RESERVED FOR RECORDER'S USE

OFFICIAL YAMHILL COUNTY RECORDS
JAN COLEMAN, COUNTY CLERK

200810279
\$41.00

00302539200800102790040041 06/16/2008 09:10:57 AM
DMR-DDMR Cnt=1 Stn=2 ANITA
\$20.00 \$10.00 \$11.00

FIRST AMERICAN TITLE 1198957

STATUTORY WARRANTY DEED

Rex W. Ziegler and Zella G. Ziegler, Trustees of the Ziegler Trust, Grantor, conveys and warrants to **Uvaldo Villarreal and Maria I. Villarreal, Husband and Wife**, Grantee, the following described real property free of liens and encumbrances, except as specifically set forth herein:

See Legal Description attached hereto as Exhibit A and by this reference incorporated herein.

Subject to:

1. Covenants, conditions, restrictions and/or easements, if any, affecting title, which may appear in the public record, including those shown on any recorded plat or survey.

REX W. ZIEGLER RESERVES UNTO HIMSELF A LIFE ESTATE IN THE HOUSE AND THE ACRE ON WHICH IT SITS.

The true consideration for this conveyance is **\$373,750.00**. (Here comply with requirements of ORS 93.030)

Received by OWRD

JUL 24 2024

Salem, OR

Legal Document
Page 3 of 4

APN: 120238

Statutory Warranty Deed
- continued

File No.: 1031-1198957 (LVF)
Date: 04/14/2008

EXHIBIT A

LEGAL DESCRIPTION:

PARCEL 1:

Beginning at the corner of Sections 21, 22, 27 and 28 in Township 4 South, Range 3 West of the Willamette Meridian in Yamhill County, Oregon, and running thence North 89°19' West 11.856 chains to old Yew stake in line of North and South fence; thence North 2°53' East along fence now there 16.727 chains to stone at the Northeast corner of the Joel Chrisman Donation Land Claim; thence South 89°33' East 14.51 chains to stake; thence South 16.697 chains to stake on Section line between Sections 22 and 27; thence South 89°34' West along Section line 3.52 chains to the place of beginning.

EXCEPTING from the above described parcel, the following described premises:

Beginning at a stone at the Northeast corner of the Joel Chrisman Donation Land Claim Notification #1017, Claim No. 52, in Section 21, Township 4 South, Range 3 West of the Willamette Meridian in Yamhill County, Oregon, and running thence East 13.57 chains to witness stake to true corner, from which witness corner a fir 60" in diameter bears North 42°30' West 28 1/2 links and a fir stump 50" in diameter, 8 feet high, bears South 17° East 30 1/2 links and at 14.51 chains East set stake at true corner; thence West .85 chains to witness stump 50" in diameter 8 feet high and at 14.53 chains West set pipe on the East boundary of Joel Chrisman Donation Land Claim; thence North 4° East 30 1/3 links (20 feet) to the place of beginning, containing 44/100 of an acre, and being the real premises described in that certain deed from Peter Swanson, a single man, to Horance Ellera Gibson, et al, dated January 18, 1939, and recorded on said date in Book 115, Page 92, Deed Records of Yamhill County, Oregon.

Tax Parcel Number: R4321-700

PARCEL 2:

Being Lot No. 1 of County Survey No. 2446, more particularly described as follows:

Beginning at a point on the Section line North 89°19' West 2.656 chains from the corner of Sections 21, 22, 27 and 28 in Township 4 South, Range 3 West of the Willamette Meridian, Yamhill County, Oregon, running thence North 89°19' West 9.20 chains to Yew Stake at the Southwest corner of County Survey No. 2368; thence South 0°19' West along old fence now there, 15.90 chains to iron pin in the center of the old County Road; thence North 65°12' East along the center of the old County Road, 10.09 chains to an iron pin; thence North 00°33' East 11.39 chains to the place of beginning.

EXCEPTING from the parcel last above described the following described premises:

Received by OWRD

JUL 24 2024

Salem, OR

Legal document
Page 4 of 4

APN: 120238

Statutory Warranty Deed
- continued

File No.: 1031-1198957 (LVF)
Date: 04/14/2008

Beginning at an Iron pin at the Southeast corner of the above described Parcel No. 2 and running thence North 00°33' East 11.39 chains (751.74 feet) to the Northeast corner thereof; thence North 89°19' West 56.8 feet to a 1" Iron pipe; thence South 00°33' West 778.8 feet to a point in the center of the old County Road; from which point a one-half inch iron pipe set on the approximate Northerly edge of the present County Road, bears North 00°33' East 53.7 feet thence North 65°12' East along the center of Old County Road, 62.8 feet to the place of beginning.

Received by OWRD

JUL 24 2024

Salem, OR

Watermaster Alternate Reservoir Application Review Sheet

In lieu of the water right application process set forth in ORS 537.140 to 537.211, an owner of a reservoir may submit an alternate reservoir application for a reservoir that has a storage capacity less than 9.2 acre-feet or a dam or impoundment structure less than 10 feet in height. ORS 537.409 describes the criteria used to evaluate alternate reservoir applications.

The review shall be limited to issues pertaining to: a) water availability, b) potential detrimental impact to existing fishery resources; and c) potential injury to existing water rights. (ORS 537.409 (6))

Within 60 days after the Water Resources Department provides public notice, any person may submit detailed, legally obtained information in writing, requesting the Department to deny the application for a permit on the basis that the reservoir: (a) Would result in injury to an existing water right; or (b) Would pose a significant detrimental impact to existing fishery resources. (ORS 537.409 (5))

Applicant's Name		
1. Does the proposed reservoir have the potential to injure existing water rights? <input type="checkbox"/> YES <input type="checkbox"/> NO Explain:		
2. Can conditions be applied to mitigate the potential injury to existing water rights? <input type="checkbox"/> YES <input type="checkbox"/> NO Explain:		
3. Is water available for the proposed reservoir? <input type="checkbox"/> YES <input type="checkbox"/> NO		
4. If yes, during what period? Beginning: _____ End: _____ Attach a WARS printout at 50% exceedance. If WARS does not cover the proposed location, make a recommendation for a storage season based upon regulation history and your knowledge of the location. (Water Availability for Reservoir Policy found under OAR 690-410-0070(2)(c))		
5. Did you meet with staff from another agency to discuss this application? <input type="checkbox"/> YES <input type="checkbox"/> NO		
Name: _____	Agency: _____	Date: _____
Name: _____	Agency: _____	Date: _____

Watermaster Name: _____

Watermaster Signature: _____ Date: _____

NOTE: This completed form must be returned to the applicant

Received by OWRD

JUL 24 2024

Salem, OR

ODFW Alternate Reservoir Application Review Sheet

This portion to be completed by the Applicant					
Applicant			Phone No.	Email.	
Mailing Address			City	State	Zip
Reservoir Name:		Source:		Volume (AF):	
Township (N or S)	Range (E or W)	Section	Quarter/ Quarter	Basin Name:	<input type="checkbox"/> in-channel <input type="checkbox"/> off-channel

This portion to be completed by Oregon Department of Fish and Wildlife (ODFW)	
1) Is the proposed project and AO ¹ off channel? (If yes then proceed to #4; if no then proceed to #2)	<input type="checkbox"/> YES <input type="checkbox"/> NO
2) Is the proposed project or AO located where NMF ² are or were historically present? (If yes then proceed to #3; if no then proceed to #4)	<input type="checkbox"/> YES <input type="checkbox"/> NO
3) If NMF are or were historically present:	
a. Is there an ODFW – approved fish passage plan?	<input type="checkbox"/> YES <input type="checkbox"/> NO
b. Is there an ODFW-approved fish-passage waiver or exemption?	<input type="checkbox"/> YES <input type="checkbox"/> NO
If fish passage is required under ORS 509.580 through .910, then either 3(a) or 3(b) must be "Yes" to move forward with the application. If responses to 3(a) and 3(b) are "No", then the proposed reservoir does not meet the requirements of Oregon Fish Passage Law and shall not be constructed as proposed.	
4) Would the proposed project pose any other significant detrimental impact to an existing fishery resource locally or downstream: <i>Explain below (for example, list STE species or other existing fishery resources that would be impacted negatively.)</i>	<input type="checkbox"/> YES <input type="checkbox"/> NO
<input type="checkbox"/> Any diversion or appropriation of water for storage during the period _____ through _____ poses a significant detrimental impact to existing fishery resources. <i>(For example, if diversion of water for storage during a certain time period would cause a significant detrimental impact to an existing fishery resource, then ODFW should recommend conditions or limitations.)</i> If NMF fish are present at the project site or point of water diversion then the applicant should be advised that a fish screen consistent with screening criteria will be required.	
<input type="checkbox"/> This proposed pond or reservoir contemplates impounding water in the Columbia Basin above Bonneville Dam. ODFW has determined that additional diversions of water in this area pose a significant detrimental impact to existing fishery resources during the period April 15 through September 30.	
If YES, can conditions be applied to mitigate the significant detrimental impact to an existing fishery resource? <input type="checkbox"/> YES (Select from Menu of Conditions on next page) <input type="checkbox"/> NO (explain)	

ODFW Signature: _____ Printed Name: _____

ODFW Title: _____ Date: _____

NOTE: This completed form must be returned to the applicant

¹ AO = Artificial Obstruction means any dam, diversion, culvert or other human-made device placed in waters of this state that precludes or prevents the migration of native migratory fish. ORS 509.580 (1)

² NMF = Native Migratory Fish Species in Oregon as defined by OAR 635-412-0005 (32)

Use this menu to identify appropriate conditions to be included in the permit, and indicate the abbreviations on the review form:

fishpass: As required by ORS 509.585, a person owning or operating an artificial obstruction (AO) may not construct or maintain any AO across any waters of this state that are inhabited, or historically inhabited, by native migratory fish (NMF) without providing passage for NMF. A person owning or operating an AO shall, prior to construction, fundamental change in permit status or abandonment of the AO in any waters of this state, obtain a determination from ODFW as to whether NMF are or historically have been present in the waters. If ODFW determines that NMF are or historically have been present in the waters, the person owning or operating the AO shall either submit a proposal for fish passage to ODFW or apply for a waiver or exemption. Approval of the proposed fish-passage facility, waiver, or exemption must be obtained from the department prior to construction, permit modification or abandonment of the AO. Approved fish-passage plans, waivers, and exemptions shall maintain adequate passage of NMF at all times (ORS 509.601) as per the approved plan, waiver or exemption.

fishself: The permittee shall install, maintain, and operate fish screening and by-pass devices consistent with current Oregon Department of Fish and Wildlife (ODFW) standards. Fish screening is to prevent fish from entering the proposed diversion while by-pass devices provide adequate upstream and downstream passage for fish. The required screen and by-pass devices are to be in place and functional prior to diversion of any water. Permittee shall obtain written approval from ODFW that the installation of the required screen and by-pass devices meets the state's criteria or the permittee shall submit documentation that ODFW has determined screens and/or by-pass devices are not necessary.

fishapprove: The permittee shall install, maintain, and operate fish screening and by-pass devices consistent with current Oregon Department of Fish and Wildlife (ODFW) standards. Fish screening is to prevent fish from entering the proposed diversion while by-pass devices provide adequate upstream and downstream passage for fish. The required screen and by-pass devices are to be in place and functional, and approved in writing by ODFW prior to diversion of any water. The permittee may submit evidence in writing that ODFW has determined screens and/or by-pass devices are not necessary.

fishdiv33: If the riparian area is disturbed in the process of developing a point of diversion, the permittee shall be responsible for restoration and enhancement of such riparian area in accordance with ODFW's Fish and Wildlife Habitat Mitigation Policy OAR 635-415. For purposes of mitigation, the ODFW Fish and Wildlife Habitat Mitigation Goals and Standards, OAR 635-415, shall be followed.

The use may be restricted if the quality of the source stream or downstream waters decrease to the point that those waters no longer meet existing state or federal water quality standards due to reduced flows.

The permittee shall install, maintain, and operate fish screening and by-pass devices consistent with current Oregon Department of Fish and Wildlife (ODFW) standards. Fish screening is to prevent fish from entering the proposed diversion while by-pass devices provide adequate upstream and downstream passage for fish. The required screen and by-pass devices are to be in place and functional, and approved in writing by ODFW prior to diversion of any water. The permittee may submit evidence in writing that ODFW has determined screens and/or by-pass devices are not necessary.

fishmay: The permittee may be required in the future to install, maintain, and operate fish screening and by-pass devices to prevent fish from entering the proposed diversion and to provide adequate upstream and downstream passage for fish.

b52 Water may be diverted only when Department of Environmental Quality sediment standards are being met.

b5 The water user shall install and maintain adequate treatment facilities meeting current DEQ requirements to remove sediment before returning the water to the stream.

b51a The period of use has been limited to through

b57 Before water use may begin under this permit, a totalizing flow meter must be installed at each diversion point.

b58 Before water use may begin under this permit, a staff gage that measures the entire range and stage between full reservoir level and dead-pool storage must be installed in the reservoir. The staff gage shall be United States Geological Survey style porcelain enamel iron staff gage style A, C, E or I.

futile call: The use of water allowed herein may be made only at times when waters from the (NAME OF SURFACE WATER) would not otherwise flow into a tributary of the River or sufficient water is available to satisfy all prior rights, including rights for maintaining instream flows.

riparian: If the riparian area is disturbed in the process of developing a point of diversion, the permittee shall be responsible for restoration and enhancement of such riparian area in accordance with ODFW's Fish and Wildlife Habitat Mitigation Policy OAR 635-415. For purposes of mitigation, the ODFW Fish and Wildlife Habitat Mitigation Goals and Standards, OAR 635-415, shall be followed.

wq: The use may be restricted if the quality of the source stream or downstream waters decrease to the point that those waters no longer meet existing state or federal water quality standards due to reduced flows.

fence: The stream and its adjacent riparian area shall be fenced to exclude livestock.

blv: Water must be diverted to a trough or tank through an enclosed water delivery system. The delivery system must be equipped with an automatic shutoff or limiting flow control mechanism or include a means for returning water to the stream source through an enclosed delivery system. The use of water shall not exceed 0.10 cubic feet per second per 1000 head of livestock.

Received by OWRD

JUL 24 2024

Salem, OR

JUL 24 2024

Land Use Information Form



Oregon Water Resources Department
725 Summer Street NE, Suite A
Salem, Oregon 97301-1266
(503) 986-0900
www.oregon.gov/OWRD

Salem, OR

NOTE TO APPLICANTS

In order for your application to be processed by the Oregon Water Resources Department (OWRD), this Land Use Information Form must be completed by a local government planning official in the jurisdiction(s) where your water right will be diverted, conveyed, used, and developed. The planning official may choose to complete the form while you wait or return the "Receipt Acknowledging Request for Land Use Information" to you. Applications received by OWRD without the Land Use Information Form, or the signed receipt, will be returned to you. **IMPORTANT:** Please note that while OWRD can accept a signed receipt as part of intake for an application for a new permit to use or store water, a completed Land Use Information Form is required for OWRD's acceptance of all other applications. Please be aware that your application cannot be approved without land use approval.

This form is **NOT** required if:

- 1) Water is to be diverted, conveyed, and used on federal lands only; **OR**
- 2) The application is for a water right transfer, allocation of conserved water, exchange, permit amendment, or ground water registration modification, and **all** of the following apply:
 - a. The existing and proposed water use is located entirely within lands zoned for exclusive farm-use or within an irrigation district;
 - b. The application involves a change in place of use only;
 - c. The change does not involve the placement or modification of structures, including but not limited to water diversion, impoundment, distribution facilities, water wells and well houses; **and**
 - d. The application involves irrigation water uses only.

NOTE TO LOCAL GOVERNMENTS

The person presenting the attached Land Use Information Form is applying for a new water right or modifying an existing water right. The Oregon Water Resources Department (OWRD) requires applicants to obtain land use information to ensure the water right does not result in land uses that are incompatible with your comprehensive plan. Please complete the form and return it to the applicant for inclusion in their application. **NOTE:** For new water right applications only, if you are unable to complete this form while the applicant waits, you may complete the "Receipt Acknowledging Request for Land Use Information" and return it to the applicant.

You will receive notice via OWRD's weekly Public Notice once the applicant formally submits their request to OWRD. The notice will give more information about OWRD's water right process and provide additional comment opportunities. If you previously only completed the receipt for an application for a new permit to use or store water, you will have 30 days from the Public Notice date to complete the Land Use Information Form and return it to OWRD. Your attention to this request for information is greatly appreciated. If you have questions concerning this form, please contact OWRD's Customer Service Group at 503-986-0900 or WRD_DL_customerservice@water.oregon.gov.

This page intentionally left blank.

Received by OWRD

JUL 24 2024

Salem, OR

JUL 24 2024

Land Use Information Form



Oregon Water Resources Department
 725 Summer Street NE, Suite A
 Salem, Oregon 97301-1266
 (503) 986-0900
 www.oregon.gov/OWRD

NAME <i>Irving Villarreal</i>		PHONE <i>971 241 0280</i>	
MAILING ADDRESS <i>17059 SE Mallard LN</i>			
CITY <i>Dayton</i>	STATE <i>OR</i>	ZIP <i>97114</i>	EMAIL <i>irving@nexnursery.com</i>

A. Land and Location

Please include the following information for all tax lots where water will be diverted (taken from its source), conveyed (transported), and/or used or developed. Applicants for municipal use, or irrigation uses within irrigation districts, may substitute existing and proposed service-area boundaries for the tax-lot information requested below.

Township	Range	Section	¼ ¼	Tax Lot #	Plan Designation (e.g., Rural Residential/RR-5)	Water to be:	Proposed Land Use:
<i>4, S</i>	<i>3, W</i>	<i>21</i>	<i>SE, SE</i>	<i>4321-00700</i>	<i>Farm</i>	<input type="checkbox"/> Diverted <input type="checkbox"/> Conveyed <input checked="" type="checkbox"/> Used	<i>Agriculture</i>
						<input type="checkbox"/> Diverted <input type="checkbox"/> Conveyed <input type="checkbox"/> Used	
						<input type="checkbox"/> Diverted <input type="checkbox"/> Conveyed <input type="checkbox"/> Used	
						<input type="checkbox"/> Diverted <input type="checkbox"/> Conveyed <input type="checkbox"/> Used	

List all counties and cities where water is proposed to be diverted, conveyed, and/or used or developed:

Yamhill Co.

NOTE: A separate Land Use Information Form must be completed and submitted for each county and city, as applicable.

B. Description of Proposed Use

Type of application to be filed with the Oregon Water Resources Department:

- Permit to Use or Store Water
 Water Right Transfer
 Permit Amendment or Ground Water Registration Modification
 Limited Water Use License
 Exchange of Water
 Allocation of Conserved Water

Source of water: Reservoir/Pond Ground Water Surface Water (name) _____

Estimated quantity of water needed: *7.74* cubic feet per second gallons per minute acre-feet

Intended use of water: Irrigation Commercial Industrial Domestic for _____ household(s)
 Municipal Quasi-Municipal Instream Other _____

Briefly describe:

Water would be used in July and August to relieve well water. Also would allow to water more efficiently.

Note to applicant: For new water right applications only, if the Land Use Information Form cannot be completed while you wait, please have a local government representative sign the receipt on the bottom of page 4 and include it with the application filed with the Oregon Water Resources Department.

See Page 4 →

JUL 24 2024

Salem, OR

For Local Government Use Only

The following section must be completed by a planning official from each county and city listed unless the project will be located entirely within the city limits. In that case, only the city planning agency must complete this form. This deals only with the local land use plan. Do not include approval for activities such as building or grading permits.

Please check the appropriate box below and provide the requested information

- Land uses to be served by the proposed water use(s), including proposed construction, are allowed outright or are not regulated by your comprehensive plan. Cite applicable ordinance section(s): _____
- Land uses to be served by the proposed water use(s), including proposed construction, involve discretionary land-use approvals as listed in the table below. (Please attach documentation of applicable land-use approvals which have already been obtained. Record of Action/land-use decision and accompanying findings are sufficient.) **If approvals have been obtained but all appeal periods have not ended, check "Being Pursued."**

Type of Land-Use Approval Needed (e.g., plan amendments, rezones, conditional-use permits, etc.)	Cite Most Significant, Applicable Plan Policies & Ordinance Section References	Land-Use Approval:	
		<input type="checkbox"/> Obtained <input type="checkbox"/> Denied	<input type="checkbox"/> Being Pursued <input type="checkbox"/> Not Being Pursued
		<input type="checkbox"/> Obtained <input type="checkbox"/> Denied	<input type="checkbox"/> Being Pursued <input type="checkbox"/> Not Being Pursued
		<input type="checkbox"/> Obtained <input type="checkbox"/> Denied	<input type="checkbox"/> Being Pursued <input type="checkbox"/> Not Being Pursued
		<input type="checkbox"/> Obtained <input type="checkbox"/> Denied	<input type="checkbox"/> Being Pursued <input type="checkbox"/> Not Being Pursued

Local governments are invited to express special land use concerns or make recommendations to the Oregon Water Resources Department regarding this proposed use of water in the box below or on a separate sheet.

Name: _____ Title: _____
 Signature: _____ Date: _____
 Governmental Entity: _____ Phone: _____

Receipt Acknowledging Request for Land Use Information

Note to Local Government Representative:
 Please complete this form and return it to the applicant. **For new water right applications only**, if you are unable to complete this form while the applicant waits, you may complete this receipt and return it to the applicant. If you sign the receipt, you will have 30 days from the date of OWRD's Public Notice of the application to submit the completed Land Use Information Form to Oregon Water Resources Department. Please note while OWRD can accept a signed receipt as part of intake for an application for a new permit to use or store water, a completed Land Use Information Form is required for all other applications.

Applicant Name: _____

Staff Name: _____ Title: _____

Staff Signature: _____ Date: _____

Governmental Entity: _____ Phone: _____

JUL 24 2024

Salem, OR

Watermaster Alternate Reservoir Application Review Sheet

In lieu of the water right application process set forth in ORS 537.140 to 537.211, an owner of a reservoir may submit an alternate reservoir application for a reservoir that has a storage capacity less than 9.2 acre-feet or a dam or impoundment structure less than 10 feet in height. ORS 537.409 describes the criteria used to evaluate alternate reservoir applications.

The review shall be limited to issues pertaining to: a) water availability, b) potential detrimental impact to existing fishery resources; and c) potential injury to existing water rights. (ORS 537.409 (6))

Within 60 days after the Water Resources Department provides public notice, any person may submit detailed, legally obtained information in writing, requesting the Department to deny the application for a permit on the basis that the reservoir: (a) Would result in injury to an existing water right; or (b) Would pose a significant detrimental impact to existing fishery resources. (ORS 537.409 (5))

Applicant's Name Irving Villarreal 4S3WSec21SESE TL 700		
1. Does the proposed reservoir have the potential to injure existing water rights? <input type="checkbox"/> YES <input checked="" type="checkbox"/> NO Explain:		
2. Can conditions be applied to mitigate the potential injury to existing water rights? <input type="checkbox"/> YES <input type="checkbox"/> NO Explain: NA		
3. Is water available for the proposed reservoir? <input checked="" type="checkbox"/> YES <input type="checkbox"/> NO		
4. If yes, during what period? Beginning: Jan 1 End: Dec 31		
Attach a WARS printout at 50% exceedance. If WARS does not cover the proposed location, make a recommendation for a storage season based upon regulation history and your knowledge of the location. (Water Availability for Reservoir Policy found under OAR 690-410-0070(2)(c))		
5. Did you meet with staff from another agency to discuss this application? <input type="checkbox"/> YES <input checked="" type="checkbox"/> NO		
Who:	Agency:	Date:
Who:	Agency:	Date:

Watermaster Name: Joel Plahn

Watermaster Signature:  Date: 7/9/2024

NOTE: This completed form must be returned to the applicant

JUL 24 2024

Salem, OR

Land Use Information Form



Oregon Water Resources Department
 725 Summer Street NE, Suite A
 Salem, Oregon 97301-1266
 (503) 986-0900
 www.oregon.gov/OWRD

NAME <i>Irving Villanueva</i>		PHONE <i>971 241 0280</i>
MAILING ADDRESS <i>17059 SE Mallard LN</i>		
CITY <i>Dayton</i>	STATE <i>OR</i>	ZIP <i>97114</i>
EMAIL <i>irving@rexpursey.com</i>		

A. Land and Location

Please include the following information for all tax lots where water will be diverted (taken from its source), conveyed (transported), and/or used or developed. Applicants for municipal use, or irrigation uses within irrigation districts, may substitute existing and proposed service-area boundaries for the tax-lot information requested below.

Township	Range	Section	¼ ¼	Tax Lot #	Plan Designation (e.g., Rural Residential/RR-5)	Water to be:			Proposed Land Use:
<i>4, S</i>	<i>3, W</i>	<i>21</i>	<i>SE, SE</i>	<i>4321-00700</i>	<i>Farm</i>	<input type="checkbox"/> Diverted	<input type="checkbox"/> Conveyed	<input checked="" type="checkbox"/> Used	<i>Agriculture</i>
						<input type="checkbox"/> Diverted	<input type="checkbox"/> Conveyed	<input type="checkbox"/> Used	
						<input type="checkbox"/> Diverted	<input type="checkbox"/> Conveyed	<input type="checkbox"/> Used	
						<input type="checkbox"/> Diverted	<input type="checkbox"/> Conveyed	<input type="checkbox"/> Used	

List all counties and cities where water is proposed to be diverted, conveyed, and/or used or developed:

Tamhill Co.

NOTE: A separate Land Use Information Form must be completed and submitted for each county and city, as applicable.

B. Description of Proposed Use

Type of application to be filed with the Oregon Water Resources Department:

- Permit to Use or Store Water
 Water Right Transfer
 Permit Amendment or Ground Water Registration Modification
 Limited Water Use License
 Exchange of Water
 Allocation of Conserved Water

Source of water: Reservoir/Pond Ground Water Surface Water (name) _____

Estimated quantity of water needed: *7.74* cubic feet per second gallons per minute acre-feet

Intended use of water: Irrigation Commercial Industrial Domestic for _____ household(s)
 Municipal Quasi-Municipal Instream Other _____

Briefly describe:

Water would be used in July and August to relieve well water. Also would allow to water more efficiently.

Note to applicant: For new water right applications only, if the Land Use Information Form cannot be completed while you wait, please have a local government representative sign the receipt on the bottom of page 4 and include it with the application filed with the Oregon Water Resources Department.

See Page 4 →

JUL 24 2024

Salem, OR

For Local Government Use Only

The following section must be completed by a planning official from each county and city listed unless the project will be located entirely within the city limits. In that case, only the city planning agency must complete this form. This deals only with the local land use plan. Do not include approval for activities such as building or grading permits.

Please check the appropriate box below and provide the requested information

- Land uses to be served by the proposed water use(s), including proposed construction, are allowed outright or are not regulated by your comprehensive plan. Cite applicable ordinance section(s): 402 of the YCZO
- Land uses to be served by the proposed water use(s), including proposed construction, involve discretionary land-use approvals as listed in the table below. (Please attach documentation of applicable land-use approvals which have already been obtained. Record of Action/land-use decision and accompanying findings are sufficient.) **If approvals have been obtained but all appeal periods have not ended, check "Being Pursued."**

Type of Land-Use Approval Needed (e.g., plan amendments, rezones, conditional-use permits, etc.)	Cite Most Significant, Applicable Plan Policies & Ordinance Section References	Land-Use Approval:	
		<input type="checkbox"/> Obtained <input type="checkbox"/> Denied	<input type="checkbox"/> Being Pursued <input type="checkbox"/> Not Being Pursued
		<input type="checkbox"/> Obtained <input type="checkbox"/> Denied	<input type="checkbox"/> Being Pursued <input type="checkbox"/> Not Being Pursued
		<input type="checkbox"/> Obtained <input type="checkbox"/> Denied	<input type="checkbox"/> Being Pursued <input type="checkbox"/> Not Being Pursued
		<input type="checkbox"/> Obtained <input type="checkbox"/> Denied	<input type="checkbox"/> Being Pursued <input type="checkbox"/> Not Being Pursued

Local governments are invited to express special land use concerns or make recommendations to the Oregon Water Resources Department regarding this proposed use of water in the box below or on a separate sheet.

Name: Ken Fridolf Title: P.D.
 Signature: [Signature] Date: 7/9/2024
 Governmental Entity: Washill County Phone: 503 434-7516

Receipt Acknowledging Request for Land Use Information

Note to Local Government Representative:
 Please complete this form and return it to the applicant. For new water right applications only, if you are unable to complete this form while the applicant waits, you may complete this receipt and return it to the applicant. If you sign the receipt, you will have 30 days from the date of OWRD's Public Notice of the application to submit the completed Land Use Information Form to Oregon Water Resources Department. Please note while OWRD can accept a signed receipt as part of intake for an application for a new permit to use or store water, a completed Land Use Information Form is required for all other applications.

Applicant Name: _____

Staff Name: _____ Title: _____

Staff Signature: _____ Date: _____

Governmental Entity: _____ Phone: _____

ODFW Alternate Reservoir Application Review Sheet

Salem, OR

This portion to be completed by the applicant.

Applicant Name: Irving Villarreal

Address: 17059 SE Mallard Ln. Dayton OR. 97114

Phone/Email: 971-241-0280 / Irving@rexnursery.com

Reservoir Name: Rex Pond

Volume (AF): 7.74

Source: Run Off

Basin Name: Willamette

in-channel

Twp Rng Sec QQ: 4S 3W 21 SESE

off-channel

Note: It is unlikely that ODFW will be able to complete this form while you wait, nevertheless we recommend making an appointment to submit the form so as to provide any necessary clarifications. See pg. 6 of Instructions for contact information.

This portion to be completed by Oregon Department of Fish and Wildlife (ODFW) staff.

1) Is the proposed project and AO¹ off channel?..... YES* NO
(if yes then proceed to #4; if no then proceed to #2)

**Based on available information, the proposed use does not appear to involve instream structures that would create or maintain an artificial obstruction. However, if the applicant creates or maintains an artificial obstruction to fish passage for the proposed use, the applicant will need to address Oregon's fish passage laws.*

2) Is the proposed project or AO located where NMF² are or were historically present?..... YES NO
(if yes then proceed to #3; if no then proceed to #4)

3) If NMF are or were historically present:

a. Is there an ODFW-approved fish-passage plan?..... YES NO

b. Is there an ODFW-approved fish-passage waiver or exemption?..... YES NO

If fish passage is required under ORS 509.580 through .910, then either 3(a) or 3(b) must be "Yes" to move forward with the application. If responses to 3(a) and 3(b) are "No", then the proposed reservoir does not meet the requirements of Oregon Fish Passage Law and shall not be constructed as proposed.

4) Would the proposed project pose any other significant detrimental impact to an existing fishery resource locally or downstream?..... YES NO

Explain below (for example, list STE species or other existing fishery resources that would be impacted negatively.)

Any diversion or appropriation of water for storage during the period April through October poses a significant detrimental impact to existing fishery resources. (For example, if diversion of water for storage

¹ AO = Artificial Obstruction means any dam, diversion, culvert or other human-made device placed in waters of this state that precludes or prevents the migration of native migratory fish. ORS 509.580 (1)

² NMF = Native Migratory Fish Species in Oregon as defined by OAR 635 - 412 - 0005 (32)

Applicant Name: Irving Villarreal

ODFW Review

Review Date: 7/23/2024

during a certain time period would cause a significant detrimental impact to an existing fishery resource, then ODFW should recommend conditions or limitations.) If NMF fish are present at the project site or point of water diversion then the applicant should be advised that a fish screen consistent with screening criteria will be required.

- This proposed pond or reservoir contemplates impounding water in the Columbia Basin above Bonneville Dam. ODFW has determined that additional diversions of water in this area pose a significant detrimental impact to existing fishery resources during the period April 15 through September 30.

ESA-listed fish (winter steelhead, spring Chinook Salmon), sensitive species (Coastal Cutthroat Trout, Pacific Lamprey, and Oregon Chub), and other game fish (Coho Salmon, fall Chinook Salmon, and summer steelhead) may be present in the Willamette River during the period of impact. ODFW currently does not have an identified biological flow target for any nearby stream. However, based on parameters assessed by ODFW for the Willamette River, instream flows to fulfill MF182 and MF181 for aquatic life are being met wholly during the period of impact. ODFW also reviewed available information (Willamette Basin TMDL: Temperature) regarding water quality impairment and determined that the diversion of water for storage, would impair water quality that supports existing fishery resources (e.g., habitat) at or downstream of the Point of Diversion during April.1 – October.31, the Willamette River Temperature TMDL critical period for water temperature. This also includes any releases of stored water throughout the year from the reservoir to waters of the state (See water quality condition below). High stream temperatures can be directly lethal to aquatic life but may also have sublethal effects on growth and development during different life stages, as well as the swimming, feeding and reproductive ability of juveniles and adults.

Because of these reasons, the proposed use will diminish water quality, physical habitat, and/or alter the flow regime to which fish are naturally adapted. These changes will negatively affect their distribution, productivity, and abundance. Therefore, a further reduction in flow or alteration of habitat from the proposed use would result in a significant detrimental impact to an existing fishery resource without appropriate conditions and/or mitigation.

Table with 13 columns (Impairment to Fishery Resource, Jan, Feb, Mar, Apr, May, Jun, Jul, Aug, Sep, Oct, Nov, Dec) and 3 rows (Water Quantity, Water Quality). The 'Water Quality' row has shaded cells from April to October.

If YES, can conditions be applied to mitigate the significant detrimental impact to an existing fishery resource?

- NO (explain)
YES (select from Menu of Conditions on next page)

See applicable conditions selected from "Menu of Conditions" on next page

Water is only available to support the quality and quantity of biologically necessary flows at the POD and/or downstream November through March. ODFW recommends the season of use be restricted to coincide with this period or the proposed use be mitigated prior to issuance of a Proposed Final Order for any use outside of this period. Without appropriate mitigation and/or conditions, a further reduction in flow or alteration of habitat from the proposed water use will result in a significant detrimental impact to an existing fishery resource.

Janna Guzman

Digitally signed by Janna Guzman
Date: 2024.07.23
10:36:53 -07'00'

ODFW Signature:

Print Name: Janna Guzman

ODFW Title: Water Planning Coordinator

Date: 7/23/2024

NOTE: This completed form must be returned to the applicant.

Revised 10/4/12; reformatted 5/12/20

Received by OWRD
JUL 24 2024
Salem, OR

MENU OF CONDITIONS FOR WRD, ODFW, DEQ AND ODA

Revised May 12, 2020, March 25, 2021

Received by OWRD

JUL 24 2024

Use this menu to identify appropriate conditions to be included in the permit:

Salem, OR

- Agricultural Water Quality Management Area Rules:** The permittee shall comply with basin-specific Agricultural Water Quality Management Area Rules described in Oregon Administrative Rule Chapter 603-095. The permittee shall protect riparian areas, including through irrigation practices and the management of any livestock, allowing site capable vegetation to establish and grow along streams, while providing the following functions: shade (on perennial and some intermittent streams), bank stability, and infiltration or filtration of overland runoff.
- b52** Water may be diverted only when Department of Environmental Quality sediment standards are being met.
- b5** The water user shall install and maintain adequate treatment facilities meeting current DEQ requirements to remove sediment before returning the water to the stream.
- b51a** The period of use has been limited to November through March.
- b57** Before water use may begin under this permit, a totalizing flow meter must be installed at each diversion point.
- b58** Before water use may begin under this permit, a staff gage that measures the entire range and stage between full reservoir level and dead-pool storage must be installed in the reservoir. The staff gage shall be United States Geological Survey style porcelain enamel iron staff gage style A, C, E or I.
- blv:** Water must be diverted to a trough or tank through an enclosed water delivery system. The delivery system must be equipped with an automatic shutoff or limiting flow control mechanism or include a means for returning water to the stream source through an enclosed delivery system. The use of water shall not exceed 0.10 cubic feet per second per 1000 head of livestock.
- Bypass Flows:** Per 690-410-0070 (2)(c), the following flows shall be bypassed or passed through the reservoir during the filling season:
- 1) When the biologically necessary flows identified below are not available immediately upstream of the impacted area, the permittee shall pass all live flow downstream at a rate equal to the inflow, minus the amount of mitigation water provided upstream, if applicable, and
 - 2) When the biologically necessary flows identified below are available immediately upstream of the impacted area, the permittee shall pass flow downstream at a rate equal to or greater than the biologically necessary flows.
- Once the reservoir has reached the permitted volume, all live flow shall be passed downstream at a rate equal to the inflow.
- The permittee shall quantify and document inflow and outflow and maintain the bypass flows for the life of the permit and subsequent certificate per the approved Bypass Plan. The bypass flow data shall be available upon request by the Oregon Water Resources Department, Oregon Department of Fish and Wildlife, Oregon Department of Environmental Quality, or Oregon Department of Agriculture.
- fence:** The stream and its adjacent riparian area shall be fenced to exclude livestock.
- fishapprove:** The permittee shall install, maintain, and operate fish screening and by-pass devices consistent with current Oregon Department of Fish and Wildlife (ODFW) standards. Fish screening is to prevent fish from entering the proposed diversion while by-pass devices provide adequate upstream and downstream passage for fish. The required screen and by-pass devices are to be in place and functional, and approved in writing by ODFW prior to diversion of any water. The permittee may submit evidence in writing that ODFW has determined screens and/or by-pass devices are not necessary.
- fishmay:** Notwithstanding that ODFW has made a determination that fish screens and/or by-pass devices are not necessary at the time of permit issuance, the permittee may be required in the future to install, maintain, and operate fish screening and by-pass devices to prevent fish from entering the proposed diversion and to provide adequate upstream and downstream passage for fish.
- fishpass:** As required by ORS 509.585, a person owning or operating an artificial obstruction (AO) may not construct or maintain any AO across any waters of this state that are inhabited, or historically inhabited, by native migratory fish (NMF) without providing passage for NMF. A person owning or operating an AO shall, prior to construction, fundamental change in permit status or abandonment of the AO in any waters of this state, obtain a determination from ODFW as to whether NMF are or historically have been present in the waters. If ODFW determines that NMF are or historically have been present in the waters, the person owning or operating the AO shall either submit a proposal for fish passage to ODFW or apply for a waiver or exemption. Approval of the proposed fish-passage facility, waiver, or exemption must be obtained from the department prior to construction, permit modification or abandonment of the AO. Approved fish-passage plans, waivers, and exemptions shall maintain adequate passage of NMF at all times (ORS 509.601) as per the approved plan, waiver or exemption.
- fishself:** The permittee shall install, maintain, and operate fish screening and by-pass devices consistent with current Oregon Department of Fish and Wildlife (ODFW) standards. Fish screening is to prevent fish from entering the proposed diversion while by-pass devices provide adequate upstream and downstream passage for fish. The required screen and by-pass devices are to be in place and functional prior to diversion of any water. Permittee

Applicant Name: Irving Villarreal

ODFW Review

Review Date: 7/23/2024

shall obtain written approval from ODFW that the installation of the required screen and by-pass devices meets the state's criteria or the permittee shall submit documentation that ODFW has determined screens and/or by-pass devices are not necessary.

- Fish Stocking:** Per ORS 498.222 and OAR 635-007-0600, all persons transporting live fish in Oregon shall have a Fish Transport Permit (FTP) issued by the Oregon Department of Fish and Wildlife (ODFW). The permittee shall not stock fish in the reservoir without an FTP approved by ODFW. As part of the FTP permitting process, the permittee may be required to screen the inlet and outlet of the reservoir to ensure that fish cannot escape into public waters and/or to keep wild fish from entering the reservoir.
- futile call:** The use of water allowed herein may be made only at times when waters from the (NAME OF SURFACE WATER) would not otherwise flow into a tributary of the type here River or sufficient water is available to satisfy all prior rights, including rights for maintaining instream flows.
- In-Water Work:** Any in-water work related to construction, development, or maintenance of the proposed use shall be conducted during the preferred flow period of type here unless an alternate time period is approved by the Oregon Department of Fish and Wildlife.
- Live Flow:** Once the allocated volume has been stored, permittee shall pass all live flow downstream at a rate equal to inflow, using methods that protect instream water quality.
- Off-Channel Stored Water Releases:** The permittee shall not release polluted water from this off-channel reservoir into waters of the state except when the release is directed by the State Engineer to prevent dam failure.
- On-Channel Reservoir:** The permittee shall design and operate the water storage facility such that all waters within and below the reservoir meet water quality criteria. The permittee shall develop a reservoir operations plan that details how water quality criteria and standards will be met. A Certified Water Rights Examiner shall verify that the reservoir operations are consistent with the plan before a certificate is issued. The reservoir operator shall maintain a copy of the plan and make it available for review upon request.
- riparian:** If the riparian area is disturbed in the process of developing a point of diversion, the permittee shall be responsible for restoration and enhancement of such riparian area in accordance with ODFW's Fish and Wildlife Habitat Mitigation Policy OAR 635-415. For purposes of mitigation, the ODFW Fish and Wildlife Habitat Mitigation Goals and Standards, OAR 635-415, shall be followed.
- Water Quality:** All water use under this permit shall comply with state and federal water quality laws. The permittee shall not violate any state and federal water quality standards, shall not cause pollution of any waters of the state, and shall not place or cause to be placed any wastes in a location where such wastes are likely to escape or be carried into the waters of the state by any means. The use may be restricted if the quality of source stream or downstream waters decrease to the point that those waters no longer meet existing state or federal water quality standards.
- wq:** The use may be restricted if the quality of the source stream or downstream waters decrease to the point that those waters no longer meet existing state or federal water quality standards due to reduced flows.

Received by OWRD

JUL 24 2024

Salem, OR



Received by OWRD
JUL 24 2024
Salem, OR

Date Received (Date Stamp Here)

OWRD Over-the-Counter Submission Receipt

Applicant Name(s) & Address: Irving Villareal
17059 SE Mallard Rd, Dayton OR 97114

Transaction Type: Alt Res

Fees Received: \$ 1418.00

Cash

Check:

Check No. 3050

Name(s) on Check: Rex Nursery LLC

Thank you for your submission. Oregon Water Resources Department (Department) staff will review your submittal as soon as possible.

If your submission is determined to be complete, you will receive a receipt for the fees paid and an acknowledgement letter stating your submittal is complete.

If determined to be incomplete, your submission and the accompanying fees will be returned with an explanation of deficiencies that must be addressed in order for the submittal to be accepted.

If you have any questions, please feel free to contact the Department's Customer Service staff at 503-986-0801 or 503-986-0810.

Sincerely,

OWRD Customer Service Staff

Submission received by: Corie Lovrien
(Name of OWRD staff)

Instructions for OWRD staff:

- Complete this Submission Receipt and make two (2) copies. Place one copy with the check/cash; and place the other copy with the submission (i.e., the application or other document).
- Date-stamp all pages. (NOTE: Do not stamp check.)
- Give this original Submission Receipt to the applicant.
- Record Submission Receipt information on the "RECEIVED OVER THE COUNTER" log sheet.
- Fold and put one copy of the Submission Receipt with check/cash into the Safe slot. Place the other copy of the Submission Receipt with submission (application/other document) in the top drawer of filing cabinet.