

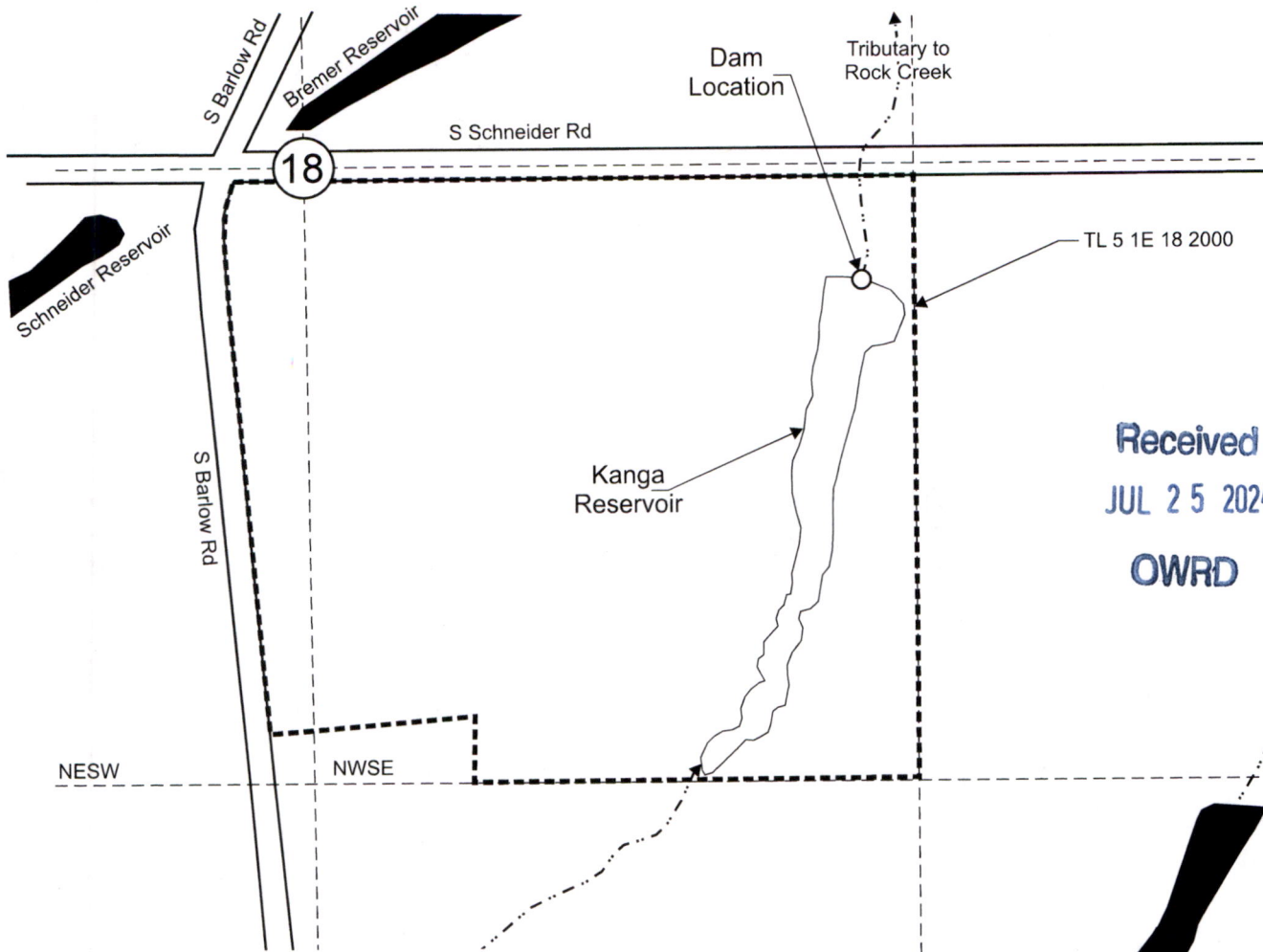

# T.5S. R.1E. Section 18, W.M.



Received  
JUL 25 2024  
OWRD

Dam is located 250 feet south and 1,215 feet east from the C 1/4 corner, Section 18.

 Area (2.2 Acres) to be submerged.

 Tax lot boundary



Scale: 1" = 400'

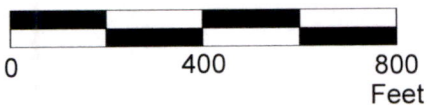

This map was prepared for the purpose of identifying the location of a water right only and is not intended to provide legal dimensions or location of property ownership lines.



## Reservoir Application Map

Jesse and Polligaia Pavla Gooch  
T.5S. R.1E. Section 18, W.M.

Pacific Hydro-Geology Inc.

03/2024