

T.5S. R.2E. Section 9, W.M.

Proposed Well 1 is located 1,215 feet north and 965 feet west from the SE corner, Section 9.

Proposed Well 2 is located 1,440 feet north and 390 feet west from the SE corner, Section 9.

 Area (4.3 Acres) to be irrigated.

 Tax lot boundary

 Donation Land Claim boundary

M. Sweigle
DLC 45

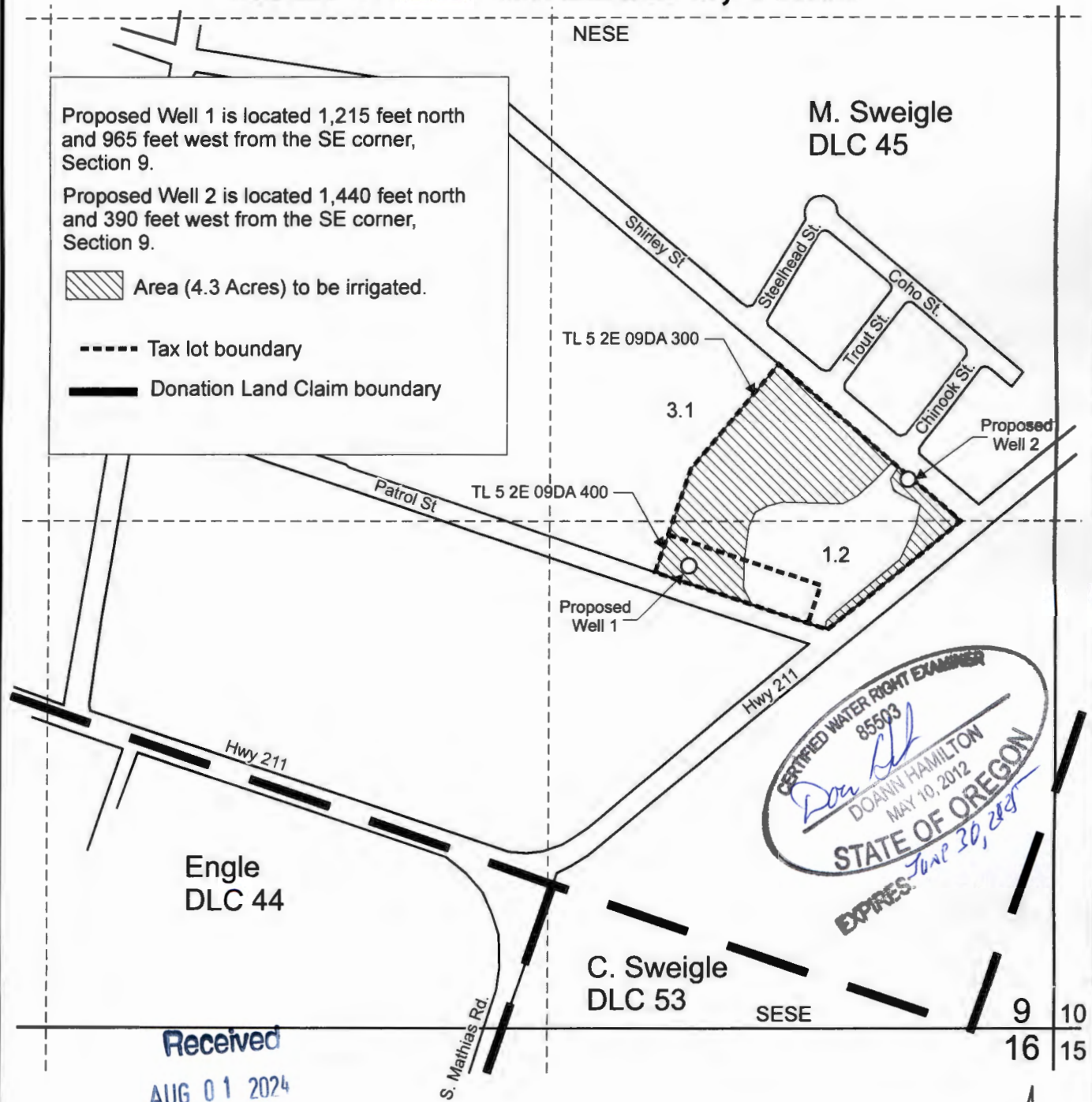

CERTIFIED WATER RIGHT EXAMINER
85503
Doan Hamilton
DOAN HAMILTON
MAY 10, 2012
STATE OF OREGON
EXPIRES: June 30, 2015

Received
AUG 01 2024

OWRD

Scale: 1" = 400'



This map was prepared for the purpose of identifying the location of a water right only and is not intended to provide legal dimensions or location of property ownership lines.



Water Right Application Map

Pacific Hydro-Geology Inc.

Molalla Nazarene Church
T.5S. R.2E. Section 9, W.M.

07/2024

NazareneCWappMap.cdr