

Received by OWRD

AUG 08 2024

Salmon, OR

Sections 4, 7, 8 & 9, T17S, R20E, W.M.,
Crook County, Oregon

Transfer T-13890
CLAIM OF BENEFICIAL USE MAP
Shotgun Creek Ranch, LLC

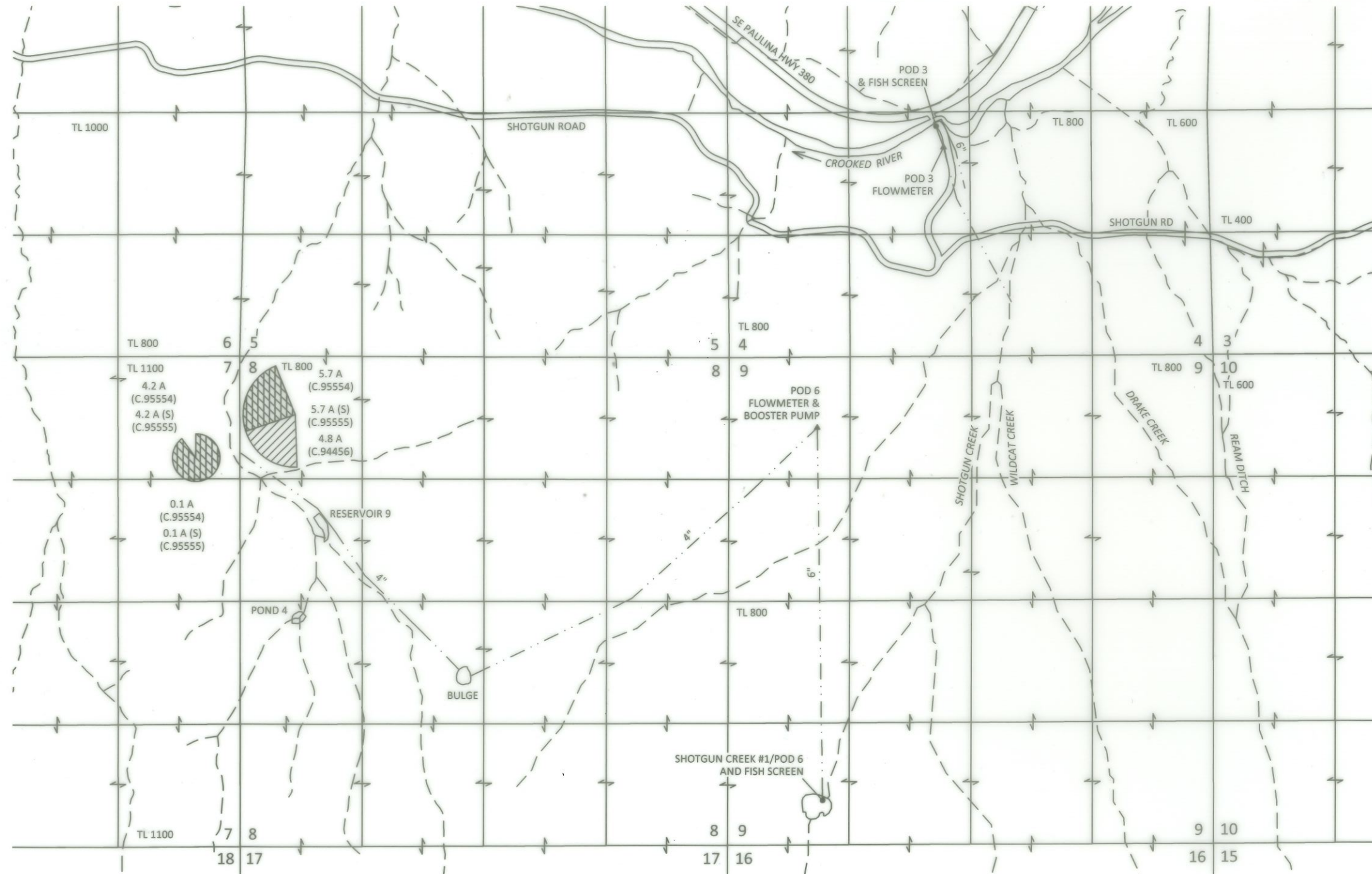

EXPLANATION

-  PLACE OF USE
IRRIGATION - 4.8 ACRES
CANCELED CERTIFICATE 94456
PRIORITY: 1889
-  PLACE OF USE
IRRIGATION - 10.0 ACRES
CANCELED CERTIFICATE 95554
PRIORITY: 1889
-  PLACE OF USE
SUPPLEMENTAL IRRIGATION (S) - 10.0 ACRES
CANCELED CERTIFICATE 95555
PRIORITY: 5/23/1961
-  POINT OF DIVERSION (POD)
-  FLOWMETER
-  PIPE (APPROXIMATE)

Site Inspection Conducted
6/25/2024

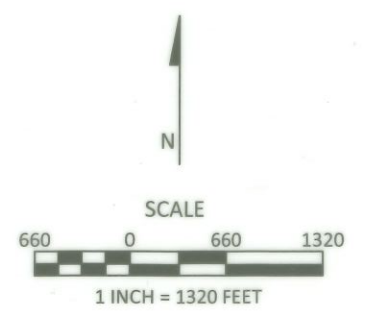

July 24, 2024

This map is not intended to provide legal
dimensions or locations of property
ownership lines

Figure 1

KPFF 170014.36

SKOOKUM
WATER ASSOCIATES INC

1626 VICTORIAN WAY
EUGENE, OR 97401
(503) 319-8926

POD 3 LOCATION: 140 FT S AND 2270 FT E FROM WEST 1/4 CORNER SECTION 4
SHOTGUN CREEK #1/POD 6 LOCATION: 2150 FT S AND 1030 FT E FROM WEST 1/4 CORNER SECTION 9