

2/4-75(1)



Name Shaeffer, Glen T.

Application No. GR 245

Certificate No. GR 221

FEEES PAID

Date	Amount	Receipt No.
8/28/56	\$25.80	8290

By

Address Route 3, Box 225-A

Stream Index, Page No. 2-9/M

Boring, Oregon

Clackamas Co.

FEEES REFUNDED

Date	Amount	Check No.

Date filed 8-28-56 8:00 AM

Tentative priority

ASSIGNMENTS

Action suspended until

Date	To Whom	Address	Volume	Page

Well log filed

REMARKS

CONSTRUCTION

Date for completion

A well irrigates 106 acres near Deep CK-(Clackamas R) Clackamas Co.

Extended to

Date for application of water

Extended to

PROSECUTION OF WORK

Form "B" filed

Form "C" filed

RECEIVED
AUG 3 1956
STATE ENGINEER
SALEM, OREGON

Registration Statement

OF CLAIMANT OF RIGHT TO APPROPRIATE GROUND WATER No. GR-245

(Under Chapter 708, Oregon Laws 1955.) CERTIFICATE No. GR-221

24-7c(1)

TO THE STATE ENGINEER OF OREGON:

I, GLEN T. SCHAEFFER ^{AND} OR BERNICE B. SCHAEFFER
of Rt. 3 Box 225A, BORING County of CLACKAMAS

State of OREGON, do hereby make application for a certificate of registration as evidence of a right to appropriate ground water.

- 1. Source from which water is withdrawn is PUMP WELL
(Flowing well, pump well, infiltration trench, or tunnel)
- 2. Location is: 1 MILE SE BORING
(Approximate distance and direction from nearest city or town)

and is more particularly described as follows:

(a) APPROX 2100' N & 510' W OF CENTER OF SEC 7 254E
(Give distance and bearing to corner of section or other legal subdivision)
being within E 1/4 OF NW 1/4 of Sec. 7, Twp. 2S Rge. 4E-WM
(Smallest legal subdivision) (N. or S.) (E. or W.)

or (b) within limits of recorded platted property, town or city:
in Lot _____, Block _____ of _____
(Name of plat or addition)
County of CLACKAMAS
(If within city or town, give name)

3. Construction Work was begun on JUNE 1951; was completed on AUG 1951
(Date) (Date)
and the ground water claimed was first used for the purposes set out below on AUG 25 1951
(Date)
since which time the water has been used CONTINUOUSLY (FOR IRRIGATION)
(Continuously or intermittently)
from SEPT 1 1951 to AUG 1956
(Date) (Date)

4. Quantity of water claimed and used is 800 gallons per minute; _____ acre feet per year.

5. Purpose or Purposes for which water is used IRRIGATION & DOMESTIC
(Domestic, irrigation, municipal, manufacturing, industrial, etc.)

6. Description of Well: Depth 255 feet. Type DRILLED
(Dug or drilled)
diameter 12" inches. Elevation of ground at well site 600' feet, mean sea level
(As near as known)
Depth to water table 170 feet.

7. Capacity of Well: 1500 g.p.m. with 8' feet drawdown.
_____ g.p.m. with _____ feet drawdown.

Date of test AUG 1951

If Flowing Well: Measured discharge _____ g.p.m. on _____
(Date)

Shut-in pressure at ground surface _____ lbs. per sq. in. on _____
(Date)

Water is controlled by _____
(Cap, valve, etc.)

8. Casing: (Give diameter, commercial specifications and depth below ground surface of each casing size.)

12" inch diameter from GROUND to 259' feet
 inch diameter from to feet
 inch diameter from to feet
 inch diameter from to feet

Describe and show depth of shoe, plug, adapter, liner or other details: SHOE AT 259'
PLUGGED IN BLACK SAND

9. Perforated Casings or Screens:

16 PER FT. 3/8 x 1/4 from 230' to 252'
(Number per foot and size of perforations, or describe screen)
 from to
 from to
 from to

10. Log of Well: (Describe each stratum or formation clearly, indicate if water bearing, and give thickness and depth as indicated.)

MATERIAL	Thickness (Feet)	Depth to Bottom (Feet)
LOAM	2	2
RED CLAY	10	12
MOTTLED CLAY	65	75
CEMENT GRAVEL BOTTEN ROCK	150	225
ROCK	2	227
GRAVEL CLEAN ROPND. H ₂ O	31"	258
BLACK COURSE SAND	1	259

GR-221 A

If log of well is not available, give name and address of driller.

11. Infiltration Trench: Covered or open

Dimensions: Length ft. Minimum depth ft. Maximum depth ft.

Bottom width ft. Discharge g.p.m. Date of test

12. Tunnel: Type of lining

Dimensions:
(Length, course, and cross sectional size)

Position of water bearing stratum with reference to portal of tunnel

Log of tunnel: (Preceding table for log of well may be used, if desired. Give footage from portal and character of materials, as pertinent.)

13. Pumping Equipment:

(a) Pump WESTERN LAND ROLLER Capacity 800 g.p.m.
(Make, type and size)

(b) Motor U.S. ELECTRIC 40 HP.
(Type and horsepower)

14. Location of area irrigated or to be irrigated, or place of use if for purposes other than irrigation.

Township North or South	Range E. or W. of Willamette Meridian	Section	Forty-acre Tract	Number Acres To Be Irrigated	Date of Reclamation
T23	4E	SEC 7		106 Total	June 1951
"	"	"	NE 1/4 of NW 1/4	28	" "
"	"	"	SE 1/4 of NW 1/4	21	" "
"	"	"	SW 1/4 of NE 1/4	25	" "
"	"	"	NE 1/4 of SW 1/4	21	" "
"	"	"	SE 1/4 of SW 1/4	8	" "
"	"	"	NW 1/4 of SE 1/4	3	" "
				<u>106</u>	

15. If the ground water supply is supplemental to an existing water supply, identification of any application for a permit, permit, certificate or adjudicated right to appropriate water made or held by the registrant.

Township 20 Range 4E W.M.
North Boring

OREGON CITY RD
KEISO →

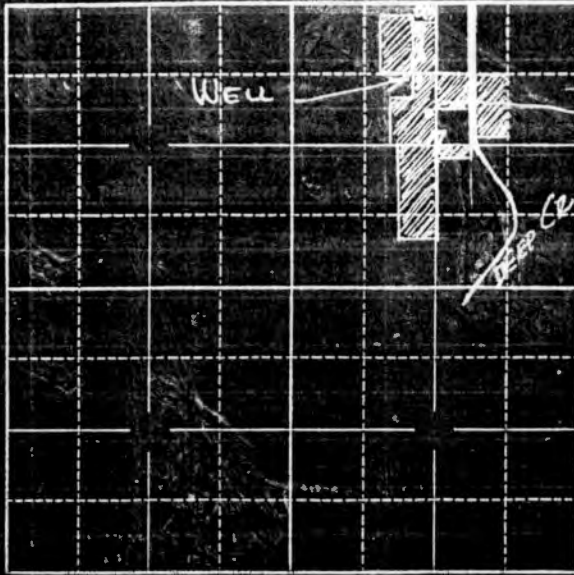

NOTE
DRY 12" hole
drilled 400'
deep 1951

Locate well and acreage of irrigated land on plat.
Scale: 2" = 1 Mile

STATE OF OREGON

County of Multnomah

I, Glen T. Schaeffer, being first duly sworn, do hereby certify that I have read the foregoing Registration Statement and that all of the items therein contained are true to the best of my knowledge and belief.

Glen T. Schaeffer
(Signature of Registrant)

Subscribed and sworn to before me this 2nd day of August, 1956

My commission expires June 28, 1957

E. Neuman
(Notary Public)

(SEAL)

CERTIFICATE OF REGISTRATION

STATE OF OREGON

County of Marion

This is to certify that the foregoing Registration Statement was received in the office of the State Engineer on the 28th day of August, 1956, at 8 o'clock A. M. and has been duly recorded in said office in Book No. 2 of Registration Statements on page GR-221 C.

Witness my hand this 23rd day of November, 1956

Flora A. Stanley
(State Engineer)

By _____
(Deputy)

GR-221 C

RECEIVED
OCT 16 1957
STATE ENGINEER
SALEM, OREGON

Application No. GR-245
Permit No. _____
Reg. Certificate No. GR-221
Owner's Well No. _____
State Well No. _____
County _____

ANNUAL REPORT ON WELLS

(ORS 537.715 requires that an annual report for each well be submitted to the State Engineer, Salem, Oregon)

Report covers period from October 1 to September 30 of following year

1. Have any changes been made in the well or pump during the past year? No
If so, explain: _____
2. What was the maximum rate of use at any time during the past year? 800 gpm
Date AUGUST Observed drawdown 7 feet feet
3. In your opinion is the level of water in this well affected by other pumping operations in your vicinity? No Explain: _____
4. If an irrigation well, how many acres were irrigated this past season? 64
What date did irrigation begin? JUNE Cease? SEPT 15
Number of days of well use 74 Average rate 480 gpm
Depth to water while pumping, 178 ft. below land surface. Date 8/5/57
5. Power consumption for entire year or season 32,240 Kwh
6. Quantity of water pumped or used during year 65 A/yr (gallons or acre feet)
7. What was the cost of pumping per acre irrigated? 87.00
8. Do you consider use of water from this source profitable? Yes
9. Will you operate this well next season? Yes
10. *Measured water levels (one measurement in spring and one in fall)
171 ~~4/16/57~~ feet below land surface. Date of measurement 4/16/57
170 feet below land surface. Date of measurement 10/10/57
Additional water level measurements:

Feet below land surface	Date	Remarks

*(For artesian wells, report head in feet of water, or pounds per square inch.)

11. Remarks: _____

Date _____

Report Prepared By: Glen T. Sharp
(See other side)

ATTENTION WELL OWNERS

Ground water is one of our most valuable resources, and you, the well owner, have a personal responsibility in helping to preserve these resources so that they will still be available for future generations. Your most important duty in this regard is the keeping of accurate records of changes in water levels, quantities of water pumped, and all other changes in the characteristics of our ground-water resources. It is chiefly through your observations that we know what is happening and are able to prevent depletion or contamination of our ground-water supplies.

The measurement of water levels in wells is the only way we can tell if the ground-water resources of an area are being depleted. For that reason, water level measurements given in your annual reports should be as accurate as possible.

We will be glad to supply you with any information we have in regard to methods of measuring water levels, or in measuring quantities of water pumped. Your cooperation in making the annual well report a document of value will be greatly appreciated.

RECEIVED
AUG 3 1956
STATE ENGINEER
SALEM, OREGON

Dear Sir:

Will you advise me as to what fees are necessary to complete this filing, what inspections or proofs etc.

Very truly yours
Glen T. Barber

106 acres
\$ 75.80



STATE OF OREGON
STATE ENGINEER
WATER RESOURCES DEPARTMENT
SALEM

REFER TO
FILE NO. _____

August 24, 1956

Mr. Glen T. Schaeffer
Route 3, Box 225-A
Boring, Oregon

Dear Mr. Schaeffer:

We are in receipt of your well registration statement in which you claim a total of 106 acres of irrigation. The statement appears to be in good order.

Registration fees for the above amount are determined as follows:

Examination Fee:	\$10.00
Recording Fee:	15.80
Total:	<u>\$25.80.</u>

Upon receipt of the above mentioned fees, this office will issue your certificate of registration.

Very truly yours,

LEWIS A. STANLEY
State Engineer

RECEIVED
AUG 28 1956

By *Wm. S. Bartholomew*
Wm. S. Bartholomew
Geologist

WSB:lac

STATE ENGINEER
SALEM, OREGON

*Check enclosed for above
amt —
Glen Schaeffer*

August 24, 1956

Mr. Glen T. Schaeffer
Route 3, Box 225-A
Boring, Oregon

Dear Mr. Schaeffer:

We are in receipt of your well registration statement in which you claim a total of 106 acres of irrigation. The statement appears to be in good order.

Registration fees for the above amount are determined as follows:

Examination Fee:	\$10.00
Recording Fee:	<u>15.80</u>
Total:	\$25.80.

Upon receipt of the above mentioned fees, this office will issue your certificate of registration.

Very truly yours,

LEWIS A. STANLEY
State Engineer

By
Wm. S. Bartholomew
Geologist

WSB:lac

September 5, 1956

Mr. Glen T. Shaeffer
Route 3, Box 225-A
Boring, Oregon

Dear Mr. Shaeffer:

This will acknowledge receipt of your well registration statement and check for fees in the amount of \$25.80. Please find enclosed our receipt No. 8290 for the above amount.

Your statement is in good form and has been filed with others awaiting certification.

Very truly yours,

LEWIS A. STANLEY
State Engineer

By
Wm. S. Bartholomew
Geologist

WSB:lac

Encl.

January 3, 1957

Mr. Glen T. Schaeffer
Route 3, Box 225-A
Boring, Oregon

Dear Mr. Schaeffer:

Enclosed find Certificate of Registration No. GR-221
Registration Statement No. GR-245
Annual Well Report Form

PLEASE READ CAREFULLY THE FOLLOWING INSTRUCTIONS:

Your Registration Statement and the attached Certificate of Registration have been recorded in this office. You should hold this original document as evidence of your claim for water rights.

The Registration Statement and the Certificate of Registration are each a part of the same document. The Certificate of Registration is found on the last page of the Registration Statement.

As provided in ORS 537.610, you, the registrant, are now, prima facie, entitled to the right to appropriate the ground water and apply it to beneficial use to the extent and in the manner disclosed in the recorded Registration Statement until such time as the final water rights are determined by adjudication.

Each holder of a Certificate of Registration is required by law to file an annual well report with this office. This report must give water level measurements, an estimate of the quantity of water pumped, and other information concerning our ground-water resources. For your convenience, we are transmitting a report form so that you will be able to record the necessary information as it is obtained. These reports must be filed at the end of the water year, which is September 30 of each calendar year. Additional report forms for next year will be mailed to you at a later date.

If your land is sold, an assignment of this registration document to the new owner should be recorded in this office. Assignment blanks will be furnished upon request.

Very truly yours,

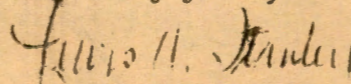

LEWIS A. STANLEY
State Engineer

August 30, 1973

GR-245

Oro Green Nursery, Inc.
Route 3, Box 794
Boring, OR 97009

Gentlemen:

This will acknowledge your application for a permit to construct a reservoir and to store therein 4.1 acre feet of water from a well for the irrigation of the acreage described in the certificate of registration recorded at page 245, Ground Water Registration Records. The small dam data sheet and map were also received. Your reservoir application was not accompanied with the required fees, was not signed in the space provided, and indicates that the reservoir will be filled from a well, so could not be filed.

A permit is not required for the storage of ground water, but if you intend to construct a dam 10 feet in height or higher, it will be necessary for you to submit plans and specifications for your proposed impoundment prepared by a registered professional engineer.

According to your map, the reservoir will be situated within the channel of an unnamed stream. If your proposed reservoir will be storing water from the drainage area of the stream above the dam, your reservoir application should be properly completed and submitted with the required fees and supporting data. It would also be necessary for you to submit an application for a secondary permit to appropriate the stored water. I am enclosing the proper secondary application form.

I am also enclosing a booklet of Rules and Regulations relative to the appropriation and use of surface water. This booklet briefly explains the requirements for completing your applications, the supporting map, and the fees.

I am returning your reservoir application, the small dam data sheet, and map.

Very truly yours,

WAYNE J. OVERCASH
Assistant

WJO:mjf
Enclosures

8. Casings: (Give diameter, commercial specifications and depth below ground surface of each casing size.)

12" inch diameter from GROUND to 259' feet
 _____ inch diameter from _____ to _____ feet
 _____ inch diameter from _____ to _____ feet
 _____ inch diameter from _____ to _____ feet

Describe and show depth of shoe, plug, adapter, liner or other details: SHOE AT 259'
PLUGGED IN BLACK SAND

9. Perforated Casings or Screens:

16 PER FT. 3/8 x 1/4 from 230' to 252'
(Number per foot and size of perforations, or describe screen)
 _____ from _____ to _____
 _____ from _____ to _____
 _____ from _____ to _____

10. Log of Well: (Describe each stratum or formation clearly, indicate if water bearing, and give thickness and depth as indicated.)

MATERIAL	Thickness (Feet)	Depth to Bottom (Feet)
LOAM	2	2
RED CLAY	10	12
MOTTLED CLAY	65	75
CEMENT GRAVEL & ROTTEN ROCK	150	225
ROCK	2	227
GRAVEL CLEAN, ROUND, H ₂ O	31	258
BLACK COURSE SAND	1	259

RECEIVED
AUG 3 1956

STATE ENGINEER
SALEM, OREGON

Registration Statement

OF CLAIMANT OF RIGHT TO APPROPRIATE GROUND WATER REGISTRATION NO. GR-245

(Under Chapter 702, Oregon Laws 1951.) CERTIFICATE NO. GR-221

2/4-1c(1)

TO THE STATE ENGINEER OF OREGON:

I, GLEN T. SCHAEFFER ^{and} OR BERNICE B. SCHAEFFER
of RT. 3 Box 225A, BORING County of CLACKAMAS

State of OREGON, do hereby make application for a certificate of registration as evidence of a right to appropriate ground water.

- 1. Source from which water is withdrawn is PUMP WELL
(Flowing well, pump well, infiltration trench, or tunnel)
- 2. Location is: 1 MILE SE BORING
(Approximate distance and direction from nearest city or town)

and is more particularly described as follows:

(a) APPROX 2100' N & 510' W OF CENTER OF SEC 7 254E
(Give distance and bearing to corner of section or other legal subdivision)
being within E 1/4 OF NW 1/4 of Sec. 7, Twp. 25, Rge. 4E WM
(Smallest legal subdivision) (N. or S.) (E. or W.)

or (b) within limits of recorded platted property, town or city:
in Lot _____, Block _____ of _____
(Name of plat or addition)

County of CLACKAMAS
(If within city or town, give name)

3. Construction Work was begun on JUNE 1951; was completed on AUG. 1951
(Date) (Date)
and the ground water claimed was first used for the purposes set out below on AUG 25 1951,
(Date)
since which time the water has been used CONTINUOUSLY (FOR IRRIGATION)
(Continuously or Intermittently)
from SEPT 1 1951 to AUG 1956
(Date) (Date)

4. Quantity of water claimed and used is 800 gallons per minute; _____ acre feet per year.

5. Purpose or Purposes for which water is used IRRIGATION & DOMESTIC
(Domestic, irrigation, municipal, manufacturing, industrial, etc.)

6. Description of Well: Depth 258 feet. Type DRILLED
(Dug or drilled)
diameter 12" inches. Elevation of ground at well site 680' feet, mean sea level.
(As near as known)
Depth to water table 170 feet.

7. Capacity of Well: 1500 g.p.m. with 8' feet drawdown.
_____ g.p.m. with _____ feet drawdown.

Date of test AUG 1951

If Flowing Well: Measured discharge _____ g.p.m. on _____
(Date)

Shut-in pressure at ground surface _____ lbs. per sq. in. on _____
(Date)

Water is controlled by _____
(Cap, valve, etc.)

If log of well is not available, give name and address of driller.

11. Infiltration Trench: Covered or open

Dimensions: Length _____ ft. Minimum depth _____ ft. Maximum depth _____ ft.

Bottom width _____ ft. Discharge _____ g.p.m. Date of test _____

12. Tunnel: Type of lining _____

Dimensions: _____
(Length, course, and tube sectional size)

Position of water bearing stratum with reference to portal of tunnel _____

Log of tunnel: (Preceding table for log of well may be used, if desired. Give footage from portal and character of materials, as pertinent.)

13. Pumping Equipment:

(a) Pump WESTERN LAND ROLLER Capacity 800 g.p.m.
(Make, type and size)

(b) Motor U.S. ELECTRIC 40 HP
(Type and horsepower)

14. Location of area irrigated or to be irrigated, or place of use if for purposes other than irrigation.

Township North or South	Range E. or W. of Willamette Meridian	Section	Forty-acre Tract	Number Acres To Be Irrigated	Date of Reclamation
T23	4E	SEC 7		106 Total	June 1951
"	"	"	NE 1/4 of NW 1/4	28	" "
"	"	"	SE 1/4 of NW 1/4	21	" "
"	"	"	SW 1/4 of NE 1/4	25	" "
"	"	"	NE 1/4 of SW 1/4	21	" "
"	"	"	SE 1/4 of SW 1/4	8	" "
"	"	"	NW 1/4 of SE 1/4	3	" "
				<u>106</u>	

15. If the ground water supply is supplemental to an existing water supply, identification of any application for a permit, permit, certificate or adjudicated right to appropriate water made or held by the registrant.