

Application No. R-72732
Permit No. R12091

T.1&2S,R.2E.W.M.

RECEIVED

SEP 1 1992

WATER RESOURCES DEPT.
SALEM, OREGON

RECEIVED

SEP 2 1992

WATER RESOURCES DEPT.
SALEM, OREGON

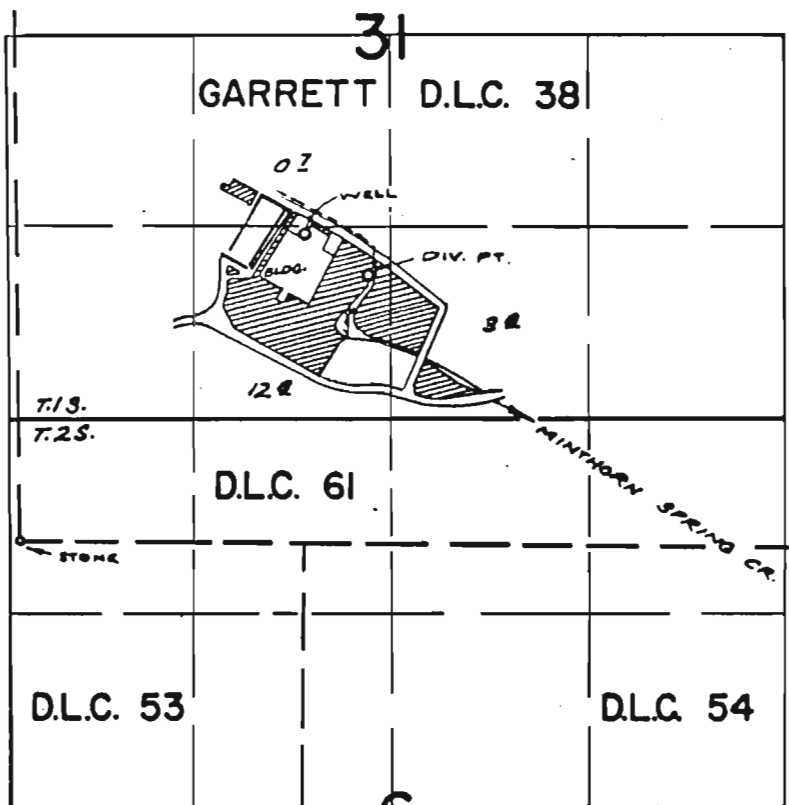

WELL LOG: 1900' E. & 2010' N. FROM S.W. COR. GARRETT D.L.C. 38
DIV. PT. 1001' E. & 1000' N.

FINAL PROOF SURVEY UNDER

TRANSFER No. 0-54
Application No. G-1517 Permit No. G-4276
IN NAME OF

OMARK PROPERTIES, INC.

Surveyed Nov. 6 1970, by L. E. GAULD.