







T17S R11E, WM DESCHUTES COUNTY, OR

-  Well
-  Pipeline
-  Bulge-in-System
-  POU NU
-  Section
-  Tax Lot
-  Quarter Quarter

- Well Locations:**
- Well #1 (DESC 52523/L-20423):**
450' S, 570' W of N 1/4 Cor Sec 22
- Well #2 (DESC 59987/L-114526):**
1160' S, 360' W of E 1/4 Cor Sec 16
- Well #3 (DESC 59434/L-108428):**
140' N, 180' W of E 1/4 Cor Sec 16
- Well #4 (DESC 58486/L-96134):**
1140' S, 410' W of N 1/4 Cor Sec 15

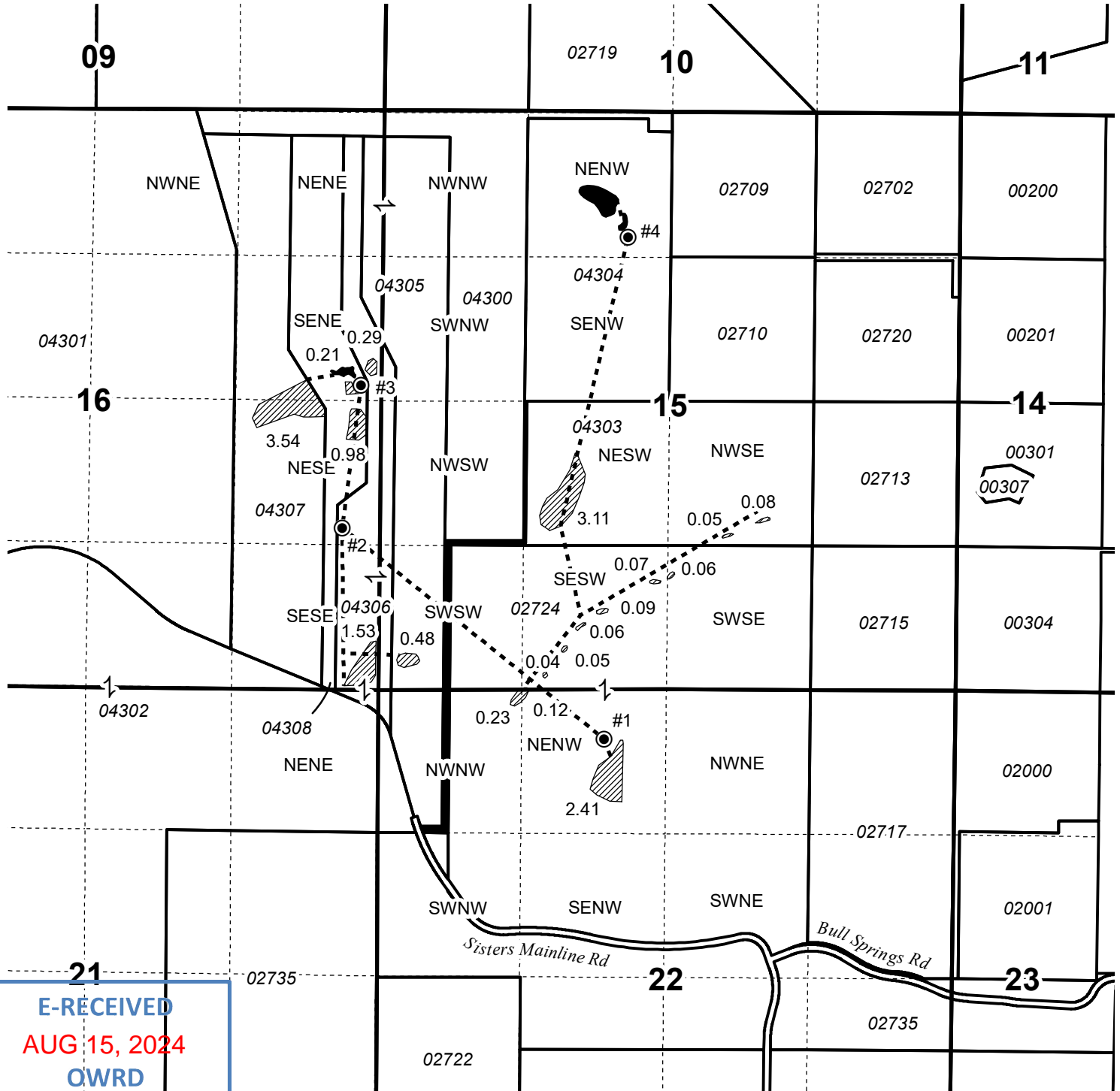
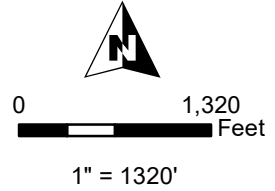

GROUNDWATER APPLICATION MAP
James & Jean Verheyden

Date Revised: 4/11/2024

This map is not intended to provide legal dimensions or locations of property ownership lines.

WATER RIGHT SERVICES, LLC
PO BOX 1830, BEND, OR 97709
WWW.OREGONWATER.US CCB # 197121
johnshort@usa.com 541-389-2837