

TOWNSHIP 2 SOUTH, RANGE 1 WEST, W.M.

RECEIVED

DEC 15 1966

WATER RESOURCES DEPT.
SALEM, OREGON

POD's
Res. A 800'S & 1900'E
B 900'S & 2250'E
C 670'S & 1400'E
all from W¼ cor
8" FVC from B & C to A

Res. A: 850'S & 1850'E
Res. B: 900'S & 2370'E
Res. C: 630'S & 1350'E
all from W¼ cor

Res. A 12.0 ac. ft.
B 10.4 ac. ft.
C 13.6 ac. ft.

All 3 res. - B' top width minimum
2:1 dn 3:1 up
3' freeboard

Res A SA = 1.8 acres
wt. depth = 10'
B SA = 1.6 acres
wt. depth = 10'
C SA = 2.1 acres
wt. depth = 10'

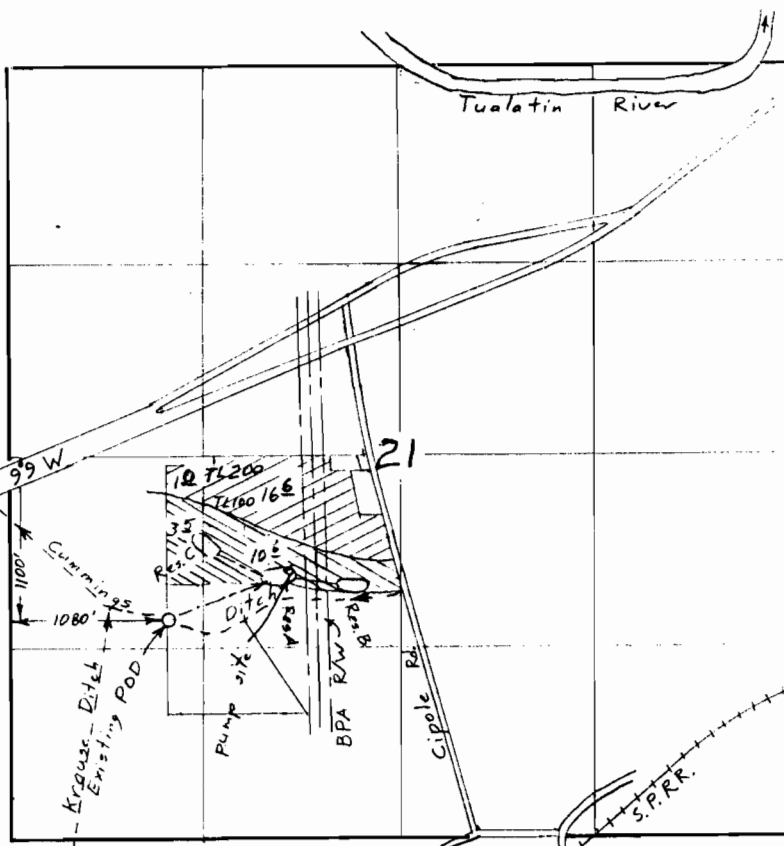

Scale 1" = 1320'

App. R-72587
S-72588

Per. R-12759

APPLICATION MAP

for

LOEN NURSERY

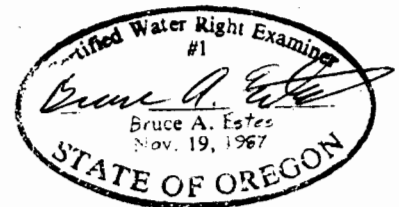

ESTES SURVEYS
6293 Sunnyview Rd. NE Salem, OR 97305 (503) 585-7593
60382 Arnold Rd. Bend, OR 97702 (503) 382-7391

This map is for the purpose of locating a water right only and has no intent to provide legal dimensions or the location of property lines.

Map 25, 1999
Amended July 16, 1996