

Application No. 9252

Permit No. 6089 Part

Certificate No. 8186 **CANCELED**

68632

FEEES PAID

Date	Amount	Receipt No.
	<u>1.00</u>	<u>3524</u>
Total		

Name Portland Golf Club.

By Portland Ave.

Address Portland Ave.

Date filed

Action suspended until

Returned to applicant

Date completed

Date of approval

CONSTRUCTION

Date for beginning Dec. 8, 1924

Date for completion June 1, 1925

Extended to

Date for application of water Oct. 1, 1926

Extended to

PROSECUTION OF WORK

Form "A" filed Dec. 18, 1923

Form "B" filed June 27, 1925

Form "C" filed " " "

FINAL PROOF

Blank mailed Aug. 4, 1925

Proof received Feb. 10, 1926

Date certificate issued Oct. 25, 1929

Receipt for recording fee No. 3524

Stream Index, Page No.

Application Record, Book No.

FEEES REFUNDED

Date	Amount	Check No.

ASSIGNMENTS

Date	To whom	Address	Volume	Page

REMARKS

2.6 sec ft. from Fanno Crk. for dom. & irr. 112.86 acres

T-6338 Δ USE, POU, POD
CANCELED Part. Sp. Or. Vol 44, Page 453

MAP

ACCOMPANYING APPLICATION NO. 9252 FOR
PERMIT TO APPROPRIATE WATER

FOR

PORTLAND GOLF CLUB

Scale: 2 in. = 1 m.

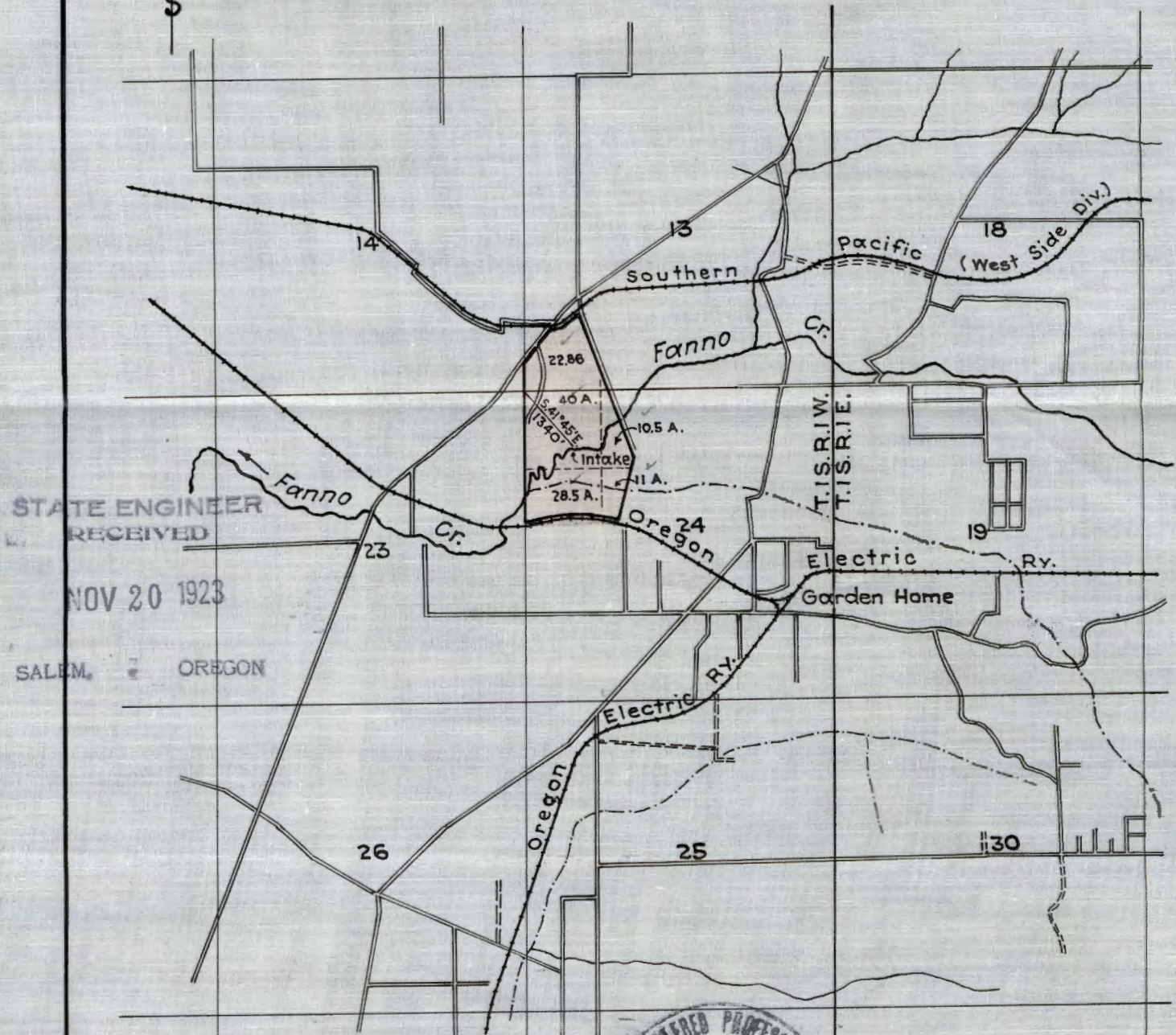
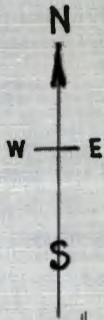

STATE ENGINEER
RECEIVED

NOV 20 1923

SALEM, OREGON

Application No. 9252
Permit No. 6089

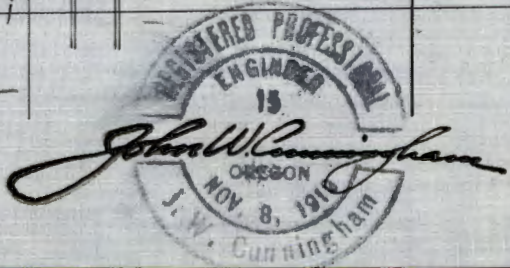

BAAR AND CUNNINGHAM
CONSULTING ENGINEERS
PORTLAND, OREGON.

MAP
ACCOMPANYING APPLICATION FOR PERMIT TO
EXTRACT WATER
FOR
PORTLAND GOLF CLUB
Scale 5 in = 1 mi



270

9252



Application No. 107
Portland, Me. 1908

STATE OF MAINE
DEPARTMENT OF CONSERVATION
BUREAU OF WATER RESOURCES

MAP

ACCOMPANYING APPLICATION NO. 9252 FOR
PERMIT TO APPROPRIATE WATER

FOR

PORTLAND GOLF CLUB

Scale: 2 in. = 1 m.

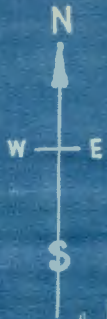

STATE ENGINEER
RECEIVED

NOV 20 1928

SALMON, OREGON

9252

Application No. 9252
Permit No. 6089



BAAR AND CUNNINGHAM
CONSULTING ENGINEERS
PORTLAND, OREGON.

8186



Permit No. 6089

County of WASHINGTON

Application No. 9252

Proof of Appropriation of Water

(In accordance with the provisions of Chapter 216, Laws of Oregon for 1909, and the regulations of the State Engineer thereunder.)

- Name Portland Golf Club
- Postoffice address Route #1 Beaverton, Oregon
- Source of supply Fanno Creek
Tributary of Tualatin River
- For what purpose is water used? Domestic & Irrigation
- Amount of water 2.6 ~~1.4~~ second feet
- Priority date November 13, 1923

7. The description of land given below corresponds to that found in your permit covering land to be irrigated, or, if for other purposes, the place of use. In the blank column on the right, headed "No. acres actually irrigated," fill in the number of acres you have irrigated in each of the tracts described.

Township	Range	Section	Forty-acre Tract	No. Acres Described in Permit	No. Acres Actually Irrigated
1 S	1 W	13	SW $\frac{1}{4}$ SW $\frac{1}{4}$	22.86	20.36
		24	NW $\frac{1}{4}$ NW $\frac{1}{4}$	40	39.
			NE $\frac{1}{4}$ NW $\frac{1}{4}$	10.5	10.5
			SE $\frac{1}{4}$ NW $\frac{1}{4}$	11	11.
			SW $\frac{1}{4}$ NW $\frac{1}{4}$	28.5	25.75
					40/106.61 (2.07)
					20
					266
					247
					261
			NW $\frac{1}{4}$ NW $\frac{1}{4}$ Sec 24 1 S 1 W		

8. During what months is water beneficially used? June, July, August, September
9. State the character of the soil and kind of crops raised Clay loam
Fine turf, grasses, shrubs, flowers etc
10. Does the accompanying blue print of the map filed with your permit show correctly the location of diverting works and area of land where water is used? Yes
11. If not, wherein is such map in error
12. If the dimensions of your ditch or dam do not correspond to those described in your permit, state what changes have been made, giving dimensions of ditch (or other distributing works)
13. If water is used for power, mining, domestic, municipal, storage, manufacturing, or any other purpose than irrigation, give the extent and method of such use

STATE OF OREGON,

COUNTY OF Multnomah

} ss.

club

I, L. W. Humphreys, Pres. of the Portland Golf, being first duly sworn, depose and say that I have read the above and foregoing proof of appropriation of water; that I know the contents thereof; and that the facts therein stated are true.

IN WITNESS WHEREOF, I have hereunto set my hand this 10th day of September, 1925.

L W Humphreys

Subscribed and sworn to before me this 10th day of September, 1925.

D B Knapp
 Notary Public for Oregon

My commission expires March 14 - 1928.



[NOTARIAL SEAL]

AFFIDAVIT OF WITNESSES

We, Frank Scott, and B.F. Lawrence,
of Multnomah & Polk Co. Oregon, being first duly sworn, depose and say that
we are well acquainted with the facts and conditions set forth in the foregoing statement relative
to proof of appropriation of water under Permit No. 6089; that we and each of us have
been over and upon each tract described in said proof, and from such personal inspection have
knowledge that all necessary ditches, dams and other diversion and distributing works have been
constructed, and water used as stated therein; that we have carefully read such proof of appropria-
tion, and that each and every statement contained therein is true to the best of our knowledge
and belief.

Frank Scott

B.F. Lawrence

Subscribed and sworn to before me this 4th day of February, 1926.

[NOTARIAL SEAL]

Chas. Fry

Notary Public for Oregon

Justice of the Peace for
My commission expires _____
The District of Beaverton
Washington County Ore.

REPORT OF PERSON MAKING INSPECTION

I, J.H. Ryan, do hereby certify that I have made
an inspection of the works described herein and in Permit No. 6089 on the 5th day
of September, 1929, and found the foregoing statements and descriptions of works
to be accurate. In my opinion the appropriation has been completed to the extent of
2.6 sec. ft. and I recommend the issuance of a water right certificate for this amount.

J.H. Ryan

(Name)

Asst. to State Engr.

(Title)

ENCLOSURE BOARD

PROOF OF APPROPRIATION

Permit No. 6089

Recording fee paid

Receipt No. 3524

STATE ENGINEER
RECEIVED

FEB 10 1926

SALEM. --- OREGON

SUCCESS BOND

SUCCESS BOND

AFFIDAVIT

STATE OF OREGON)
) ss.
County of WASHINGTON)

I, ROBERT L. FOOTE, PRESIDENT, of PORTLAND GOLF CLUB, 4900 S.W. SCHOLLS FERRY ROAD, PORTLAND, OREGON, 97255, being first duly sworn, depose and say that PORTLAND GOLF CLUB is the owner of a water right and the land to which it is appurtenant, which is for the use of 0.02 cubic foot of water per second from Fanno Creek for irrigation of the following described land:

SW 1/4 SW 1/4 0.21 ACRE
SECTION 13

NW 1/4 NW 1/4 0.42 ACRE
SW 1/4 NW 1/4 1.20 ACRES
SECTION 24

TOWNSHIP 1 SOUTH, RANGE 1 WEST, W.M.

and for the use of 0.07 cfs from Fanno Creek for domestic use, with a priority date of November 13, 1923, as described by the certificate recorded at page 8186, Volume 8, State Record of Water Right Certificates; that Portland Golf Club has abandoned any and all interest in and to said portion of said water right and request the same be canceled.

IN WITNESS WHEREOF, I hereunto set my hand

this 19 day of September, 1990.

Robert L. Foote
(SIGNATURE)

President
(TITLE)

Subscribed and sworn to before me this 19 day
of September, 1990

Nancy M. Callahan
Notary Public for Oregon

March 23, 1993
My Commission Expires

November 4, 1968

Anderson and Jacob
Attorneys at Law
745 Morgan Building
Portland, Oregon 97205

ATTENTION: Norman E. Anderson

Dear Sir:

The only way a perfected right as evidenced by a certificate can be lost is by abandonment. Failure to use the water for any period of five successive years shall be presumed to be an abandonment of the water right.

When the certificate recorded at page 8186 was issued to Portland Golf Club, we were using only one form. The fifty year expiration period only pertains to the use of water for power and not for the use of irrigation although I will admit that the wording is not real clear. You might wish to see ORS 537.250 and 540.610.

Very truly yours,

CHRIS L. WHEELER
State Engineer

By
Trevor Jones
Assistant

TJ:slh

ANDERSON & JACOB
ATTORNEYS AT LAW
745 MORGAN BUILDING
PORTLAND, OREGON 97205

NORMAN E. ANDERSON
ROBERT T. JACOB
RONALD D. BAILEY

AREA CODE 503
TELEPHONE 228-9691

October 16, 1968

RECEIVED
OCT 17 1968
STATE ENGINEER
SALEM OREGON

State Engineer
State of Oregon
Water Researcher's Department
Public Service Building
Salem, Oregon 97310

Gentlemen:

At my request, you have forwarded to me Certificate No. 8186 in the name of Portland Golf Club for the use of the waters of Fanno Creek. The undersigned is a member of the Green Committee of Portland Golf Club, and was requested to get a copy of the water right on behalf of that particular committee.

The Certificate as to the water right shows that the priority of the right continues until November 15, 1973. The question presented to me by the Committee is whether the water right automatically terminates on that date, or whether it can be renewed.

If you have a pamphlet or other departmental memo concerning applications or rights to renew water rights at the ^{Time} term of the initial expiration date, it would be much appreciated if you would forward the same to me.

Thank you for your cooperation.

Very truly yours,

Norman E. Anderson

NEA:sk

Clark of VSA

3-4 years ago

Ferris Co Vista Brook

Heater

pump water out.

Nights

Sent to Clayton

but doubtful if can
help since they do have



July 9, 1936

Mr. R. M. Burley
1109 Yeon Building
Portland, Oregon

Dear Sir:

This is in reply to your letter of July 6, requesting information concerning water rights on Fanno Creek in Sections 13 and 24, Township 1 South, Range 1 West, W.M.

According to our records water right certificate No. 8186 has been issued to the Portland Golf Club granting a right to the use of 1.4 second-feet of water from Fanno Creek for the irrigation of 106.61 acres in Sections 13 and 24, Township 1 South, Range 1 West, W.M., with a priority of November 15, 1923.

Certificate No. 11409 has been issued to Stark Brothers granting a right to the use of 0.25 second-foot of water from Fanno Creek for the irrigation of 18 acres with a priority of September 5, 1935.

Application No. 16432 has been filed by Tom Michos for permit to appropriate water from Sylvan Creek, tributary of Fanno Creek, for the irrigation of 4 acres.

These are the only filings on Fanno Creek or its tributaries in Section 13 and 24, Township 1 South, Range 1 West, W.M., although there are numerous other filings on Fanno Creek and its tributaries, most of which are at points lower down the creek.

Very truly yours

CHAS. E. STRICKLIN
State Engineer

By
V. S. Bovelie, Ass't.

VSB EL

9252

R. M. BURLEY
LAW OFFICE
SUITE 1109 YEON BUILDING
ATWATER 3158
PORTLAND, ORE.

HOWARD BOND
MADE IN U.S.A.

July 6, 1936.

RECEIVED
JUL 7 1936
STATE ENGINEER
SALEM, OREGON

State Engineer,
Salem,
Oregon.

Dear Sir:

I desire to know what filings for water rights have been made on the water from Fanno Creek in Sections 13 and 24, Township 1 South, Range 1 West, Washington County, Oregon.

I am writing this on behalf of the Portland Golf Club through whose property said creek flows. I am sure that the Portland Golf Club in former days made certain filings on the water from this creek but would like particular information in regard to said filings and whether the Club's rights still are in force. I am also interested in any other filing that might effect the rights of the Portland Golf Club.

Thanking you for this information, I am,

Yours very truly,



R. M. BURLEY

RMB:NB

16432

16029

A-16432 - Tom Michos -

Alton Cr. - inq. re - 6/24/36 -

C11408 - Stark Brothers -

0.23 Fanno Cr. - 10 ac -

9/5/35

HOWARD BOND
MADE IN U.S.A.

Portland Golf Club
512 Pittcock Block.
Portland, Oregon

app. 9252 per. 6089

2.6 sec. ft. from Fanno Co. for domestic
and irrigation of 112.86 acres.

December 8, 1924

June 1, 1925

October 1, 1926

a filed

B+C filed + ack.

Proof mailed 8/4/25

Receipt No. 3524

2-11-26 - to be inspected
G. A. N. has proof

NOTICE OF BEGINNING OF CONSTRUCTION

I, Lester M. Humphreys, Secy of Portland Golf Club, the holder of Application No. 9259, being

Permit No. 6089, issued by the State Engineer of the State of Oregon
(Reservoir or Enlargement)

for the appropriation of 2.6 second-feet of the waters of Fanno Creek
 in accordance with the tenor of such permit and the limitations endorsed thereon by the State Engineer,

began the actual construction of the works described therein on the 8th day of December, 1923,
 being within the time limitation as fixed in said permit for the beginning of construction work.

3240 feet 2 inch and 1 1/2 inch galvanized iron pipe laid in trenches, connected
 The appropriator should state the manner of beginning construction work, number of men and teams employed, the amount of work completed up to the date of this
and covered - four men employed since Dec 8, 1923. Heretofore pump house
 statement, and any additional information which may tend to show the beginning of work in good faith.

erected, and pump and engine installed

IN WITNESS WHEREOF, I have hereunto set my hand this 17th day of December, 1923,

512 Pittcock Block Portland Ore

(Present Address)

Portland Golf Club

(Signature of Applicant)

by Lester M. Humphreys

Rec. Dec 18 - 23

EXCHANGE SHOP

NOTICE OF COMPLETE APPLICATION OF WATER TO A BENEFICIAL USE

I, PORTLAND GOLF CLUB, the holder of Application No. 9252, being
 Permit No. 6089, issued by the State Engineer of the State of Oregon
 (Reservoir or Enlargement)
 for the appropriation of 2.6 second-feet of the waters of FANNO CREEK
 in accordance with the tenor of such permit and the limitations endorsed thereon by the State Engineer,
 completely applied the water to a beneficial use, on the 15 day of JUNE, 1925,
 being the time limitation as fixed in said permit or extended by the State Water Board for the complete
 application of water to a beneficial use.

Remarks:

.....
 If all of the water granted in the permit had not been fully applied to beneficial use, you should so state, so that delinquent appropriators may

 have notice.

IN WITNESS WHEREOF, I have hereunto set my hand this 15th day of JUNE, 1925,
PORTLAND GOLF CLUB

R, Route 1, Beaverton, Oregon.

(Present Address)

BY

Lester M. Humphrey
 (Signature of Applicant) SECRETARY

Fill out, detach, and mail to the Secretary, State Water Board, Salem, Oregon.

NOTICE OF COMPLETION OF CONSTRUCTION

I, PORTLAND GOLF CLUB, the holder of Application No. 9252, being
 Permit No. 6089, issued by the State Engineer of the State of Oregon
 (Reservoir or Enlargement)
 for the appropriation of 2.6 second-feet of the waters of Fanno Creek
 in accordance with the tenor of such permit and the limitations endorsed thereon by the State Engineer,
 have completed the construction of the works described therein the 1st day of JUNE, 1925,
 being within the time limitation as fixed in said permit or extended by the State Water Board for the
 completion of construction work.

Remarks:

.....
 If the works have a less capacity than as described in the permit, or you have definitely abandoned your plan of irrigating any of the lands described

 in your permit, you should so state in order that our records may not be unnecessarily encumbered.

IN WITNESS WHEREOF, I have hereunto set my hand this 1st day of JUNE, 1925,
PORTLAND GOLF CLUB

Route 1, Beaverton, Oregon.

(Present Address)

BY

Lester M. Humphrey
 (Signature of Applicant) SECRETARY

Fill out, detach, and mail to the Secretary, State Water Board, Salem, Oregon. Form D should be used in reporting progress of work if more than one year has been
 allowed for completion.

STATE ENGINEER
RECEIVED

JUN 27 1925

SALEM, OREGON

ER

STATE ENGINEER
RECEIVED

JUN 27 1925

SALEM, OREGON

February 11, 1926.

Portland Golf Club,
Mr. R. H. Hatfield, Manager,
R.F.D. 1,
Beaverton, Oregon.

Gentlemen:

I am in receipt of your letter of February 8th, transmitting proof of appropriation of water and the one dollar recording fee under your Permit No. 6089.

Official receipt number 3524 is enclosed covering the above amount.

This appropriation will be inspected before final water right certificate is issued.

Yours very truly,

H.
Enclosure.

Rhea Luper,
State Engineer.

PORTLAND GOLF CLUB

R. F. D. NO. 1

BEAVERTON, OREGON

February 8, 1926

State Engineer
Salem, Oregon

Dear Sir:

Enclosed herewith you will find final proof of appropriation of water under permit number 6089, together with \$1.00 in currency for recording water right certificate.

Yours truly,

R. S. Hatfield
Ass't. Sec. and Mgr.

RHH.E
enc.

STATE ENGINEER
RECEIVED

FEB 10 1926

SALEM. - - OREGON

August 4, 1925.

Portland Golf Club,
512 Pitteck Block,
Portland, Oregon.

Dear Sir:

I am enclosing herewith blanks for making final proof of appropriation of water under Permit No.

6089.

After the proof has been carefully filled out and signed before a notary public, it should be returned to this office, together with \$1.00 for the purpose of recording the water right certificate in the county records.

I am also enclosing a copy of instructions which may be found helpful in completing the proof.

Yours respectfully,

H.
Enclosures.

Rhea Luper
State Engineer

Dear Sir:

I am enclosing herewith plans for making final proof of appropriation of water under permit No.

After the proof has been carefully filled out and signed before a notary public, it should be returned to this office, together with \$1.00 for the purpose of recording the water right certificate in the county records.

I am also enclosing a copy of instructions which may be found helpful in completing the proof.

Yours respectfully,

Edna Inger
State Engineer

H
Enclosures

PORTLAND GOLF CLUB

R. F. D. NO 1

BEAVERTON, OREGON

June 25, 1925.

Secretary,
State Water Board,
Salem, Oregon.

Dear Sir:

Enclosed is notice of completion of construction by the Portland Golf Club on application No. 9252, permit No. 6087, for the appropriation of the water of Fanno Creek, together with notice of complete application of water to beneficial use; the date of completion of construction being June 1, 1925, and the date of complete application to beneficial use June 15, 1925.

Very truly yours,

Portland Golf Club

R. W. Hatfield
Manager.

Enc. 2
RHH/E

STATE ENGINEER
RECEIVED

JUN 27 1925

SALEM

OREGON

PORTLAND GOLF CLUB
512 PITTOCK BLOCK
PORTLAND, OREGON

December 17th, 1923.

Secretary, Water Board,
Salem, Oregon.

Dear Sir:-

Inclosed please find herewith,
notice of beginning of construction, ap-
plication No. 9252, and permit No. 6089,
in connection with appropriation by
Portland Golf Club, of water from Fanno
Creek.

Yours very truly,

Lester M. Humphreys
Secretary.

LWH:DK
Inc.

STATE ENGINEER
RECEIVED
DEC 18 1923
SALEM,
OREGON

May 25, 1946

Public Health Department
Hillsboro, Oregon

Attention: Wm. J. Daniel, Jr.
County Sanitarian

Dear Mr. Daniel:

In reply to your letter of May 22 this will advise you that a certificate recorded in this office in the name of the Portland Golf Club on Page 8186 confirms the right to the use of 1.4 cubic feet of water per second for domestic use and the irrigation of 106.61 acres from Fanno Creek, with a priority of November 13, 1923.

Yours very truly,

CHAS. E. STRICKLIN
State Engineer

By
Ed K. Humphrey, Assistant

EKH lyh



certif 8186
9252

PUBLIC HEALTH DEPARTMENT

HILLSBORO, OREGON

May 22, 1946

RECEIVED
MAY 24 1946
STATE ENGINEER
SALEM, OREGON

Mr. Charles E. Stricklin
State Engineer
Water Resources Department
Salem, Oregon

Dear Mr. Stricklin:

Would you be able to tell us whether or not the Portland Golf Club owns a water right on Fanno Creek in Washington County—S. W. $\frac{1}{4}$ of Section 13, T. 1 S, R. 1 W, The property is owned by the Portland Trust Co.

The club maintains a large pond which is used for irrigation.

Very truly yours,

Hollister M. Stolte, M. D.
Medical Director, Part Time

Wm J. Daniel, Jr.
COUNTY SANITARIAN

By:
Wm. J. Daniel, Jr.
County Sanitarian

WJD:bm

November 15, 1923.

Messrs. Baar and Cunningham,
415 Spalding Building,
Portland, Oregon.

Gentlemen:

I am in receipt of your letter of November 10th, making application for permit to appropriate water from Fanno Creek in the name of the Portland Country Club, and enclosing check in the sum of \$3.00 in payment of the examination fee. In accordance with your request we have considered your letter an application for permit to appropriate water and given the application number 9252. Official receipt number 252 covering the \$3.00 examination fee is enclosed.

I am also enclosing application blank partially filled out with the information contained in your letter. The blank should be completed, signed and returned to this office with the required maps and balance of fees and will be substituted for the preliminary application on file.

I am also in receipt of your letter of November 15th and upon checking our records I find the following filings on Fanno Creek:

Application No. 7679, Permit No. 4814 by C. F. Nash, for the appropriation of 0.06 second foot of water for irrigation of 4.36 acres. The point of diversion is located in Section 2, Tp. 2 South, R. 1 W.

Application No. 9193 by A. E. Hartshorn, for the appropriation of 0.15 second foot of water for irrigation of 10 acres. The point of diversion is located in Section 22, Tp. 2 South, R. 1 W.

Application No. 2465, Permit No. 1501 by Brenislav Sobolewski, for the appropriation of 0.15 second foot of water for irrigation of 3.57 acres. The point of diversion is located in Section 25, Tp. 1 South, R. 1 W.,

Application No. 8035, Permit No. 5196 by Forbes B. Tompkins, for the appropriation of 0.5 second foot of water from Cedar Creek tributary to Fanno Creek for irrigation of 40 acres. The point of diversion is located in Section 35, Tp. 1 South, R. 1 W.

Very respectfully,

ER:H
Enclosure.

Rhea Luper,
State Engineer.

**BAAR AND CUNNINGHAM
ENGINEERS**

413-16 SPALDING BUILDING
PHONE BROADWAY 6921

FILE NO. 15

PORTLAND, OREGON November 10, 1923

Mr. Rhea Luper
State Engineer
Salem, Ore.

9259

Dear Sir;

We wish to make application, in behalf of the Portland Country Club, for the appropriation of five (5) second feet of water from Fanno Creek, a tributary of the Tualatin River. This water will be diverted by a pumping plant in Section 24, T.1 S. R.1 W. W.M. and will be used for domestic purposes and for irrigation of 113 acres owned by the club.

We are enclosing check for \$3.00 for the examination fee. Will you please consider this letter as an informal application, pending the preparation of maps and application for permit on the regular form.

Yours very truly,

BAAR AND CUNNINGHAM

By

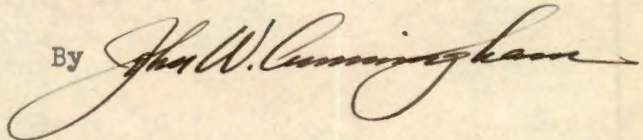

JWC-A

App.

#3⁰⁰ Exam. fee

**STATE ENGINEER
RECEIVED**

NOV 13 1923

SALEM, OREGON

**STATE ENGINEER
RECEIVED**

NOV 9 1923

SALEM, OREGON

**BAAR AND CUNNINGHAM
ENGINEERS**

413-16 SPALDING BUILDING
PHONE BROADWAY 6921

FILE NO.

PORTLAND, OREGON November 13, 1923.

Mr. Rhea Luper,
State Engineer,
Salem, Oregon.

Dear Sir:

On November 10th we made a preliminary application for the appropriation of 5 second feet of water from Fanno Creek, a tributary of the Tualatin River, in behalf of the Portland Country Club. Will you be kind enough to change the name of the party making application to the Portland Golf Club. Will you also kindly advise whether there are any other filings on Fanno Creek, and oblige.

Yours very truly,

BAAR AND CUNNINGHAM

By

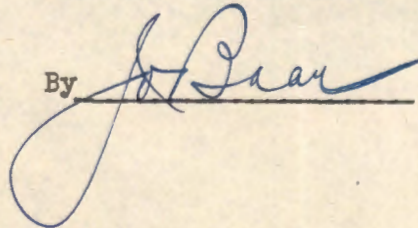

JOB FC

app

9 2 5 2

December 12th, 1923.

Portland Golf Club,
Portland, Oregon.

Gentlemen:- Attention Messrs. Baar & Cunningham.

Herewith you will find Application No. 9252, being Permit No. 6089, together with blue print. This application has been approved and recorded in this office.

* Permit No.

APPLICATION FOR A PERMIT

To appropriate the Public Waters of the State of Oregon

I, ^{Dalp} PORTLAND COUNTRY CLUB,

(Name of applicant)

of Portland (Postoffice), County of Multnomah

State of Oregon, do hereby make application for a permit to appropriate the following described public waters of the State of Oregon, subject to existing rights:

If the applicant is a corporation, give date and place of incorporation

1. The source of the proposed appropriation is Fanno Creek (Name of stream)

tributary of Tualatin River

2. The amount of water which the applicant intends to apply to beneficial use is 5 cubic feet per second.

3. The use to which the water is to be applied is domestic and irrigation purposes (Irrigation, power, mining, manufacturing,

domestic supplies, etc.)

4. The point of diversion is located (Give distance and bearing to section corner)

being within the (Give smallest legal subdivision) of Sec. 24, Tp. 1 South, (No. N. or S.)

R. 1 West, W. M., in the county of (No. E. or W.)

5. The (Main ditch, canal or pipe line) to be

miles in length, terminating in the (Smallest legal subdivision) of Sec. Tp. (No. N. or S.)

R. W. M., the proposed location being shown throughout on the accompanying map. (No. E. or W.)

6. The name of the ditch, canal or other works is

DESCRIPTION OF WORKS

DIVERSION WORKS—

7. (a) Height of dam feet, length on top feet, length at bottom

feet; material to be used and character of construction (Loose rock, concrete, masonry, rock and brush, timber crib, etc., wasteway over or around dam)

(b) Description of headgate (Timber, concrete, etc., number and size of openings)

* A different form of application is provided where storage works are contemplated. These forms can be secured without charge, together with instructions, by addressing the State Engineer, Salem, Oregon.

CANAL SYSTEM—

8. (a) Give dimensions at each point of canal where materially changed in size, stating miles from headgate. At headgate: Width on top (at water line)feet; width on bottomfeet; depth of waterfeet; gradefeet fall per one thousand feet.

(b) At miles from headgate: Width on top (at water line)feet; width on bottomfeet; depth of waterfeet; gradefeet fall per one thousand feet.

FILL IN THE FOLLOWING INFORMATION WHERE THE WATER IS USED FOR IRRIGATION—

9. The land to be irrigated has a total area ofacres, located in each smallest legal subdivision, as follows:
(Give area of land in each smallest legal subdivision which you intend to irrigate)

(If more space required, attach separate sheet)

POWER, MINING, MANUFACTURING, OR TRANSPORTATION PURPOSES—

10. (a) Total amount of power to be developed theoretical horsepower.

(b) Total fall to be utilizedfeet.
(Head)

(c) The nature of the works by means of which the power is to be developed

(d) Such works to be located in of Sec.
(Legal subdivision)

Tp., R., W. M.
(No. N. or S.) (No. E. or W.)

(e) Is water to be returned to any stream?
(Yes or No)

(f) If so, name stream and locate point of return
....., Sec., Tp., R., W. M.
(No. N. or S.) (No. E. or W.)

(g) The use to which power is to be applied is

(h) The nature of the mines to be served

MUNICIPAL SUPPLY—

11. To supply the city of _____
_____ County, having a present population of _____,
(Name of)
and an estimated population of _____ in 192_____

(Answer questions 12, 13, 14, and 15 in all cases)

- 12. Estimated cost of proposed works, \$ _____
- 13. Construction work will begin on or before _____
- 14. Construction work will be completed on or before _____
- 15. The water will be completely applied to the proposed use on or before _____

Duplicate maps of the proposed ditch or other works, prepared in accordance with the rules of the State Water Board, accompany this application.

(Name of applicant)

Signed in the presence of us as witnesses:

(1) _____, _____
(Name) (Address of witness)

(2) _____, _____
(Name) (Address of witness)

Remarks: _____

STATE OF OREGON, }
County of Marion, } ss.

This is to certify that I have examined the foregoing application, together with the accompanying maps and data, and return the same for correction or completion, as follows: _____

In order to retain its priority, this application must be returned to the State Engineer, with corrections, on or before _____, 192_____

WITNESS my hand this _____ day of _____, 192_____

STATE ENGINEER.

STATE OF OREGON, }
County of Marion, } ss.

This is to certify that I have examined the foregoing application and do hereby grant the same, subject to the following limitations and conditions: If for irrigation, this appropriation shall be limited to one-eightieth of one cubic foot per second, or its equivalent, for each acre irrigated, and shall be subject to such reasonable rotation system as may be ordered by the proper State officer

The amount of water appropriated shall be limited to the amount which can be applied to beneficial use and not to exceed _____ cubic feet per second, or its equivalent in case of rotation. The priority date of this permit is _____

Actual construction work shall begin on or before _____ and shall thereafter be prosecuted with reasonable diligence and be completed on or before _____

Complete application of the water to the proposed use shall be made on or before _____

WITNESS my hand this _____ day of _____, 192_____

STATE ENGINEER.

Permits for power development are subject to the limitation of franchise as provided in Section 5728, Oregon Laws, and the payment of annual fees as provided in Section 5803, Oregon Laws.

2

Application No. 9 2 5 2
Permit No.

PERMIT
TO APPROPRIATE THE PUBLIC
WATERS OF THE STATE
OF OREGON

Division No. District No.

This instrument was first received in the office of the State Engineer at Salem, Oregon, on the 13 day of November, 192 3, at 8:30 o'clock A. M.

Returned to applicant for correction:

Corrected application received:

Approved:

Recorded in Book No. _____ of _____

Permit, on Page _____

STATE ENGINEER

[Handwritten signature]