



Oregon Water Resources Department
 725 Summer Street NE, Suite A
 Salem, Oregon 97301
 (503) 986-0900
 www.oregon.gov/OWRD

E-RECEIVED
 8/3/2024
 OWRD

Ownership Update for Certificated Rights Only

NO FEES ARE REQUIRED TO SUBMIT THIS FORM

NOTICE: A certificate of water right typically stays with the land. In order to track water right ownership, the Department requests that this form be submitted to the Department. **To update multiple rights, a separate form is required for each right.** If you have any questions about this form, please contact your local watermaster, or call the Water Resources Department at (503) 986-0900.

This form is **not** for Applications, Permits, Transfers, Groundwater Registrations, or Limited Licenses. To notify the Department of changes in ownership to these types of authorizations, an Assignment is required.

Current Landowner Information					
Name:	James & Joanne Isaac				
Mailing Address:	410 Park Dr				
City:	Shady Cove	State:	OR	Zip:	97539
Phone:	541-531-5284	Email:	Kfall5001@gmail.com		

Property Information					
County:	Jackson	Township:	345	Range:	1W
		Section:	16		
Tax Lot #:	1100				
Street Address of Water Right:	410 Park Dr Shady Cove OR 97539				

Water Right Information	
Application:	Joanne Isaac
Permit:	35668
Certificate:	43152
Are all the lands associated with this water right owned by the requestor? <input type="checkbox"/> Yes <input checked="" type="checkbox"/> No ^{WR} (If no, include a map showing the portion of the water right involved) see map	

Signature and Date	
Name of individual completing form:	Joanne Isaac
Signature of requestor:	Joanne Isaac Date: 8/4/2024
Phone or email:	541-531-5284

The Department does not change names on water right certificates. This form will be placed in the file for future reference only. If mailed, the Department will not provide acknowledgement of receipt.

This form can be mailed to the address above or sent via email to wrd_dl_customerservice@oregon.gov

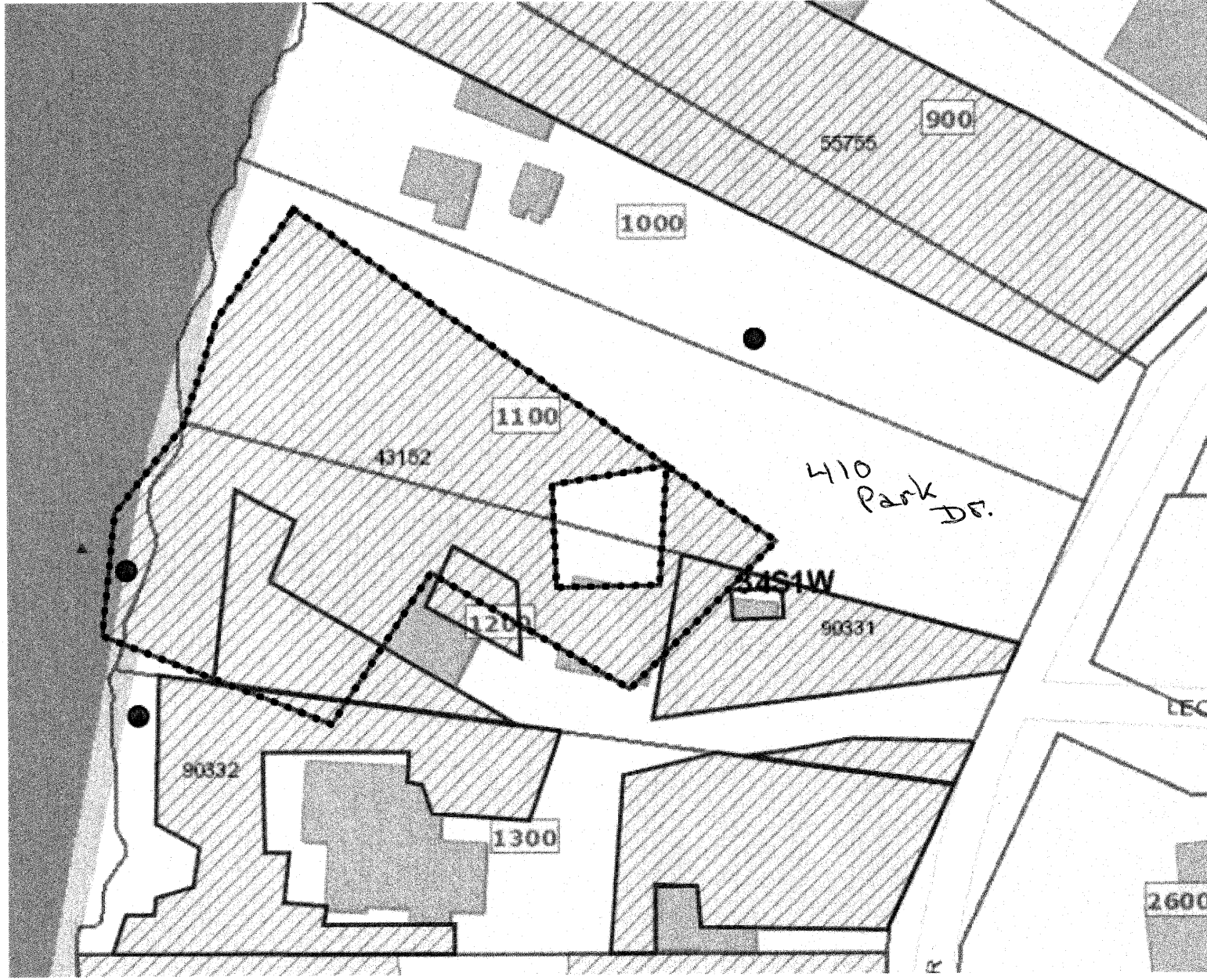

900

55755

1000

1100

43152

410 Park Dr.

57S1W

1200

90331

90332

1300

2600