

35
6

Name NESIKA BEACH WATER DISTRICT

By ~~Box 114 A. Rt. 1~~ Gold Beach, Oregon 97444

Address 32892 Nesika Rd.

Gold Beach, Or. 97444

Date filed January 23, 1967

Priority April 18, 1967

Action suspended until OK Cert

Returned to applicant

Date of approval October 19, 1967

CONSTRUCTION

Date for beginning October 19, 1968

Date for completion October 1, 1969

Extended to

Date for application of water October 1, 1970

Extended to

PROSECUTION OF WORK

Form "A" filed Started

Form "B" filed Nov 17, 1967

Form "C" filed Nov. 17, 1967

FINAL PROOF

Blank mailed MAR 26 1971

Proof received

Date certificate issued JUN 14 1971

Application No. G G 3788

Permit No. G G 3571

Certificate No. 37549

Stream Index, Page No. 15-99

36/14w-9R

FEEES PAID

Date	Amount	Receipt No.
<u>1/23/67</u>	<u>22.00</u>	<u>2358</u>
<u>4-1-71</u>	<u>\$1 Cert. Fee</u>	<u>23116</u>

FEEES REFUNDED

Date	Amount	Check No.
------	--------	-----------

ASSIGNMENTS

Date	To Whom	Address	Volume	Page
------	---------	---------	--------	------

REMARKS

1.11 cfs from a well (Rogue River) for domestic use

W.R.I.S.

Assembled _____ by _____

Entered _____ by _____

Verified _____ by _____

365 14w - Dig. only.
365 14w -

Scale OKed TJ 2-16-67

SM-8-64

Form C

IMPORTANT—This form is a notice to the State Engineer that permittee is ready to make **final proof** to the extent to which the water has actually been applied to the intended use under the terms of the permit. Permittee is cautioned that Certificate of Water Right will be issued based on the extent of the quantity and use as determined by the **final proof** inspection and survey which will be made in response to the filing of this Form C.

NOTE: In the case of an irrigation permit, this Form C should not be mailed to the State Engineer until all of the land described in the permit, which it is intended to irrigate under this permit at any time, has actually been irrigated. Fill out, detach and mail to the State Engineer, Salem, Oregon 97310, when all of the water has been applied.

Application No. G 3788

NOTICE OF COMPLETE APPLICATION OF WATER TO A BENEFICIAL USE

I, Nesika Beach Water District, the holder of Permit No. G 3571 to appropriate the public waters of the state of Oregon, completely applied the waters to a beneficial use in accordance with the terms of said permit, on the 1st day of July, 1967.

Remarks: _____

IN WITNESS WHEREOF, I have hereunto set my hand this 15 day of November, 1967.

Raymond H. Stevens (Signature of Applicant) Char (Address) P.O. Box 114A Gold Beach Ore 97444

Form B

Application No. G 3788

NOTICE OF COMPLETION OF CONSTRUCTION

I, Nesika Beach Water District, the holder of Permit No. G 3571 to appropriate the public waters of the state of Oregon, completed the construction of the works described therein on the 22d day of September, 1967.

Remarks: _____
If the works have less capacity than described in the permit, or you have definitely abandoned part of the proposed development, you

should so state in order that our records may not be unnecessarily encumbered.

IN WITNESS WHEREOF, I have hereunto set my hand this 15th day of November, 1967.

RECEIVED NOV 17 1967 STATE ENGINEER SALEM OREGON

Form C

IMPORTANT—This form is a notice to the State Engineer that permittee is ready to in which the water has actually been applied to the intended use under the terms of the permit Certificate of Water Right will be issued based on the extent of the quantity and use as determined and survey which will be made in response to the filing of this Form C.

NOTE: In the case of an irrigation permit, this Form C should not be mailed to the State Engineer in the permit, which it is intended to irrigate under this permit at any time, but fill out, detach and mail to the State Engineer, Salem, Oregon 97310, when all of the water has been applied.

NOTICE OF COMPLETE APPLICATION OF WATER TO A BENEFICIAL USE

I, Nesika Beach Water District, the holder of

to appropriate the public waters of the state of Oregon, completely applied the water in accordance with the terms of said permit, on the 1st day of July

Remarks: _____

RECEIVED
NOV 17 1967
STATE ENGINEER
SALMON OREGON

IN WITNESS WHEREOF, I have hereunto set my hand this 15 day of _____

(Signature of Applicant) Raymond H. Stevens P.O. Box 1144
(Address) Clatsop

NOTICE OF COMPLETION OF CONSTRUCTION

Nesika Beach Water District, the holder of

the public waters of the state of Oregon, completed the construction on the 22d day of September, 19 67.

Remarks: _____

If the works have less capacity than described in the permit, or you have definitely abandoned part of the works, _____
In order that our records may not be unnecessarily encumbered.

WITNESS WHEREOF, I have hereunto set my hand this 15th day of _____

(Signature of Applicant) Raymond H. Stevens P.O. Box 1144
(Address) Clatsop

Fill out, detach and mail to the State Engineer, Salem, Oregon 97310, when construction work is completed.

Well will induce infiltration from Rogue River. WSB 2/15/67

Form C

IMPORTANT—This form is a notice to the State Engineer that permittee is ready to make **final proof** to the extent to which the water has actually been applied to the intended use under the terms of the permit. Permittee is cautioned that Certificate of Water Right will be issued based on the extent of the quantity and use as determined by the **final proof** inspection and survey which will be made in response to the filing of this Form C.

NOTE: In the case of an irrigation permit, this Form C should not be mailed to the State Engineer until all of the land described in the permit, which it is intended to irrigate under this permit at any time, has actually been irrigated. **Fill out, detach and mail to the State Engineer, Salem, Oregon 97310, when all of the water has been applied.**

Application No. G 3788

NOTICE OF COMPLETE APPLICATION OF WATER TO A BENEFICIAL USE

I, Nesika Beach Water District, the holder of Permit No. G 3571

to appropriate the public waters of the state of Oregon, completely applied the waters to a beneficial use in accordance with the terms of said permit, on the 1st day of July, 19 67.

Remarks: _____

IN WITNESS WHEREOF, I have hereunto set my hand this 15 day of November, 19 67.

Raymond H. Stevens (Signature of Applicant) (char) P.O. Box 114A Gold Beach Ore 97444 (Address)

Form B

Application No. G 3788

NOTICE OF COMPLETION OF CONSTRUCTION

Nesika Beach Water District, the holder of Permit No. G 3571

to appropriate the public waters of the state of Oregon, completed the construction of the works described therein on the 22d day of September, 19 67.

Remarks: _____

If the works have less capacity than described in the permit, or you have definitely abandoned part of the proposed development, you should so state in order that our records may not be unnecessarily encumbered.

IN WITNESS WHEREOF, I have hereunto set my hand this 15th day of November, 19 67.

Raymond H. Stevens (Signature of Applicant) (char) P.O. Box 114A Gold Beach, Ore 97444 (Address)

Fill out, detach and mail to the State Engineer, Salem, Oregon 97310, when construction work is completed.

RECEIVED
NOV 17 1967
STATE ENGINEER
SALEM OREGON

NESIKA BEACH WATER DISTRICT MUNICIPAL WATER SYSTEM

Township	Range	Section	Forty-acre Tract	Township	Range	Section	Forty-acre Tract
36s	14w	10	SW ¹ / ₄ of SW ¹ / ₄	36s	14w	6	NE ¹ / ₄ of S ¹ / ₄
36s	14w	9	S ¹ / ₂ of SE & S ¹ / ₂ of SW ¹ / ₄	36s	14w	6	SW ¹ / ₄ of S ¹ / ₄
36s	14w	16	N ¹ / ₂ of NW ¹ / ₄	36s	15w	1	NE ¹ / ₄ of S ¹ / ₄
36s	14w	8	SE ¹ / ₄ of SE ¹ / ₄	35s	15w	36	SE ¹ / ₄ of S ¹ / ₄
36s. II	14w	8	SW ¹ / ₄ of SE ¹ / ₄	35s	15w	36	NE ¹ / ₄ of S ¹ / ₄
36s	14w	8	NE ¹ / ₄ of SW ¹ / ₄	35s	14w	31	Entire Section
36s	14w	8	SE ¹ / ₄ of NW ¹ / ₄	35s	14w	30	SW ¹ / ₄ of S ¹ / ₄
36s	14w	8	NW ¹ / ₄ of NW ¹ / ₄	35s	14w	30	SE ¹ / ₄ of S ¹ / ₄
36s	14w	6	SE ¹ / ₄ of SE ¹ / ₄	36s	14w	17	W ¹ / ₂ of S ¹ / ₄
36s	14w	6	NW ¹ / ₄ of SE ¹ / ₄	35s	14w	30	SW ¹ / ₄ of S ¹ / ₄
36s	14w	6	SE ¹ / ₄ of NW ¹ / ₄	36s	14w	17	NE ¹ / ₄ of S ¹ / ₄
36s	14w	6	NW ¹ / ₄ of NW ¹ / ₄	36s	14w	8	SW ¹ / ₄ of S ¹ / ₄

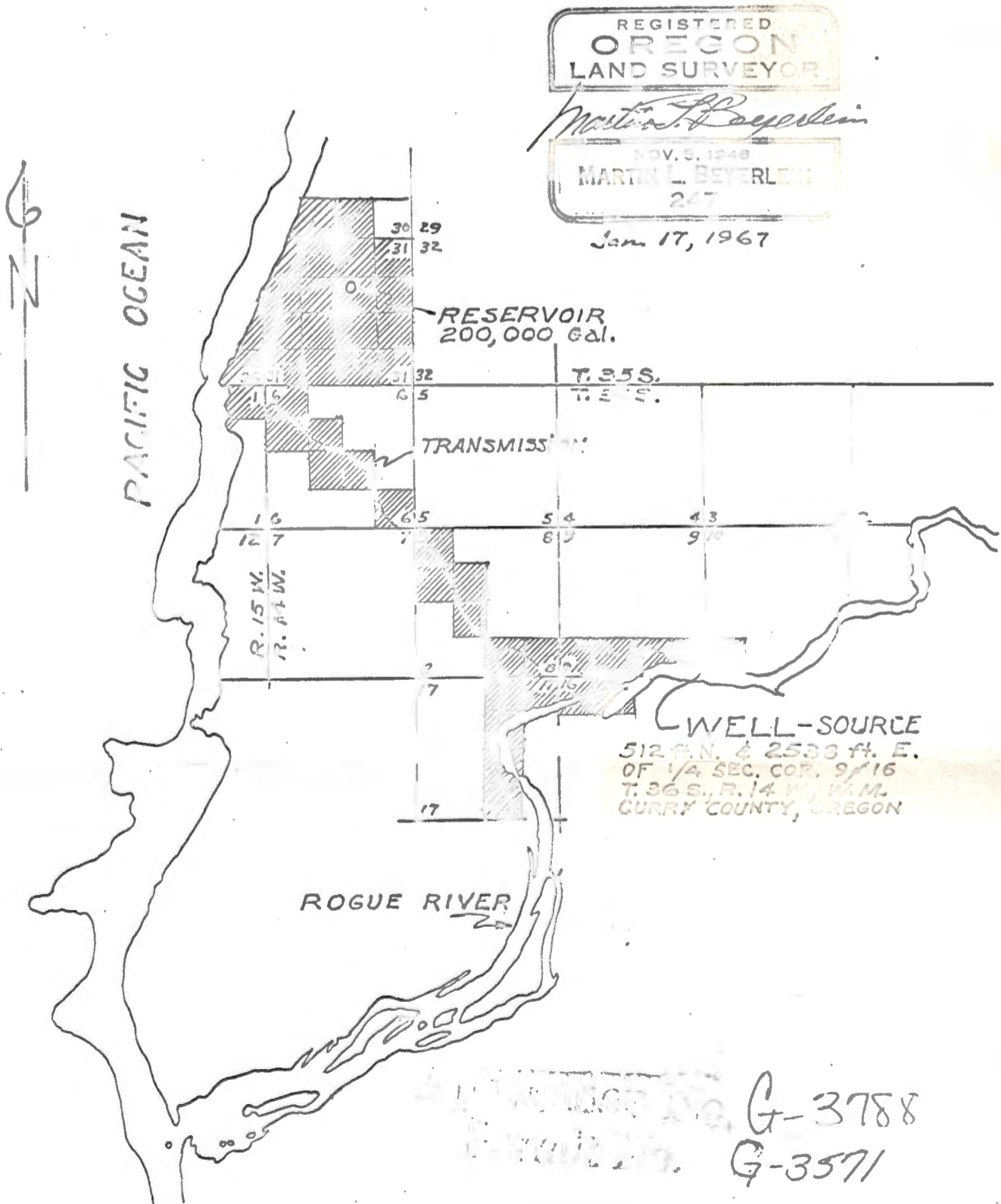

G-3788
G-3571



STATE OF OREGON

INTEROFFICE MEMO

RECEIVED

APR 20 1995

TO: Howard J. Newhouse
CWRE

DATE: 04-18-95 WATER RESOURCES DEPT.
SALEM, OREGON

FROM: John P. Drolet
WM, Dist XIX

file # G-3788
prmt # G-3571

SUBJECT: Nesika Beach Water District Water Right and Application

Howard, sorry that it has taken so long to get back to you regarding Nesika Beach.

To begin, the District's water right as evidenced by the 1967 certificate # 37549 is for "Group domestic use ..." and does not allow the District to use water for other uses such as commercial or industrial uses.

Because of this deficiency on the original right, the new application should be designed to include commercial use, industrial use, fire protection, irrigation and other water uses in park and recreation facilities, and street washing for that area covered by the original 1967 right.

Depending on the laws under which the District was formed (see the definition of "Municipal Corporation", attached), the new application should list the use for the area not covered by the 1967 right as municipal or quasi municipal (again, see definitions, attached).

Also attached are two of my letters to the District which go over some of the same details.

Get in touch if you have questions.

JPD/dt

atch:Div 11 definitions
correspondence

CF: AJC
Dwight French (for files)

P.S. your Application MAP looks OK



RECEIVED

DEC 15 1994

WATER RESOURCES DEPT.
SALEM, OREGON

COOS COUNTY
WATER RESOURCES DEPARTMENT

COOS COUNTY COURTHOUSE / COQUILLE, OREGON 97423 / (503) 396-3121 EXT. 254

HEARING & SPEECH IMPAIRED / 1-800-735-2900

12-12-94

Bryan Flavin
P.O. Box 360
Wedderburn, Ore. 97491

file # G-3788
prmt # G-3571

Dear Mr. Flavin,

Following our meeting 12-07-94, I met with John Drolet District Watermaster and explained your inquiry as to what should be done towards bringing Nesika Beach Water District up to legal standards. John reflected back to his contact with Mr. Leon Lynch, Manager Nesika Beach Water District regarding this same situation.

John has asked me to forward the enclosed copies of those correspondence pertaining to this situation in the hopes of answering any questions you may have.

If you have any questions please feel free to call.

Sincerely,

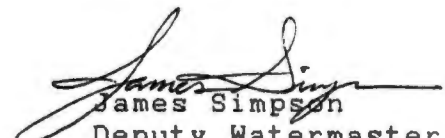
James Simpson
Deputy Watermaster
District XIX

JAS/sn

Enc: 10-24-94 Ltr.
11-01-94 Ltr.
11-02-94 Ltr.

CF: John Drolet, Watermaster Dist. XIX
Dwight French (for files)
Leon Lynch
File # 2-7-9.0

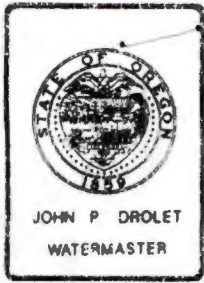

Water Resources Department

COOS COUNTY ANNEX, 290 NORTH CENTRAL ST., COQUILLE, OREGON 97423 PHONE 396-3121 EXT. 254

RECEIVED

NOV - 7 1994

WATER RESOURCES DEPT.
SALEM, OREGON

11-02-94

file # G-3788, prmt # G-3571

Leon Lynch, Manager
Nesika Beach Water District
32892 Nesika Road
Gold Beach, OR 97444

Dear Leon:

This office is today in receipt of your 11-01-94 letter regarding the desirability of applying for a new water use permit to cover both the area and the quantity of water not covered by your 1967 water right.

Enclosed is a groundwater application form and an instruction booklet that will assist you in the completion of the application form. Application fees are listed in the instruction booklet.

For application map purposes, you might consider a modification of the District's water right map, also enclosed. Modifications would take the form of:

1. cross-hatching the present and anticipated service areas not shown on the 1967 water right map,
2. identifying on the map, as is done on the 1967 map, the specific townships, ranges, and sections, for the expanded service area.

If the Department determines that a permit for your expanded use may be issued, then at that time the Department will request that the District submit a map prepared by a certified water rights examiner (CWRE list enclosed).

As mentioned in my 10-24-94 letter to you, the statutes under which the District was incorporated will dictate the appropriate water use that the District should apply for.

Again, I would encourage the District to apply for the new permit as quickly as possible. Get in touch if you have questions.

Sincerely,

John P. Drolet
Watermaster, District XIX

JPD/dt

ENCL:GW ap form & inst.
modifies map
CWRE list

CF: AJC w/o atch
Dwight French (for files)

NESIKA BEACH WATER DISTRICT

32892 NESIKA ROAD
GOLD BEACH, OREGON 97444

Nov. 1, 1994

John Drolet
Watermaster, District XIX

Dear John:

Enclosed is an updated map of the area served by the Nesika Beach Water District.

The original water right was issued for .20 cubic feet per second for the purpose of serving 112 families. The District has expanded to serve the Indian Hills subdivision, the Hubbard Mound subdivision, and the entire Ophir area.

The total number of services, active and inactive, on the system at this time is 643.

At this time we are at the limits of our water right. Therefore, I would like to apply for another water right or a water permit to cover our usage.

Sincerely,

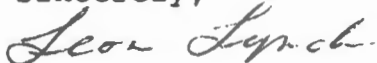

Leon Lynch, Manager
Nesika Beach Water District

4w
4w
4w
4w
4w
4w
4w
4w
4w
4w
4w
4w

10
9
16
8
8
8
8
8
6
6
6
6

SW $\frac{1}{4}$ of SW $\frac{1}{4}$
SE $\frac{1}{4}$ of SE $\frac{1}{4}$ & ~~SW $\frac{1}{4}$ of SW $\frac{1}{4}$~~
NE $\frac{1}{4}$ of NW $\frac{1}{4}$
SE $\frac{1}{4}$ of SE $\frac{1}{4}$
SW $\frac{1}{4}$ of SE $\frac{1}{4}$
NE $\frac{1}{4}$ of SW $\frac{1}{4}$
SE $\frac{1}{4}$ of NW $\frac{1}{4}$
NW $\frac{1}{4}$ of NW $\frac{1}{4}$
SE $\frac{1}{4}$ of SE $\frac{1}{4}$
NW $\frac{1}{4}$ of SE $\frac{1}{4}$
SE $\frac{1}{4}$ of NW $\frac{1}{4}$
NW $\frac{1}{4}$ of NW $\frac{1}{4}$

36s
36s
36s
35s
35s
35s
35s
35s
35s
35s
35s
35s

14w
14w
15w
15w
15w
14w
14w
14w
14w
14w
14w
14w

6
6
1
36
36
31
30
30
17
30
17
8

NE $\frac{1}{4}$ of SW $\frac{1}{4}$
SW $\frac{1}{4}$ of NW $\frac{1}{4}$
NE $\frac{1}{4}$ of NE $\frac{1}{4}$
SE $\frac{1}{4}$ of SE $\frac{1}{4}$
NE $\frac{1}{4}$ of SE $\frac{1}{4}$
Entire Section
SW $\frac{1}{4}$ of SW $\frac{1}{4}$
SE $\frac{1}{4}$ of SW $\frac{1}{4}$
W $\frac{1}{2}$ of E $\frac{1}{2}$
SW $\frac{1}{4}$ of SE $\frac{1}{4}$
NE $\frac{1}{4}$ of NE $\frac{1}{4}$
SW $\frac{1}{4}$ of NW $\frac{1}{4}$

PACIFIC OCEAN

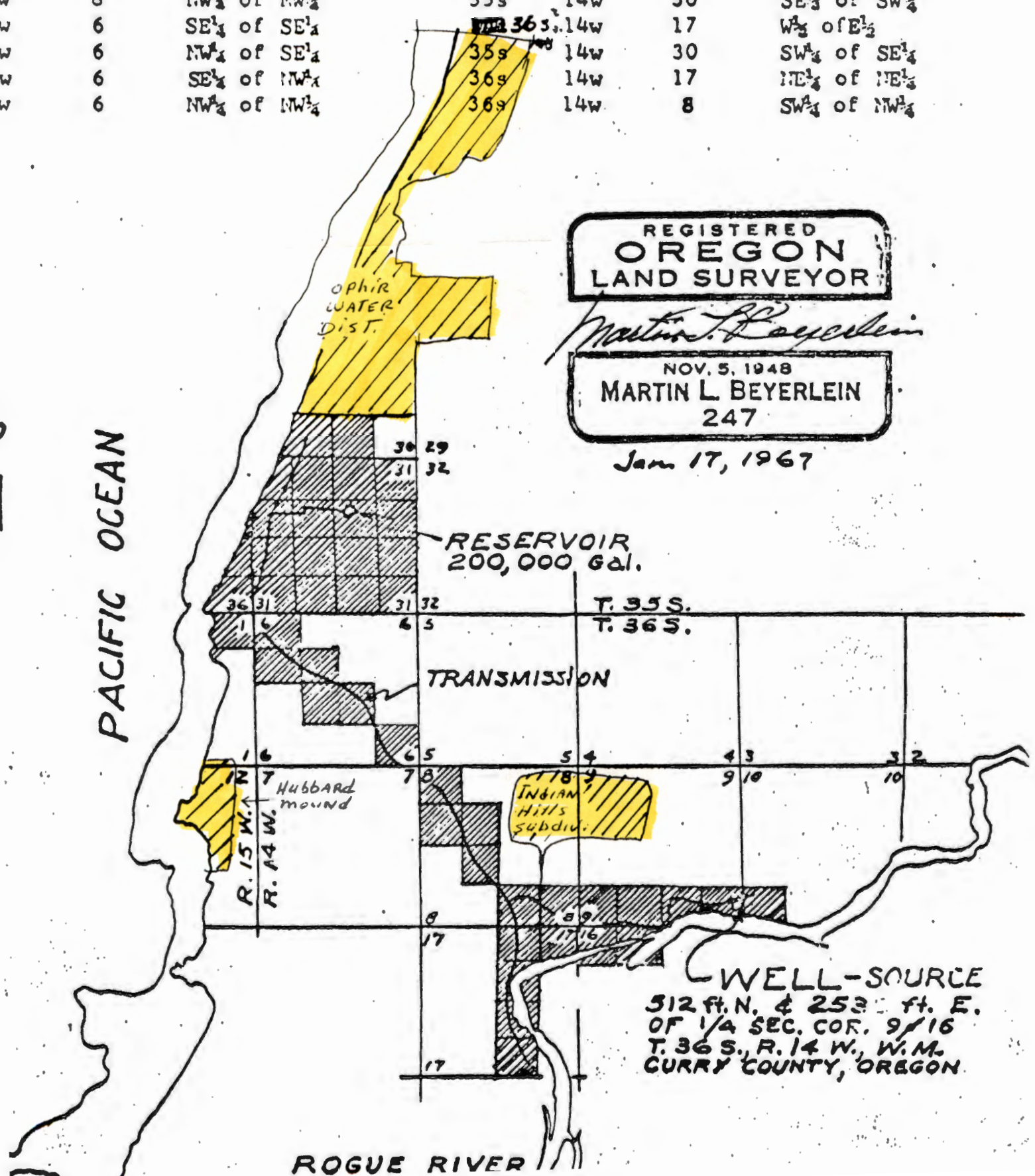

REGISTERED
OREGON
LAND SURVEYOR

Martin L. Beyerlein

NOV. 5, 1948
MARTIN L. BEYERLEIN
247

Jan 17, 1967

ROGUE RIVER

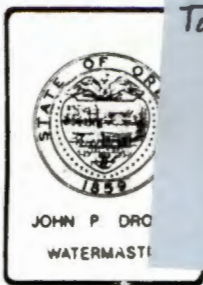

To: Dwight French

ces Department

RECEIVED

OCT 26 1994

WATER RESOURCES DEPT
SALEM, OREGON

X, 290 NORTH CENTRAL ST., COQUILLE, OREGON 97423 PHONE 396-3121
EXT. 254

10-24-94

Nesika Beach Water District
32892 Nesika Rd.
Gold Beach, OR 97444

file # G-3788, prmt # G-3571

Gentlemen:

In 1967, your district ap
was subsequently certified as
particulars of that water right

source: a well
allowed use: group
amount of water: .20 c

I am concerned that your
protect all of your current:

1. uses
2. places of use, or
3. quantity of water us

Please file
G-3788

hat
ws:

The opportunity exists for your district to apply for
another water use permit that would cover those deficiencies that
may exist in your 1967 water right.

As regards your 1967 water right, the allowed water use
limits that right to "group domestic use" for 112 families. As
you can see from a copy of Chapter 690, Division 11
administrative rules, "group domestic use" is limited to domestic
water use within residences and dwellings. Commercial water use,
for example, is not acknowledged as an allowable use under the
terms of a group domestic right.

If the District is serving an area outside of the area shown
on your attached water right "final proof survey map", the Water
Resources Department should be advised of the expanded service
area.

Depending on the statutes under which your district was
incorporated, subsequent water use permit applications by your
district may be filed as either municipal water use or quasi-
municipal water use. Such a classification, in addition to
domestic uses would allow: commercial and industrial water use
and fire protection among other uses.

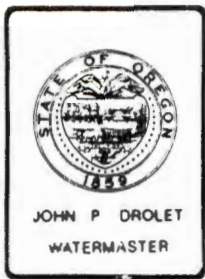

Water Resources Department

COOS COUNTY ANNEX, 290 NORTH CENTRAL ST., COQUILLE, OREGON 97423 PHONE 396-3121
EXT. 254

RECEIVED

OCT 20 1994

WATER RESOURCES DEPT.
SALEM, OREGON

10-24-94

Nesika Beach Water District
32892 Nesika Rd.
Gold Beach, OR 97444

file # G-3788, prmt # G-3571

Gentlemen:

In 1967, your district applied for a water use permit that was subsequently certified as a water right. Some of the particulars of that water right (copy attached) are as follows:

source:	a well near Rogue River
allowed use:	group domestic use for 112 families
amount of water:	.20 c.f.s.

I am concerned that your water right may not adequately protect all of your current:

1. uses
2. places of use, or
3. quantity of water used.

The opportunity exists for your district to apply for another water use permit that would cover those deficiencies that may exist in your 1967 water right.

As regards your 1967 water right, the allowed water use limits that right to "group domestic use" for 112 families. As you can see from a copy of Chapter 690, Division 11 administrative rules, "group domestic use" is limited to domestic water use within residences and dwellings. Commercial water use, for example, is not acknowledged as an allowable use under the terms of a group domestic right.

If the District is serving an area outside of the area shown on your attached water right "final proof survey map", the Water Resources Department should be advised of the expanded service area.

Depending on the statutes under which your district was incorporated, subsequent water use permit applications by your district may be filed as either municipal water use or quasi-municipal water use. Such a classification, in addition to domestic uses would allow: commercial and industrial water use and fire protection among other uses.

Nesika Beach Water District
10-24-94

page 2

A window of opportunity currently exists for you to address the above deficiencies. I would welcome the opportunity to discuss the above with an authorized district representative or to speak before your board. Please get in touch at your earliest convenience but no later than 30 days from the receipt of this letter.

Sincerely,



John P. Drolet
Watermaster, District XIX

JPD/dt

CF: Chuck Nordstrum
AJC
Dwight French (for files)
Bill Ferber

STATE OF OREGON

COUNTY OF CURRY

CERTIFICATE OF WATER RIGHT

This Is to Certify, That NESIKA BEACH WATER DISTRICT

of Route 1, Box 114 A, Gold Beach, State of Oregon, has made proof to the satisfaction of the STATE ENGINEER of Oregon, of a right to the use of the waters of a well

a tributary of Rogue River for the purpose of Group domestic use of 112 families under Permit No. G-3571 of the State Engineer, and that said right to the use of said waters has been perfected in accordance with the laws of Oregon; that the priority of the right hereby confirmed dates from April 18, 1967

that the amount of water to which such right is entitled and hereby confirmed, for the purposes aforesaid, is limited to an amount actually beneficially used for said purposes, and shall not exceed 0.20 cubic foot per second

or its equivalent in case of rotation, measured at the point of diversion from the stream. The point of diversion is located in the SE1/4 SE1/4, Section 9, T. 36 S., R. 14 W., W. M. Well located: 512 feet North and 2538 feet East from SW Corner, Section 9.

The amount of water used for irrigation, together with the amount secured under any other right existing for the same lands, shall be limited to-----of one cubic foot per second per acre,

and shall conform to such reasonable rotation system as may be ordered by the proper state officer.

A description of the place of use under the right hereby confirmed, and to which such right is appurtenant, is as follows:

SE1/4 SW1/4
Section 30
SW1/4 NE1/4
NW1/4
N1/2 SW1/4
SW1/4 SW1/4
Section 31
T. 35 S., R. 14 W., W. M.

SE1/4 NE1/4
E1/2 SE1/4
Section 36
T. 35 S., R. 15 W., W. M.

SE1/4 SE1/4
Section 6
NW1/4 NW1/4
SE1/4 NW1/4
E1/2 SW1/4
S1/2 SE1/4
Section 8
T. 36 S., R. 14 W., W. M.

STATE OF OREGON

SW 1/4
SE 1/4

Section 9

NW 1/4

Section 16

MESKIA BEACH WATER DISTRICT

W 1/2 NW 1/4

Section 17

T. 36 S., R. 14 W., W. M.

has made proof

Oregon

of the waters of

for the purpose of

to the use of said waters

of the right hereby

for the purpose

shall not exceed

from the stream

W. M.

Section 9

under any other

second

and

This right shall be further limited to appropriation of water only to the extent that it does not impair or substantially interfere with existing surface water rights of others.

The right to the use of the water for the purposes aforesaid is restricted to the lands or place of use herein described.

WITNESS the signature of the State Engineer, affixed

this 14 day of June, 1971

CHRIS L. WHEELER

State Engineer

Permit No. G-3571

Application No. G-3788

County CURRY

Proof of Appropriation of Water

- 1. Name NESIKA BEACH WATER DISTRICT 2. Address Route 1, Box 114A, Gold Beach, Oregon
- 3. Source of supply a well
Tributary of Rogue River
- 4. Amount of water 0.20 cubic foot per second 5. Priority date April 18, 1967
- 6. Use Group domestic use of 112 families
- 7. Location of point of diversion SE¹/₄ SE¹/₄ Sec. 9, Twp. 36 S., Range 14 W., W.M.
(Legal Subdivision)
Well located: 512 feet North and 2538 feet East from S¹/₄ Corner, Section 9.
- 8. The description of land given below corresponds to that found in your permit covering land to be irrigated, or, if for other purposes, the place of use.

Township	Range	Section	Legal Subdivision	No. Acres Actually Irrigated
(SEE ATTACHED SHEET)				
This right shall be further limited to appropriation of water only to the extent that it does not impair or substantially interfere with existing surface water rights of others.				

I have read the above and foregoing proof of appropriation of water; I know the contents thereof, and that the facts therein stated are true.

IN WITNESS WHEREOF, I have hereunto set my hand this 29 day of March

1971

RECEIVED
 APR 1 1971
 STATE ENGINEER
 SALEM, OREGON

Nesika Beach Water District
Raymond H. Stevens
Chairman of Board
 4309

SE $\frac{1}{4}$ SW $\frac{1}{4}$
Section 30

SW $\frac{1}{4}$ NE $\frac{1}{4}$
NW $\frac{1}{4}$
N $\frac{1}{2}$ SW $\frac{1}{4}$
SW $\frac{1}{4}$ SW $\frac{1}{4}$

Section 31
T. 35 S., R. 14 W., W. M.

SE $\frac{1}{4}$ NE $\frac{1}{4}$
E $\frac{1}{2}$ SE $\frac{1}{4}$
Section 36
T. 35 S., R. 15 W., W. M.

SE $\frac{1}{4}$ SE $\frac{1}{4}$
Section 6

NW $\frac{1}{4}$ NW $\frac{1}{4}$
SE $\frac{1}{4}$ NW $\frac{1}{4}$
E $\frac{1}{2}$ SW $\frac{1}{4}$
S $\frac{1}{2}$ SE $\frac{1}{4}$
Section 8

S $\frac{1}{2}$ SW $\frac{1}{4}$
S $\frac{1}{2}$ SE $\frac{1}{4}$
Section 9

NE $\frac{1}{4}$ NW $\frac{1}{4}$
Section 16

W $\frac{1}{2}$ NE $\frac{1}{4}$
NW $\frac{1}{4}$ SE $\frac{1}{4}$
Section 17
T. 36 S., R. 14 W., W. M.

NESIKA BEACH WATER DISTRICT
MUNICIPAL WATER SYSTEM

RECEIVED
JAN 23 1967
STATE ENGINEER
SALEM OREGON

Township	Range	Section	Forty-acre Tract	Township	Range	Section	Forty-acre Tract
36s	14w	10	SW ¹ / ₄ of SW ¹ / ₄	36s	14w	6	NE ¹ / ₄ of SW ¹ / ₄
36s	14w	9	S ¹ / ₂ of SE & SW ¹ / ₄	36s	14w	6	SW ¹ / ₄ of NW ¹ / ₄
36s	14w	16	N ¹ / ₂ of NW ¹ / ₄	36s	15w	1	NE ¹ / ₄ of NE ¹ / ₄
36s	14w	8	SE ¹ / ₄ of SE ¹ / ₄	35s	15w	36	SE ¹ / ₄ of SE ¹ / ₄
36s	14w	8	SW ¹ / ₄ of SE ¹ / ₄	35s	15w	36	NE ¹ / ₄ of SE ¹ / ₄
36s	14w	8	NE ¹ / ₄ of SW ¹ / ₄	35s	14w	31	Entire Section
36s	14w	8	SE ¹ / ₄ of NW ¹ / ₄	35s	14w	30	SW ¹ / ₄ of SW ¹ / ₄
36s	14w	8	NW ¹ / ₄ of NW ¹ / ₄	35s	14w	30	SE ¹ / ₄ of SW ¹ / ₄
36s	14w	6	SE ¹ / ₄ of SE ¹ / ₄	35s	14w	17	W ¹ / ₂ of E ¹ / ₄
36s	14w	6	NW ¹ / ₄ of SE ¹ / ₄	35s	14w	30	SW ¹ / ₄ of SE ¹ / ₄
36s	14w	6	SE ¹ / ₄ of NW ¹ / ₄	36s	14w	17	NE ¹ / ₄ of NE ¹ / ₄
36s	14w	6	NW ¹ / ₄ of NW ¹ / ₄	36s	14w	8	SW ¹ / ₄ of NW ¹ / ₄

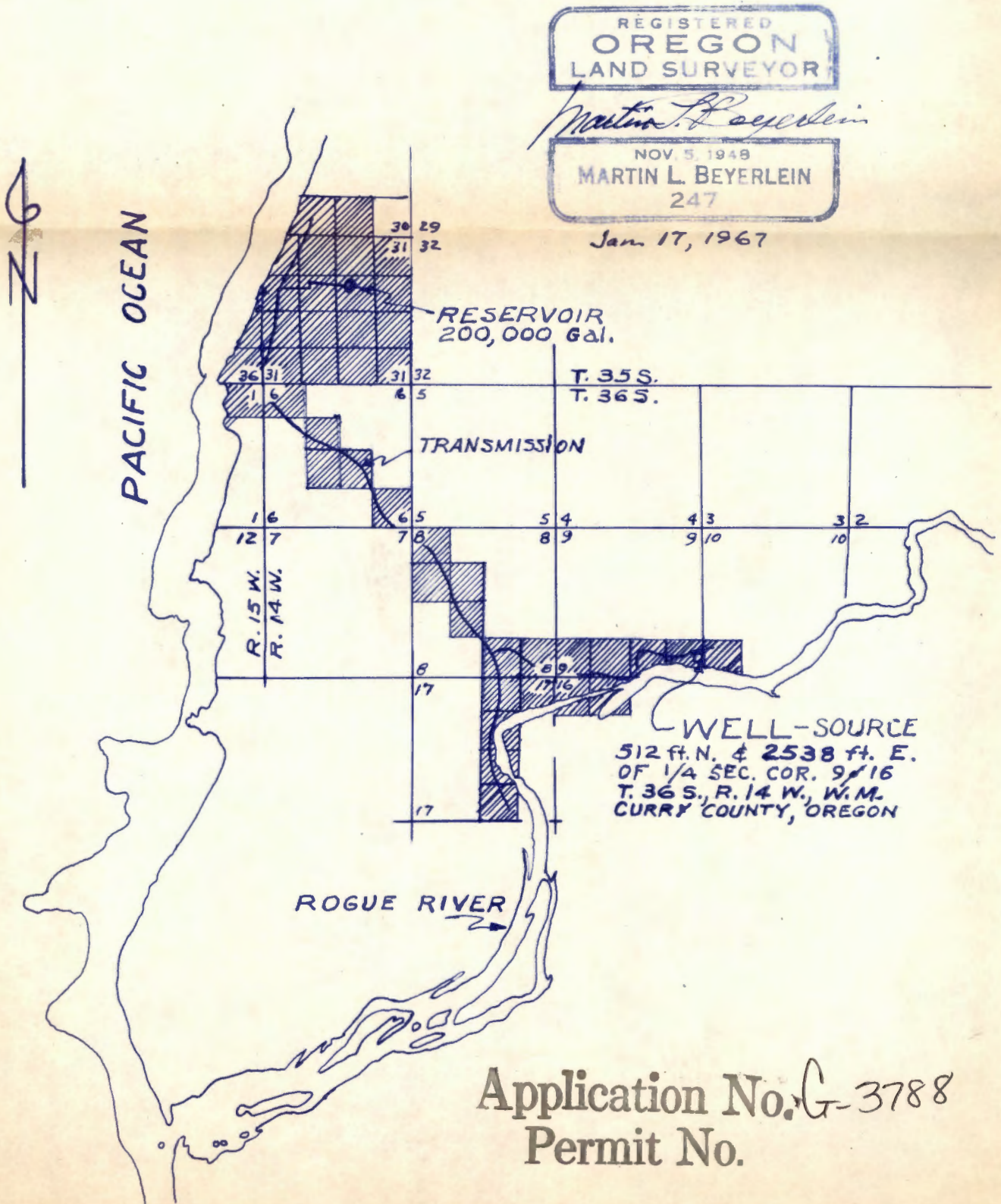

Application No. G-3788
Permit No.

RECEIVED
JAN 23 1967

STATE ENGINEER
SALEM OREGON

Permit No. G-.....

APPLICATION FOR A PERMIT

Duplicate

To appropriate the Ground Waters of the State of Oregon

I, Nesika Beach Water District (Name of applicant)

of Gold Beach (Postoffice Address), county of Curry,

state of Oregon, do hereby make application for a permit to appropriate the following described ground waters of the state of Oregon, SUBJECT TO EXISTING RIGHTS:

If the applicant is a corporation, give date and place of incorporation

Incorporated October 4, 1963 Curry County, Oregon

1. Give name of nearest stream to which the well, tunnel or other source of water development is situated Rogue River (Name of stream)

tributary of Pacific Ocean

2. The amount of water which the applicant intends to apply to beneficial use is 1.11 cubic feet per second or 500 gallons per minute.

3. The use to which the water is to be applied is domestic water supply

4. The well or other source is located 512 ft. North and 2538 ft. East from the S₁ sec. corner of Section 9, Township 36, South, Range 14, West, W. M. (Section or subdivision)

(If preferable, give distance and bearing to section corner)

(If there is more than one well, each must be described. Use separate sheet if necessary)

being within the SE₁ of SE₁ of Sec. 9, Twp. 36n, R. 14w,

W. M., in the county of Curry

5. The transmission pipe line (Canal or pipe line) to be 5.7 miles in length, terminating in the SW₁ of the NE₁ (Smallest legal subdivision) of Sec. 31, Twp. 35n,

R. 14w, W. M., the proposed location being shown throughout on the accompanying map.

6. The name of the well or other works is Nesika Beach Intake Well

DESCRIPTION OF WORKS

7. If the flow to be utilized is artesian, the works to be used for the control and conservation of the supply when not in use must be described.

Not artesian

8. The development will consist of one (Give number of wells, tunnels, etc.) having a diameter of 10 inches and an estimated depth of 43 feet. It is estimated that 21 feet of the well will require 10 cnp (Kind) casing. Depth to water table is estimated 1.0 (Feet)

CANAL SYSTEM OR PIPE LINE—

9. (a) Give dimensions at each point of canal where materially changed in size, stating miles from headgate. At headgate: width on top (at water line) feet; width on bottom feet; depth of water feet; grade feet fall per one thousand feet.

(b) At miles from headgate: width on top (at water line) feet; width on bottom feet; depth of water feet; grade feet fall per one thousand feet.

(c) Length of pipe, 30,000 ft.; size at intake, 6" in.; in size at 30,000 ft. from intake 6" in.; size at place of use 2"; 4"; 6"; in.; difference in elevation between intake and place of use, approx. 300' ft. Is grade uniform? No Estimated capacity, 1.11 sec. ft.

10. If pumps are to be used, give size and type One only 140 GPM submersible turbine type pump, pumping from intake arrangement to reservoir

Give horsepower and type of motor or engine to be used One only 20 HP submersible 220 V., 3 phase electric motor

11. If the location of the well, tunnel, or other development work is less than one-fourth mile from a natural stream or stream channel, give the distance to the nearest point on each of such channels and the difference in elevation between the stream bed and the ground surface at the source of development

Intake Structure located at north bank of Rogue River. Well screen 10 feet below stream bed.

12. Location of area to be irrigated, or place of use

Township N. or S.	Range E. or W. of Willamette Meridian	Section	Forty-acre Tract	Number Acres To Be Irrigated
36s	14w	10	SE _{1/4} of SW _{1/4}	Domestic use
36s	14w	9	SE _{1/4} of SE & SE _{1/4} sec.	Domestic use
36s	14w	16	NE _{1/4} of NE _{1/4} sec.	Domestic use
36s	14w	8	SE _{1/4} of SE _{1/4}	Domestic use
36s	14w	8	NE _{1/4} of SW _{1/4}	Domestic use
36s	14w	8	SE _{1/4} of NE _{1/4}	Domestic use
36s	14w	8	NE _{1/4} of NE _{1/4}	Domestic use
36s	14w	6	SE _{1/4} of SE _{1/4}	Domestic use
36s	14w	6	NE _{1/4} of SE _{1/4}	Domestic use
36s	14w	6	SE _{1/4} of NE _{1/4}	Domestic use
36s	14w	6	NE _{1/4} of NE _{1/4}	Domestic use
36s	14w	6	SE _{1/4} of NE _{1/4}	Domestic use
36s	14w	6	NE _{1/4} of SE _{1/4}	Domestic use
36s	15w	1	NE _{1/4} of NE _{1/4}	Domestic use
35s	15w	36	SE _{1/4} of SE _{1/4}	Domestic use
35s	15w	36	NE _{1/4} of SE _{1/4}	Domestic use
35s	14w	31	Entire section	Domestic use
35s	14w	30	SW _{1/4} of SW _{1/4}	Domestic use
35s	14w	30	SE _{1/4} of SE _{1/4}	Domestic Use
35s	14w	17	W _{1/2} of E _{1/2}	Domestic use
35s	14w	30	SW _{1/4} of SE _{1/4}	Domestic Use
36s	14w	17	NE _{1/4} of NE _{1/4}	Domestic use
36s	14w	8	SW _{1/4} of NW _{1/4}	Domestic use

(If more space required, attach separate sheet)

Character of soil

Kind of crops raised

MUNICIPAL SUPPLY—

13. To supply the city of Neiska Beach Water District
in Curry county, having a present population of 500
and an estimated population of 1000 in 1985

ANSWER QUESTIONS 14, 15, 16, 17 AND 18 IN ALL CASES

- 14. Estimated cost of proposed works, \$.....
- 15. Construction work will begin on or before January 1, 1967
- 16. Construction work will be completed on or before July 31, 1967
- 17. The water will be completely applied to the proposed use on or before June 1, 1967

18. If the ground water supply is supplemental to an existing water supply, identify any application for permit, permit, certificate or adjudicated right to appropriate water, made or held by the applicant.

Raymond H. Stevens
(Signature of applicant)

Remarks:

STATE OF OREGON, }
County of Marion, } ss.

This is to certify that I have examined the foregoing application, together with the accompanying maps and data, and return the same for

In order to retain its priority, this application must be returned to the State Engineer, with corrections on or before, 19.....

WITNESS my hand this day of, 19.....

STATE ENGINEER

By ASSISTANT

STATE OF OREGON, }
County of Marion, } ss.

PERMIT

This is to certify that I have examined the foregoing application and do hereby grant the same, SUBJECT TO EXISTING RIGHTS and the following limitations and conditions:

The right herein granted is limited to the amount of water which can be applied to beneficial use and shall not exceed cubic feet per second measured at the point of diversion from the well or source of appropriation, or its equivalent in case of rotation with other water users, from

The use to which this water is to be applied is

If for irrigation, this appropriation shall be limited to of one cubic foot per second or its equivalent for each acre irrigated and shall be further limited to a diversion of not to exceed acre feet per acre for each acre irrigated during the irrigation season of each year;

and shall be subject to such reasonable rotation system as may be ordered by the proper state officer.

The well shall be cased as necessary in accordance with good practice and if the flow is artesian the works shall include proper capping and control valve to prevent the waste of ground water.

The works constructed shall include an air line and pressure gauge or an access port for measuring line, adequate to determine water level elevation in the well at all times.

The permittee shall install and maintain a weir, meter, or other suitable measuring device, and shall keep a complete record of the amount of ground water withdrawn.

The priority date of this permit is

Actual construction work shall begin on or before and shall thereafter be prosecuted with reasonable diligence and be completed on or before October 1, 19.....

Complete application of the water to the proposed use shall be made on or before October 1, 19.....

WITNESS my hand this day of, 19.....

STATE ENGINEER

Application No. G-.....
Permit No. G-.....

PERMIT
TO APPROPRIATE THE GROUND
WATERS OF THE STATE
OF OREGON

This instrument was first received in the
office of the State Engineer at Salem, Oregon,
on the day of,
19....., at o'clock M.

Returned to applicant:
.....
.....

Approved:
.....
Recorded in book No. of
Ground Water Permits on page

STATE ENGINEER

Drainage Basin No. page

State Printing

Permit No. G-3571

Application No. G-3788

County CURRY

Proof of Appropriation of Water

1. Name NESIKA BEACH WATER DISTRICT 2. Address Route 1, Box 114A, Gold Beach, Oregon
3. Source of supply a well
Tributary of Rogue River
4. Amount of water 0.20 cubic foot per second 5. Priority date April 18, 1967
6. Use Group domestic use of 112 families
7. Location of point of diversion SE¹/₄ SE¹/₄ Sec. 9, Twp. 36 S., Range 14 W., W.M.
Well located: 512 feet North and 2558 feet East from SW Corner, Section 9.
8. The description of land given below corresponds to that found in your permit covering land to be irrigated, or, if for other purposes, the place of use.

Township	Range	Section	Legal Subdivision	No. Acres Actually Irrigated
Willamette Meridian				
			(SEE ATTACHED SHEET)	

This right shall be further limited to appropriation of water only to the extent that it does not impair or substantially interfere with existing surface water rights of others.

I have read the above and foregoing proof of appropriation of water; I know the contents thereof, and that the facts therein stated are true.

IN WITNESS WHEREOF, I have hereunto set my hand this day of

19.....

.....

SE $\frac{1}{4}$ SW $\frac{1}{4}$
Section 30

SW $\frac{1}{4}$ NE $\frac{1}{4}$
NW $\frac{1}{4}$
N $\frac{1}{2}$ SW $\frac{1}{4}$
SW $\frac{1}{4}$ SW $\frac{1}{4}$

Section 31

T. 35 S., R. 14 W., W. M.

SE $\frac{1}{4}$ NE $\frac{1}{4}$
E $\frac{1}{2}$ SE $\frac{1}{4}$

Section 36

T. 35 S., R. 15 W., W. M.

SE $\frac{1}{4}$ SE $\frac{1}{4}$
Section 6

NW $\frac{1}{4}$ NW $\frac{1}{4}$
SE $\frac{1}{4}$ NW $\frac{1}{4}$
E $\frac{1}{2}$ SW $\frac{1}{4}$
S $\frac{1}{2}$ SE $\frac{1}{4}$

Section 8

S $\frac{1}{2}$ SW $\frac{1}{4}$
S $\frac{1}{2}$ SE $\frac{1}{4}$

Section 9

NE $\frac{1}{4}$ NW $\frac{1}{4}$
Section 16

W $\frac{1}{2}$ NE $\frac{1}{4}$
NW $\frac{1}{4}$ SE $\frac{1}{4}$

Section 17

T. 36 S., R. 14 W., W. M.

**STATE
ENGINEER**

WATER RESOURCES DEPARTMENT

516 PUBLIC SERVICE BUILDING • SALEM, OREGON • 97310 • Ph 364-2171

March 26, 1971

FILE NO. G-3788

Nesika Beach Water District
Route 1, Box 114 A
Gold Beach, Oregon 97444

Gentlemen:

Enclosed is the final proof in connection with the incomplete water right represented by your permit No. G-3571.

The data contained in the proof, which is based on an inspection and survey of your project made by a representative of this department, defines the extent to which your water right has been completed within the terms of your permit. The proof should be dated and signed by you and returned to this office.

Upon receipt of the proof, properly executed and accompanied by the statutory recording fee of \$1, a certificate of water right will be issued confirming the right thereunder and, after being recorded in the county records, will be forwarded to you.

Very truly yours,

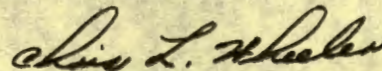

CHRIS L. WHEELER
State Engineer

Form 117

Enclosure

cjs



STATE OF OREGON
STATE ENGINEER
516 PUBLIC SERVICE BUILDING
SALEM 10

REFER TO FILE NO. G-3788

November 20, 1967

Nesika Beach Water District
Box 114 A. R. 1
Gold Beach, Oregon 97444

Gentlemen:

This will acknowledge receipt of your notice to the effect that complete application of water has been made under permit No. G-3571.

Pursuant to your report and in line with the general practice of this office, a survey will be made at a later date.

After this survey, proof may be made and certificate issued covering the actual use of water as found by the engineer. In case of irrigation, any lands described in the permit that have not been irrigated will be automatically eliminated from the water right.

In the meantime, the permit which you hold will be valid evidence of the water right in question so long as you continue to use the water.

Very truly yours,

CHRIS L. WHEELER
State Engineer

Form 128

ks

G-3788

November 13, 1967

Nesika Beach Water District
Gold Beach
Oregon 97444

blueprint.

G-3788, permit No. G-3571 with a

May 2, 1967

Nesika Beach Water District
Gold Beach
Oregon

Gentlemen:

This will acknowledge your returned application No. G-3788 and map. This application has received a new date of priority of April 18, 1967.

The application is now in satisfactory form for approval by issuance of a permit.

Very truly yours,

CHRIS L. WHEELER
State Engineer

By
Larry W. Jebousek
Assistant

LWJ:hls

cc Worthington Associates, Inc.
214 Hout Building
Corvallis, Oregon

February 17, 1967

Nesika Beach Water District
Gold Beach
Oregon

Gentlemen:

This will acknowledge receipt of your application for a permit to appropriate 1.11 cubic feet of water per second from one well for domestic water supply, map, and the fee of \$22 for which our receipt No. 2358 is enclosed. This application has been filed and numbered G-3788.

Item No. 12 describes the SW $\frac{1}{4}$ of Section 9 in Township 36 South, Range 4 West as a place of use. The map shows only the S $\frac{1}{2}$ SW $\frac{1}{4}$ of Section 9. Item No. 12 also shows the W $\frac{1}{2}$ of the E $\frac{1}{2}$ of Section 17 in Township 35 South, Range 14 West as being served. The map however, shows this to be in Township 36 South, Range 14 West. The application and the map must be in agreement as to the area to be served.

I am returning your application and the map for correction. The application is endorsed so that in order to retain its date of priority, it must be returned on or before April 17, 1967.

Very truly yours,

CHRIS L. WHEELER
State Engineer

By
Larry W. Jebousek
Assistant

LWJ:dly
Enclosures
cc: Worthington Associates Inc.
214 Hout Building
Corvallis, Oregon

WORTHINGTON ASSOCIATES INC.

CONSULTING ENGINEERS
214 HOUT BUILDING
CORVALLIS, OREGON 97330

RECEIVED
JAN 23 1967

STATE ENGINEER
SALEM OREGON

January 17, 1967

Office of the State Engineer
Water Resources Department
516 Public Service Building
Salem, Oregon 97310

Gentlemen:

Re: NESIKA BEACH WATER DISTRICT
GOLD BEACH, OREGON

Submitted herewith is a map, signed Application for a Permit and a check for \$22.00 for appropriating water from a well in a gravel bar on the right bank of the Rogue River in Curry County, Oregon.

Please contact our office if any additional information is needed.

Very truly yours,

WORTHINGTON ASSOCIATES INC.

Martin L. Beyerlein

MLB:bh
Enclosures

Notice that you intend to construct a well to develop and use ground water has been received from a licensed Water Well Contractor as provided by law.

Anyone intending to appropriate ground water is required by law to apply for and be issued a permit before withdrawing or using ground water for any purpose except:

(1) Stock watering purposes; (2) Watering any lawn or noncommercial garden not exceeding $\frac{1}{2}$ acre in area; (3) Single or group domestic purposes not exceeding 15,000 gallons per day and/or (4) any single industrial or commercial purpose not exceeding 5,000 gallons per day. A permit is not necessary and cannot be issued for such exempted uses of **ground water.**

If you intend to use water from the well for any purpose not exempt from filing, the proper application forms and instructions for filing will be mailed to you if you check the following square and return this card. Please correct any error in your address on the opposite side of this card.

CHRIS L. WHEELER, State Engineer
Salem, Oregon 97310

RECEIVED
MAR 20 1967

STATE ENGINEER
SALEM OREGON

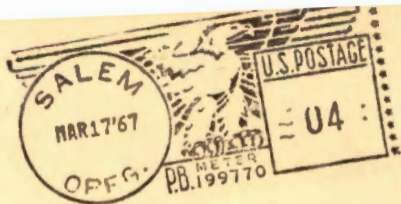

Nesika Beach Water Dist.
Nesika Beach, Oregon

**No Such Post Office
in State Named.**

Inspection
 August 21, 1969
 L. E. G.

Abstract of Permit No. 0-3571

Application No. **0-3788** Certificate No.

Name **Nesika Beach Water District** *Ray Stevens 7-6731*

Address **Box 114 (Rt. 1)
Gold Beach, Oregon**

Source of water supply **A well** *trib Rogue River*

Use **Group Domestic use of 112 families**

Point of diversion **512' N. & 2538' E. from S1 sec. cor. Sec. 9, being within
SE1/4 SE1/4, Sec. 9, T. 36 S., R. 14 W., W. M., county of Curry**

Number of acres

DESCRIPTION OF LAND TO BE IRRIGATED OR PLACE OF USE

Twp.	Range	Sec.	NE1/4				NW1/4				SW1/4				SE1/4			
			NE1/4	NW1/4	SW1/4	SE1/4	NE1/4	NW1/4	SW1/4	SE1/4	NE1/4	NW1/4	SW1/4	SE1/4	NE1/4	NW1/4	SW1/4	SE1/4

Twp	Rng	Sec	Land Description
35S	14W	30	S.E. 1/4 S.W. 1/4 ✓
		31	S.W. 1/4 N.E. 1/4 ✓
			N.W. 1/4 ✓
			N. 1/2 SW 1/4 ✓
			S.W. 1/4 S.W. 1/4 ✓
35S	15W	36	SE 1/4 NE 1/4 ✓
			E 1/2 SE 1/4 ✓
36S	14W	6	S.E. 1/4 SE 1/4 ✓
		8	N.W. 1/4 N.W. 1/4 ✓
			S.E. 1/4 NW 1/4 ✓
			E. 1/2 SW 1/4 ✓
			S. 1/2 SE 1/4 ✓
		9	S. 1/2 S.W. 1/4 ✓
			S. 1/2 S.E. 1/4 ✓
16	N. E. 1/4 N. W. 1/4 ✓		
17	W. 1/2 N. E. 1/4 ✓		
	N. W. 1/4 S. E. 1/4 ✓		

Abstract of Permit No. G-3571

Application No. G-3788 Certificate No.

Name **Nesika Beach Water District** *Ray Stevens 7-6731*
 Address *Box 114 (Rt. 1)*
Gold Beach, Oregon
 Source of water supply **A well** *trib Rogue River*
 Use **Group** *Domestic use of 112 families*
 Point of diversion **512' N. & 2538' E. from St sec. cor. Sec. 9, being within**
SE 1/4, Sec. 9, T. 36 S., R. 14 W., N. H., county of Curry
 Number of acres

DESCRIPTION OF LAND TO BE IRRIGATED OR PLACE OF USE

Twp.	Range	Sec.	NE 1/4				NW 1/4				SW 1/4				SE 1/4			
			NE 1/4	NW 1/4	SW 1/4	SE 1/4	NE 1/4	NW 1/4	SW 1/4	SE 1/4	NE 1/4	NW 1/4	SW 1/4	SE 1/4	NE 1/4	NW 1/4	SW 1/4	SE 1/4
368	14W	10											X					
		9											X	X			X	X
		16					X	X										
		8						X	X	X	X						X	X
		6						X	X	X	X					X		X
368	15W	1	X															
	14W	17	X	X	X											X	X	
358		30											X	X			X	
		31	X	X	X	X	X	X	X	X	X	X	X	X	X	X	X	X
358	15W	36													X			X

Priority date **April 18, 1967**
~~0.20~~
 Amount of water **1.11 c.f.s.**
 Time limit to begin construction ~~October 19, 1968~~
 Time limit to complete construction ~~10-1-69~~ extended to _____ extended to _____
 Time limit to completely apply water ~~10-1-70~~ extended to _____ extended to _____

Remarks: *This right* ~~This appropriation shall be limited to _____ of one cubic foot per second or its equivalent for each acre irrigated and shall be further limited to a diversion of not to exceed _____ acre feet per acre for each acre irrigated during the irrigation season of each year; and shall be further limited to appropriation of water only to the extent that it does not impair or substantially interfere with existing surface water rights of others and shall be subject to such reasonable rotation system as may be ordered by the proper state officer.~~

Inspection August 21, 1969 L.E.G.

Basin 15, Vol. _____

Info: Mr. Raymond H. Stevens (Chairman of Board)

Well: 12" Casing Approx. 40' Deep

Pump: 20 HP. Layne & Bowler Type 6 E.H.L., 3 phase
8 Stage Submersible, 6" Discharge
Cap. 180 g.p.m. with 300' Head. = 0.40 cfs

Reservoir: Cylindrical Steel 33' Diam. 32' High

Elevation: 260.0' to Bottom of Inside Tank.

Pipe: Approx. 4 miles 8" Transite

" 1 1/2 " 6" "

" ~~1~~ " 4" "

" 4 or 5 " 2" Plastic.

Lift: Approx. 300' head (Pump to Tank)

Use: Domestic use of 112 families
(6 or 7 are Commercial)

August 21, 1969, R. E. Gould
Field Engineer

Twp	Rng	Sec	
35S	14W	30	S.E. $\frac{1}{4}$ S.W. $\frac{1}{4}$ ✓
		31	S.W. $\frac{1}{4}$ N.E. $\frac{1}{4}$ ✓
			N.W. $\frac{1}{4}$ ✓
			N. $\frac{1}{2}$ S.W. $\frac{1}{4}$ ✓
			S.W. $\frac{1}{4}$ S.W. $\frac{1}{4}$ ✓
35S	15W	36	SE $\frac{1}{4}$ NE $\frac{1}{4}$ ✓
	E $\frac{1}{2}$ SE $\frac{1}{4}$ ✓		
36S	14W	6	S.E. $\frac{1}{4}$ SE $\frac{1}{4}$ ✓
		8	N.W. $\frac{1}{4}$ N.W. $\frac{1}{4}$ ✓
			S.E. $\frac{1}{4}$ N.W. $\frac{1}{4}$ ✓
			E. $\frac{1}{2}$ S.W. $\frac{1}{4}$ ✓
			S. $\frac{1}{2}$ S.E. $\frac{1}{4}$ ✓
		9	S. $\frac{1}{2}$ S.W. $\frac{1}{4}$ ✓
			S. $\frac{1}{2}$ S.E. $\frac{1}{4}$ ✓
		16	N.E. $\frac{1}{4}$ N.W. $\frac{1}{4}$ ✓
		17	W. $\frac{1}{2}$ N.E. $\frac{1}{4}$ ✓
			N.W. $\frac{1}{4}$ S.E. $\frac{1}{4}$ ✓

RECEIVED
APR 18 1967

STATE ENGINEER
SALEM, OREGON

RECEIVED
JAN 23 1967

STATE ENGINEER
SALEM, OREGON

NESIKA BEACH WATER DISTRICT MUNICIPAL WATER SYSTEM

Township	Range	Section	Forty-acre Tract	Township	Range	Section	Forty-acre Tract
36s	14w	10	SW ¹ / ₄ of SW ¹ / ₄	36s	14w	6	NE ¹ / ₄ of SW ¹ / ₄
36s	14w	9	S ¹ / ₂ of SE & S ¹ / ₂ of SW ¹ / ₄	36s	14w	6	SW ¹ / ₄ of NW ¹ / ₄
36s	14w	16	N ¹ / ₂ of NW ¹ / ₄	36s	15w	1	NE ¹ / ₄ of NE ¹ / ₄
36s	14w	8	SE ¹ / ₄ of SE ¹ / ₄	35s	15w	36	SE ¹ / ₄ of SE ¹ / ₄
36s, III	14w	8	SW ¹ / ₄ of SE ¹ / ₄	35s	15w	36	NE ¹ / ₄ of SE ¹ / ₄
36s	14w	8	NE ¹ / ₄ of SW ¹ / ₄	35s	14w	31	Entire Section
36s	14w	8	SE ¹ / ₄ of NW ¹ / ₄	35s	14w	30	SW ¹ / ₄ of SW ¹ / ₄
36s	14w	8	NW ¹ / ₄ of NW ¹ / ₄	35s	14w	30	SE ¹ / ₄ of SW ¹ / ₄
36s	14w	6	SE ¹ / ₄ of SE ¹ / ₄	36s	14w	17	W ¹ / ₂ of E ¹ / ₂
36s	14w	6	NW ¹ / ₄ of SE ¹ / ₄	35s	14w	30	SW ¹ / ₄ of SE ¹ / ₄
36s	14w	6	SE ¹ / ₄ of NW ¹ / ₄	36s	14w	17	NE ¹ / ₄ of NE ¹ / ₄
36s	14w	6	NW ¹ / ₄ of NW ¹ / ₄	36s	14w	8	SW ¹ / ₄ of NW ¹ / ₄

REGISTERED
OREGON
LAND SURVEYOR

Martin L. Beyerlein

NOV. 5, 1948
MARTIN L. BEYERLEIN
247

Jan 17, 1967

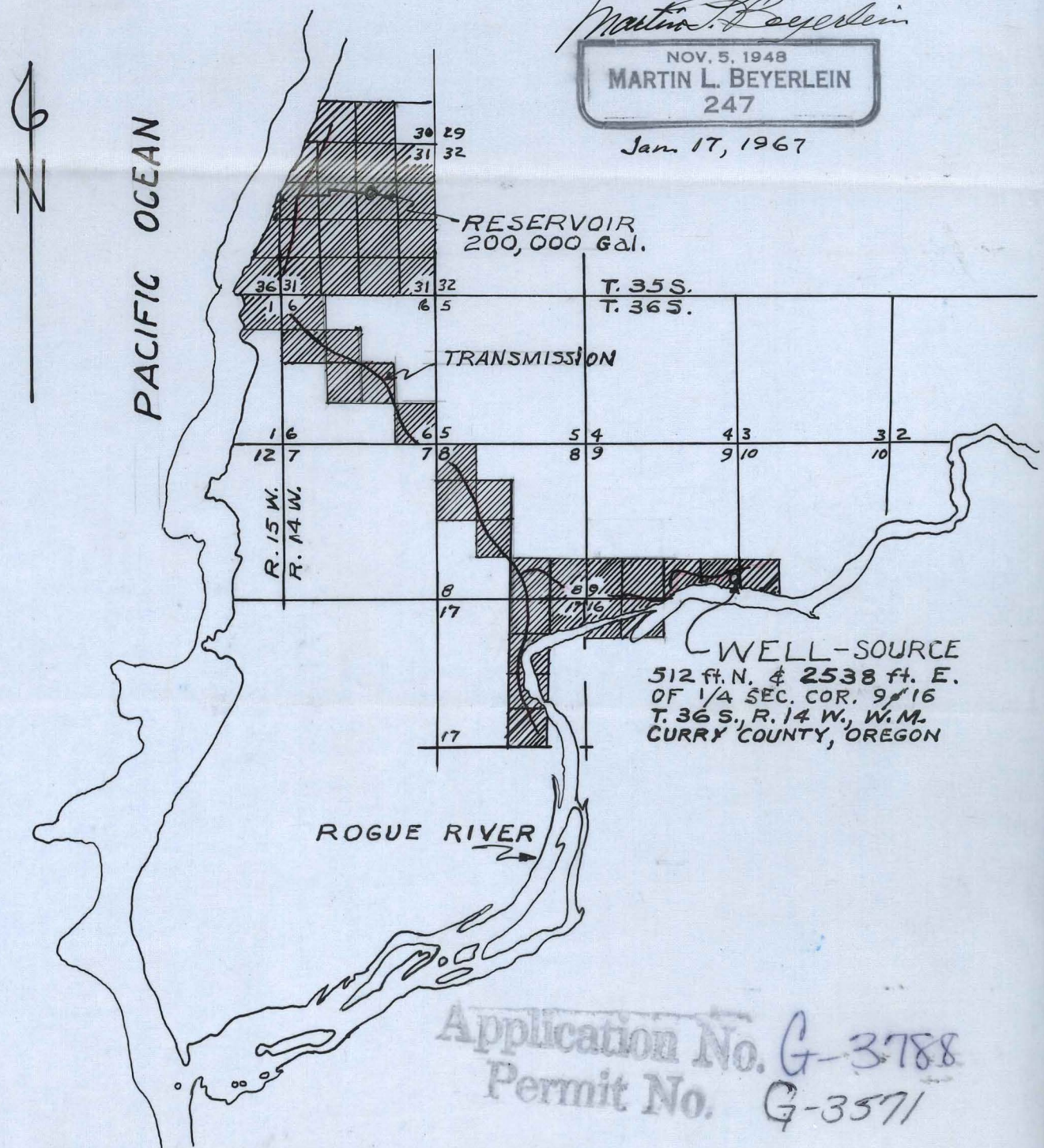

Application No. G-3788
Permit No. G-3571

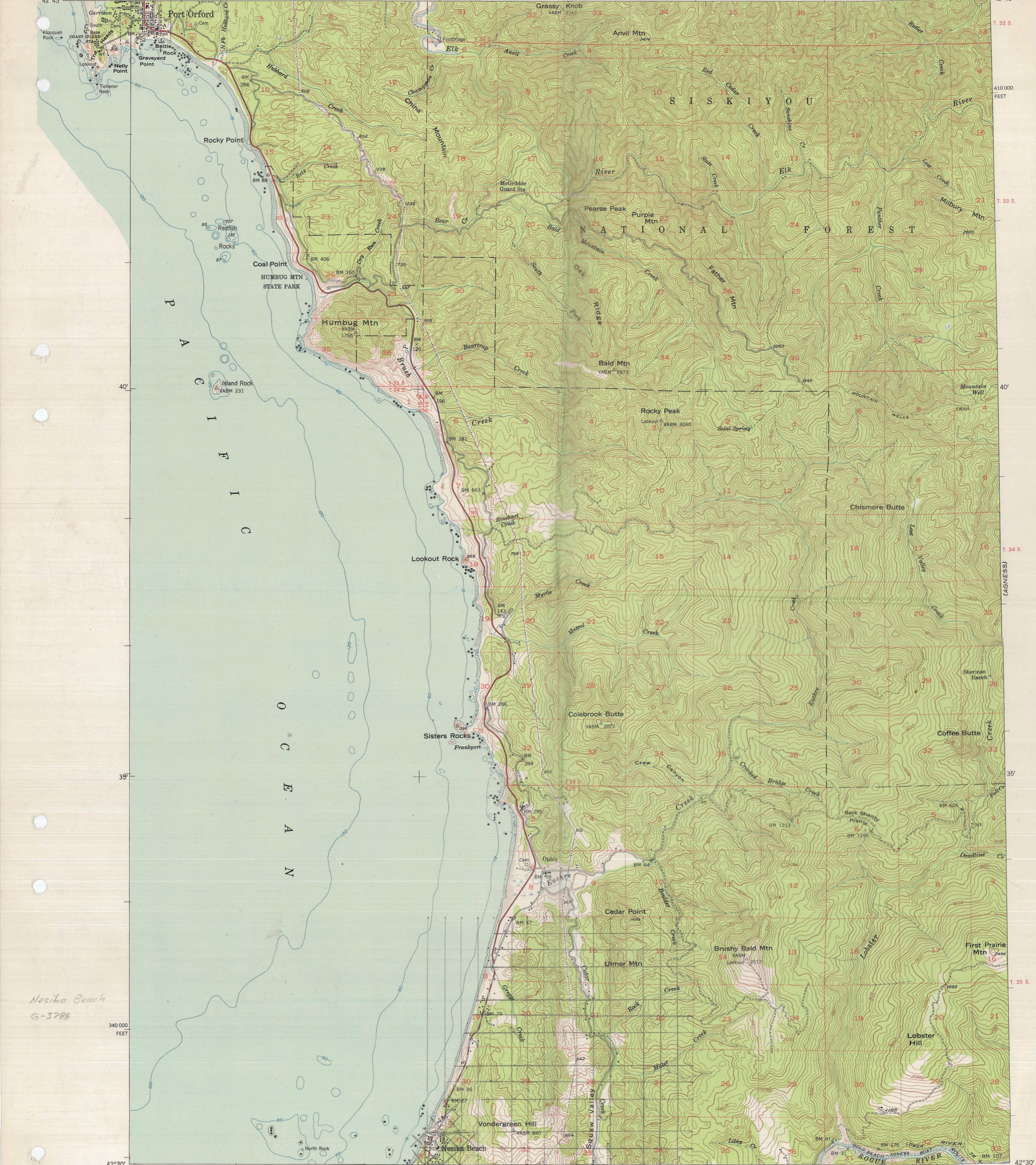

Nesika Beach
G-3788

Mapped, edited, and published by the Geological Survey
Control by USGS and USC&GS
Topography from aerial photographs by multiplex methods
Aerial photographs taken 1952. Field check 1954
Hydrography from USC&GS charts 5951 (1948) and 5952 (1950)
Polyconic projection. 1927 North American datum
10,000-foot grid based on Oregon coordinate system, south zone
Dashed land lines indicate approximate locations
Unchecked elevations are shown in brown

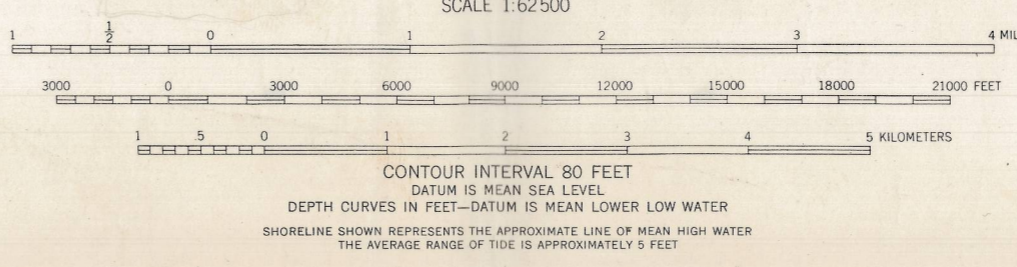
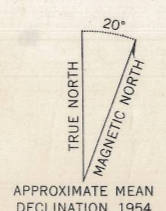

ROAD CLASSIFICATION

Heavy-duty	Light-duty
Medium-duty	Unimproved dirt

U. S. Route State Route

OREGON
QUADRANGLE LOCATION

PORT ORFORD, OREG.
N4230—W12415/15

Nesika Beach G-388

UNITED STATES
DEPARTMENT OF THE INTERIOR
GEOLOGICAL SURVEY

GOLD BEACH QUADRANGLE
OREGON—CURRY CO.
15 MINUTE SERIES (TOPOGRAPHIC)

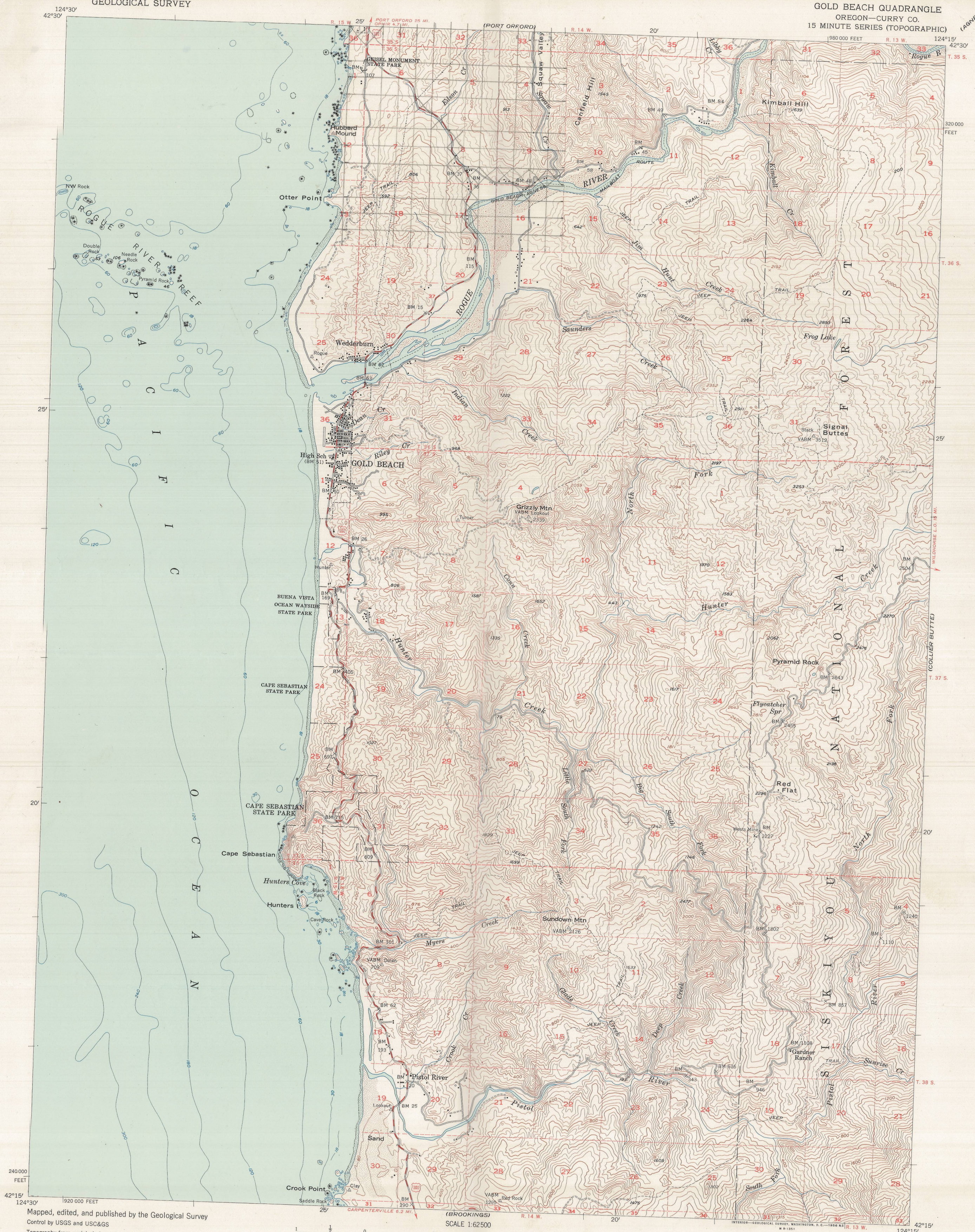

Mapped, edited, and published by the Geological Survey
Control by USGS and USC&GS
Topography from aerial photographs by multiplex methods
Aerial photographs taken 1952. Field check 1954
Hydrography compiled from USC&GS Charts 5896 (1951)
and 5951 (1948)
Polyconic projection. 1927 North American datum
10,000-foot grid based on Oregon coordinate system, south zone
Dashed land lines indicate approximate locations
Unchecked elevations are shown in brown

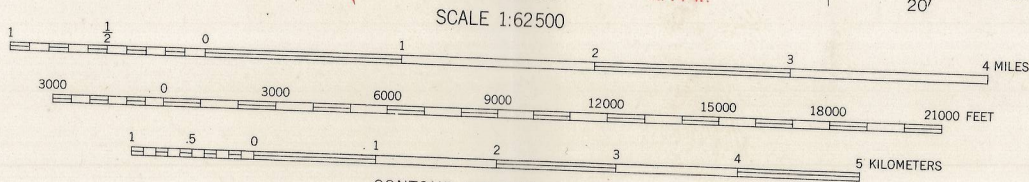
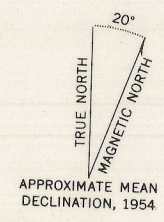

CONTOUR INTERVAL 80 FEET
DATUM IS MEAN SEA LEVEL
DEPTH CURVES IN FEET—DATUM IS MEAN LOWER LOW WATER
SHORELINE SHOWN REPRESENTS THE APPROXIMATE LINE OF MEAN HIGH WATER
THE AVERAGE RANGE OF TIDE IS APPROXIMATELY 5 FEET

THIS MAP COMPLIES WITH NATIONAL MAP ACCURACY STANDARDS
FOR SALE BY U. S. GEOLOGICAL SURVEY, FEDERAL CENTER, DENVER, COLORADO OR WASHINGTON 25, D. C.
A FOLDER DESCRIBING TOPOGRAPHIC MAPS AND SYMBOLS IS AVAILABLE ON REQUEST

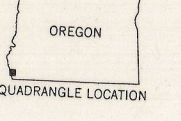
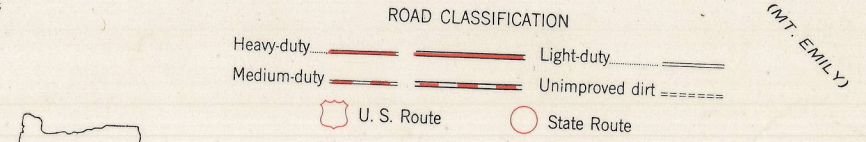

GOLD BEACH, OREG.
N4215—W12415/15
1954