

Application No. 14450

Permit No. 10470

Certificate No. 9888

FEES PAID

Date	Amount	Receipt No.
<u>12/28/31</u>	<u>9.50</u>	<u>14756</u>
Total		

Stream Index, Page No. 2-455

Application Record, Book No. _____

FEES REFUNDED

Date	Amount	Check No.

H. A. Dempsey
Rickreall, Oregon
Dec. 28, 1931
 suspended until _____

_____ to applicant _____
 _____ completed _____
 _____ approval March 3, 1932

ASSIGNMENTS

Date	To whom	Address	Volume	Page

REMARKS

0.03 s. f. from La Creole Creek, trib. Willamette, for irrigation 2 1/2 acres.
9-9-32 - Form 102

CONSTRUCTION

_____ beginning March 3, 1933
 _____ completion Oct. 1, 1934
 _____ ended to _____
 _____ application of water Oct. 1, 1935
 _____ ended to _____

PROSECUTION OF WORK

_____ "A" filed _____
 _____ "B" filed _____
 _____ "C" filed _____

FINAL PROOF

_____ mailed March 2, 1932
 _____ received Sept. 30, 1932
 _____ certificate issued January 6, 1933
 _____ for recording fee No. 15543 for 1.00

SECTION

TOWNSHIP 7S, RANGE 4W, W. M.

North

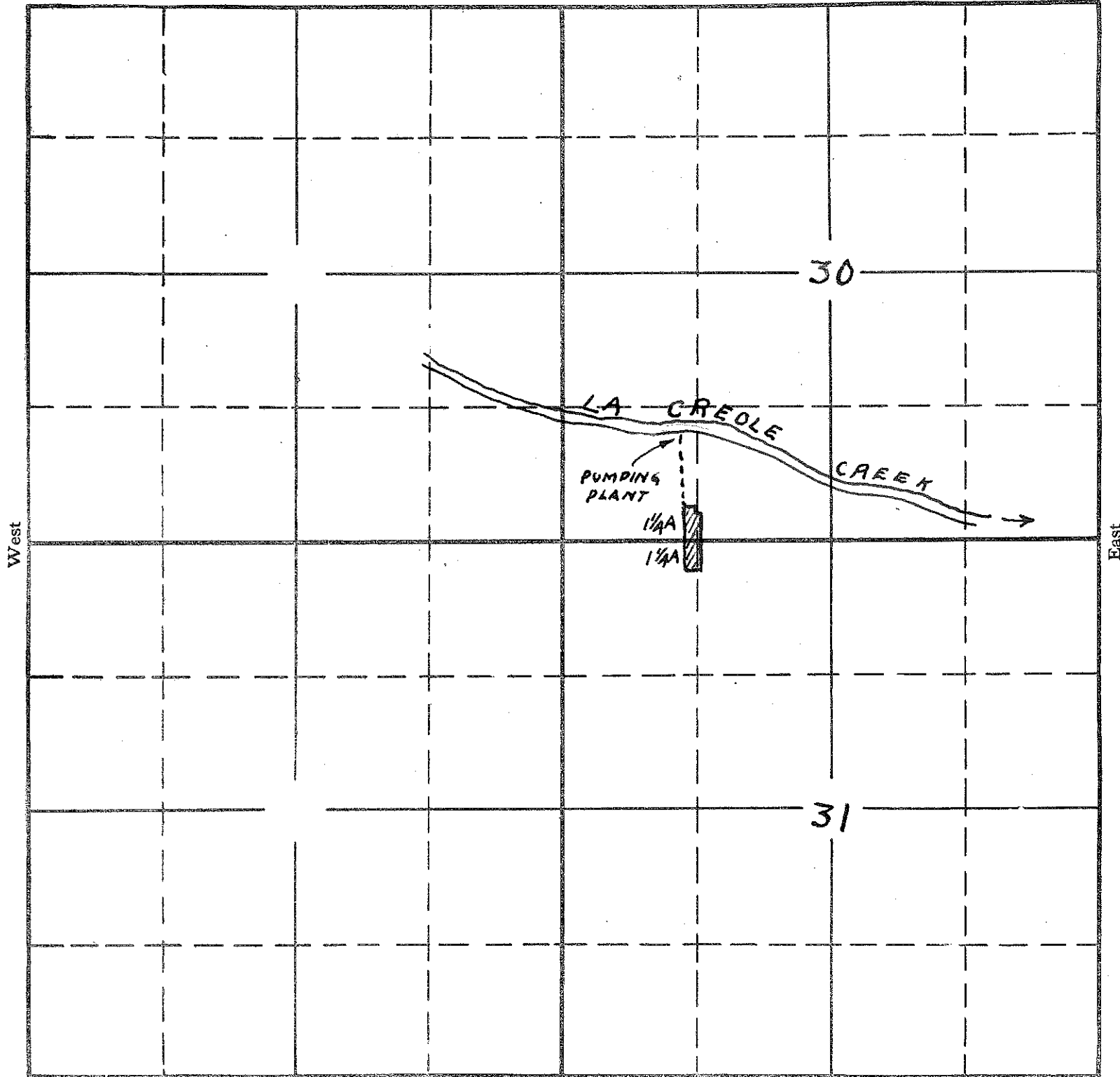

South

APPLICATION No. 14450

PERMIT No. 10470

Rickreall, Oreg.,
Sept. 30, 1932.

State Engineer,
Salem, Oreg.

STATE ENGINEER
RECEIVED

SEP 30 1932

Dear Sir,

SALIM, OREGON

I am enclosing 1^{00}
for recording the certificate,
and think I have filled
in the checked items
satisfactorily this time.

The name of the creek
is Rickreall, not Lacreole.

Yours truly,

Larry G. Dempsey
Rickreall, Oreg.

10/1/32

APPLICATION No. 14450

COUNTY Polk

PROOF OF APPROPRIATION OF WATER

1. Name H. A. Dempsey 2. Address Rickreall, Oregon.

3. Source of supply La Creole Creek or Rickreall Tributary of Willamette River

4. Amount of water 0.03 0.02 5. Priority date December 28, 1931

6. Use Irrigation

7. Location of point of diversion, SW 1/4 SW 1/4 (Legal Subdivision) Sec. 30, Twp. 7 S, Range 4 W W. M.

8. The description of land given below corresponds to that found in your permit covering land to be irrigated, or, if for other purposes, the place of use. In the blank column on the right, headed "No. acres actually irrigated," fill in the number of acres you have irrigated in each of the tracts described:

Table with 5 columns: Township, Range, Section, Forty-acre Tract, No. Acres Described in Permit, No. Acres Actually Irrigated. Includes handwritten entries for Township 7 S, Range 4 W, Sections 30 and 31.

(Attach separate sheet if necessary)

DESCRIPTION OF WORKS

- 9. (a) If a dam has been constructed, give description: Height,ft.; length on top,ft.
length on bottomft.; material used and character of construction,
- (b) Give description of headgate: Width,ft.; depth,ft.; material used and character
of construction,
- (c) Size of canal: Width on top (at waterline)ft.; width on bottom,ft.; depth of
water,ft.; grade,ft. fall per 1,000 ft. Actual capacity,
sec.-ft. Give general description,
- (d) Pipe line: Description of intake,

Length of pipe, 500.ft.; size at intake, 2 in.; size at 16.ft. from intake, 1 1/2 in.; size
at place of use, 1 3/4 in. Difference in elevation between intake and place of use, 42.ft.
Is grade uniform? yes Actual capacity of pipe line,sec.-ft.
Give general description: steel
(Material: Steel, wrought, cast iron, wood stave, etc.)

(e) Pumping plant: Give size and type of pump, Plunger
Suction lift, 4.ft.; discharge lift, 32.ft. Type of motor used Electric
Horse power rating, 3/4 H. P. Actual capacity of pump, 6.50 ^{Pow. hrs.} sec.-ft.

- 10. During what months is water beneficially used May June July August Sept
- 11. State character of soil loam
Kind of crops raised Garden & Alfalfa
- 12. Does the accompanying map, filed with your application, show correctly the point of diversion, area
of land irrigated, or place of use? yes
- 13. If not, wherein is such map in error? yes
- 14. Domestic use: Give number of families actually using water at this time
- 15. If for power, mining, municipal, manufacturing, storage or any other purpose than irrigation, give
extent and method of such use

AFFIDAVIT OF APPROPRIATOR

STATE OF OREGON,

County of Polk } ss.

I, H.A. Dempsey, being first duly sworn, depose and say that I have read the above and foregoing proof of appropriation of water; that I know the contents thereof, and that the facts therein stated are true.

IN WITNESS WHEREOF, I have hereunto set my hand this 24th day of September, 1932

H.A. Dempsey

Subscribed and sworn to before me this 24 day of September, 1932

H.C. Barnhart
Notary Public for Oregon

[NOTARIAL SEAL]

My commission expires 7-2-34

AFFIDAVIT OF WITNESSES

STATE OF OREGON,

County of Polk } ss.

We, S.J. Lowry, and _____

of _____, being first duly sworn, depose and say that we are well acquainted with the facts and conditions set forth in the foregoing statement relative to proof of appropriation of water under Permit No. 4458; that we and each of us have been over and upon each tract described in said proof, and from such personal inspection have knowledge that all necessary ditches, dams and other diversion and distributing works have been constructed, and water used as stated therein; that we have carefully read such proof of appropriation, and that each and every statement contained therein is true to the best of our knowledge and belief.

S.J. Lowry
Otis Keith

Subscribed and sworn to before me this 24 day of September, 1932

H.C. Barnhart
Notary Public for Oregon

[NOTARIAL SEAL]

My commission expires 7-2-34

SECTION

TOWNSHIP 7S, RANGE 4W, W. M.

North

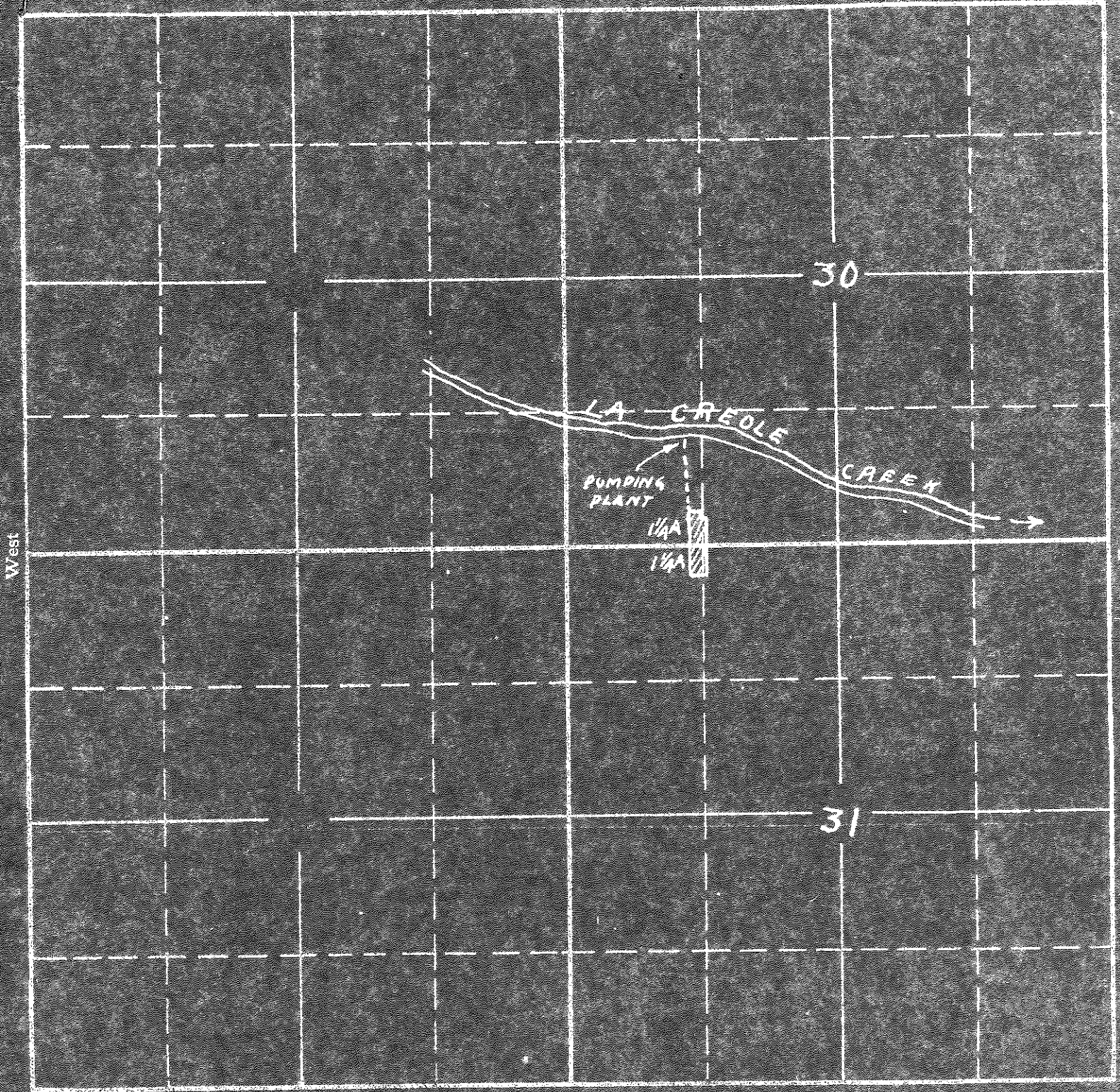

West

East

South

APPLICATION No. 14450
PERMIT No. 10470

September 27, 1932.

Mr. H. A. Dampsey,
Rickreall, Oregon.

Dear Sir:

Final proof under your Permit No. 10470 has been received, together with the original permit.

The proof, however, is not considered to be satisfactory in that it does not give sufficient description of the completed works. The number of acres which are actually being irrigated should be stated under Item 8, and the items on the second page which I have checked in pencil should be filled out. There is a fee of \$1.00 for recording the water right certificate in the County Clerk's office which should accompany the proof form.

Your permit is being returned herewith and you should retain it until the water right certificate is received as it is your record of your water right.

Very truly yours,

CHAS. S. STRICKLIN,
State Engineer.

By

V. S. Bovelle, Assistant.

VSB:LN
Encls.

March 3, 1932.

Mr. H. A. Dempsey,
Rickreall, Oregon.

Dear Sir:

Herewith you will find Application No. 14450, Permit
No. 10470.

This application has been approved and recorded in
this office.